

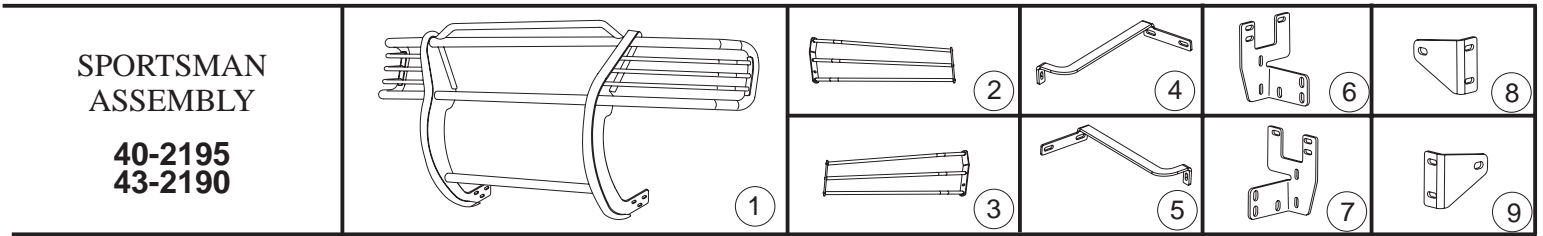

# INSTALLATION INSTRUCTIONS

APPLICATION: 2006-UP TOYOTA 4-RUNNER

AUTOMOTIVE PRODUCTS, INC.



## PARTS KIT CONTENTS

ITEM	QTY	DESCRIPTION	ITEM	QTY	DESCRIPTION
1	1	SPORTSMAN ASSEMBLY	16	4	3/8" SAE FLAT WASHER, SS
2,3	2	LIGHT GUARD ASSEMBLY, PASSENGER (2) AND DRIVER (3)	17	2	3/8" LOCK WASHER, SS
4,5	2	TOP BRACKET, PASSENGER (4) AND DRIVER (5)	18	2	3/8-16 HEX NUT, SS
6,7	2	BOTTOM BRACKET, PASSENGER (6) AND DRIVER (7)	19	4	M6-1.00 X 25MM HEX HEAD BOLT
8,9	2	BOTTOM SUPPORT, PASSENGER (8) AND DRIVER (9)	20	4	1/4" FLAT WASHER
10	2	M12-1.25 X 30MM HEX HEAD BOLT	21	4	M6 LOCK WASHER
11	6	1/2-13 X 1.25" HEX HEAD BOLT	22	4	3/8-16 X 1.25" HEX HEAD BOLT
12	14	1/2" FLAT WASHER	23	8	3/8" SAE FLAT WASHER
13	6	1/2" LOCK WASHER	24	4	3/8" LOCK WASHER
14	6	1/2-13 HEX NUT	25	4	3/8-16 HEX NUT
15	2	3/8-16 X 1.25" BUTTON HEAD BOLT, SS	26	2	ANTI REFLECTIVE TAPE (CHROME ASSEMBLIES ONLY.)

## TOOLS REQUIRED

3/4" SOCKET	3/4" WRENCH	9/16" SOCKET	9/16" WRENCH	7/16" WRENCH
5/32" HEX WRENCH	14MM SOCKET	10MM SOCKET	RATCHET	SOCKET EXTENSION
TORQUE WRENCH	UTILITY KNIFE	FLAT TIP SCREWDRIVER		

- STEP 1. Remove the contents from box and check for damage. Verify all parts are present. Read instructions completely before beginning.
- STEP 2. Attach light guard assemblies as shown. **SEE FIGURE 1.**
- STEP 3. Remove three of the four nuts that hold the bumper support frame to the vehicle frame. **NOTE:** Leave the outer top most nut attached or vehicle damage may occur. **SEE FIGURES 2 AND 3.**
- STEP 4. Determine passenger and driver side bottom brackets. Attach both bottom brackets with existing hardware previously removed. Leave loose. **SEE FIGURE 3.**
- STEP 5. Attach bottom support brackets to vehicle using metric bolts and 1/2" fasteners and to previously installed bottom bracket 3/8" fasteners as shown. Leave loose. **SEE FIGURE 3.**
- STEP 6. Open hood. Locate hole in front of Radiator mount. Find the grille in the bumper. The grille will have rows of openings going across and they are divided into 5 columns which run up and down. The bracket is inserted through the hole in the top row and second column in from each side. The bracket is attached to the radiator mount with the M6 bolts, M6 lock washers and 1/4" flat washers. **SEE FIGURE 2.**
- STEP 7. With Sportsman front side down in front of vehicle, fasten rear slot of Sportsman to the rear slot of mount bracket on bottom of frame. Leave loose. Rotate Sportsman up to vehicle and secure to bracket using remaining 1/2" and 3/8" fasteners. Leave loose. **SEE FIGURE 2.**
- STEP 8. Center and level Sportsman. Carefully make sure vehicle hood will clear unit and top braces when opening and closing. Adjust unit if needed. Torque 1/2" fasteners and M12 bolts to 65 FT. LBS, 3/8" fasteners and M10 nuts to 35 FT. LBS, and M6 bolts to 11 FT. LBS.

**FIGURE 1**  
**LIGHT GUARD INSTALLATION**  
**DRIVER SIDE SHOWN,**  
**PASSENGER SIDE OPPOSITE**

ITEM	QTY.	DESCRIPTION
1	8	1/4-20 X 1.00" BUTTON HEAD BOLT
2	8	1/4" FLAT WASHER
3	4	1/4" INTERNAL TOOTH LOCK WASHER
4	4	1/4-20 NYLON NUT
5	8	RUBBER WASHER

NOTE: ALL FASTENERS MAY NOT BE USED.

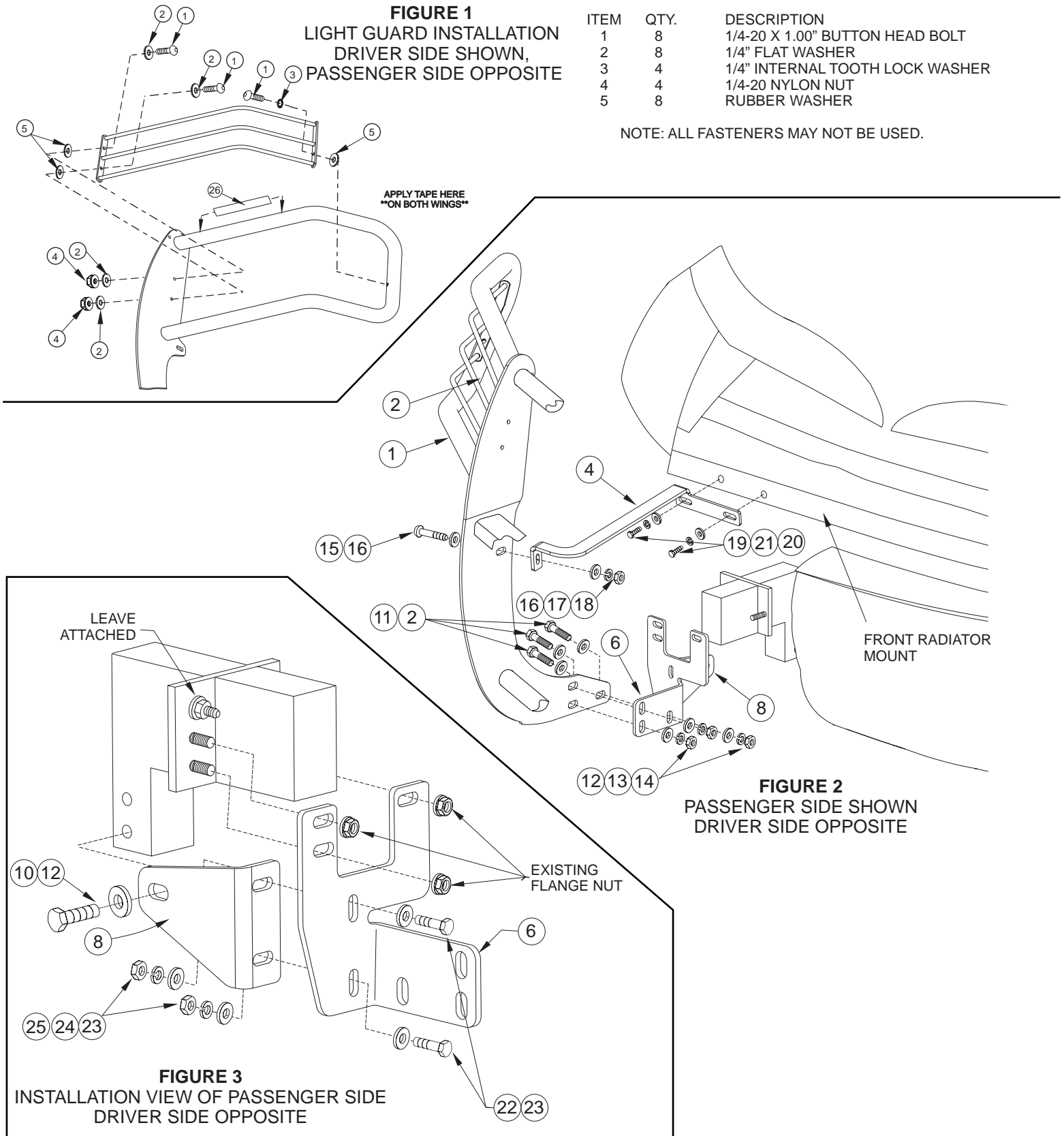

**FIGURE 3**  
**INSTALLATION VIEW OF PASSENGER SIDE**  
**DRIVER SIDE OPPOSITE**

**FIGURE 2**  
**PASSENGER SIDE SHOWN**  
**DRIVER SIDE OPPOSITE**

Finish protection - Westin products have a high quality finish that must be cared for like any other exposed finish on the vehicle. Protect the finish with a non-abrasive automotive wax (pure carnauba, for example) on a regular basis. The use of cleaner wax or any compound which contains an abrasive is detrimental, as the compounds scratch the finish and open it to corrosion.



Westin Automotive Products, Inc.  
 5200 N. Irwindale Ave. Suite 220  
 Irwindale, Ca. 91706

Thank You for choosing Westin products  
 For additional installation assistance please call  
 Customer service (800) 793-7846 or (507) 375-3559