

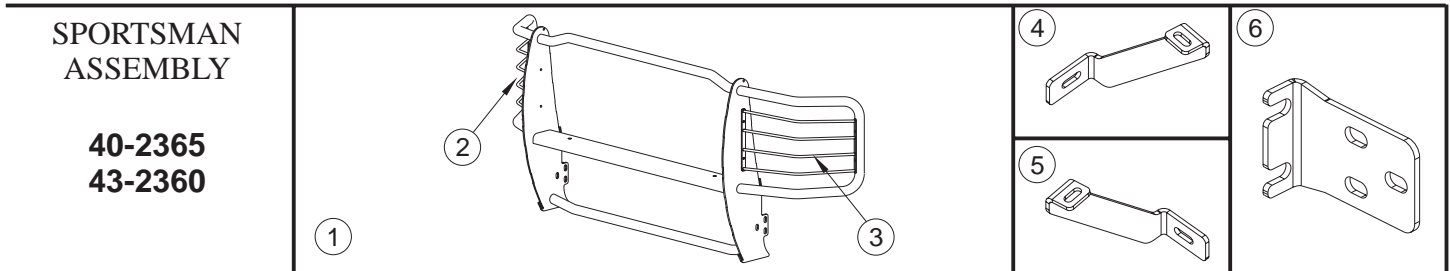

INSTALLATION INSTRUCTIONS

APPLICATION: 2008-UP FORD F-250/350/450 SUPERDUTY

AUTOMOTIVE PRODUCTS, INC.



PARTS KIT CONTENTS

ITEM	QTY	DESCRIPTION	ITEM	QTY	DESCRIPTION
1	1	SPORTSMAN ASSEMBLY	10	6	1/2-13 HEX NUT
2,3	2	LIGHT GUARD ASSEMBLY, PASSENGER(2) AND DRIVER(3)	11	2	3/8-16 X 1.25" HEX HEAD BOLT
4,5	2	TOP BRACKET, PASSENGER(4) AND DRIVER(5)	12	4	3/8" FLAT WASHER
6	2	BOTTOM BRACKET	13	2	3/8" LOCK WASHER
7	6	1/2-13 X 1.25" HEX HEAD BOLT	14	2	3/8-16 HEX NUT
8	12	1/2" FLAT WASHER	15	2	ANTI-REFLECTIVE TAPE (FOR CHROME ASSEMBLIES ONLY.)
9	6	1/2" LOCK WASHER			

TOOLS REQUIRED

9/16" SOCKET	9/16" WRENCH	13MM WRENCH	7/16" WRENCH	3/4" WRENCH
3/4 SOCKET	5/32" HEX WRENCH	18MM SOCKET	6" EXTENSION	RATCHET
TORQUE WRENCH				

- STEP 1. Remove the contents from box and check for damage. Verify all parts are present. Read instructions completely before beginning.
- STEP 2. Attach light guard assemblies as shown. **SEE FIGURE 1.**
- STEP 3. Loosen front bumper bolts approximately 3/8" while pushing bumper toward vehicle to help prevent retaining clips from rotating beneath the bumper. Attach bottom brackets as shown. Leave bracket loose enough for adjustment. **SEE FIGURE 2.**
- STEP 4. Measure distance at the outside of the uprights on grille guard.
- STEP 5. Position brackets on vehicle according to the measured width of the upright. At the same time, position bumper in desired location. Tighten factory bumper bolts on vehicle. Recommended torque is 65 FT. LBS.
- STEP 6. Place Sportsman assembly up against truck and align with the bottom mount brackets. Attach Sportsman with 1/2" fasteners. Leave loose. **SEE FIGURE 2.**
- STEP 7. Lift hood slowly to check if grille clears top tube. If not, adjust Sportsman assembly properly to clear. Leave hood up and locate top bracket mounting locations. **SEE FIGURE 3.** Remove factory bolts and place brackets into position, put factory bolts back in. Leave lose. Use 3/8" fasteners to attach top brackets to uprights. **SEE FIGURE 4.** Leave loose.
- STEP 8. Center and level Sportsman as desired. Make sure grille clears top tube when shutting hood. Adjust as necessary. Tighten all fasteners. Recommended torque values are 43 FT. LBS. for 1/2" fasteners, 19.7 FT. LBS. for 3/8" fasteners, and 6 FT. LBS. for 1/4" fasteners (Light Guards). After torquing all fasteners, check grille clearance again to make sure it clears the top tube when shutting the hood. Adjust if necessary.
- STEP 9. For chrome assemblies. If light glare is being experienced off the wings of the Sportsman, anti-reflective tape has been supplied to reduce glare. With headlights on, note where the reflection is concentrated on the wing. Clean the wing well with a non-abrasive cleaner (rubbing alcohol works the best.) Trim the anti-reflective tape to the appropriate size where the glare was located and apply tape. **SEE FIGURE 1.**

FIGURE 1
LIGHT GUARD INSTALLATION

ITEM	QTY.	DESCRIPTION
1	8	1/4-20 X 1.00" BUTTON HEAD BOLT
2	8	1/4" FLAT WASHER
3	4	1/4" INTERNAL TOOTH LOCK WASHER
4	4	1/4-20 NYLON NUT
5	8	RUBBER WASHER

NOTE: ALL FASTENERS MAY NOT BE USED.

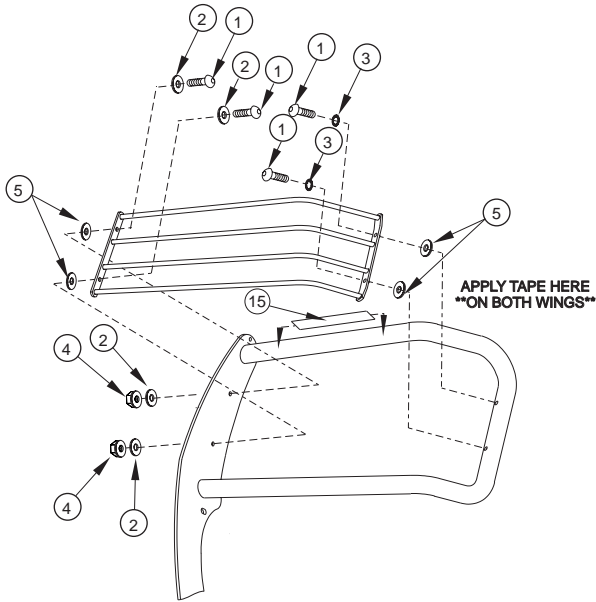

FIGURE 2
BOTTOM BRACKET INSTALLATION,
DRIVER SIDE SHOWN

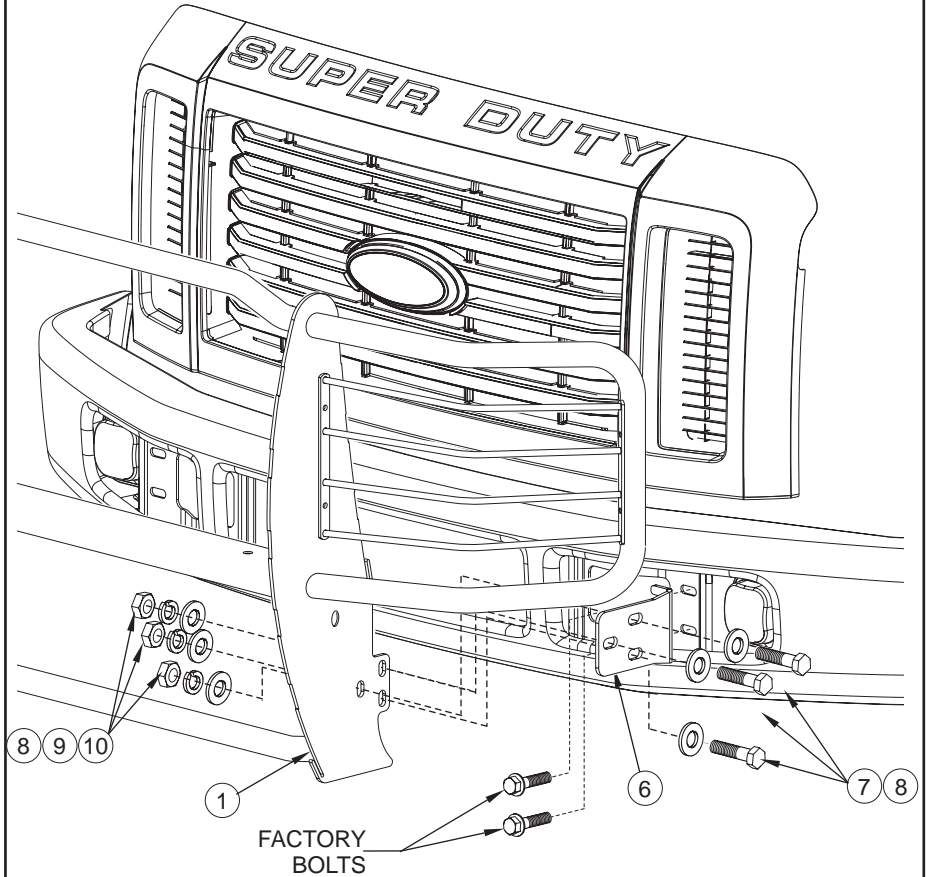

FIGURE 3
TOP BRACKET INSTALLATION,
REAR PASSENGER SIDE OF FRAME SHOWN

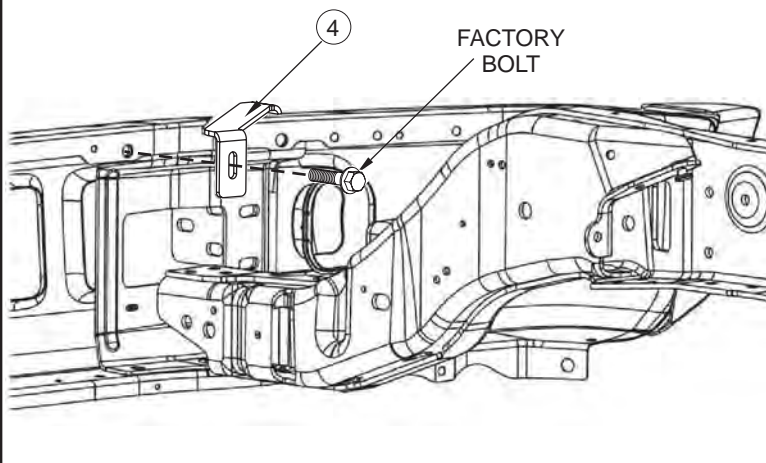
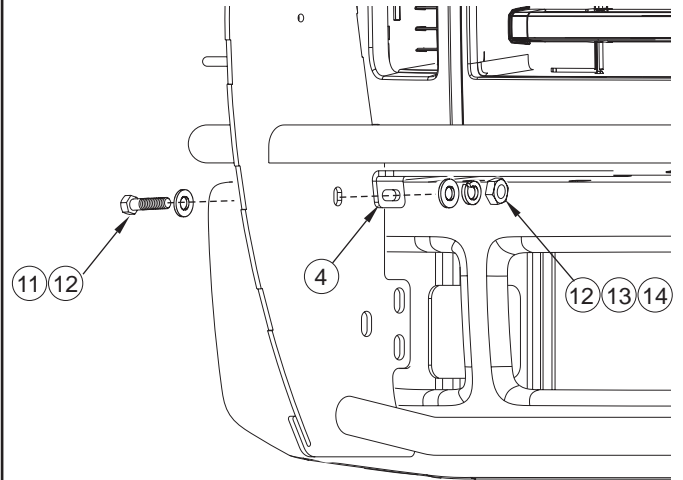

FIGURE 4
TOP BRACKET INSTALLATION,
PASSENGER SIDE SHOWN



Finish protection - Westin products have a high quality finish that must be cared for like any other exposed finish on the vehicle. Protect the finish with a non-abrasive automotive wax (pure carnauba, for example) on a regular basis. The use of cleaner wax or any compound which contains an abrasive is detrimental, as the compounds scratch the finish and open it to corrosion.



Westin Automotive Products, Inc.
5200 N. Irwindale Ave. Suite 220
Irwindale, Ca. 91706

Thank You for choosing Westin products
For additional installation assistance please call
Customer service (800) 793-7846 or (507) 375-3559