

UNDER THE HOOD. *ABOVE THE REST.*

Equipped with AEM® Dryflow™ Filter
No Oil Required!

**INSTALLATION INSTRUCTIONS
PART NUMBER
21-799C (GUN METAL GRAY FINISH)**

2013-17

NISSAN

SENTRA

1.8L

D-670-25

**Excludes: LEV2 and LEV3 SULEV test groups
DNSXV01.881B, ENSXV01.881B, FNSXV01.881B,
GNSXV01.831A, HNSXV01.8R1A**

**INTAKE SYSTEMS FOR VEHICLES
LISTED ARE 50 STATE LEGAL. SEE
AEMINTAKES.COM FOR CARB STATUS ON
EACH PART FOR A SPECIFIC VEHICLE.**

ITEM NO.	PART NUMBER	DESCRIPTION	QTY.
1	21-2157D	AIR FILTER 2-3/4" FLG, 5-1/2"B, 4-3/4T DRYFLOW	1
2	2-1582C	TUBE; 2.75"D X 14"L, AL, 2015 NISSAN SENTRA 1.8L	1
3	2-1581C	TUBE; 2.75"D X 23"L, AL, 2015 NISSAN SENTRA 1.8L	1
4	9-21070	MAF INSERT; AIR STRTNR, 2.59"OD, PLASTIC	1
5	5-272	HOSE, SILICONE 2.75X2" BLACK	2
6	9444	HOSE CLAMP, 2.31-3.25"	5
7	070228	STUD; RUBBER MNT, M/F, 1/2"L X 1"W, M6 X 1.00	1
8	22224	BOLT; M6X1.00X12 HEX; FLG, GRADE 10.9, GEO	1
9	08160	WASHER; 1"D X 1/4 HOLE FENDER	2
10	07027	STUD; M6-1.00 M/M, RUBBER MNTD	1
11	444.460.04	NUT; M6 HEX SERRATED	2
12	08691	HOSE; 5/8" ID X 9" L REINFORCED	1
13	7-352	BRACKET; 2" X 1" , M6 STUD, STAINLESS STEEL	1
14	409	SUPER GLUE, 3G DRIP PROOF	1

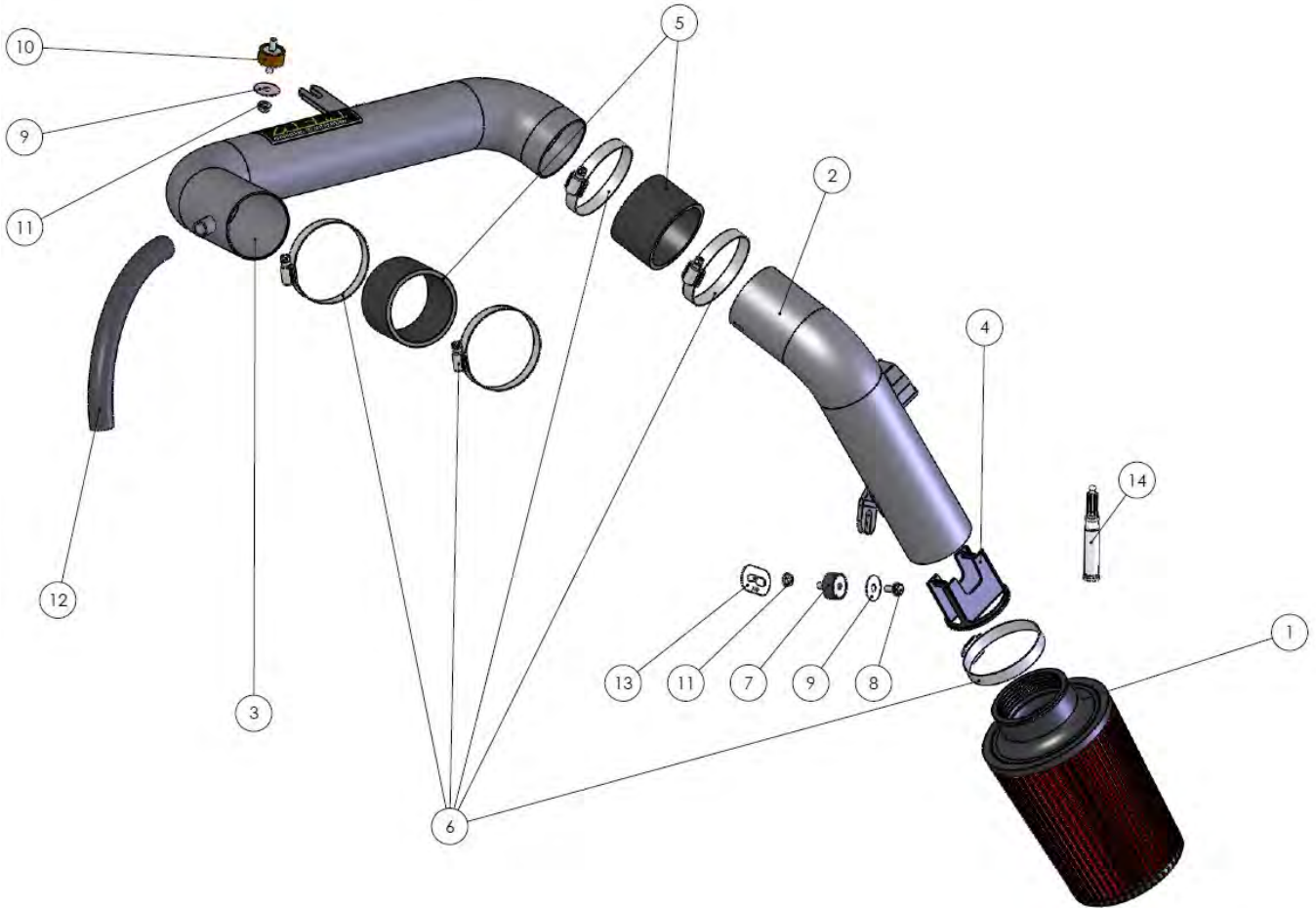

Read and understand these instructions **BEFORE** attempting to install this product. Failure to follow installation instructions and not using the provided hardware may damage the intake tube, throttle body and engine. If you need any assistance please call 1-800-858-3333 to speak with a representative in our Customer Service Center before returning the product.

1. Preparing Vehicle

- a. Make sure vehicle is parked on level surface.
- b. Set the parking brake.
- c. If engine has run in the past two hours, let it cool down.
- d. Disconnect negative battery terminal.
- e. Do not discard stock components after removal of the factory system.
- f. Open the air intake kit package and make sure all parts are included.

Tools Needed:	Socket Driver
Flat Head Screwdriver	Pliers
Philips Head Screwdriver	Lug wrench
10mm Socket Extension	Optional:
	Small Torque Wrench

2. Removal of stock system



a. Remove plastic engine cover by pulling up with both hands gently.



b. Remove the plastic air duct from the stock air box by pulling it straight up while lifting the tab where the arrow is pointing.



c. Unlatch the two clips holding the two halves of the air box together and remove the front section and air box by tilting it towards the front of the car and lifting it up and out.



d. Unbolt the other section of the air box as shown.

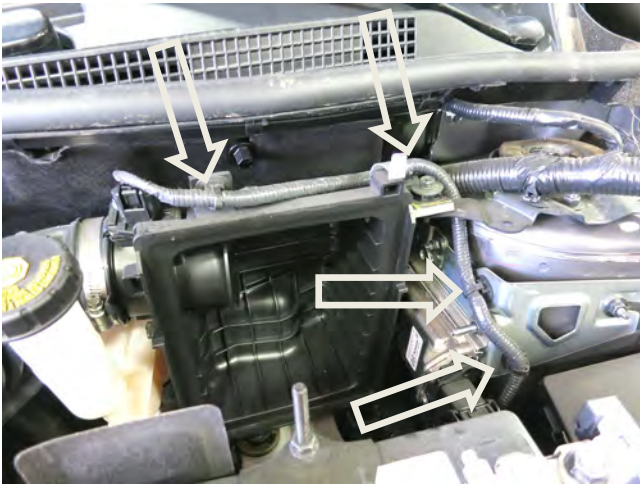

e. Unplug the Mass Air Flow (MAF) sensor harness and unclip the wire looms using a small flathead screwdriver to depress the tabs on the wire ties to release them from the air box.



f. Loosen the hose clamps on the throttle body and air box.



g. Using pliers, release the pressure on the spring clamp holding the vent hose to the engine and disconnect the vent hose from the engine. The two spring clamps will be reused in step 3m.



h. Remove the stock rubber air duct first, then remove the remaining section of air box by pulling it up and out of the engine bay.

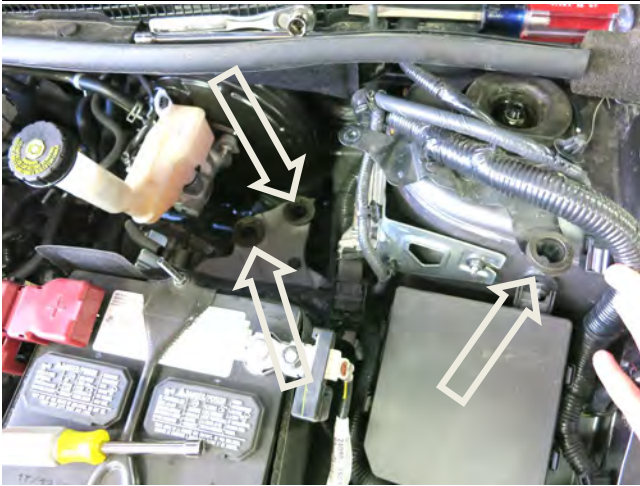

i. Remove the 3 rubber grommets that secured the air box and ducting and place them on the stock components for storage as they will not be reused.



j. Loosen the two bolts holding the resonator in the front fender well area where the plastic duct was removed. These bolts are difficult to see but relatively easy to access from the engine bay.

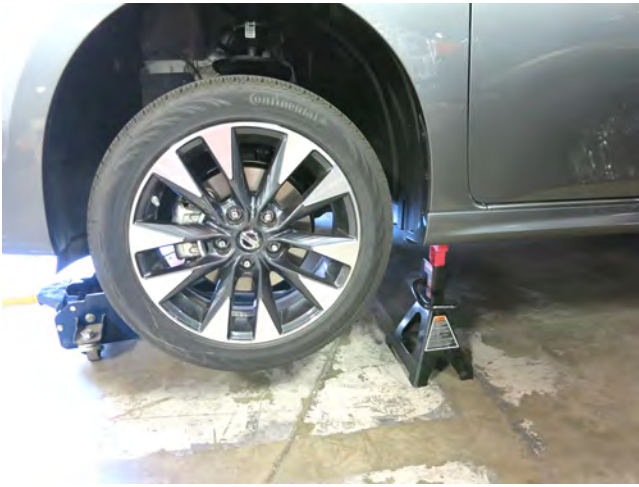

k. Break loose the lug nuts on the driver's side front wheel. Then, jack up the front of the vehicle and support it with jack stands. Then, completely loosen the lug nuts and remove the wheel.

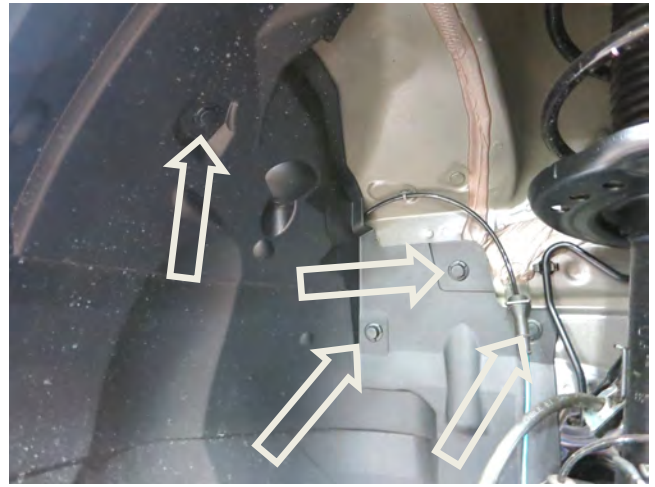

l. Remove the four pop outs shown in the inner fender well area.

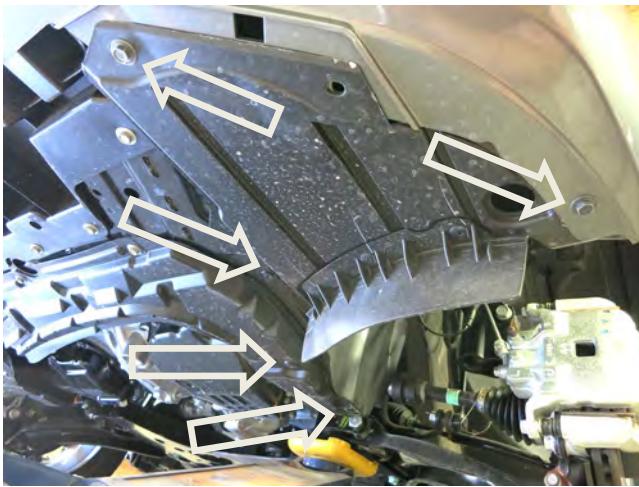

m. Remove the two bolts and three pop outs under the driver's side front corner of the bumper in the locations shown.



n. Lower the plastic fender liner to access the lower bolt securing the resonator and remove it.



o. Lower the plastic resonator out of the car as shown. Note: Do not discard any of your stock equipment.



p. Remove the MAF sensor from the stock air box. Note: These screws will be reused in step 3a.

3. Installation of AEM® intake system.

- a. When installing the intake system, do not completely tighten the hose clamps or mounting hardware until instructed to do so.



a. Install the MAF sensor into the AEM lower intake tube using the screws removed in step 2p.



b. Install the provided coupler and hose clamps onto the throttle body. Torque the throttle body side hose clamp to 30 in-lbs at this time.



c. Thread the male-to-male rubber isolator mount to the underside of the air box mount as shown.



d. Install the AEM upper intake tube as shown and secure the bracket to the isolator using the nut and washer provided.



e. Install the coupler to the end of the AEM upper intake tube as shown.

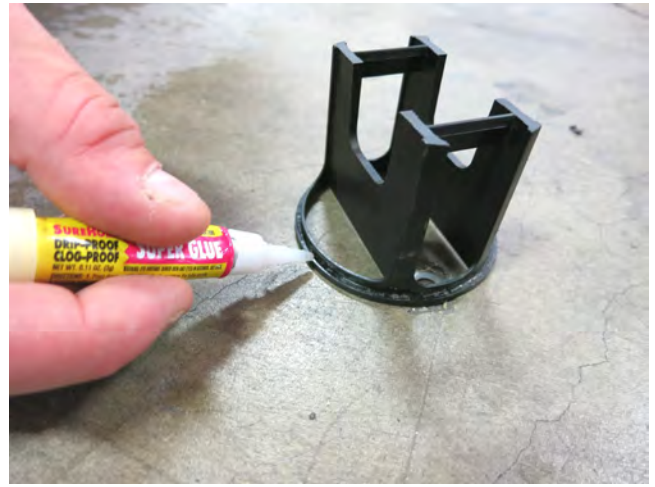

f. Apply the included super glue to the plastic air straightener as shown.



g. Quickly install the air straightener into the long end of the AEM lower intake tube aligning the vanes with the MAF sensor as shown. Refer to the exploded view for clarification.

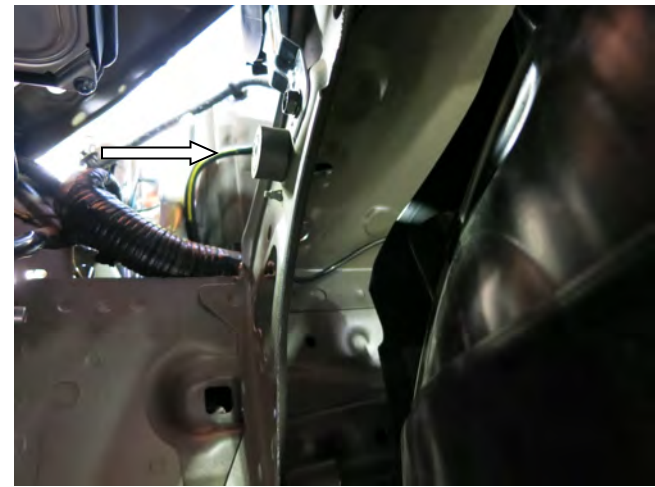

h. On 2015 and earlier models, Install the female to male rubber isolated onto the inner fender as shown. See step 3j for directions for 2016 and newer models



i. Install the AEM lower intake tube from the bottom of the car.



j. 2016 and newer models will require the use of the stainless steel offset bracket as shown. On all models secure the Intake tube bracket with the bolt and washer to the isolator. Note: the wiring harness that runs beneath the tube may need to be loosened and adjusted to fit properly.

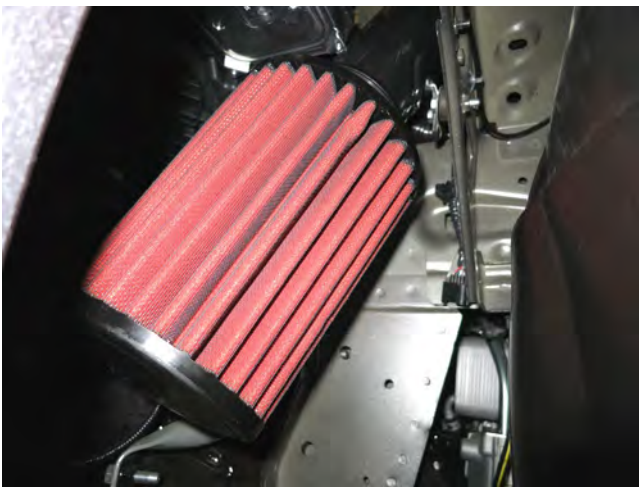

k. Install the AEM filter and torque the provided hose clamp to 30 in-lbs.



l. Route the MAF harness down to the MAF sensor and connect it as shown.



m. Using the spring clamps removed in step 2g, attach the provided vent hose from the engine to the AEM intake tube.

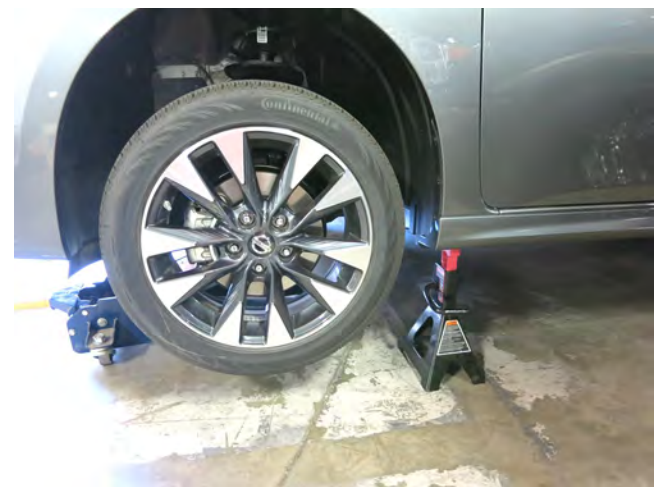

n. Torque all remaining hose clamps to 30 in-lbs, reinstall the engine cover, reassemble the fender liner, install wheel and torque lug nuts, and lower the vehicle.



STOCK INTAKE INSTALLED



AEM INTAKE INSTALLED

4. Reassemble Vehicle

- a. Position all kit components for best fitment. Ensure that no components contact any unintended part of the vehicle.
- b. Check for proper hood clearance. Re-adjust components if necessary and re-tighten them.
- c. Inspect the engine bay for any loose tools and ensure that all fasteners that were moved or removed are properly tightened.
- d. Reconnect negative battery terminal and start engine. Let the vehicle idle for 3 minutes. Perform a final inspection before driving the vehicle.

5. Service and Maintenance

- a. AEM Induction Systems requires cleaning the intake system's air filter element every 100,000 miles. When used in dusty or off-road environments, our filters will require cleaning more often. We recommend that you visually inspect your filter once every 25,000 miles to determine if the screen is still visible. When the screen is no longer visible some place on the filter element, it is time to clean it. To clean, purchase our Synthetic air filter cleaner, part number 1-1000 and follow the easy instructions.
- b. Use window cleaner to clean your powder coated AEM[®] intake tube.

NOTE: DO NOT USE aluminum polish on powder coated AEM[®] intake tubes.

For technical inquiries
e-mail us at
sales@aemintakes.com
or
call us at
800.992.3000

AEM Air Intake System Warranty Policy

AEM® warrants that its intake systems will last for the life of your vehicle. AEM® will not honor this warranty due to mechanical damage (i.e. improper installation or fitment), damage from misuse, accidents or flying debris. AEM® will not warrant its powder coating if the finish has been cleaned with a hydrocarbon-based solvent. The powder coating should only be cleaned with a mild soap and water solution. Proof of purchase of both the vehicle and AEM® intake system is required for redemption of a warranty claim.

This warranty is limited to the repair or replacement of the AEM® part. In no event shall this warranty exceed the original purchase price of the AEM® part nor shall AEM® be responsible for special, incidental or consequential damages or cost incurred due to the failure of this product. Warranty claims to AEM® must be transportation prepaid and accompanied with dated proof of purchase. This warranty applies only to the original purchaser of product and is nontransferable. Improper use or installation, use for racing, accident, abuse, unauthorized repairs or alterations voids this warranty. AEM® disclaims any liability for consequential damages due to breach of any written or implied warranty on all products manufactured by AEM®. Warranty returns will only be accepted by AEM® when accompanied by a valid Return Merchandise Authorization (RMA) number. Credit for defective products will be issued pending inspection. Product must be received by AEM® within 30 days of the date RMA is issued.

If you have a warranty issue, please call (800) 992-3000 and our customer service department will assist you. A proof of purchase is required for all AEM® warranty claims.

**INTAKE SYSTEMS FOR VEHICLES
LISTED ARE 50 STATE LEGAL. SEE
AEMINTAKES.COM FOR CARB STATUS ON
EACH PART FOR A SPECIFIC VEHICLE.**