



Equipped with AEM® Dryflow™ Filter  
No Oil Required!

# INSTALLATION INSTRUCTIONS

## PART NUMBER

### 21-810C (GUN METAL GRAY FINISH)

---

2016	SCION	iA (Manual Trans)	1.5L
2017	TOYOTA	YARIS iA (Manual Trans)	1.5L
2016	MAZDA	2 (Manual Trans)	1.5L

Not legal for sale or use on any pollution controlled motor vehicle in California or states adopting California emission procedures. See [AEMIntakes.com](http://AEMIntakes.com) for CARB status on each part for a specific vehicle.

ITEM NO.	PART NUMBER	DESCRIPTION	QTY.
1	21-2127DK	AIR FILTER; 2-3/4" X 5" OVAL DRYFLOW	1
2	2-1591C	INTAKE TUBE; 2.5" X 30.50"L, 21-810, GUNMETAL GRAY	1
3	08476	HOSE; 2-1/2" TO 2-1/4" ID X 2" L TPRD REINFORCED	1
4	9436	1/2" BNDHOSE CLAMP,1.81"-2.75"	1
5	9440	HOSE CLAMP, 2.15-3.00"	1
6	5-1002	HOSE; 3/8"ID X 2"L	1
7	1-1016	BOLT; HEX/FLANGE M6-1 X 30	1
8	08160	WASHER; 1"D X 1/4 HOLE FENDER	1
9	2-664	SPACER, 1.00 OD .348 ID X .625	1
10	7-359	BRACKET; CLUTCH LINE, SCION iA, MILD STL, TB/PC	1
11	8-197-1	EXTENSION HARNESS; 5 PIN 18" DENSO	1
12	1-113	ZIP TIE, 6" LONG	1
13	07733	BOLT; M4 - 0.07 8MM, A/H CAP, SS	2
14	9448	1/2" BNDHOSE CLAMP,2.56"-3.50"	1

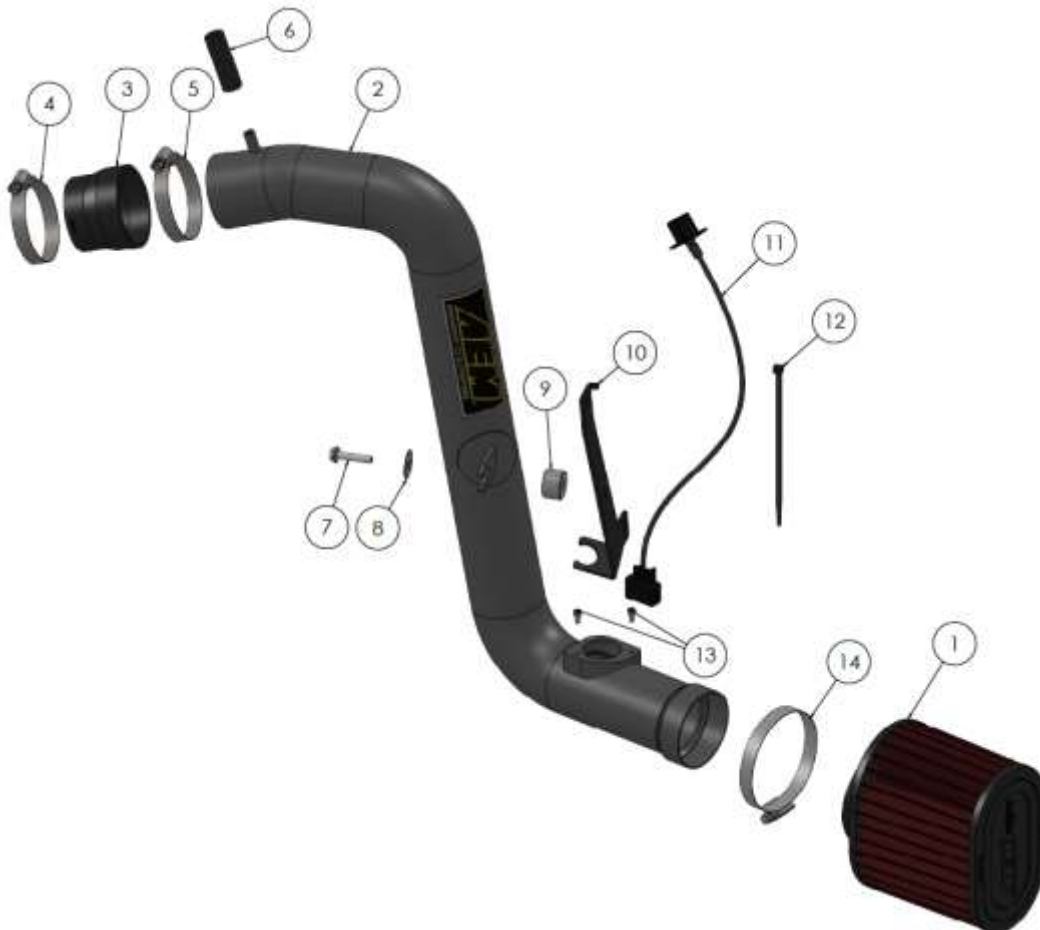

Read and understand these instructions **BEFORE** attempting to install this product. Failure to follow installation instructions and not using the provided hardware may damage the intake tube, throttle body and engine. If you need any assistance please call 1-800-858-3333 to speak with a representative in our Customer Service Center before returning the product.

## 1. Preparing Vehicle

- a. Make sure vehicle is parked on level surface.
- b. Set the parking brake.
- c. If engine has run in the past two hours, let it cool down.
- d. Disconnect negative battery terminal.
- e. Do not discard stock components after removal of the factory system.
- f. Open the air intake kit package and make sure all parts are included.

### Tools Needed:

Screwdriver  
7mm, 8mm, 10mm  
Socket

### Optional:

Small Torque  
Wrench

Socket Driver/  
Ratchet

Side Cutters

3mm Hex Key

## 2. Removal of stock system



a. Carefully pull up on the engine cover and remove it.



b. Unplug the harness from the MAF (Mass Air Flow) sensor.



c. Use a 7mm socket and ratchet to loosen the throttle body hose clamp. Then, pull the PCV line out from the nipple on the intake hose.



d. Use a 10mm socket and ratchet to remove the (2) M6 bolts holding the intake snorkel to the radiator shroud. Do not discard any factory hardware.



e. Release the spring clamps holding the stock air box halves together.



f. Pull the intake hose off of the throttle body and flip the upper air box around. Then, unclip the MAF sensor harness from the upper air box.



g. Remove the upper air box and intake hose assembly from the vehicle. Do not discard any factory components.



h. Pull up on the lower air box and snorkel assembly and remove it from the vehicle. Do not discard any factory components.



i. Use a 10mm socket and ratchet to remove the alternator harness bracket from the frame rail. Do not discard any factory components.



j. Unclip the harness from the bracket.



k. Use a small flathead screw driver to release the harness clip from the harness. You will reattach this in step 3e.



l. Use a 10mm socket and ratchet to remove the clutch hardline bracket. You will reuse the M6 bolt in step 3d.



m. Remove the bracket from the clutch hardline grommet. Do not discard any factory components.



n. Remove the (2) Phillips head screws holding the MAF sensor to the upper air box. Then, remove the MAF sensor. The MAF sensor will be reused with the AEM intake system.

### 3. Installation of AEM® intake system.

- a. When installing the intake system, do not completely tighten the hose clamps or mounting hardware until instructed to do so.



a. Install the MAF sensor to the AEM intake tube with the (2) supplied M4 bolts.



b. Install the tapered coupler onto the throttle body, making sure the smaller end goes onto the throttle body. Use the supplied #36 hose clamp to tighten the coupler onto the throttle body to 30 in-lbs.



c. Install the supplied aluminum spacer, washer, and bolt onto the threaded hole where the alternator harness bracket was removed in step 2i. Leave the assembly loose.



d. Install the supplied clutch hardline relocation bracket using the M6 bolt removed in step 2i. Make sure the alignment tab rests in the cutout on the frame rail.



e. Attach the alternator harness clip, removed in step 2k, to the bracket as shown. Then, attach the alternator harness to the clip.



f. Attach the clutch hardline to the bracket. Make sure the grommet seats completely into the cutout in the bracket.



g. Insert the AEM intake tube into the throttle body coupler. Then, line the bracket up to the aluminum spacer. Do not tighten the remaining throttle body hose clamp or aluminum spacer bolt at this time.



h. Remove the (3) fender liner screws using an 8mm socket and ratchet.



i. Pull the fender liner away and install the AEM filter with hose clamp onto the AEM intake tube. Orient the filter so that it does not push against the fender liner and tighten hose clamp.



j. Re-secure the fender liner. Then, make final adjustments to the positioning of the intake tube so that there is no interference with its surroundings. Then, tighten the remaining throttle body hose clamp and bolt on the aluminum spacer.



k. Connect the supplied MAF harness extension to the MAF sensor. Then connect the other end to the MAF harness on the vehicle.



l. Use the supplied zip tie to tie the MAF sensor harness to the main fuse box harness.



m. Install the supplied 3/8" hose onto the intake tube nipple.



n. Insert the PCV line into the hose. Finally, reinstall the engine cover.





STOCK INTAKE INSTALLED



AEM INTAKE INSTALLED

#### 4. Reassemble Vehicle

- a. Position all kit components for best fitment. Ensure that no components contact any unintended part of the vehicle.
- b. Check for proper hood clearance. Re-adjust components if necessary and re-tighten them.
- c. Inspect the engine bay for any loose tools and ensure that all fasteners that were moved or removed are properly tightened.
- d. Reconnect negative battery terminal and start engine. Let the vehicle idle for 3 minutes. Perform a final inspection before driving the vehicle.

#### 5. Service and Maintenance

- a. AEM Induction Systems requires cleaning the intake system's air filter element every 100,000 miles. When used in dusty or off-road environments, our filters will require cleaning more often. We recommend that you visually inspect your filter once every 25,000 miles to determine if the screen is still visible. When the screen is no longer visible some place on the filter element, it is time to clean it. To clean, purchase our Synthetic air filter cleaner, part number 1-1000 and follow the easy instructions.
- b. Use window cleaner to clean your powder coated AEM<sup>®</sup> intake tube.

**NOTE: DO NOT USE aluminum polish on powder coated AEM<sup>®</sup> intake tubes.**

For technical inquiries  
e-mail us at  
[sales@aemintakes.com](mailto:sales@aemintakes.com)  
or  
call us at  
800.992.3000

## **AEM Air Intake System Warranty Policy**

AEM® warrants that its intake systems will last for the life of your vehicle. AEM® will not honor this warranty due to mechanical damage (i.e. improper installation or fitment), damage from misuse, accidents or flying debris. AEM® will not warrant its powder coating if the finish has been cleaned with a hydrocarbon-based solvent. The powder coating should only be cleaned with a mild soap and water solution. Proof of purchase of both the vehicle and AEM® intake system is required for redemption of a warranty claim.

This warranty is limited to the repair or replacement of the AEM® part. In no event shall this warranty exceed the original purchase price of the AEM® part nor shall AEM® be responsible for special, incidental or consequential damages or cost incurred due to the failure of this product. Warranty claims to AEM® must be transportation prepaid and accompanied with dated proof of purchase. This warranty applies only to the original purchaser of product and is nontransferable. Improper use or installation, use for racing, accident, abuse, unauthorized repairs or alterations voids this warranty. AEM® disclaims any liability for consequential damages due to breach of any written or implied warranty on all products manufactured by AEM®. Warranty returns will only be accepted by AEM® when accompanied by a valid Return Merchandise Authorization (RMA) number. Credit for defective products will be issued pending inspection. Product must be received by AEM® within 30 days of the date RMA is issued.

If you have a warranty issue, please call (800) 992-3000 and our customer service department will assist you. A proof of purchase is required for all AEM® warranty claims.

**Not legal for sale or use on any pollution controlled motor vehicle in California or states adopting California emission procedures. See [AEMIntakes.com](http://AEMIntakes.com) for CARB status on each part for a specific vehicle.**