



advanced FLOW engineering

Instruction Manual P/N: 46-20416-B

BladeRunner – Turbo Muffler Delete For OE Tubes

Make: **Volkswagen** Model: **GTI** Year: **2015-2020** Engine: **L4 – 2.0L(t)**

Make: **Volkswagen** Model: **Golf R** Year: **2015-2019** Engine: **L4 – 2.0L(t)**

Make: **Volkswagen** Model: **Jetta GLI** Year: **2019-2020** Engine: **L4 – 2.0L(t)**

Make: **Audi** Model: **A3** Year: **2015-2020** Engine: **L4 – 2.0L(t)**

Make: **Audi** Model: **S3** Year: **2015-2020** Engine: **L4 – 2.0L(t)**



- Please read the entire instruction manual before proceeding.
- Ensure all components listed are present.
- If you are missing any of the components, call customer support at 951-493-7100.
- Ensure you have all necessary tools before proceeding.
- Do not attempt to work on your vehicle when the engine is hot.
- Disconnect the negative battery terminal before proceeding.
- Retain factory parts for future use.

Label	Qty.	Description	Part Number
A	1	Adaptor, Turbo Outlet: 46-20414	05-61104-1
B	1	Flange, Turbo Outlet: 46-20414	05-61104-2
C	1	O-Ring, Buna-N (-226)	05-61036
D	1	Coupling, Silicone 2.50" X 1.875" X 15 Deg	05-61113
E	1	Clamp, Spring Loaded T-Bolt: 2.06"	03-50613
F	1	Clamp, Spring Loaded T-Bolt: 2.50"	03-50560
G	3	Screw, M6x1.0x20	03-50241
H	3	Washer, M6	03-50177

Installation will require the following tools:

T30 socket, 7mm socket, 7/16" deep socket, 5mm allen wrench, 6" extension, ratchet, pick, flat head screwdriver

Note: Legal in California for use on race vehicles only. The use of this device on vehicles used on public streets or highways is strictly prohibited in California and others states that have adopted California emission regulations

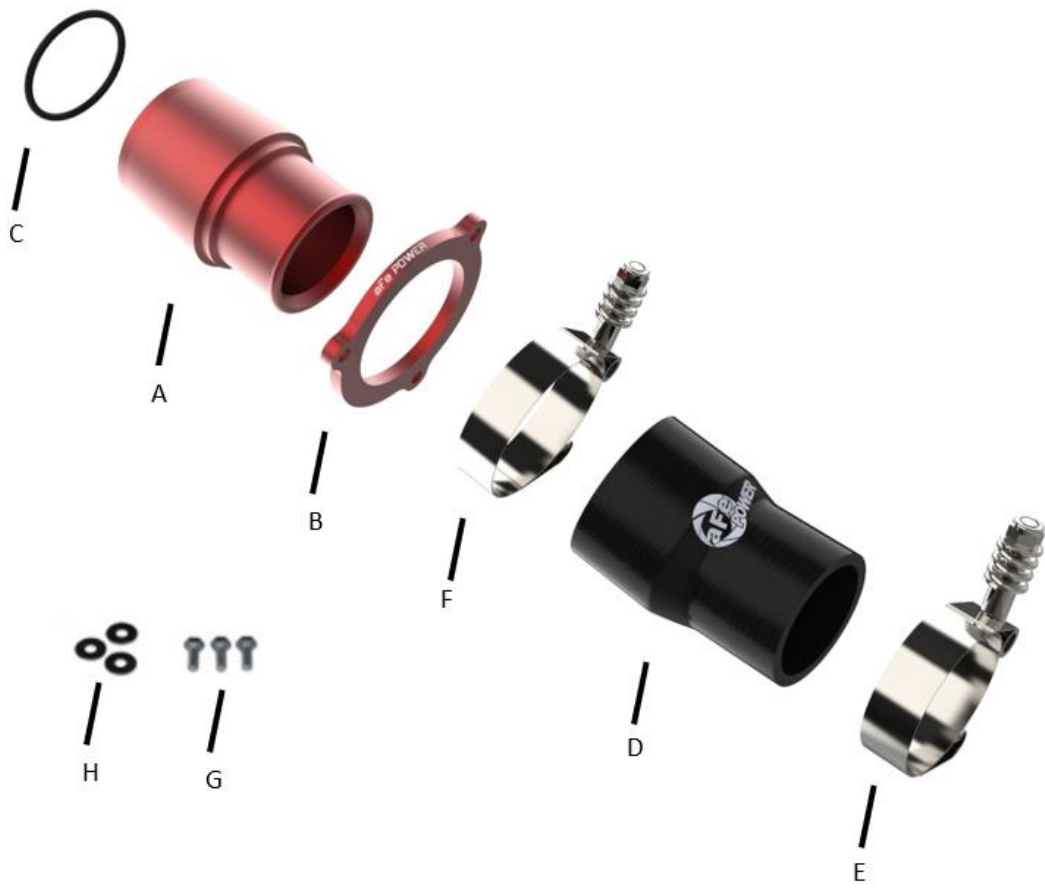

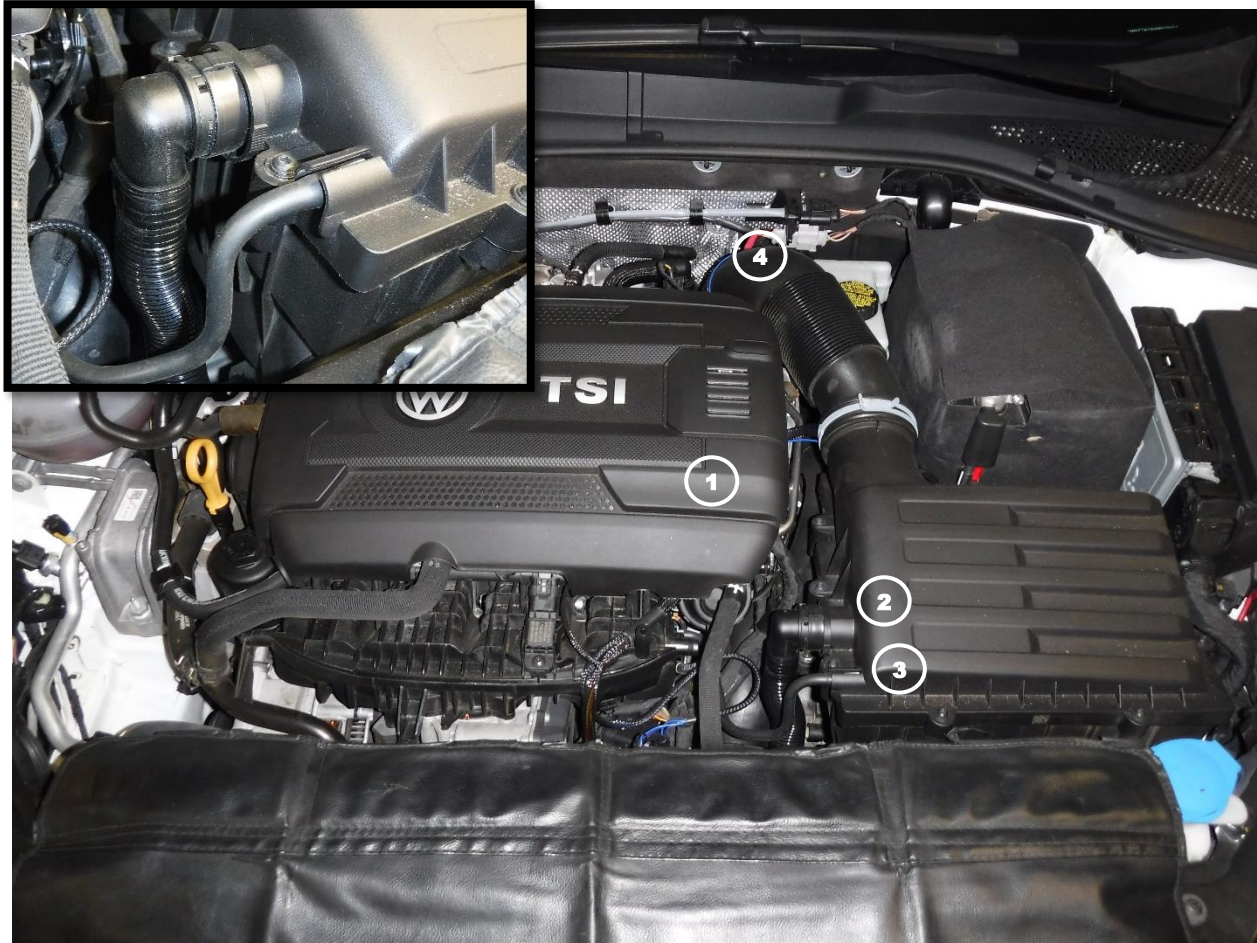

1. Park vehicle on level ground and engage the parking brake.
2. Disconnect the negative battery cable.
3. Remove the engine cover ① by lifting straight up on it from all four (4) corners.
4. Disconnect the blow off valve recirculation hose ② by squeezing on the raised sides at the same time and pull it off of the air intake box.
5. Disconnect the vacuum hose ③ from the air intake box
6. Loosen the clamp securing the air intake tube onto the turbo inlet tube ④
7. Remove the intake tube and box from the vehicle together by lifting the air box straight up out of its mounting grommets.



8. Unclip three (3) clips securing the wire harness to the factory hot side intercooler tube (5).
9. Remove the screw securing the hot side intercooler tube onto the engine (6).



10. Loosen the two (2) clamps securing the hot side intercooler tube onto the turbo outlet (7).

11. Remove the coupling (8) from the vehicle.

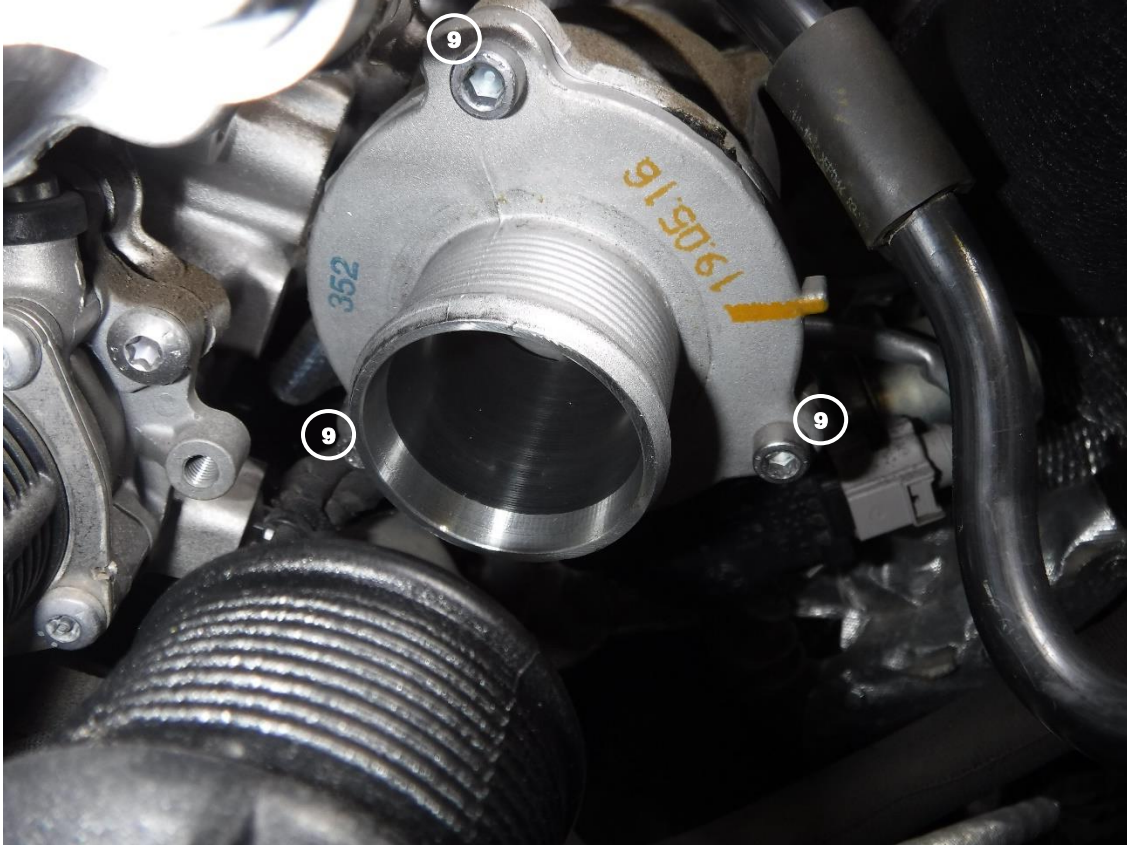

Note: Be sure not to misplace the O-ring on the back side of the turbo muffler

12. Remove the three (3) screws securing the turbo muffler onto the turbo ⑨
13. Remove the turbo muffler from the vehicle.

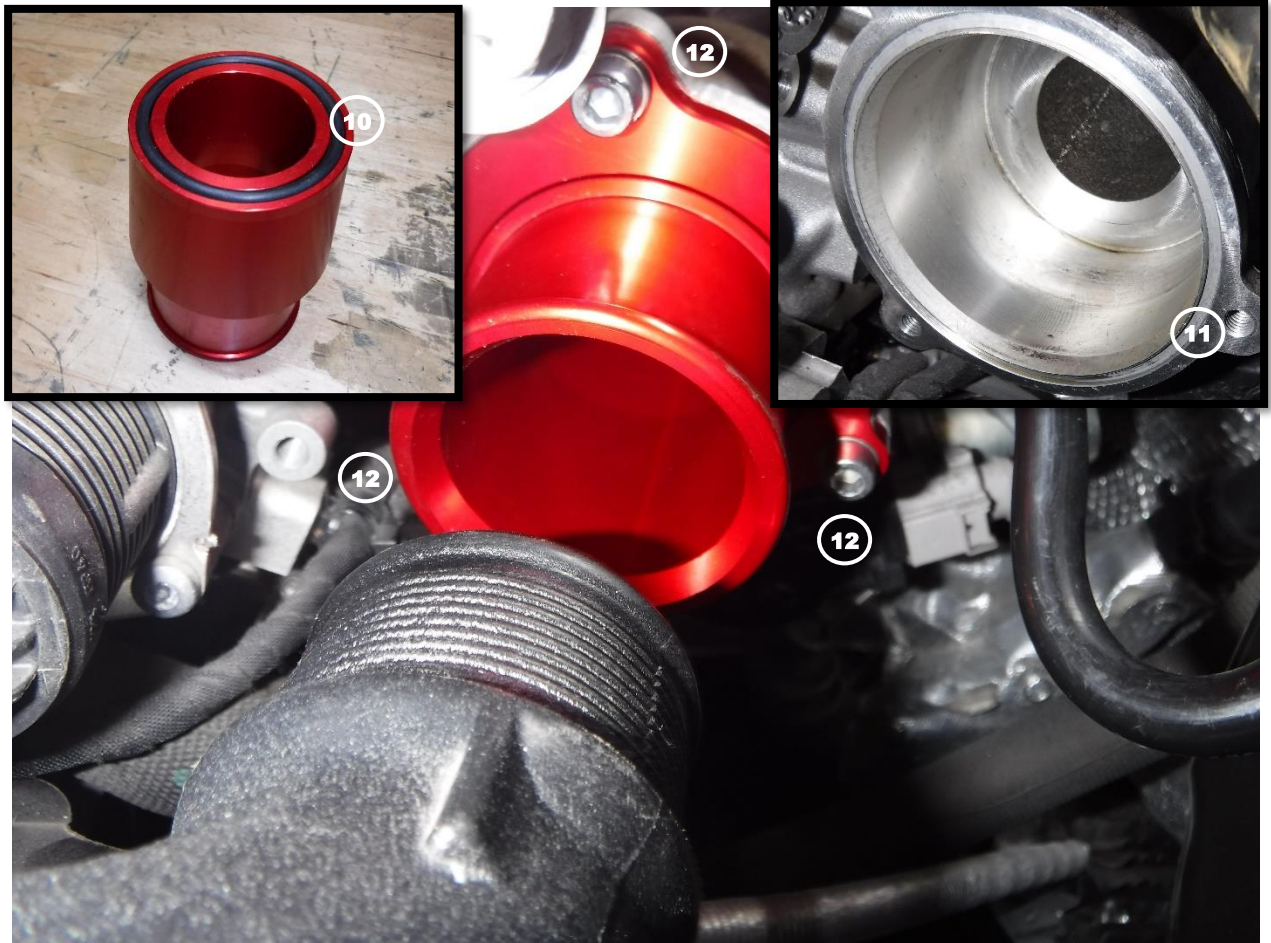

Note: Be sure to lubricate the O-ring with grease prior to installation.

14. Install the supplied -226 O-ring (10) into the groove on the back side of aFe turbo outlet adapter.
15. Ensure the factory O-ring is in its proper location on the turbo outlet (11).
16. Install the aFe turbo flange over the aFe turbo adapter and carefully maneuver the assembly into the turbo outlet and secure it to the turbo using the three (3) supplied M6x1x20 screws and washers (12).

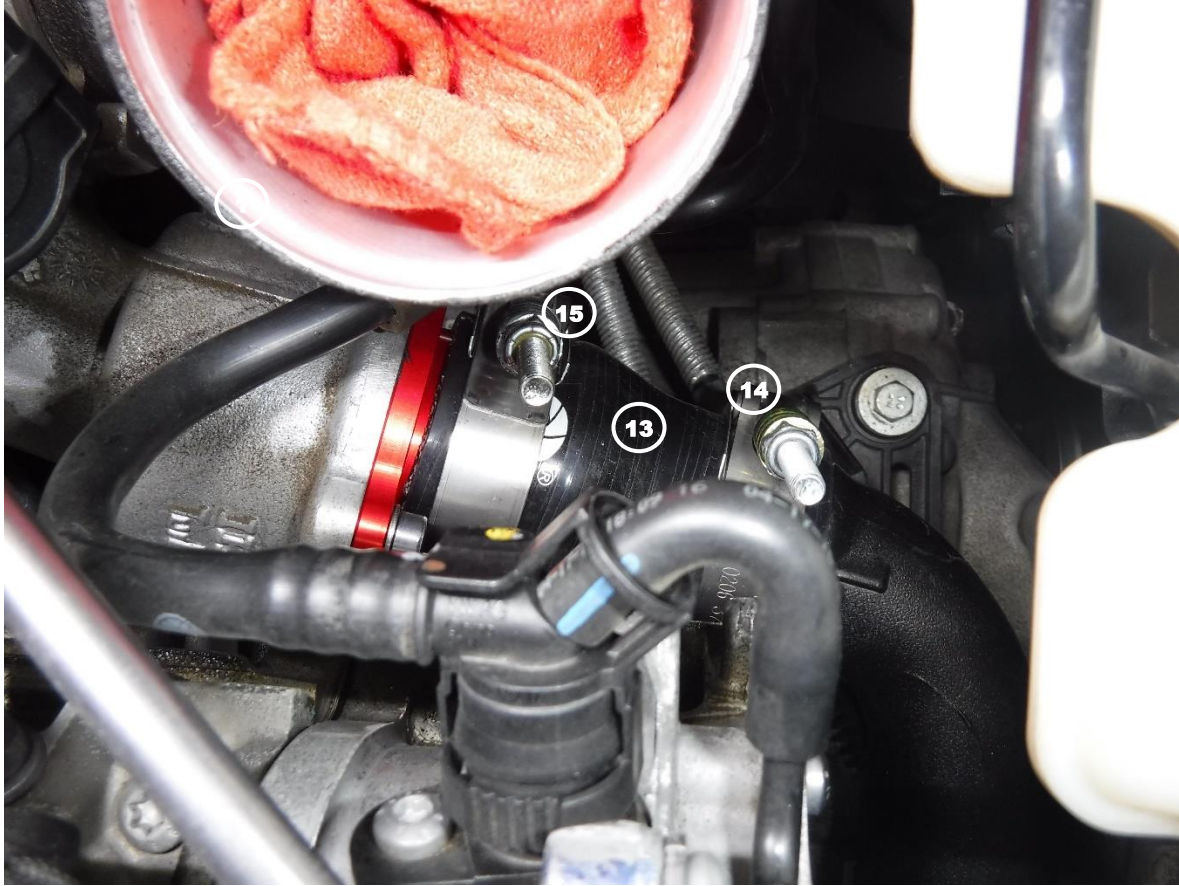

17. Install the aFe silicone 2.50" X 1.875" X 15 Deg coupling (13) and the 2.06" spring-loaded t-bolt clamp (14) onto the end of the factory hot side tube, do not tighten the clamp yet.
18. Install the coupling from the previous step onto the turbo outlet along with the supplied 2.50" spring-loaded t-bolt clamp (15) do not tighten the clamp yet.
19. Ensure the factory hot side intercooler tube is not touching any metal surfaces.
20. Secure factory hot side intercooler tube to the engine using the factory hardware from step 9.
21. Tighten all of the clamps.

Warranty

General Terms:

- aFe warrants their products to be free from manufacturer’s defects due to workmanship and material.
- This warranty applies only to the original purchaser of the product and is non-transferrable.
- Proof of purchase of the aFe product is required for all warranty claims.
- Warranty is valid provided aFe instructions for installation and/or cleaning were properly followed.
- Proper maintenance with regular inspections of product is required to insure warranty coverage.
- Damage due to improper installation, abuse, unauthorized repair or alteration is not warranted.
- Incidental or consequential damages or cost, including installation and removal of part, incurred due to failure of aFe product is not covered under this warranty.
- All warranty is limited to the repair and/or replacement of the aFe part. To request Return Goods Authorization (“RGA”), email RGA@afepower.com or call (951)493-7100. Upon receipt of the RGA, you must return the product to the address provided in the RGA, freight prepaid and accompanied with a dated proof of purchase and the RGA. Upon receipt of the defective product and upon verification of proof of purchase, aFe will either repair or replace the defective product within a reasonable time, not to exceed thirty days.

<u>Product Category</u>	<u>P/N Prefix</u>	<u>Warranty duration</u>
Direct OE Replacement Filters	10, 11, 30, 31, 71, 73	Life of the vehicle
Racing Filters	18	1 year
Universal	21, 24, 72	2 years
Air Intake Systems	50, 51, 54, 55, 75	2 years
Exhaust Systems	49	2 years
Intercoolers & Intercooler Tubes	46-2	2 years
Intake Manifolds	46-1	2 years
Differential Cover	46-7	Life of the vehicle
Transmission Pans / Oil Pans	46-7	Life of the vehicle
Turbochargers	46-6	2 years
Exhaust Manifolds	46	2 years
Throttle Body Spacers	46-3	2 years
Fluid Filters	44	90 days
Pre-Filters	28	2 years
Heavy Duty OE Replacement	70	2 years
PowerSports OE Replacement	81,87	2 years
PowerSports Intake Systems	85	2 years

No other warranty expressed or implied applies nor is any person or advanced FLOW engineering authorized to assume any other warranty. Some States do not allow the exclusion or limitation of incidental or consequential damages or do not allow limitations on how long an implied warranty lasts, so the above limitations or exclusions may not apply to you. This warranty gives you specific legal rights, and you may also have other rights which vary from State to State.



advanced FLOW engineering, inc.

252 Granite Street Corona, CA 92879

TEL: 951.493.7100 • TECH: 951.493.7100 x23

E-Mail: Tech@aFepower.com