

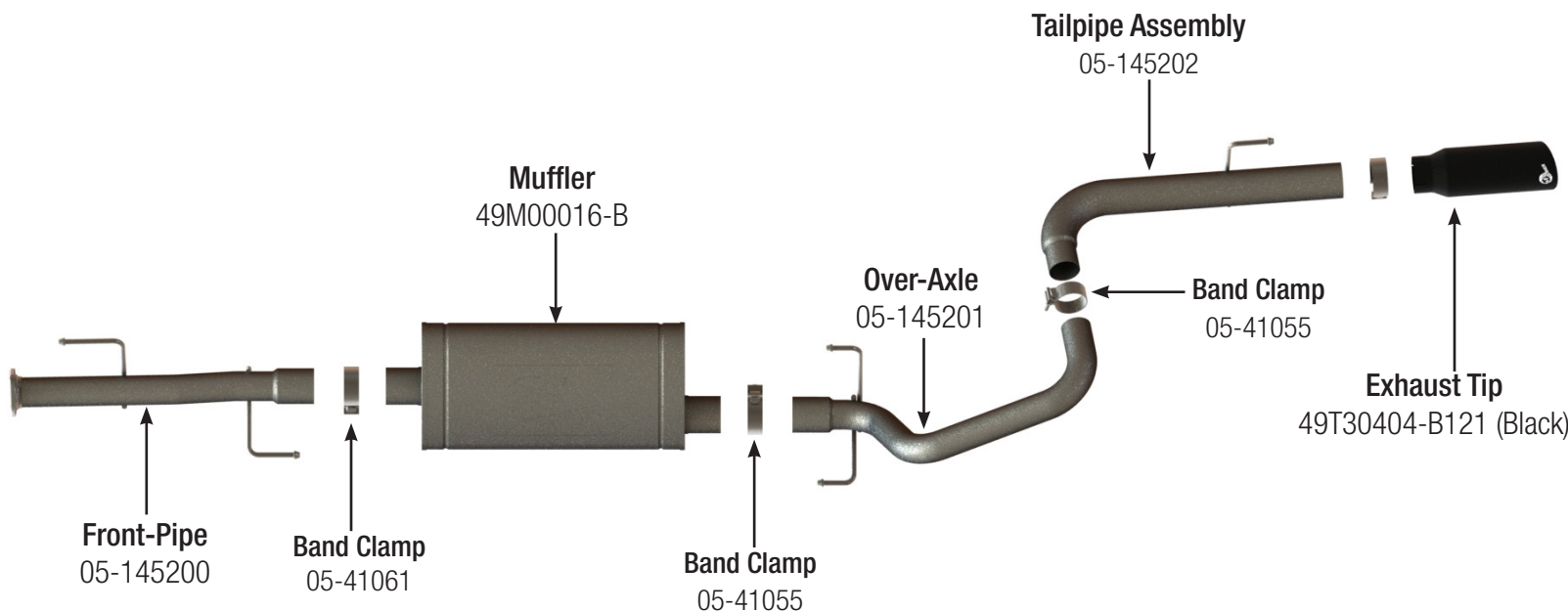

INSTALLATION INSTRUCTIONS

MAKE: Toyota
MODEL: 4Runner
YEAR: 2010-2019
ENGINE: V6-4.0L

Cat-Back
304 Stainless Steel
49-36040-B (Black)



Professional installation is highly recommended. (Read instructions prior to installation). Make sure to always have at least (2) stands or jacks on hand to support the removal of OE system. Also for the installation of aFe system. Any Removal of rubber isolation mounts may require using a spray lubricant such as WD40 and a pry bar.

- Step 1:** (Read instructions prior to installation.) Remove your stock exhaust up to the catalytic converter from the rear of your vehicle, working your way forward. Take caution not to damage the factory hardware and isolation mounts as they will be reused. (It is recommended to not fully tighten the clamps until the entire system has been installed.)
- Step 2:** For faster installation, spread the pieces of the exhaust alongside of your vehicle according to the diagram shown above.
- Step 3:** Install the front pipe onto the stock y-pipe using the stock bolts, gaskets, and factory isolation mounts. Install the muffler assembly. (Use a jack stand to support the muffler assembly.)
- Step 4:** Install the over axle pipe into the muffler assembly.
- Step 5:** Install the tailpipe into the over-axle assembly.
- Step 6:** Place the tailpipe and tip at desired position, do not fully tighten.
- Step 7:** Adjust and straighten out the exhaust. You can now begin to tighten down your exhaust, beginning at the front flange and working your way back.
- Step 8:** Your installation is now complete. It is recommended to re-tighten all exhaust components after 50 - 100 miles.

NOTE: Does not fit 4Runners equipped with Kinetic Dynamic Suspension System (KDSS). KDSS was an option on 2010-Present Toyota 4Runner Trail Edition and TRD Off-Road. To determine if you have KDSS, look at the rear sway bar on the drivers side and look for a hydraulic actuator connecting the sway bar to the chassis. If the actuator is present, your vehicle has KDSS, and the exhaust system will not fit.

Caution: Allow time for your vehicle to cool down prior to installation. When working on or under your vehicle proceed with caution. Exhaust systems reach high temperatures and may cause serious burns. Wear protective safety equipment; eye goggles and gloves to ensure a safe installation. **aFe recommends professional installation on our products.**



INSTALLATION INSTRUCTIONS

MAKE: Toyota
MODEL: 4Runner
YEAR: 2010-2019
ENGINE: V6-4.0L

Cat-Back
304 Stainless Steel
49-36040-P (Polished)

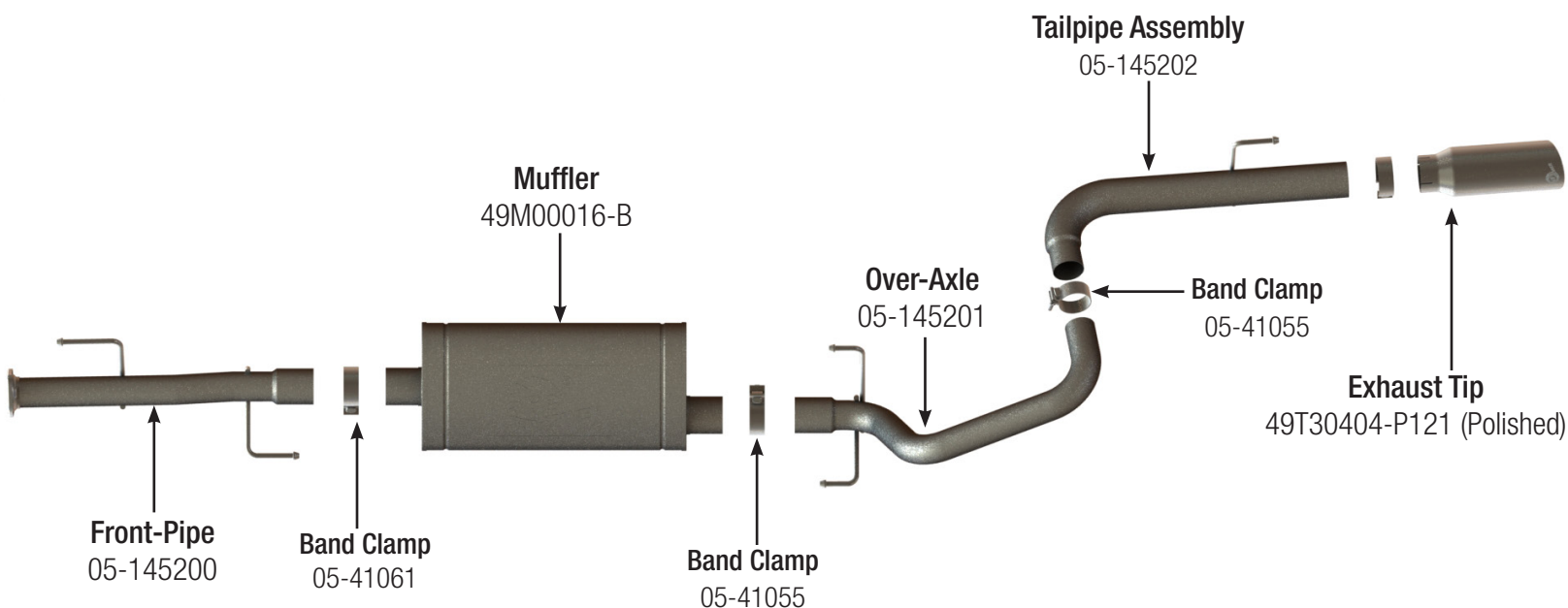

Professional installation is highly recommended. (Read instructions prior to installation). Make sure to always have at least (2) stands or jacks on hand to support the removal of OE system. Also for the installation of aFe system. Any Removal of rubber isolation mounts may require using a spray lubricant such as WD40 and a pry bar.

- Step 1:** (Read instructions prior to installation.) Remove your stock exhaust up to the catalytic converter from the rear of your vehicle, working your way forward. Take caution not to damage the factory hardware and isolation mounts as they will be reused. (It is recommended to not fully tighten the clamps until the entire system has been installed.)
- Step 2:** For faster installation, spread the pieces of the exhaust alongside of your vehicle according to the diagram shown above.
- Step 3:** Install the front pipe onto the stock y-pipe using the stock bolts, gaskets, and factory isolation mounts. Install muffler assembly. (Use a jack stand to support the muffler assembly.)
- Step 4:** Install the over axle pipe into the muffler assembly.
- Step 5:** Install the tailpipe into the over-axle assembly.
- Step 6:** Place the tailpipe and tip at desired position, do not fully tighten.
- Step 7:** Adjust and straighten out the exhaust. You can now begin to tighten down your exhaust, beginning at the front flange and working your way back.
- Step 8:** Your installation is now complete. It is recommended to re-tighten all exhaust components after 50 - 100 miles.

NOTE: Does not fit 4Runners equipped with Kinetic Dynamic Suspension System (KDSS). KDSS was an option on 2010-Present Toyota 4Runner Trail Edition and TRD Off-Road. To determine if you have KDSS, look at the rear sway bar on the drivers side and look for a hydraulic actuator connecting the sway bar to the chassis. If the actuator is present, your vehicle has KDSS, and the exhaust system will not fit.

Caution: Allow time for your vehicle to cool down prior to installation. When working on or under your vehicle proceed with caution. Exhaust systems reach high temperatures and may cause serious burns. Wear protective safety equipment; eye goggles and gloves to ensure a safe installation. **aFe recommends professional installation on our products.**