



advanced FLOW engineering™
 P.O. Box 1719
 Corona, CA 92878
 Support: 951-493-7100
 aFepower.com

Intake Kit Installation Instructions: 2008 Pontiac G8 GT V8-6.0L Stage 2

Kit P/N: 51/54-11582	Tools Required: 5/16" nut driver 9/32" nut driver Flat head screwdriver Phillips screwdriver 10mm socket or wrench Ratchet w/extension T27 Torx bit 5/32" allen key	Parts List: 1 Air filter (Pro-5R™ 24-91040 or Pro Dry S™ 21-90053) 1 Housing 1 Tube 2 Coupler, Reducer (05-00020) 1 Coupler, Straight (05-00421) 4 Clamp, #064 2 Clamp, #072 1 3/4" trim seal @ 18" L	2 Screw, M6 x1 x 20 2 Washer, flat M6 1 3/8" hose @ 15"L 2 Washer, wavy M6 1 Grommet 1 Fitting, elbow 3/8" 1 Adaptor, filter 3 Screws, button head M6
-----------------------------	--	---	--



Complete Kit w/ Parts

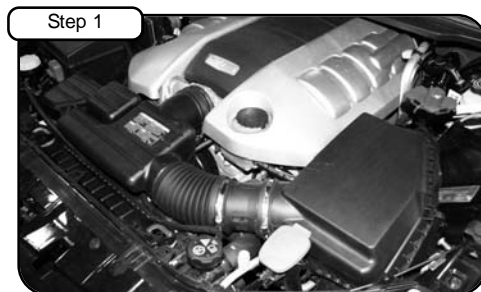

Step 1

Complete Stock Intake.
 Disconnect battery before install.

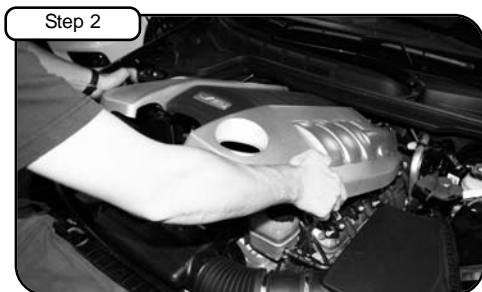

Step 2

Remove engine cover by lifting up front of cover and pulling up.

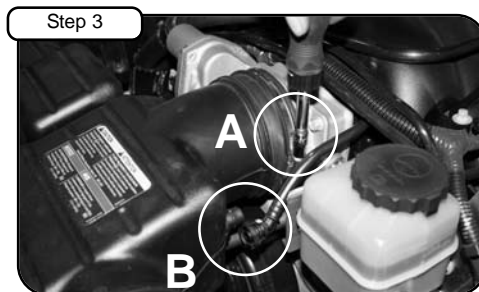

Step 3

A) Loosen clamp at Throttle Body w/ 9/32" nut driver.
 B) Disconnect crankcase line from tube.

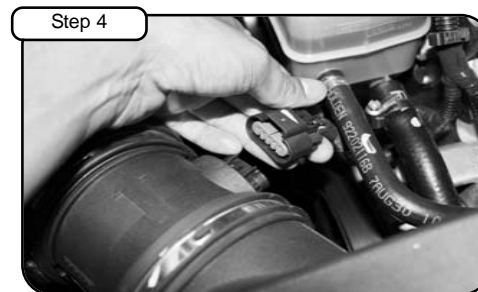

Step 4

Disconnect MAF sensor harness.



Step 5

Un-clip upper half of air box.



Step 6

Remove tube/sensor/upper air box in one piece. Remove stock air filter.

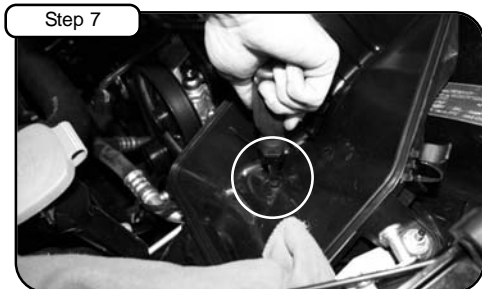

Step 7

Loosen bolt on bottom of air box with T27 torx bit and remove.

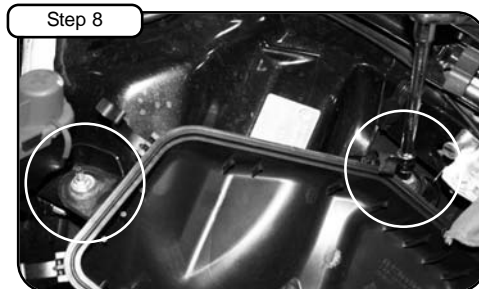

Step 8

With 10mm socket or wrench loosen the 2 nuts holding in bottom of air box. Save one nut for later install (see step 17). Pull air box out and remove.

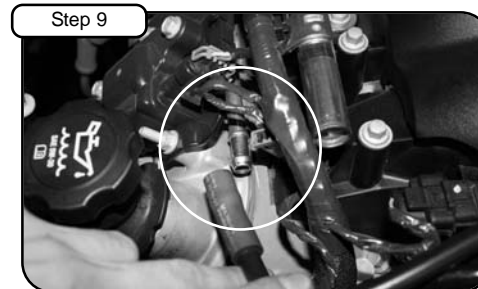

Step 9

Remove stock crankcase line from engine.



Step 10

Replace crankcase line with new 3/8" hose provided to engine and position like factory hose from step 9.

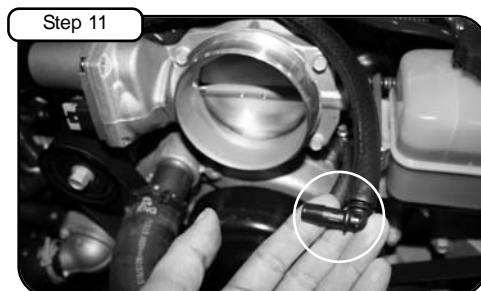

Step 11

Attach 3/8" fitting to new hose.

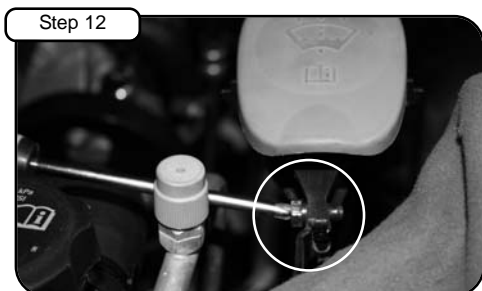

Step 12

With 10mm wrench or phillips screwdriver loosen and remove bolt holding in washer reservoir (see step 15).

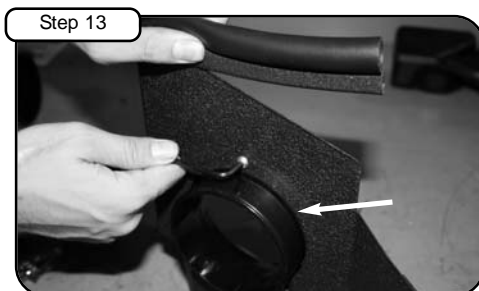

Step 13

Attach trim seal to housing and install adaptor to housing using button head screws provided. Tighten using 5/32" allen key.

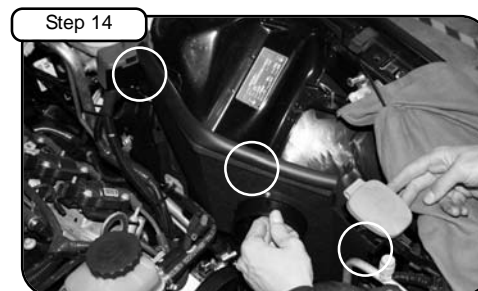

Step 14

Install housing into vehicle and position the three tabs.

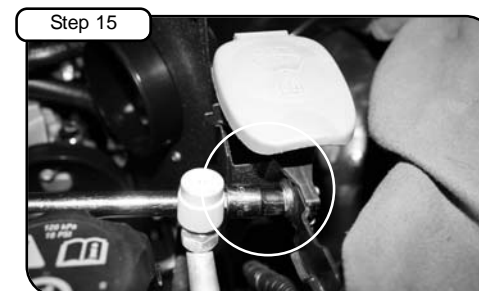

Step 15

With new screw, wavy & flat washers provided, tighten down housing tab to washer reservoir.

Turn page over and continue to page 2 →



advanced FLOW engineering™
 P.O. Box 1719
 Corona, CA 92878
 Support: 951-493-7100
aFepower.com

Intake Kit Installation Instructions: 2008 Pontiac G8 GT V8-6.0L Stage 2

Accessories Available:



Restore Kits

90-50001 Blue Aerosol
 90-50501 Blue Squeeze
 90-59999 Pro Dry S™ Cleaner

Replacement Air Filter:



Pro-5R™ 24-91040
 Blue Media



Pro Dry S™ 21-90053
 White Media

Note: Filter Cleaning and Re-oiling: When cleaning your aFe filter, be sure to use only aFe's "Restore Kit" (aFe P/N: 90-50001 blue oil aerosol, aFe P/N: 90-50501 blue squeeze bottle oil, aFe P/N: 90-59999 Pro Dry S™ cleaner only.) **Pro Dry S™** cleaning: see cleaning instruction sheet 06-00074. For replacement part(s) or "Restore Kit" please call aFe sales/tech support @ 951-493-7100

Step 16

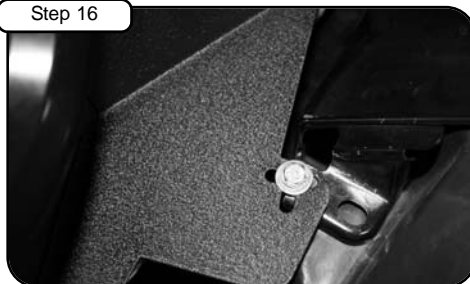

With new screw, wavy & flat washers provided tighten down bottom of housing with 10mm socket or wrench.

Step 17



Use nut from step 8, tighten down housing tab with 10mm socket or wrench.

Step 18

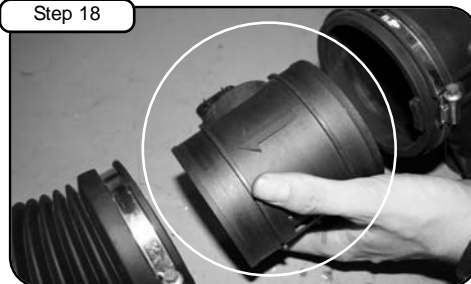

Remove MAF sensor from stock intake.

Step 19

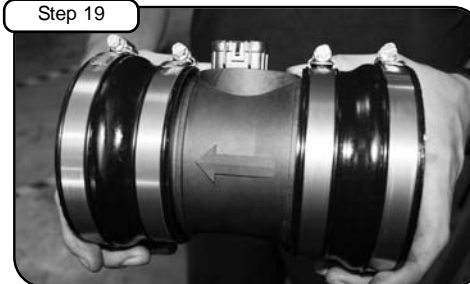

Attach reducer couplers (05-00020) to MAF sensor with clamps provided.

Step 20

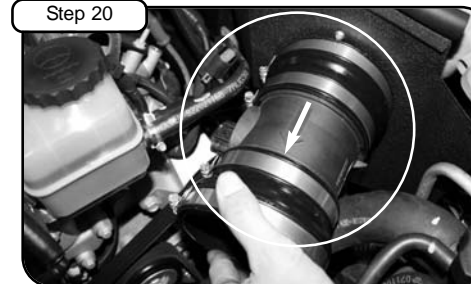

Install to filter adaptor on housing. Make sure **ARROW** on sensor is in direction towards Throttle Body.

Step 21



With straight coupler (05-00421) and clamps provided attach to end of tube. Attach grommet to hole on tube.

Step 22

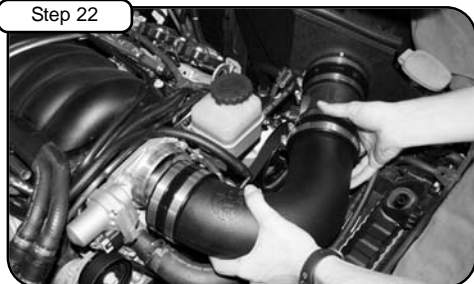

Install and position to Throttle Body and MAF sensor.

Step 23

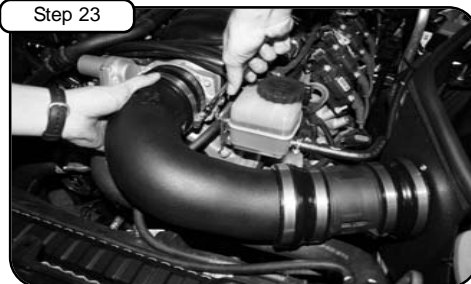

Tighten tube all clamps using 5/16" nut driver.

Step 24



Install 3/8" fitting to grommet on tube.

Step 25



Install air filter to adaptor and tighten using 5/16" nut driver.

Step 26

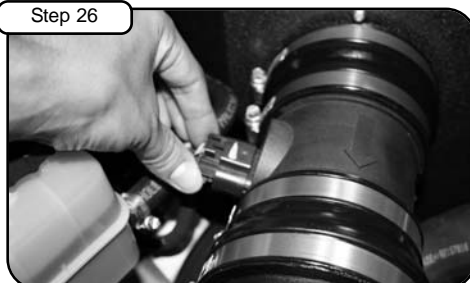

Re-connect MAF sensor harness.

Step 27



Re-install engine cover. Re-connect battery.

Step 28



Your installation is now complete. Make sure you tighten all clamps and check all electrical connections periodically. Thank you for choosing aFe!