

***advanced FLOW engineering***

Cold Air Intake System

**Instruction Manual** P/N: 51-74102 / 54-74102

Make: Chevrolet / GMC Model: Trucks / SUVs Year: 07-08 Engine: V8-4.8L / 5.3L / 6.0L / 6.2L



- Please read the entire instruction manual before proceeding.
- Ensure all components listed are present.
- If you are missing any of the components, call customer support at 951-493-7185.
- Ensure you have all necessary tools before proceeding.
- Do not attempt to work on your vehicle when the engine is hot.
- Retain factory parts for future use.

Label	Qty.	Description	Part Number
A	1	Air Filter (Pro DRY S) For 51-74102	21-91079
A	1	Air Filter (Pro 5R) For 54-74102	24-91079
B	1	Tube	05-00765
C	1	Housing	05-5074101B2
D	1	Coupling, MAF Sensor, (4.00" x 3-1/2")ID x 3-1/2"L	05-01414
E	1	Coupling, Throttle Body, (4.15" x 3-3/4")ID x 2.35"L	05-01459
F	1	T-Bolt Clamp (8-5/16" to 8-5/8")	03-50267
G	2	Clamp #060	03-50002
H	1	Clamp #064	03-50006
J	1	Clamp #072	03-50010
K	1	Seal Trim - 26" Long	05-01507
L	1	Urethane Plug	05-01202
M	1	Nipple, Brass, 3/8"	03-50193
N	1	Hose, 3/8" x 12"	05-00110

**Installation will require the following tools:**

5/16 Nut Driver, 10mm Socket & Ratchet.

Warranty Information available at: <https://afepower.com/contact#warranty>

**Emissions Disclaimer:** This product is not currently CARB exempt and is not available for purchase in California or for use on any vehicle registered with the California Department of Motor Vehicles.

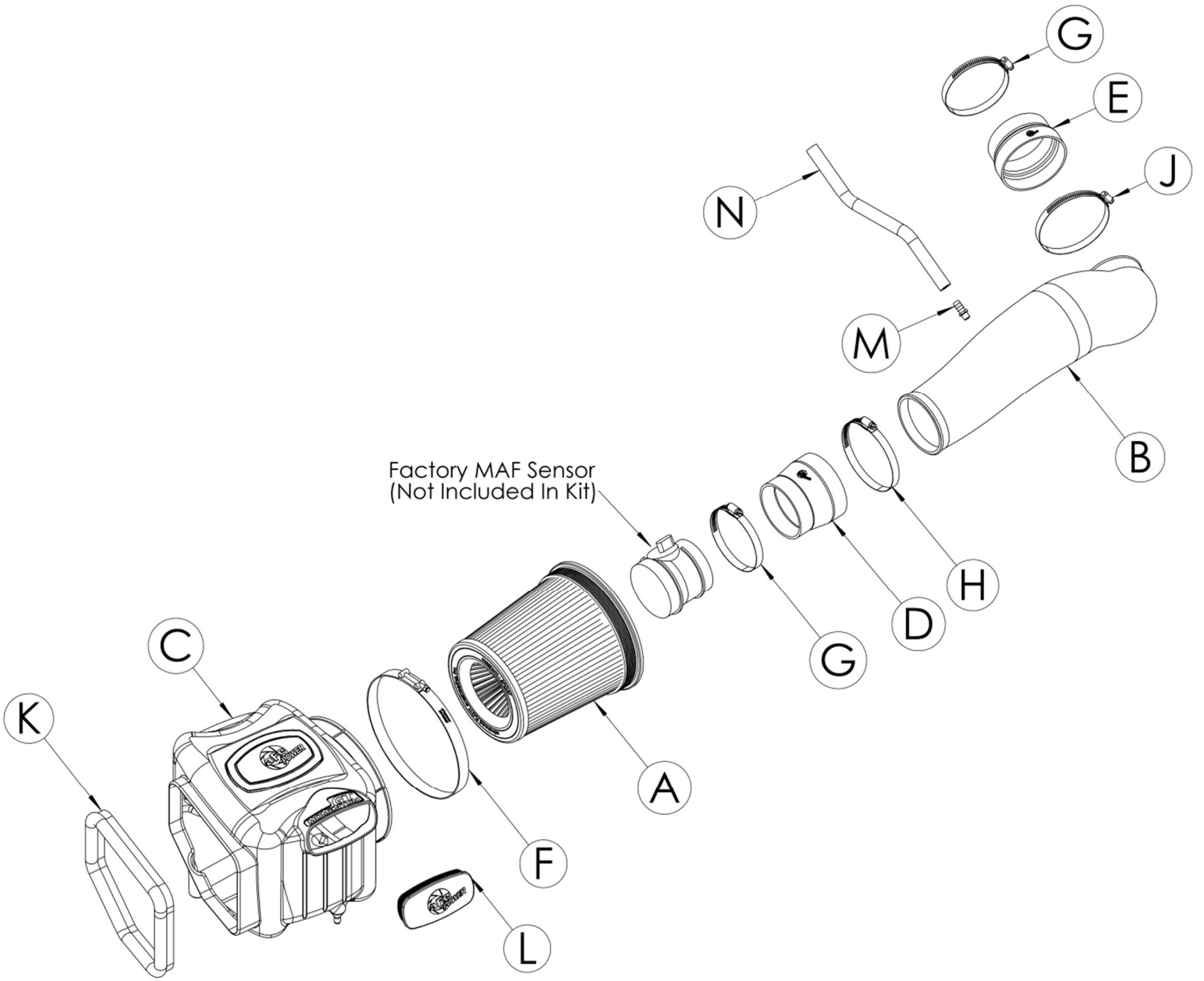

**Figure A****Refer to Figure A for Steps 1-3**

Step 1: Remove Engine Cover.

Step 2: Loosen the clamps attaching the tube to the intake housing and throttle body.

Step 3: Disconnect the wire harness from the MAF Sensor (A).



**Refer to Figure B for Steps 4-5**

Step 4: Remove the stock housing by lifting up and out.

Step 5: Detach the coolant hose support clip from the stock intake tube.

**Figure C****Refer to Figure C for Step 6**

Step 6: Slide the air filter (A) into the air box (B). Install supplied T-bolt clamps (C) & (D)  
(Do not tighten clamps at this time)

**IMPORTANT:** Prior to installation of T-bolt clamp, we recommend that you stretch the T-bolt clamps by installing it in its intended position and tightening

**Figure D****Refer to Figure D for Steps 7-8**

Step 7: Install trim seal (A) on the edge of the Momentum air box.

Step 8: Remove the retaining plug (B) from the factory air box and install on the Momentum air box.

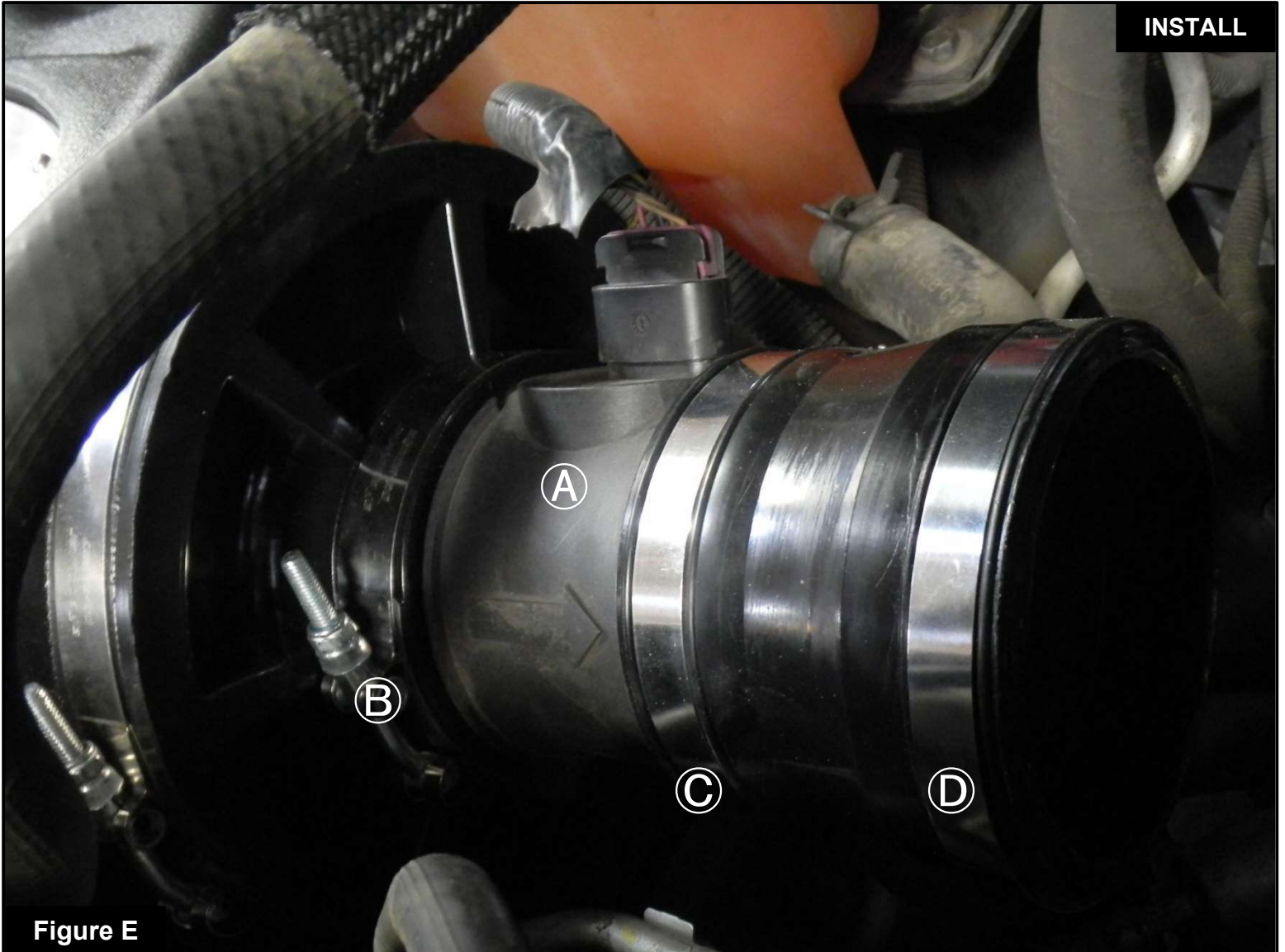

**Figure E**

**Refer to Figure E for Steps 9-13**

Step 9: Install the aFe airbox into the vehicle by firmly pushing it into the factory mounting grommets.

Step 10: Insert stock MAF cartridge into filter as shown (A).

Step 11: Tighten band clamp (B).

Step 12: Slip #060 band clamp over hump coupling and slip over MAF cartridge (C).

Step 13: Slide #064 band clamp on hump coupling (D) do not tighten at this time.



**Figure F****Refer to Figure F for Steps 14-16**

Step 14: Slip #060 band clamp (A) over adaptor coupling (B).

Step 15: Slip adaptor coupling over throttle body.

Step 16: Slip #072 band clamp (C) over adaptor coupling. Do not tighten at this time.



Figure G

**Refer to Figure G for Steps 17-21**

Step 17: Slide tube into couplings.

Step 18: Install vent fitting and connect vent hose (A).

Step 19: Reconnect MAF sensor harness.

Step 20: Make sure all connections are secure and all clamps are tight.

Step 21: Re-Install the engine cover. Your installation is now complete.

**NOTE: Retighten all connections after approximately 100-200 miles.**

**Place enclosed CARB EO sticker on or near the device on a smooth, clean surface.**

**EO identification label is required to pass the smog inspection.**



***advanced FLOW engineering, inc.***

Corona, CA 92879

<https://afepower.com/contact>