

Airaid

Installation Instructions

For Part Numbers:

250-702 850-496 Airaid Oiled Media Filter

251-702 851-496 SynthaMax Dry Media Filter - Red

2016-19 Chevrolet Camaro

V6-3.6L

INTAKE SYSTEMS FOR VEHICLES LISTED ARE 50 STATE LEGAL. SEE AIRAID.COM FOR CARB STATUS ON EACH PART FOR A SPECIFIC VEHICLE.

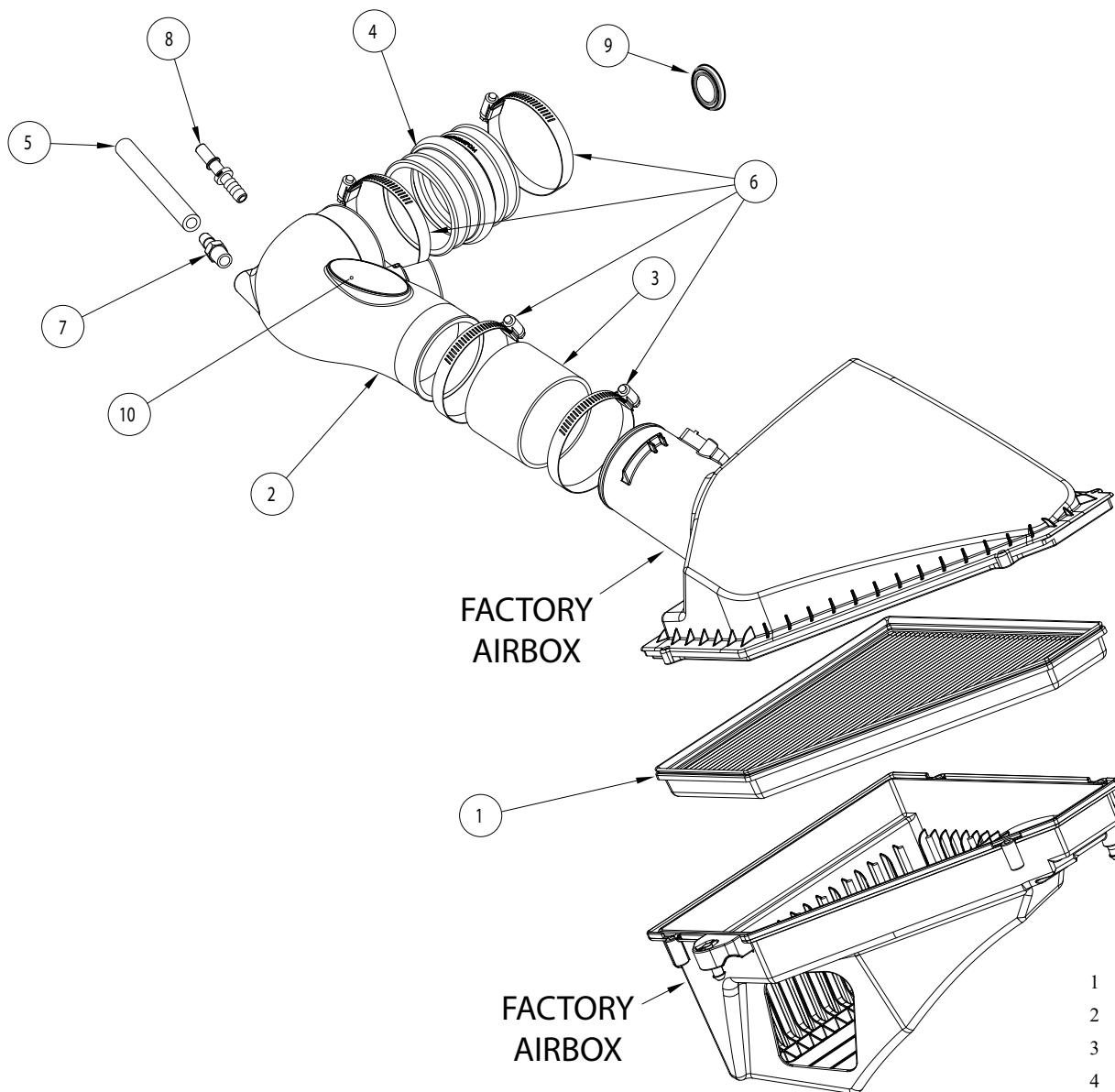

Component Identification

1	850/851-496	AIRAID FILTER	1
2	KIT902A	INTAKE TUBE	1
3	KITCOUPLER16	COUPLER; 3.15"ID X 2.5"L SILICONE	1
4	KITHUMPHS06EPDM	HUMP HOSE; 3"ID X 3"L	1
5	5-1006	RUBBER HOSE; 3/8"ID X 6"L	1
6	08605	HOSE CLAMP; #48 MIDI	4
7	08047	VENT; STRT, 3/8"HOSE, 1/4"NPT	1
8	82631	FITTING; BARBED, 3/8", QUICK	1
9	KITPLUG03	FIREWALL PLUG	1
10	KITSTICKER12	AIRAID DECAL	1

Full color instructions can be viewed on our web site at Airaid.com.
If you need any assistance please call 1-800-498-6951 to speak with a representative in our Customer Service Center before returning the product.

TO START:

1. Turn off the ignition and disconnect the negative battery cable.

NOTE: Disconnecting the negative battery cable erases pre-programmed electronic memories. Write down all memory settings before disconnecting the negative battery cable. Some radios will require an anti-theft code to be entered after the battery is reconnected. The anti-theft code is typically supplied with your owner's manual. In the event your vehicles anti-theft code cannot be recovered, contact an authorized dealership to obtain your vehicles anti-theft code.



2. Remove the oil cap and bolt that secure the engine cover and then remove the engine cover from the vehicle.



3. Slide the locking tab back and then disconnect the mass air sensor electrical connection.



4. Loosen the hose clamp that secures the EVAP line and unclip the crank case vent to the intake tube and disconnect them. Loosen the two hose clamps that secure the intake tube to the air filter housing and throttle body. Disconnect the tube from the air filter housing and throttle body.



5. Lift up the intake tube to access the sound tube connection and then disconnect the sound tube from the intake tube and remove the intake tube from the vehicle.



6. Release the four sound drum tube mounts.

Continued...



7. Remove the bolt that secures the sound tube to the firewall and then rotate the tube clockwise to remove the complete sound tube assembly.



8. Install the provided plug into the hole for the sound tube in the firewall.



9. Remove the air filter housing lid and replace the stock air filter with the provided AIRAID filter, reinstall the lid and secure with the factory hardware.



10. Install the AIRAID decal onto the intake tube. Install the provided 1/4npt into the intake tube.

NOTE: Plastic NPT fittings are easy to cross thread. Install the vent fitting "hand" tight, then turn it two complete turns with a wrench.



11. Install the provided vent hose and quick disconnect fitting onto the intake tube.



12. Install the coupling hoses onto the air filter housing and throttle body as shown.



13. Install the intake tube into the coupler at the air filter housing and then into the coupler at the throttle body, adjust the tube for best fit and then secure with the provided hose clamps. Connect the EVAP and crank case vent lines.



14. Reconnect the mass air sensor electrical connection.



15. Reinstall the engine cover and secure with the factory hardware.



16. Double check your work!

Make sure there is no foreign material in the intake path. Make sure all clamps, hoses, bolts, and screws are tight. Double check the hood clearance!

Reconnect the negative battery cable!

Thank you for purchasing the Airaid Intake System. Contact Airaid @ (800) 498-6951 8:00 AM - 5:00 PM MST weekdays for questions regarding fit or instructions that are not clear to you. Your Airaid Intake System was carefully inspected and packaged. Check that no parts are missing, or were damaged during shipping. If any parts are missing, contact Airaid. The air filter element is protected from direct exposure to water and debris; care should be taken not to drive through deep water.

WATER INGESTION IS THE DRIVERS RESPONSIBILITY! The air filter is reusable and should be cleaned periodically.

For your Oiled media filter we offer the Airaid Tune Up Kit!



P/N 790-551 Aerosol Spray
P/N 790-550 Squeeze Spray



INTAKE SYSTEMS FOR VEHICLES LISTED ARE 50 STATE LEGAL. SEE AIRAID.COM FOR CARB STATUS ON EACH PART FOR A SPECIFIC VEHICLE.

SynthaMax

Synthamax Air Filters **do not** require oil. Service air filter as needed by cleaning with common non-petroleum all-purpose household cleaner and water. Simple Green®, Formula 409® or equivalent works great. Apply cleaner to outside of air filter and allow to soak. Then flush filter clean from the inside out with a garden hose and repeat steps if necessary. Do not apply high pressure water or air to clean filter. Allow filter to air dry and reinstall.