

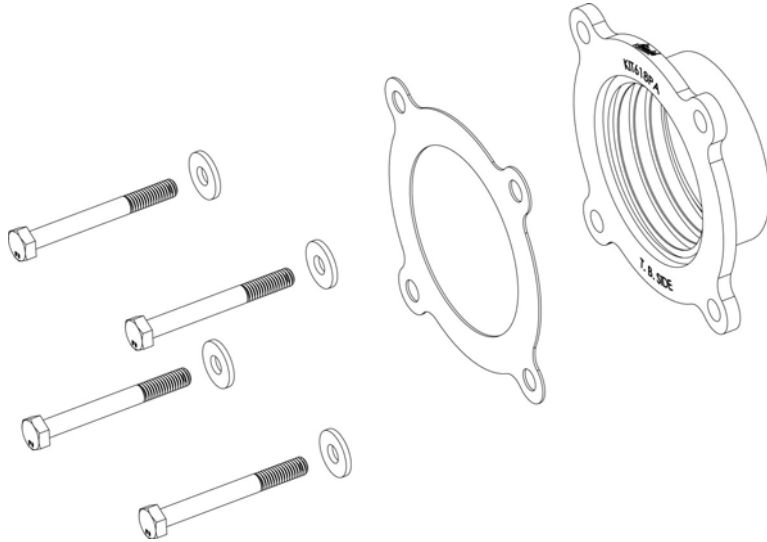

Installation Instructions
Part Number 310-618
Poweraid Spacer For
2007-12 Dodge Ram & Dakota
2007-10 Dodge Nitro
2007-09 Jeep Commander
2007-09 Jeep Grand Cherokee
2007-12 Jeep Liberty
2007-09 Mitsubishi Raider
3.7L V-6



Parts List

AIR-KIT618PA	Aluminum Plate	(1)
AIR-KIT618G	Gasket	(1)
AIR-KIT618H	Hardware	
	6mm x 50mm Hex Bolts	(4)
	6mm Flat Washers	(4)

Tools Required For Installation

- 5/16" & 10mm Sockets
- Ratchet & Extension
- Flat Blade Screwdriver

INTAKE SYSTEMS FOR VEHICLES LISTED ARE 50 STATE LEGAL. SEE AIRAID.COM FOR CARB STATUS ON EACH PART FOR A SPECIFIC VEHICLE.

Thank you for purchasing the Airaid Throttle Body Spacer. Please read the instruction manual carefully before proceeding with the installation. Your Airaid Throttle Body Spacer was carefully inspected and packaged. Check that no parts are missing, or were damaged during shipping. If you need any assistance please call 1-800-858-3333 to speak with a representative in our Customer Service Center before returning the product.

Thank you for selecting AIRAID.

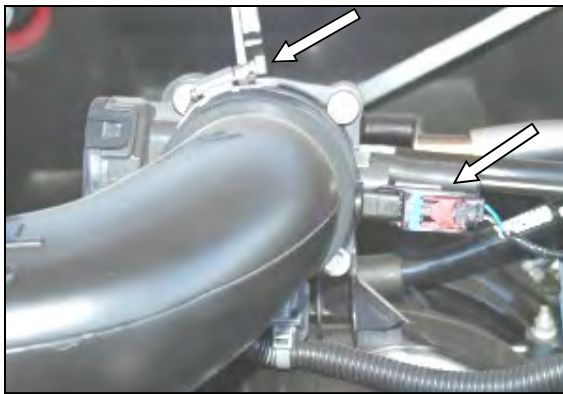

1. Disconnect the negative battery cable!
2007-10 Jeep Liberty/Dodge Nitro: Using a 5/16" socket, loosen the hose clamp on the throttle body end of the factory intake tube. Disconnect the factory temperature sensor wiring harness by sliding the red tab back, and then pressing the black tab on the connector while sliding it off. Slide the factory intake tube off of the throttle body.



2. All other listed vehicles: Using a 5/16" socket, or flat blade screwdriver, loosen the hose clamp which secures the factory intake tube to the resonator box. Disconnect the factory temperature sensor wiring harness from the sensor in the resonator box. Slide the factory intake tube off of the resonator box. Remove the resonator box by pulling straight forward to release it from the throttle body and the grommet mounts. Save the resonator box for reuse.

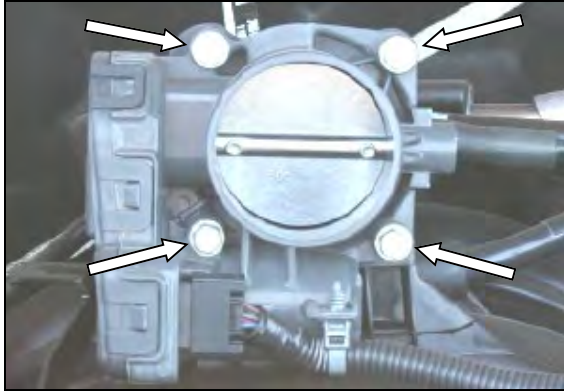

3. Using a 10mm socket, remove the four bolts that secure the throttle body to the intake manifold. Next, rotate the factory throttle body out of the way to allow access to the intake manifold. Make sure the factory blue gasket is seated in the groove on the intake manifold.

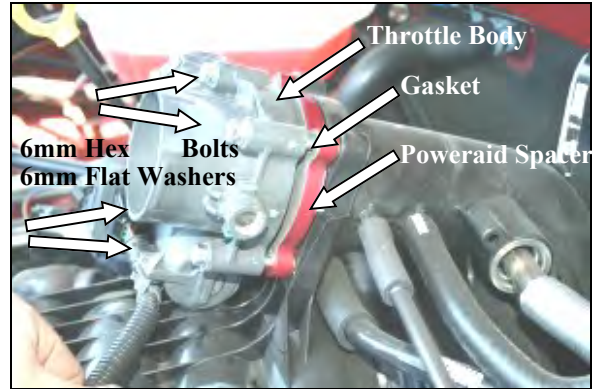

4. Install the Airaid Spacer (#1) with the bore extending into the intake manifold. Install the Gasket (#2) between the Airaid Spacer and the throttle body. Install four 6mm x 50mm hex bolts (#3) and 6mm flat washers (#4) through the throttle body, AiraidSpacer, Gasket, and into the intake manifold. Using a 10mm socket, tighten all four throttle body bolts evenly, to the manufacturer's specifications. **Do Not Over Tighten The Bolts!** Reference picture below for spacer orientation.

5. Re-install the factory intake tube or resonator onto the vehicle. Re-connect the factory temperature sensor wiring harness. Tighten all hose clamps securely. **Re-connect the negative battery cable!**

The sound of power...The "whistle" means its working!



Example of proper spacer installation. Spacer must protrude into intake manifold and away from throttle body.

AIR-I31618C
Rev. 06.26.20

Contact your nearest Airaid dealer for an Airaid Intake System for your car, truck or SUV.

Airaid. 1455 Citrus St, PO Box. 1329, Riverside, CA 92502 (800) 498-6951 AiraidInfo@airaid.com