

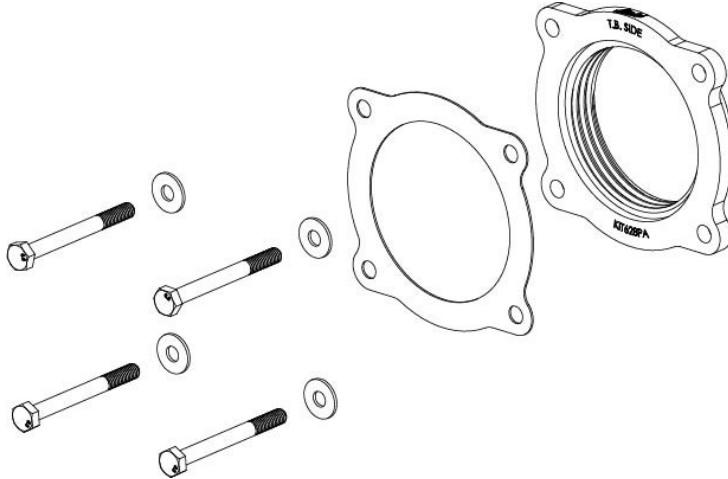

Installation Instructions
Part Number 510-628
AIRAID Spacer For
2010-2014 Toyota FJ Cruiser
2010-2020 Toyota 4Runner
4.0L V-6



Parts List

AIR-KIT628PA	Aluminum Plate	(1)
AIR-KIT628G	Gasket	(1)
AIR-KIT628H	Hardware	
	6mm x 60mm Bolt	(4)
	6mm Flat Washer	(4)

Tools Required For Installation

5/16", 10mm Socket
Ratchet and Extension

NOT LEGAL FOR SALE OR USE ON ANY POLLUTION CONTROLLED MOTOR VEHICLE IN CALIFORNIA OR STATES ADOPTING CALIFORNIA EMISSION PROCEDURES.

See AIRAID.COM for CARB status on each part for a specific vehicle.

Thank you for purchasing the AIRAID Throttle Body Spacer. Please read the instruction manual carefully before proceeding with the installation. Your AIRAID Throttle Body Spacer was carefully inspected and packaged. Check that no parts are missing, or were damaged during shipping. If you need any assistance please call 1-800-858-3333 to speak with a representative in our Customer Service Center before returning the product.

Thank you for selecting AIRAID.



Disconnect The Negative Battery Terminal.

1. Remove the engine cover.

Lift up on the front of the engine cover to unseat the mounting grommets and remove it from the vehicle.

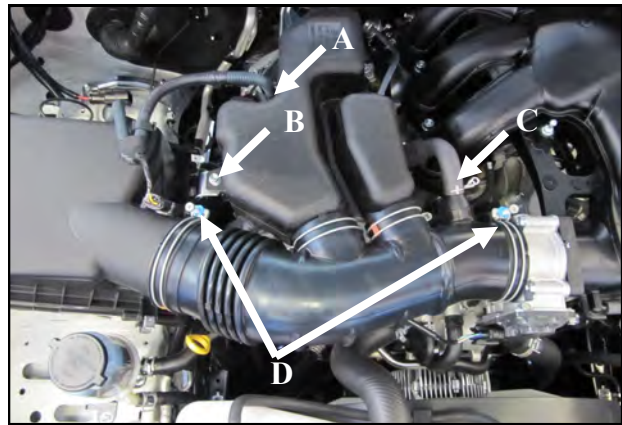

2. Remove the factory intake.

A.) Pry the wire harness anchor from the intake resonator chamber

B.) Remove the 6mm anchor bolt from the resonator.

C.) Disconnect the crankcase breather and fuel pressure regulator lines.

D.) Loosen the clamps on both ends of the intake tube and remove the entire intake/resonator assembly.

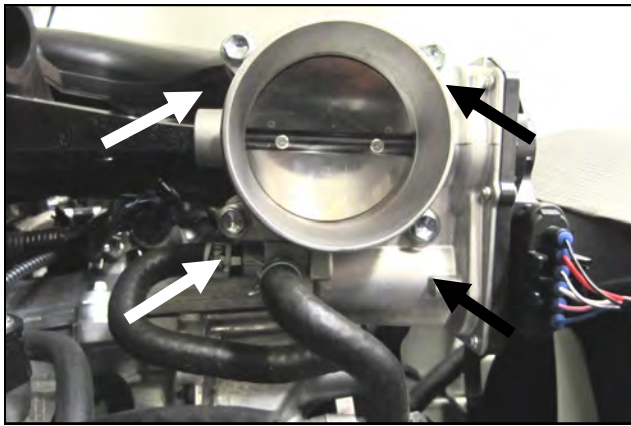

3. Remove the four bolts that secure the throttle body to the intake manifold.

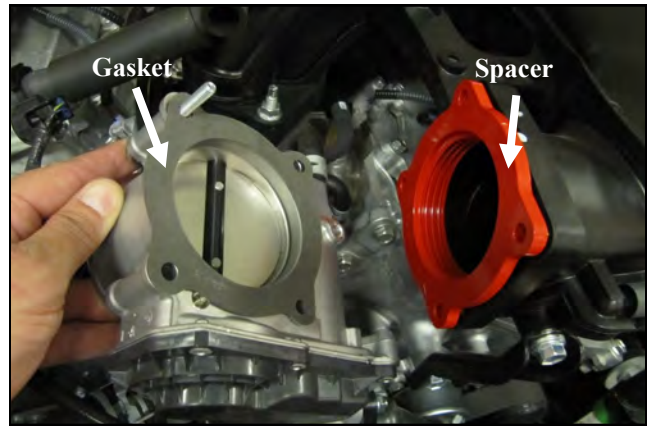

4. Insert the AIRAID Spacer into the intake manifold as shown. Prepare the throttle body for installation by placing the gasket on it and using one of the supplied bolts and washers as an alignment aid. *Note: AIRAID spacer must be installed with bore protruding into intake manifold away from throttle body. Incorrect installation will hinder performance. Reference picture below for spacer orientation.

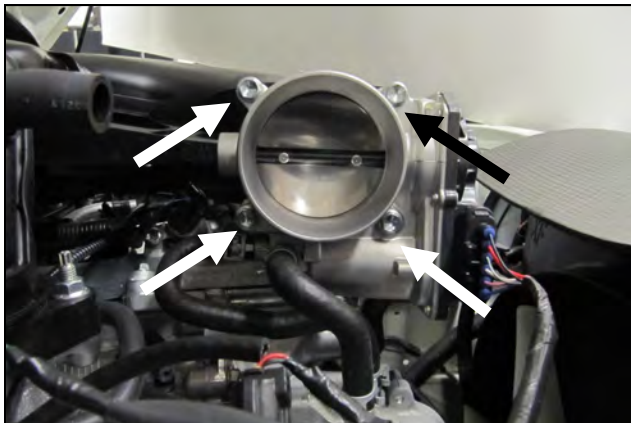

5. Install the provided bolts and washers thru the throttlebody and AIRAID Spacer and tighten to the manufacturer's specifications in an X Pattern.



6. Reinstall the factory intake tube, tighten the two hose clamps, and reconnect the crankcase breather and Fuel pressure regulator lines. Reinstall the engine cover.
Re-connect the negative battery cable!



**Airaid Intake Systems PN. 510-302
2010-2012 Toyota FJ Cruiser and 4 Runner**



Example of proper spacer installation. Spacer must protrude into intake manifold and away from throttle body.

AIR-I51628G
Rev.6/1/20

Contact your nearest Airaid dealer for the Airaid Intake System for your Vehicle

Airaid. 1455 Citrus St., P.O. Box 1329, Riverside, CA. 92502 1-800-498-6951 AiraidInfo@airaid.com