

Parts List

1	Driver-side fender flare
1	Passenger-side fender flare
16	Hex bolt, M6 x 20mm
14	Rivnut, M6
17	Flat washer, M6
16	Lock washer, M6
1	Insert tool, M6
1	Left hand nut, M8
1	Metal spacer

Tools Required

Ratchet	Socket, 10mm
Wrench, 13mm	Socket, 13mm
Drill	Cut-off tool
Plier-style thread set tool, M6	Drill bit, 25/64" OR 10mm
Paint marker	Trim removal tool

Level of Difficulty

Moderate

Scan
for helpful
install tips**Product Image****Notes and Maintenance**

Before you begin installation, read all instructions thoroughly.

Proper tools will improve the quality of installation and reduce the time required.

For black finishes, mild soap may be used to clean the product.

Step 1

Starting with the front fenders, remove the inner fender well using a 10mm socket to remove all hex head bolts.

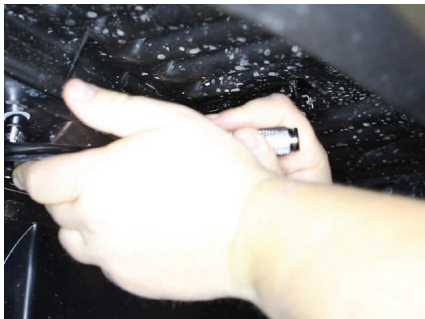

Step 2

Remove all push-in retainers. Take care not to damage the plastic inner fender flare.

Once the retainers are removed, remove the fender and set aside.



Step 3

Disconnect the side marker light.



Step 4

Remove the plastic fender flare support by removing the hex head bolts holding it in place.

You should now be able to pull the stock fender flare from the body of the Jeep.

If you are installing ARIES inner fender liners (1500350) skip to step 6 and refer to inner fender liner instructions.



Step 5

Hold the inner fender flare in place and mark evenly along the body. Cut to fit using a rotary tool or knife and set aside.

To insure the best fit we recommended trimming a little at a time, making sure not to over cut.



Step 6

Using the factory metal brace to help balancing the fender flare, place the ARIES fender up against the body and align the mounting holes.



Step 7

Identify the matching holes from the ARIES fender and the original holes. Mark the locations where drilling is needed.



Step 8

Remove the flare and drill 25/64" OR 10mm holes if needed, to fit the M6 threaded metal inserts supplied with the ARIES fenders.

Do not make the holes larger than required or the rivnuts may fail to install.



Step 9

If a plier-style thread-set will be used to install the rivnuts proceed to the installation locations in step 10.

Screw the left handed nut completely onto the thread-set tool. Slide the metal spacer onto the larger thread until it rests against the M8 left hand nut.

Place an M6 flat washer on the small thread followed by an M6 rivnut. Thread the rivnut onto the small end of the tool until it seats the washer against the shoulder between the M6 and M8 threads.

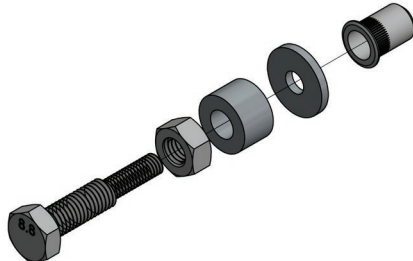

Step 10

Insert the the rivnut into the drilled hole. Using an open ended 13mm wrench, hold the M8 nut on the thread setting tool.

With a 13mm socket, turn the head of the bolt clock-wise until the M8 nut and metal spacer contact the M6 washer and rivnut. After tension is felt, carefully compress the rivnut in the hole while applying slight pressure to keep it seated (approximately two full rotations).

CAUTION: Over tightening the rivnut may damage the thread set tool and / or vehicle body panel. Only compress the rivnut enough to seat in the hole without rotating.

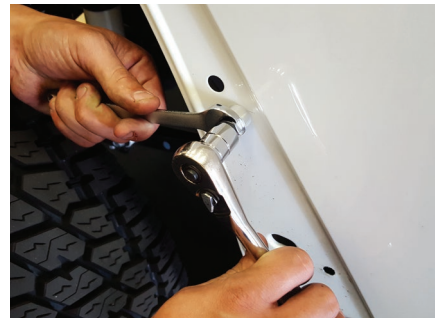

Step 11

Place the fender back into place, and attach using an M6 bolt, lock washer and flat washer.



Step 12

Reinstall the inner fender well using the stock hardware where applicable.

To ensure a tight fit, additional fastening may be required with zip ties (not included).

This step can be skipped if ARIES inner fender liners (1500350) are being installed.



Step 13

Tighten down all hardware with a 10mm socket. Repeat this process on the passenger side.



Step 14

Congratulations on the installation of your new ARIES fender flares.

With the fender flares installed, periodic inspections should be performed to ensure all mounting hardware remains tight.

To protect your investment, see the 'Notes and Maintenance' section on the first page of this instruction manual.

