



BX1673

2007-09 Chevy 1500 Heavy Duty
 2007 Chevy 2500 New Style
 2007 GMC Pickup 2500 New Style
 Installation Instructions

Serial Number

Please read BOTH these Installation Instructions and the General Towing Instructions before attempting to install or operate this equipment.

- Blue Ox® towing products and accessories are intended to be installed by Blue Ox® Dealers who are familiar with our products and have the equipment and knowledge to do “fit work.” When necessary, Blue Ox® Dealers can be found at www.blueox.us or by contacting our Customer Care Department at (888) 425-5382.
- Many Blue Ox® Baseplates are designed to use existing holes and hardware to mount the baseplate to the towed vehicle. Even though bolts are there, do not assume they are adequate for baseplate mounting. Always use hardware supplied in the hardware kit or existing hardware specified in the Baseplate Towing Installation Instructions.

Attachment Tab Height: 15 1/2”
 Attachment Tab Width: 31 1/2”

Bolt Torque Specifications
 Torque in Foot-Pounds for Metric Bolts

Bolt Size	Grade 8.8	Grade 10.9
6MM	6	8
8MM	16	22
10MM	31	40
12MM	54	70
14MM	89	117

Confirm the towability and pre-towing procedures for your vehicle with the owner’s manual or contact the vehicle’s manufacturer for specific towing procedures.

Bolt Torque Specifications
 Torque in Foot-Pounds for Inch Bolts

Bolt Size	Grade 5	Grade 8
1/4”	10	14
5/16”	19	29
3/8”	33	47
7/16”	54	78
1/2”	78	119
5/8”	154	230



! WARNING

Failure to read and follow these instructions could result in separation of the towed vehicle from the tow bar, causing property damage, loss of towed vehicle, personal injury or death.

BX1673
 2007-09 Chevy 1500 Heavy Duty
 2007 Chevy 2500 New Style
 2007 GMC Pickup 2500 New Style
 Installation Instructions

Parts List

Ref. No.	Qty.	Part #	Description
1	1	61-6387	Weldment, Baseplate, BX1673
2	1	61-6388	Weldment, Baseplate, BX1673
3	8	201-0011	1/2-13x1 1/4" Hex Bolt, Grd. 5, ZP
4	8	203-0012	1/2" Lock Washer, ZP
5	4	201-0050	1/4-20x3/4 Hex Bolt, Grd. 5, ZP
6	4	203-0008	1/4" Lock Washer, ZP
7	2	203-0001	1/4" Flat Washer, ZP
8	4	202-0069	1/4-20 Hex Flange Whiz Lock Nut, ZP
9	2	201-0192	#10-32x1/2" Slot, Round Head Screw
10	2	203-0054	#10 Lock Washer
11	2	202-0047	#10-32 Hex Nut
12	2	101-5822	Adapter, 4 Way Connector
13	1	101-6135	Electrical Bracket, 90 Degrees
14	2	62-3468	Attachment, Assembly, SF/SB, 1 Hole
	2	290-0437	Cap Plug, Black (Not Shown)
	4	229-0512	Quicklink, 1/2", ZP (Not Shown)
	2	226-0049	Baseplate Safety Cable, 36" Class IV (Not Shown)

Tools Required

Loctite® RED
 Flat Screwdriver
 10MM Socket
 15MM Socket
 18MM Socket
 Utility Knife

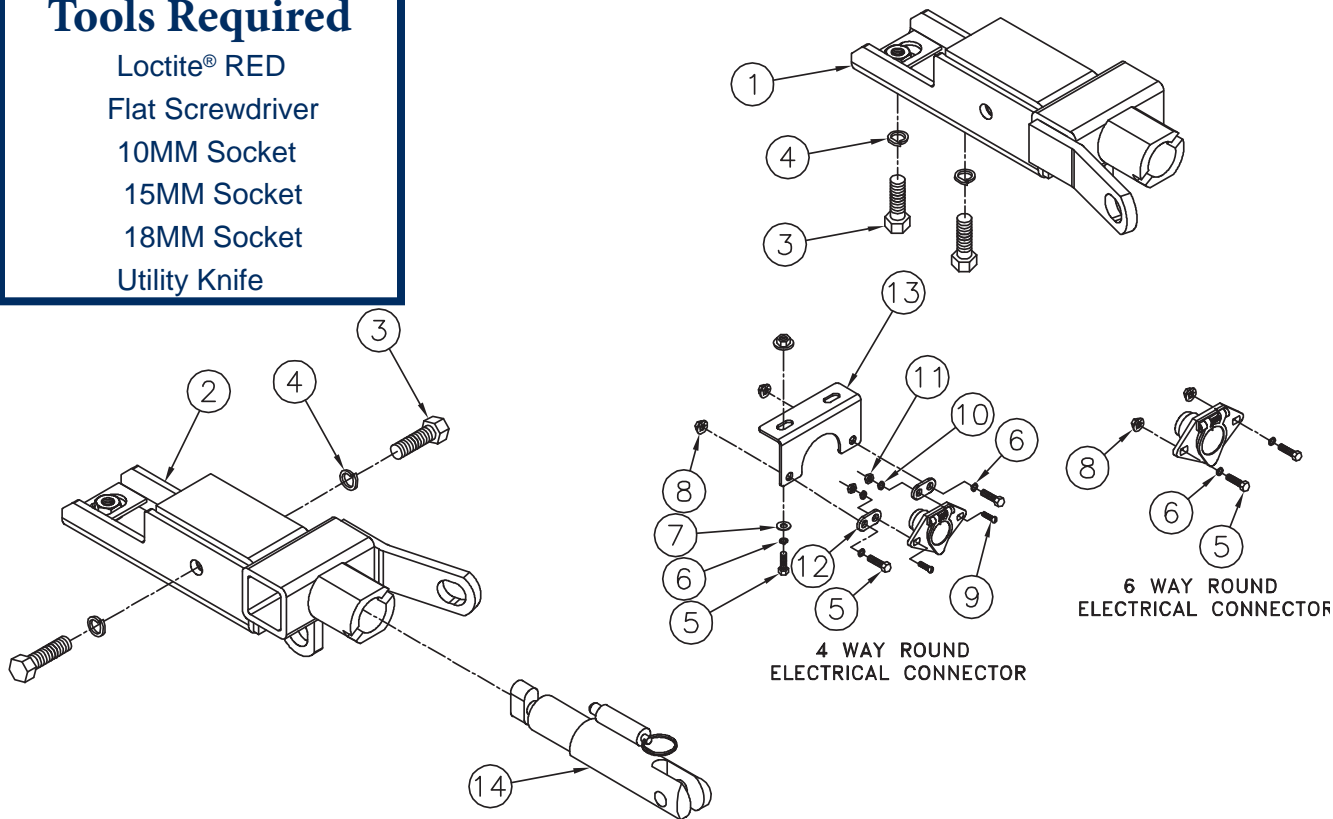

Important:

Use only genuine factory replacement parts on your baseplate. Do **NOT** substitute homemade or non-typical parts. If a bolt is lost or in need of replacement, for your safety and the preservation of your baseplate, be sure to use a replacement bolt of the same grade (In most cases it will be Grade 5, please reference the parts list above). Replacement parts may be ordered through your nearest Blue Ox® Dealer or Distributor.

BX1673
2007-09 Chevy 1500 Heavy Duty
2007 Chevy 2500 New Style
2007 GMC Pickup 2500 New Style

Installation Instructions

Vehicle Weight:

The weight of this vehicle is near the Class III, 5,000 lb. rating limitations. Some models, depending on options, may well exceed this 5,000 lb rating. Be sure to confirm the weight of your individual vehicle before towing. As of 1999 the Aventa® II is now 10,000 lbs. and either the Aventa® II or the Aventa® LX tow bar must be used for these applications.

Tow Bar Adapters are NOT to be used with vehicles weighing over 5,000 lbs.

Installation Notes: The grille and bumper are removed and reinstalled during installation of the baseplate. Trimming of the fascia is required.

The dimensional variations between otherwise identical vehicles can be considerable. While the baseplate was designed for easy installation, it may be necessary to tailor the baseplate slightly to compensate for auto manufacturer's tolerances. These minor adjustments may include filing a hole slightly, bending electrical rods and/ or bending end plates.

The BX8869 Bulb & Socket Wiring Kit is recommended for this vehicle.

Installation Instructions:

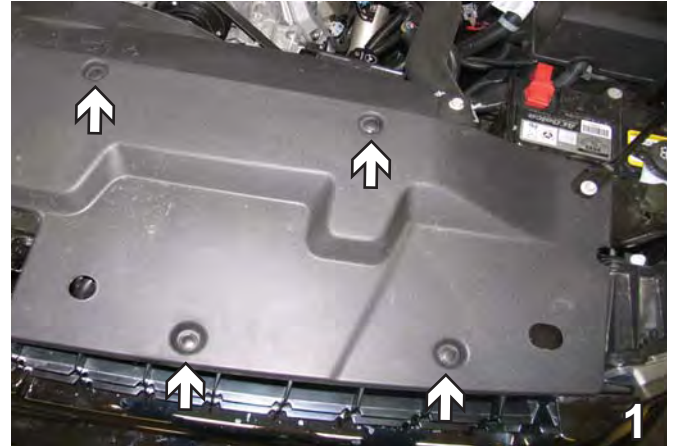

1. Using a flat screwdriver, remove four push pins from the flat plastic piece on top. Do this to both sides of the vehicle. Set push pins aside to be reinstalled later.



2. Once top plastic piece is set aside, you will need to remove two bolts with a 10MM socket. Do this to both sides of the vehicle. Set bolts aside to be reinstalled later.



3. You will need to pull apart several clips located on the back of the grille. The grille is then ready to be removed from the vehicle and set aside to be reinstalled later.

BX1673
2007-09 Chevy 1500 Heavy Duty
2007 Chevy 2500 New Style
2007 GMC Pickup 2500 New Style
Installation Instructions



4. Using a 18MM socket, remove one bolt located just behind metal bumper, on top of bumper bracket. Do this to both sides of the vehicle. Set bolts aside to be reinstalled later.



5. Using a 15MM socket, remove one bolt located underneath right in front of the tire. Do this to both sides of the vehicle. Set bolts aside to be reinstalled later.



6. Using a 18MM socket, remove one bolt from the side and one bolt from the bottom of the tow hook. Do this to both sides of the vehicle. Factory tow hooks and bolts will not be reinstalled.

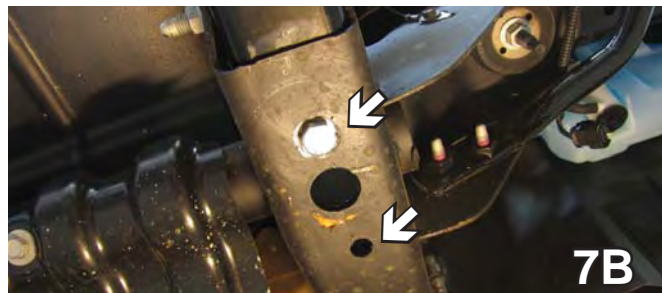

7. Slide baseplate in where the tow hooks were removed. Insert a 1/2-13x1 1/4" hex bolt and 1/2" lock washer into the two holes on the side and the two holes on the bottom of the baseplate and tighten down. Do this to both sides of the vehicle.



8. Attach the permanent baseplate safety cables to the provided convenience link on the baseplate. The photo above shows the recommended installation of the cables to frame of vehicle. Additional options may interfere with suggested mounting; in this case secure the cables to a solid piece of the frame as described in the instructions included with the permanent baseplate safety cables. Be sure the safety cables do not rub against any hoses or moving parts. Do this to both sides of the vehicle.

BE SURE TO USE LOCTITE® RED ON ALL BOLTS BEFORE TIGHTENING. TIGHTEN ALL BOLTS ACCORDING TO THE TORQUE CHART ON THE FRONT PAGE OF THESE INSTRUCTIONS OR ON PAGE 3 OF THE BASEPLATE TOWING GENERAL INSTRUCTIONS.

BX1673
2007-09 Chevy 1500 Heavy Duty
2007 Chevy 2500 New Style
2007 GMC Pickup 2500 New Style

Installation Instructions



9. Using a utility knife, cut two tabs flush with the fascia opening. The photo above is what the opening should look like after your finished. Do this to both sides of the vehicle.

Be sure that **ALL** electrical connections are plugged in properly and functioning **BEFORE** installing the fascia.

DEALER or INSTALLER:
Be certain the user receives the instruction sheets for their products.



Shown without removable tabs installed.



Shown with removable tabs installed.

If the baseplate is in an accident, it must be replaced. **DO NOT** use it again! An accident can cause unseen damage and using it again could result in more damage or serious injury. **DO NOT** use the baseplate if it is damaged or missing parts.

Install the tow bar and safety cables according to the instructions provided in their packages. When demonstrating this to the customer, be sure to include all the contents and packages.

Do **NOT** substitute other devices if the tow bar pins and clips are misplaced.

CUSTOMER SERVICE COMMITMENT

Blue Ox is committed to providing you with exceptional customer care throughout your lifetime with our products. Our team is here to assist you with any questions you may have regarding the performance of your product. Simply call 1-800-228-9289 and you can speak with our customer care team.

Additionally, please visit our website to see which rallies our Destination America team will be attending. For a nominal fee, our service technician will service your towing system to ensure it's in proper working condition. Also as a commitment to our customers, should you visit our factory you can stay at our full service Blue Ox campground at no charge along with enjoying a factory tour.

Again thank you for being our customer and for the confidence you have shown in the performance of our products. It is because of customers like you we enjoy the success we have today.



© 2007, 08, 09 Blue Ox
One Mill Road, Industrial Park
Pender, Nebraska 68047
Phone: (402) 385-3051 • Fax: (402) 385-3360
www.blueox.us