



# BX1704

## 2013 Chevy Spark 2LT Installation Instructions

Serial Number

Attachment Tab Height: 22"

Attachment Tab Width: 18"

Please read BOTH these Installation Instructions and the General Instructions prior to installing or operating this equipment.

- Blue Ox® towing products and accessories are intended to be installed by Blue Ox® Dealers who are familiar with our products and have the equipment and knowledge necessary to do "fit work". If needed, Blue Ox® Dealers can be found at [www.blueox.com](http://www.blueox.com) or by contacting our Customer Care Department at (402) 385-3051.
- Many Blue Ox® baseplates are designed to use existing holes and hardware to mount the baseplate to the towed vehicle. Even though bolts are there, do not assume they are adequate for baseplate mounting. Always use the hardware supplied in the hardware kit and existing hardware as specified in the installation instructions.

**Bolt Torque Specifications**  
Torque in Foot-Pounds for Metric Bolts

Bolt Size	Grade 8.8	Grade 10.9
6MM	6	8
8MM	16	22
10MM	31	40
12MM	54	70
14MM	89	117

**Bolt Torque Specifications**  
Torque in Foot-Pounds for Inch Bolts

Bolt Size	Grade 5	Grade 8
1/4"	10	14
5/16"	19	29
3/8"	33	47
7/16"	54	78
1/2"	78	119
5/8"	154	230



If the front of your vehicle looks different than this, please contact us at (402)385-3051.

**Reference your vehicle owner's manual for manufacturer's towing specifications.**

**! WARNING**

Failure to read and follow these instructions could result in separation of the towed vehicle from the tow bar, causing property damage, loss of towed vehicle, personal injury or death.

BX1704  
2013 Chevy Spark 2LT  
Installation Instructions

**Instruction Notes:** The fascia and windshield washer fluid reservoir are removed and reinstalled for the baseplate installation. Some drilling and trimming is required.

Place all components that are removed on a flat, sturdy surface. All items will be reinstalled unless otherwise noted after the baseplate is installed.

The dimensional variations between otherwise identical vehicles can be considerable. While the baseplate was designed for easy installation, it may be necessary to tailor the baseplate slightly to compensate for vehicle manufacturer's tolerances.

The BX8869 Tail Light Wiring Kit is recommended for this vehicle.

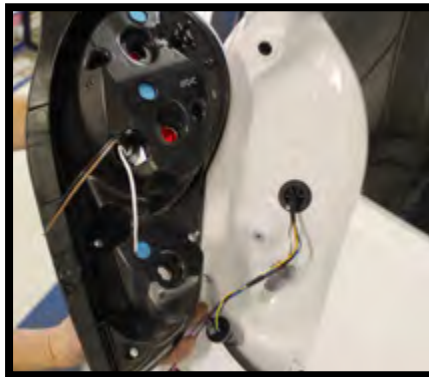

Drill a hole according to the tail  
light wiring kit instructions.

## ***NOTICE***

- Handling of some cosmetic parts when installing this product may require the use of protective covers, rags, specialty tools, etc. to prevent damage.
- When using power drills be aware of the dangers of torque and drill bit length.
- Be sure that **ALL** electrical connections are plugged in properly and functioning before reinstalling the fascia.
- Do not use the towed vehicle for storing luggage, equipment, etc. This may cause you to exceed the towing capacity of the tow bar, baseplate and its accessories.
- Be sure to use Loctite® Red on all bolts before tightening. Tighten all bolts according to the torque chart provided.
- Dealer or installer be certain the user receives the instruction sheet.

**BX1704**  
**2013 Chevy Spark 2LT**  
**Installation Instructions**

**Tools Required**

Large Vise Grip  
 Flat Screwdriver  
 Utility Knife  
 Phillips Screwdriver  
 Torque Wrench  
 Drill  
 Tape Measure  
 Loctite® RED  
 1/2" Drill Bit  
 13/32" Drill Bit  
 12MM Socket  
 13MM Socket  
 9/16" Socket  
 9/16" Wrench

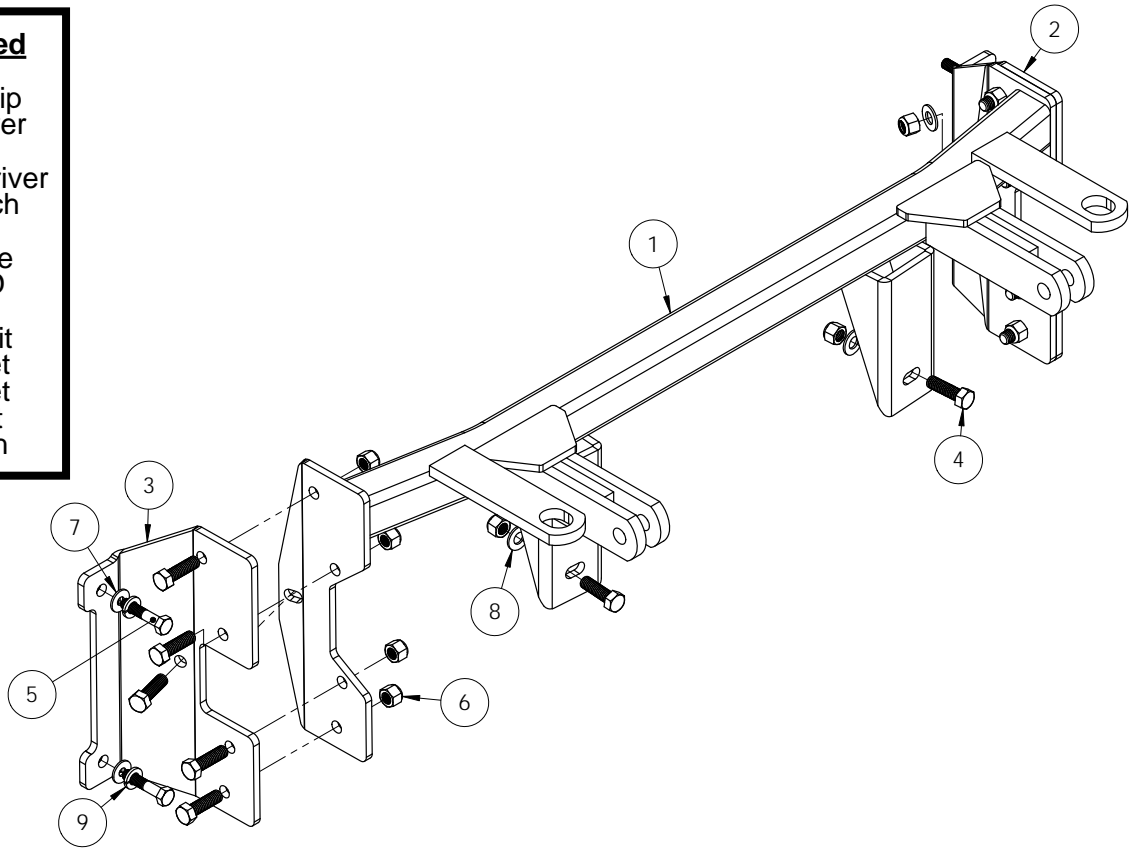

Item No.	Part No.	Description	Qty.
1.....	61-7006.....	BX1846 Baseplate.....	1
2.....	101-8055.....	BX1704 DS End Plate.....	1
3.....	101-8056.....	BX1704 PS End Plate.....	1
4.....	201-0368.....	3/8"-16 x 1-1/4" Hex Head Bolt, Grade 5, ZP.....	12
5.....	201-0418.....	8MM-1.25 x 35MM Hex Head Bolt, Grade 8.8.....	4
6.....	202-0090.....	3/8"-16 Hex Nylon Insert Lock Nut, ZP.....	12
7.....	203-0001.....	1/4" Flat Washer, ZP.....	4
8.....	203-0003.....	3/8" Flat Washer, ZP.....	4
9.....	203-0102.....	8MM Lock Washer, ZP.....	4
10.....	226-0046(not shown).....	Class III Safety Cables.....	2
11.....	229-0359(not shown).....	3/8" Quicklink, ZP.....	2

BX1704  
2013 Chevy Spark 2LT  
Installation Instructions

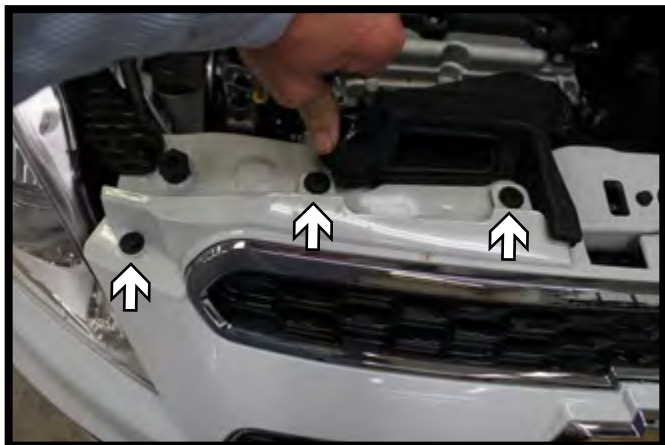

1. Using a flat screwdriver, remove the three (3) pushpins from the top edge of the fascia. Do this on both sides of the vehicle.

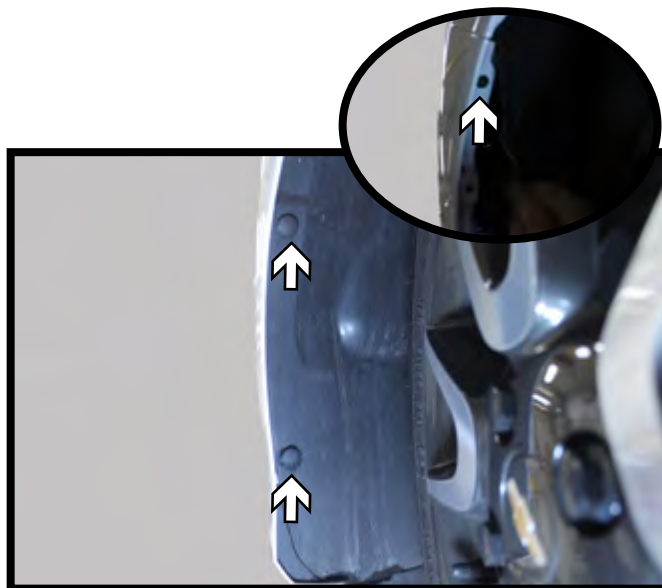

2. Using a flat screwdriver, remove the two (2) pushpins from the wheel well. Behind the wheel well cover, using a 20 Torx, remove the screw at the top of the fascia. Do this on both sides of the vehicle.

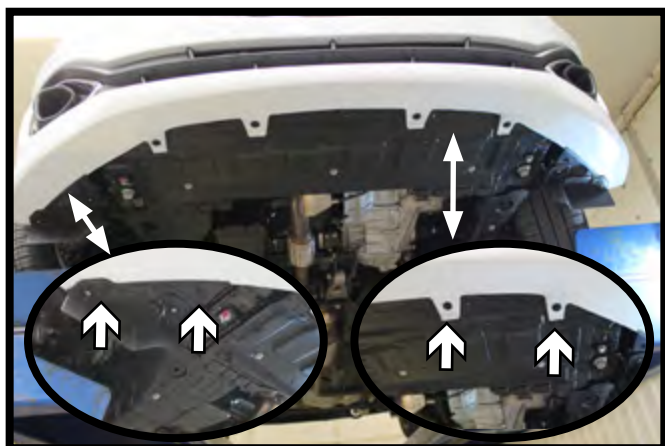

3. Using a flat screwdriver, remove the eight (8) pushpins from the bottom edge of the fascia. There are four (4) on each side of the vehicle.



4. Unsnap the fascia at the wheel wells and pull forward to remove fascia from vehicle. Unplug any electrical connections from the fascia and set aside.

BX1704  
2013 Chevy Spark 2LT  
Installation Instructions

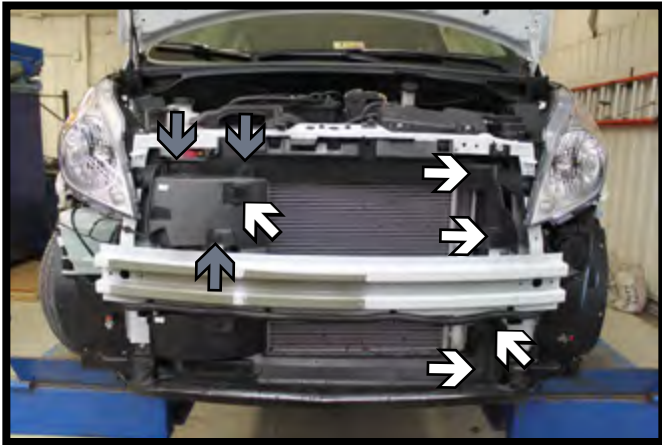

5. Using a flat screwdriver, remove the four (4) pushpins from the driver side air baffle (white) and remove. Then remove the three (3) pushpins (gray) and temperature sensor (white) from the passenger side air baffle and remove from vehicle.

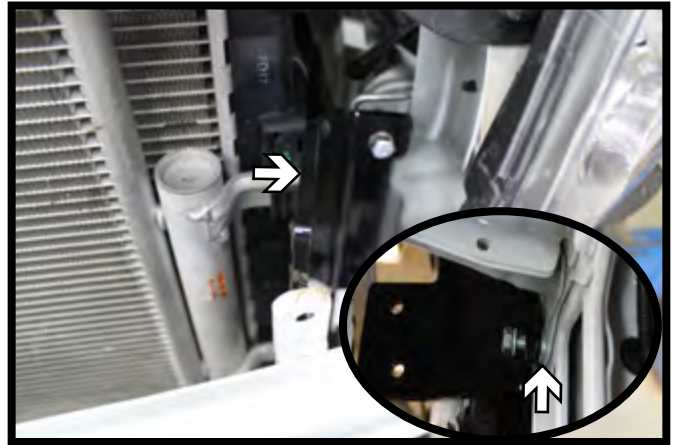

6. Install the driver side end plate onto the frame with 8MM-1.25 hex head bolts and 8MM lock washers. Use two (2) 1/4" flat washers per bolt as a spacer between the frame and the end plate. Do not tighten the bolts. Repeat on the passenger side.



7. Install the baseplate onto the end plates, using 3/8"-16 hex head bolts and 3/8"-16 nylon lock nuts. Tighten down the baseplate and end plate bolts.



8. Using a 13/32" drill bit, drill a hole thru the bumper 13-1/2" in from the end. Repeat on the other side of the vehicle. Install 3/8"-16 bolts, 3/8"-16 nylon lock nuts and 3/8" flat washers into the holes.

 Caution: When drilling thru the bumper do not to hit the radiator behind. Use a piece of pipe on the bit as shown above or a stubby drill bit.

BX1704  
2013 Chevy Spark 2LT  
Installation Instructions

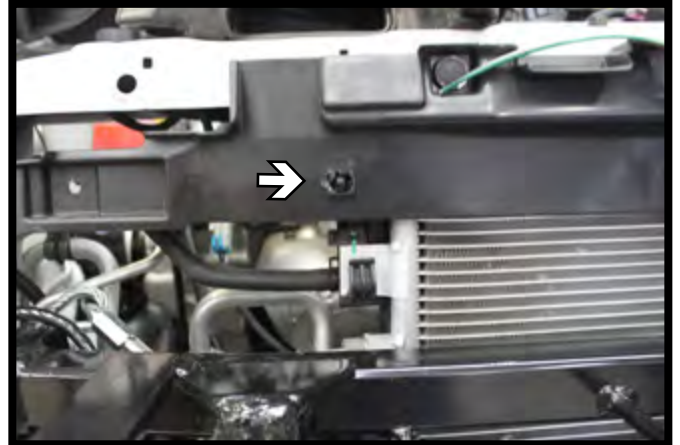

9. Attach the permanent baseplate safety cables to the provided convenience link on the baseplate. The photo above shows the recommended installation of the cables to frame of vehicle. Additional options may interfere with suggested mounting; in this case, secure the cables to a solid piece of the frame as described in the instructions included with the permanent baseplate safety cables. Be sure the safety cables do not rub against any hoses or moving parts. Do this on **BOTH** sides of the vehicle.
10. Using a 1/2" drill bit, drill out the existing pushpin hole and insert the temperature sensor.
11. Hold up the fascia to the vehicle and trim out the areas to clear the attachment tabs and convenient links. Reinstall the fascia and hook up electrical connections.

### CUSTOMER SERVICE COMMITMENT

Blue Ox® is committed to providing you with exceptional customer care throughout your lifetime with our products. Our team is here to assist you with any questions you may have regarding the performance of your product. Simply call (402) 385-3051 and you can speak with our customer care team.

Additionally, please visit our website to see which rallies our Destination America team will be attending. For a nominal fee, our service technician will service your towing system to ensure it's in proper working condition. Also, as a commitment to our customers, should you visit our factory, you can stay at our full service Blue Ox® campground at no charge along with enjoying a factory tour.

Again, thank you for being our customer and for the confidence you have shown in the performance of our products. It is because of customers like you we enjoy the success we have today.

© 2012 Blue Ox  
One Mill Road, Industrial Park  
Pender, Nebraska 68047  
Phone: (402) 385-3051  
Fax: (402) 385-3360  
[www.blueox.com](http://www.blueox.com)