



BX1505 Installation Instructions
1998 Buick Regal LS

Serial Number

The baseplate mounts to the metal bumper and to the frame of the vehicle. All six holes need to be drilled for installation. The attachment tabs will extend through the grill opening approximately four inches. The plastic facia needs to be removed for installation.

1. Look at the upper part of the center opening in the bumper facia. Remove the plastic push pins.
2. Remove the 5 push pins and the 8 Hex bolts from the bottom of the facia. Once this is done remove each corner piece and set aside.
3. Remove the 2 Phillips screws that are in front of each front tire.
4. Pull the plastic back and remove the four 10mm Hex bolts connecting the fenders and the plastic facia.
5. Open the hood and remove the five push pins from the top of the plastic.
6. Remove the three push pins holding the plastic center grill piece. Pull off the facia and set it aside.
7. Take a marker and label (starting on either end) the baseplate holes 1 through 6. See Figure 1.
8. Hold the baseplate (Item 1) up to the bottom of the metal bumper and center it around the frame surrounding the radiator. Mark and center punch the #3 hole on the frame and drill a 1/2" hole. Insert a 1/2" bolt plate with wire (Item 2) through the end of the metal bumper and into the 1/2" hole. Fasten the baseplate to the bolt plate using the 1/2" washer and Hex nut (Items 6 and 7). Apply Loctite to the bolt and torque it according to the chart in the general instruction sheet. Mark, punch and drill the #4 hole and bolt it to the frame with the same hardware used for the #3 hole. Torque the nut and bolt for the #4 hole.
9. Mark, punch and drill the #2 and #5 holes using the baseplate as a template. Use the 1/2 bolts, lock washers and Hex nuts (Items 8,9 and 7) as shown in the diagram on page 2. Loctite and torque bolts accordingly.
10. Drill holes for the #1 and #6 holes and use the 3/8" hardware as shown in the diagram on page 2. The 3/8" wire nuts can be inserted through the inside corners of the frame (bottom corners of the radiator). Loctite and torque bolts.
11. Replace the facia molding and lower corner pieces.
12. **DEALER OR INSTALLER: BE CERTAIN THE USER RECEIVES THE INSTRUCTION SHEET.**

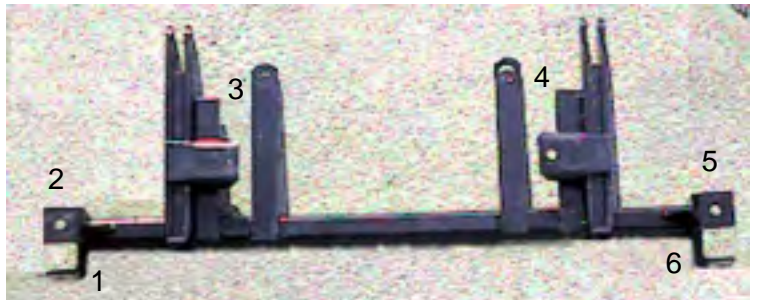
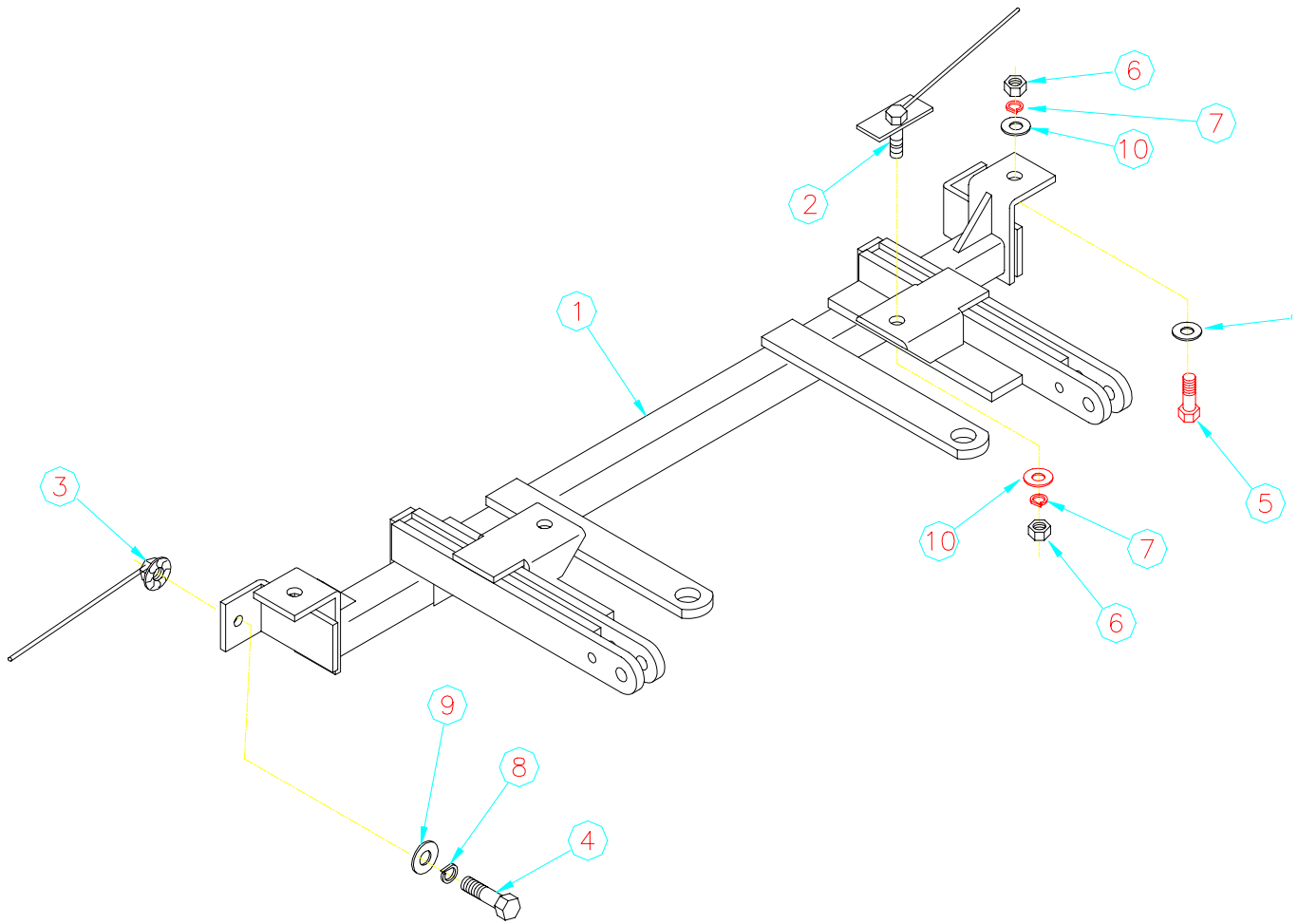

Figure 1





Tools Required

10MM Wrench
9/16" Wrench

Utility Knife
1/2" Drill Bit

Loctite 3/4" Wrench
3/8" Drill Bit Drill

Parts List

Ref. No.	Qty.	Part No.	Description
1	1	61-5346	Baseplate, BX1505
2	2	61-5348	1/2" Bolt Plate with Wire
3	2	61-5208	3/8" Nut Plate with Wire
4	2	203-0010	3/8" Lock Washer
5	2	201-0368	3/8"-16 x 1 1/4" Hex Bolt, Grade 5
6	4	202-0005	1/2"-13 Hex Nut, ZP
7	6	203-0005	1/2" Flat Washer
8	2	201-0051	1/2"-13 x 1 1/2" Hex Bolt, Grade 5
9	4	203-0012	1/2" Lock Washer
10	2	203-0003	3/8" Flat Washer