

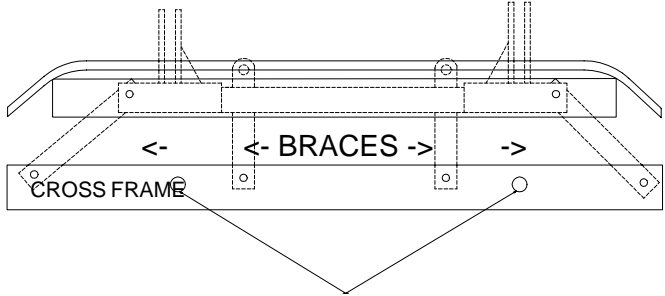

BX1930 Installation Instructions
1996-97 Dodge Caravan
1996-97 Chrysler Town & Country
1996-97 Plymouth Voyager

These vehicles weigh over 3500 lbs and require a Class III (5000 lbs) rated tow bar, hitch, and accessories. Utilization of Blue Ox baseplates with any tow bar not approved by Automatic Equipment Mfg. Co. invalidates the limited warranty.

Installation of this baseplate requires removing the bumper and the plastic air dam, both of which will need to be trimmed because of the baseplate. Holes will need to be drilled in the metal bumper.

1. Read the General Instruction Sheet included with this baseplate.
2. The bumper will need to be removed so the baseplate can be attached to the frame of the vehicle. There are five screws and two bolts on the top of the bumper and four bolts (two on each side) that connect the bumper to the side quarter panels. To get to these bolts, remove three of the phillips screws that hold the fender well molding to the bumper. You will need a 10mm wrench and a Phillips screwdriver. There are also ten push plugs on the bottom of the bumper that need to be removed. Disconnect the electrical connections to the lights before removing the bumper.
3. The black plastic air dam will need to be removed next. There are six bolts that will need to be removed. You will need a 10mm wrench for these bolts.
4. When the plastic bumper molding is removed, you will see a metal bumper with slotted holes in it. Center the baseplate (Item 1), left to right under the bumper and be certain holes in the braces (Items 2 and the center braces of the baseplate) extend over the cross frame of the vehicle to allow drilling and bolting. When the baseplate (Item 1) is centered correctly, mark and drill 17/32" holes.
5. The two braces that extend to the back frame will need to have 17/32" holes drilled also. Holes for the wire nuts will also need to be drilled. There are slotted holes that need to be drilled to 1" holes. There are two braces that extend from the outside of the baseplate to the outside edge of the frame. Bolt the braces to the baseplate and move them to the side of the frame, drill 17/32" holes.
6. Bolt the baseplate to the frame, once all the bolts have been started, and tighten. Be sure to use Loctite on all bolts to ensure that they will not loosen.
7. The air dam and bumper can now be replaced. Both will need to be trimmed because of the braces and baseplate. Start with the air dam and then the bumper.
8. Install the tow bar and safety cables according to the instructions included in their packages.
9. Do not substitute other devices if the tow bar pin and clip are lost.
10. DEALER OR INSTALLER: BE CERTAIN THE USER RECEIVES THE INSTRUCTION SHEET.

Automatic

3/4" Wrench
 Drill
 Center Punch

Tools Required
 17/32" Drill Bit
 1" Drill Bit

Loctite Blue
 Tape Measure

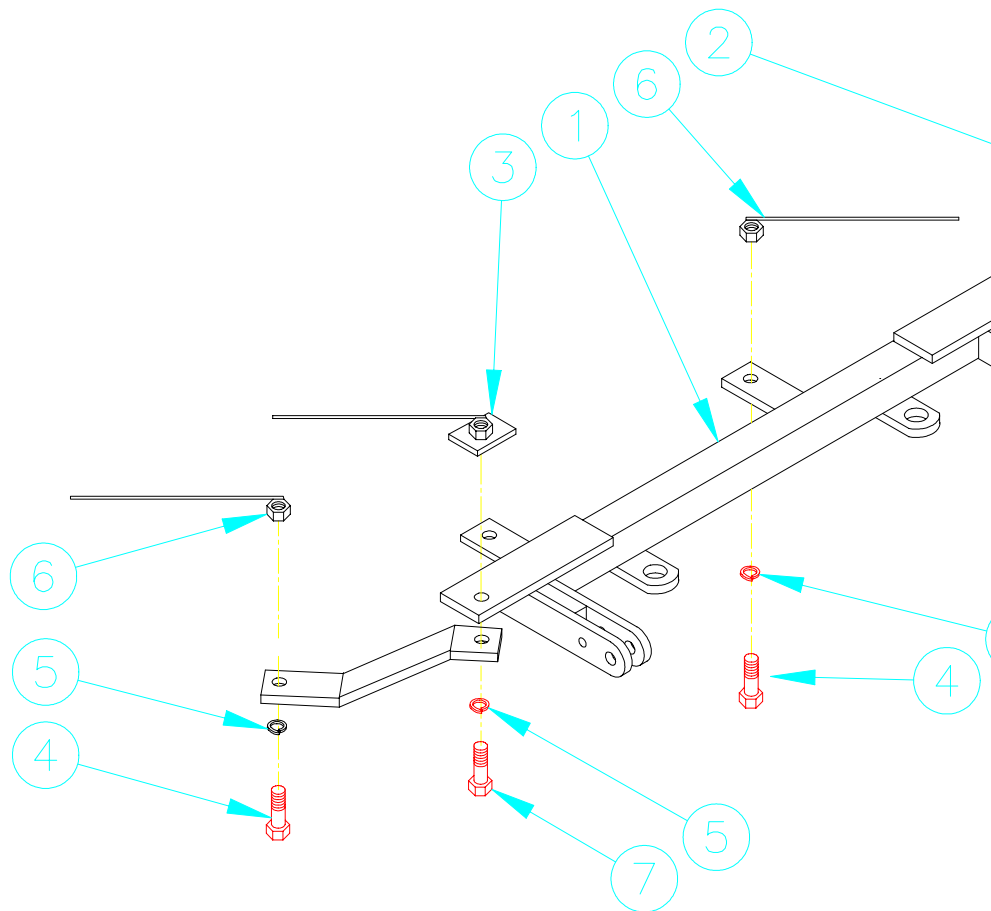

Parts List

Ref. No.	Qty.	Part No.	Description
1	1	61-4966	Baseplate BX1930
2	2	102-5300	Side Brace BX1930
3	2	61-4931	1/2" Nut Plate
4	4	201-0011	1/2-13 x 1 1/4" Hex Bolt, Grade 5
5	6	203-0012	1/2" Lock Washer
6	4	61-4029	1/2" Wire Nut
7	2	201-0283	1/2-13 X 2" Hex Bolt, Grade 5