



BX1931 Installation Instructions 1997-98 Mitsubishi Mirage

Utilization of Blue Ox base plates with any tow bar not approved by Automatic Equipment Mfg. Co. invalidates the limited warranty.

Installation of this baseplate requires removing the headlights, the small in the middle of the upper bumper and the bumper molding itself. Holes will need to be drilled in the vehicle's frame.

1. Read the General Instruction Sheet included with this base plate.
2. Remove the head lights so that the bumper molding can be removed. The head lights consist of two separate pieces. Remove the bolt and nut on the inside piece of the headlamps and the one bolting the two pieces together. When the nuts and bolts are removed, slide the outside piece out first.
3. The small grill located in the middle of the upper bumper can be removed by pulling back the small locking tabs on the back side of the grill. Now remove the 10mm bolts and braces on the top of the molding.
4. Remove all the screw rivets and bolts that are on the lower part of the bumper. Remove two of the small Phillips screws that hold the bumper molding to the fender well (the ones directly in front of the tires). There are two bolts that hold the molding to the quarter panels. One is located behind the outside head lamp area and the other is located behind the fender well molding directly in front of the tires. Now the molding can be removed.
5. Dimensional variations between otherwise identical cars can be considerable. While the location and size of the holes in the base plate were designed for easy installation, it may be necessary to file a hole to allow a bolt to clear.
6. The baseplate will mount to the upper and lower frame (in front of the radiator and below it) of the car. There are four 1/2" holes on the bottom of the cross frame which is directly in front of the radiator. Bolt the baseplate (Item 1) to the frame. Use the 1/2" bolts (Item 4), flat washer and lock washer (Items 5 and 6) and the wire nuts (Item 2) provided in the base plate kit. Insert the wire nuts (Item 2) through the holes on the back side of the frame. Be sure to use Loctite Blue with each bolt. Hand tighten the bolts.
7. The 3/8" bolts (Item 7), the flat and lock washers (Items 8 and 9) and the 3/8" wire nuts (Item 10) will be used on the lower brace of the baseplate (Item 1). Holes need to be drilled using a 7/16" drill bit in the frame of the car, use the slotted holes of the brace as a guide when drilling. Use Loctite blue with each bolt. Tighten all the bolts in steps 5 and 6.
8. Before the bumper molding can be replaced, it will need to be trimmed. With a helper place the bumper as close to its original position as possible. Mark the molding where it will need to be notched. Be careful not to notch the bumper too much. After the bumper is notched, replace the bumper, head lights and center grill.
9. Install the tow bar and safety cables according to the instructions included in their packages.
10. Do not substitute other devices if the tow bar pin and clip are lost.
12. **DEALER OR INSTALLER: BE CERTAIN THE USER RECEIVES THE INSTRUCTION SHEET.**

Automatic

Tools Required

1/2" Wrench
7/16" Drill Bit
C -Clamps

3/4" Wrench
Drill
Utility Knife

Loctite Blue
Phillips Screwdriver

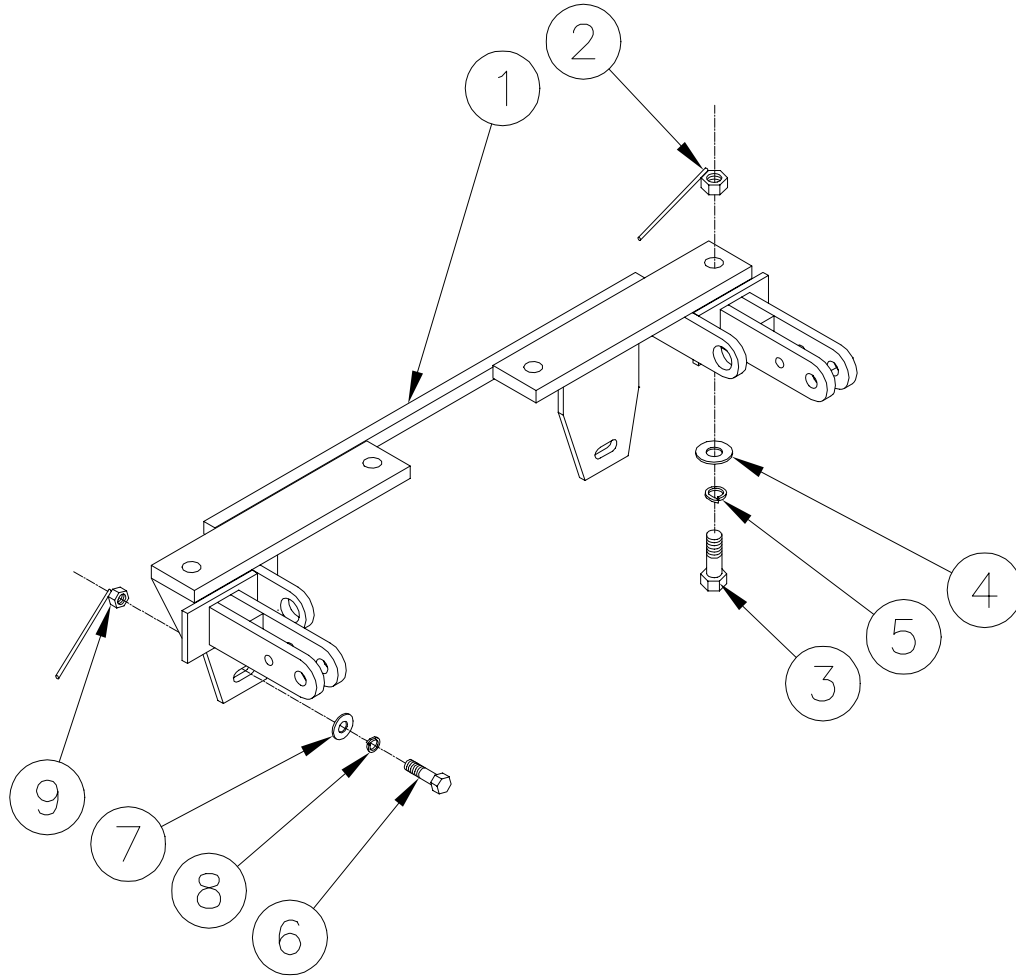

Parts List

Ref. No.	Qty.	Part No.	Description
1	1	61-4992	Weldment, BX1931
2	4	61-4029	1/2" Wire Nut
3	4	201-0068	1/2 - 13 x 1 3/4", Hex Bolt
4	4	203-0005	1/2" Flat Washer
5	4	203-0012	1/2" Lock Washer
6	2	201-0440	3/8 x 1 3/4", Hex Bolt
7	2	203-0003	3/8" Flat Washer
8	2	203-0010	3/8" Lock Washer
9	2	61-4978	3/8" Wire Nut