



BX1941

2000-02 Mitsubishi Eclipse (Includes Spyder) Installation Instructions

Installation of this baseplate requires removing the bumper fascia. Holes need to be drilled in the frame and metal bumper. The air dam needs to be trimmed.

1. Starting in the front fender wells, remove the three Phillip head plastic rivets that are directly in front of the tires. Also remove the 10mm Hex head bolt inboard of the plastic rivets.
2. Pull the fender well plastic out to expose/remove the 10mm Hex head bolts just below the seam of the fenders and fascia
3. Open the hood and remove the five 10mm Hex head bolts from the top of the fascia, remove the black piece on top of the fascia and set aside.
4. Remove the headlights by removing the three hex head bolts from each headlight. Disconnect the electrical from the back of the lights. Pull up on the front and out of the headlights to remove.
5. Notice along the bottom of the frame towards the front are two larger holes. Remove the bolts from all four holes. Now pull the bumper fascia and main bumper from the frame, there may be plastic push rivets that need to be removed to pull the fascia completely from the car. Separate the metal bumper (with foam) from the plastic fascia and bolt back onto the frame.
6. Remove the fog lights and set aside till after the baseplate has been installed. The baseplate mounts to the bottom of the metal bumper. The lower braces set in the formed lower cross frame (outside of the engine support). The plastic formed in front of the lower cross frame will need to be neatly trimmed to allow the lower braces to set in place correctly. Mark the center of the bumper (on the styro foam) and also mark the center of the baseplate.
7. Hold the baseplate up to the bottom of the metal bumper (center) with the braces through the plastic setting in the formed areas on the cross frame. Center punch one of the two 1/2" holes going to the metal bumper and drill. Use the 1/2" wire nut (Item 2), insert it through the side of the lower section of the metal bumper and the 1/2-13 x 1 1/2 Hex bolt with lock washer. Hand tighten only and do the same for the other side. Apply Loctite to each bolt.
8. Hold the lower braces up to the metal of the cross frame, mark/drill the 3/8" holes. Use the 3/8-16 x 1 1/4 Hex bolt, lock washer and 3/8 nut with wire. Once all four bolts have been started tighten and torque each bolt according to the torque chart in the General Instruction Sheet. Either bend out of the way or cut the excess wire from the wire bolt plates and wire nuts used.
9. Replace the fog lights and bumper fascia. It may be necessary to trim the back of the fascia to allow it to sit in its original position. It may be necessary to pull out on the outside piece of the fog light brackets to replace them.
10. Install the tow bar and safety cables according to the instructions included in their packages.
11. DEALER OR INSTALLER: BE CERTAIN THE USER RECEIVES THE INSTRUCTION SHEET.

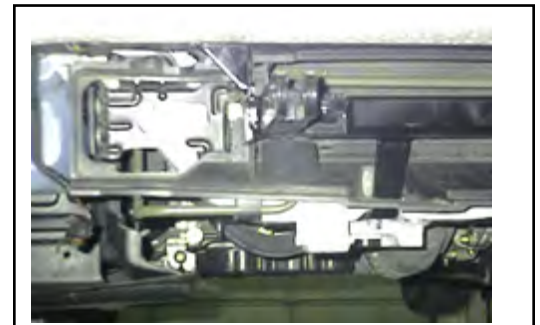

Fog Lights Removed



Fog Lights Replaced

Tools Required

3/4" Wrench
3/8" Drill
Center Punch

1/2" Drill Bit
9/16" Wrench
Utility Knife

Loctite Blue
Straight Screwdriver
Phillip Screwdriver

Parts List

Ref. No.	Qty.	Part No.	Description
1	1	61-5393	BX1941 Baseplate
2	2	61-5459	1/2"-13 Bolt Plate with Wire
3	2	61-5208	3/8"-16 Nut Plate with Wire
4	2	202-0005	1/2"-13 Hex Nut, ZP
5	2	203-0012	1/2" Lock Washer
6	2	201-0440	3/8"-16 x 1-1/2" Hex Bolt, Grade 5
7	2	203-0010	3/8" Lock Washer
8	2	201-0553	1/4"-20 X 1/2" Hex Bolt
9	2	101-5822	4 Way Connector Adapter
10	2	202-0047	#10-32 Hex Nut
11	2	203-0054	#10 Lock Washer
12	2	201-0192	#10-32 x 1/2" Rd. Hd Screw
	2	226-0046 (not shown)	36" Class III Safety Cables
	4	229-0359 (not shown)	3/8" Quicklink, ZP



CUSTOMER SERVICE COMMITMENT

Blue Ox® is committed to providing you with exceptional customer care throughout your lifetime with our products. Our team is here to assist you with any questions you may have regarding the performance of your product. Simply call (402) 385-3051 and you can speak with our customer care team.

Additionally, please visit our website to see which rallies our Destination America team will be attending. For a nominal fee, our service technician will service your towing system to ensure it's in proper working condition. Also, as a commitment to our customers, should you visit our factory, you can stay at our full service Blue Ox® campground at no charge along with enjoying a factory tour.

Again, thank you for being our customer and for the confidence you have shown in the performance of our products. It is because of customers like you we enjoy the success we have today.

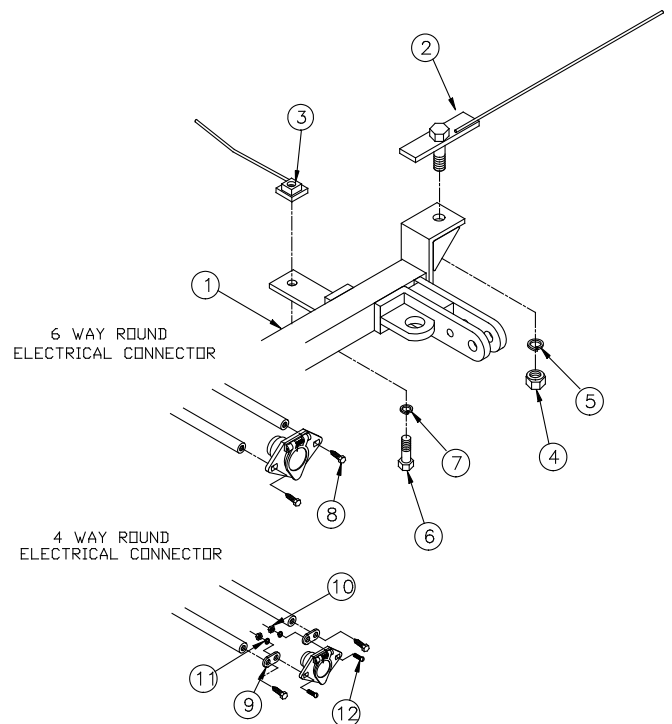

© 2002 Blue Ox
One Mill Road, Industrial Park
Pender, Nebraska 68047
Phone: (402) 385-3051
Fax: (402) 385-3360
www.blueox.com