



EX2308 Installation Instructions  
1999-00 Hyundai Elantra

Serial Number

**The baseplate mounts to the frame of the vehicle. Two holes need to be drilled for installation. The bumper molding and the turn signals are removed for installation. The attachment tabs will extend through the grill opening approximately four inches. Fog lights need to be removed permanently for baseplate installation.**

1. Open the hood and remove the four plastic push pins from the top of the bumper molding.
2. Locate and remove the small Phillips screw connecting the head lights and the turn signals. Pull the turn signals out and disconnect the electrical from the plastic assembly. Set the turn signal assemblies aside.
3. Look inside the signal openings locate and remove the 10mm Hex nut.
4. On the bottom of the bumper molding on the outside edges are two Phillip head screws connection the wheel well plastic to the bumper molding. Remove the screws from each side of the vehicle.
5. Pull the plastic fender well molding out, locate and remove the 7mm Hex head bolt connecting the fenders and bumper molding.
6. In the lower grill opening locate and remove the plastic push pins from the upper grill area.
7. On each side of the frame are bolts connecting the frame to the front main bumper. Locate and remove these bolts from each side. (14mm)
8. Next locate the two lower bolts that hold the lower frame supporting the engine. Remove the passenger side bolt.
9. Hold baseplate up aligning the baseplate to the bolt holes from step 8. Use existing bolts. Apply Loctite to each bolt.
10. Notice the two braces outboard of the middle brace. Drill a 3/8" hole into the frame. Use the 3/8" Hex bolts, lock washers and the 3/8" nut plate with wire and fasten the two braces to the frame of the car. Apply Loctite to each bolt.



Note: Tighten and torque all bolts according to the chart in the General Instruction Sheet.

11. Replace the bumper molding, fender well molding and the turn signals to original position. The two push pins that go into the grill opening will not be used again.
12. Install the tow bar and safety cables according to the instructions included in their packages. Do not substitute other devices if the tow bar pin and clip are lost.
13. **DEALER OR INSTALLER: BE CERTAIN THE USER RECEIVES THE INSTRUCTION SHEET.**



**Automatic**

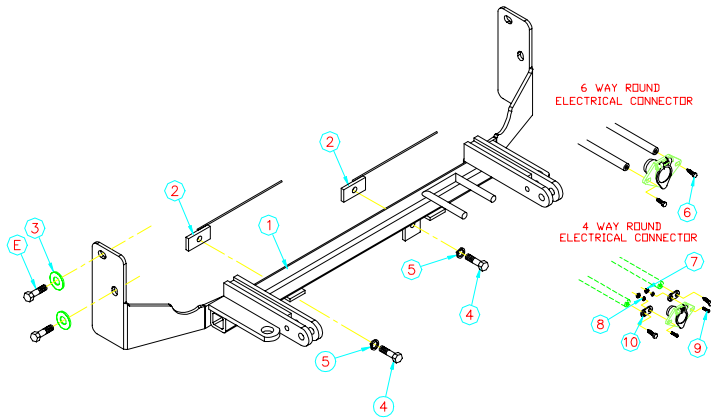

**Tools Required**

- |                      |                |         |             |
|----------------------|----------------|---------|-------------|
| 10MM Wrench          | 7MM Wrench     | Loctite | 14MM Wrench |
| Phillips Screwdriver | 3/8" Drill Bit | Dill    | 17MM Wrench |
|                      | 9/16" Wrench   |         |             |

**Parts List**

Ref. No.	Qty.	Part No.	Description
1	1	61-5356	Baseplate, BX2308
2	2	61-5367	3/8 Nut Plate 1/4 x 1 x 1 with Wire
3	4	203-0005	1/2 Flat washer, ZP
4	2	201-0368	3/8-16 x 1 1/4 Hex Bolt, Grade 5
5	2	203-0010	3/8 Lock Washer
6	2	201-0553	1/4-20 x 1/2 Hex Bolt
7	2	202-0047	#10-32 Hex Nut
8	2	203-0054	#10 Lock washer
9	2	201-0192	#10-32 x 1/2 Slot, Rd. Hd Screw
10	2	101-5822	Adapter, 4 way Connector
E	4		Existing Bolt