



Figure 9

9. Use baseplate as a template and drill 3/8" holes for the lower bracing. Figure 9. Use 3/8" hardware as shown in drawing on last page. Insert the wire nut plate through the opening next to drilled hole. Use Loctite on each bolt.



Figure 10

10. Follow same procedure as in step 9 for the upper braces. Figure 10. Tighten all bolts according to the Torque Chart in the General Instruction Sheet.



Figure 11

11. Replace bumper molding and headlight assemblies. DEALER OR INSTALLER: BE CERTAIN THE USER RECEIVES THE INSTRUCTION SHEET.

Tools Required

- | | | |
|-----------------------|----------------|--------------|
| 14MM Wrench | 9/16" Wrench | Loctite Blue |
| 10MM Wrench | 3/8" Drill Bit | Wire Cutter |
| Phillips Screw Driver | | |

Parts List

Ref. No.	Qty.	Part No.	Description
1	1	61-5510	Weldment Baseplate, BX2309
2	4	61-5208	3/8 Nut Plate with Wire
3	4	201-0404	3/8 -16 x 1 3/4 Hex Bolt, Grade 5
4	4	203-0010	3/8 Lock Washer
5	2	201-0553	1/4-20 x 1/2 Self Tapping Hex Nut
6	2	201-0192	#10-32 x 1/2 Slot, Rd. Hd. Screw
7	2	202-0047	#10-32 Hex Nut
8	2	203-0054	#10 Lock Washer
9	2	101-5822	Adapter, 4 Way Connector
E	4		Existing Bolts, Tie Down Brackets

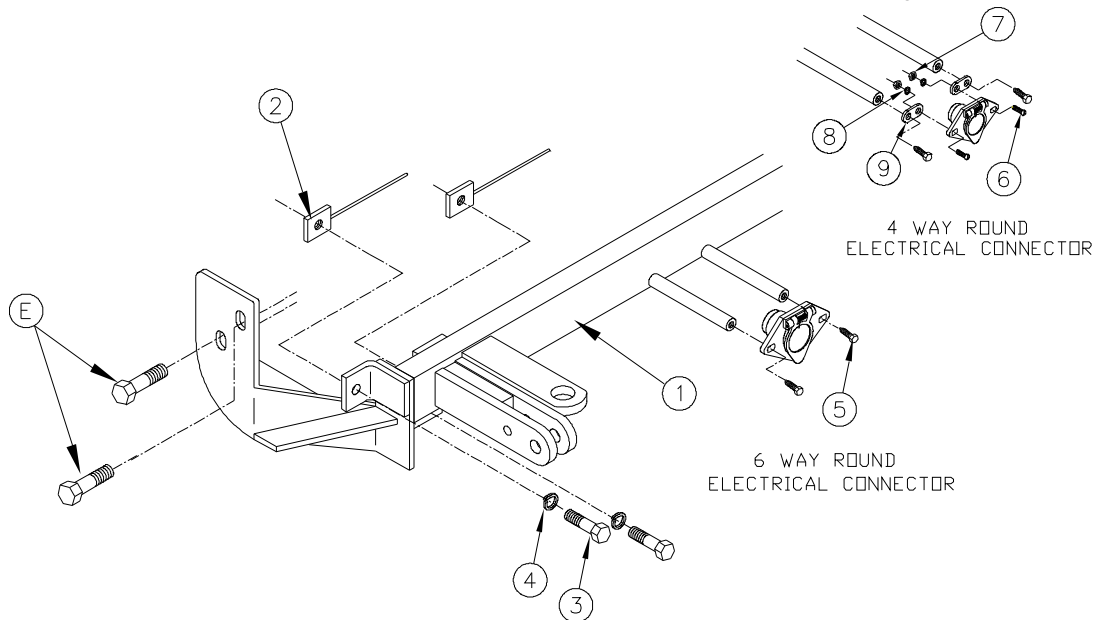



**Installation Instructions BX2309
Hyundai Accent 1999-2000**

Serial No.

The front bumper fascia and headlights are removed also holes need to be drilled for baseplate installation.



Figure 1

1. Open the hood and remove the Phillip screws on the bumper fascia. Figure 1.

2. Remove the screw holding the headlight assemblies and pull headlights out. Figure 2.



Figure 2

3. Once headlights are off, remove the Phillips head screw and 10mm Hex head bolt exposed (for each side). Figure 3.

4. Remove the Phillip head Screws from the bottom of the bumper fascia. Figure 4.



Figure 3

5. Look up from bottom of fascia and remove or cut plastic pins. These pins will not be replaced. Figure 5.

6. Pull fender molding back and remove Phillip head screw. Figure 6. Pull bumper fascia from vehicle.



Figure 4

7. Remove each tie down bracket from vehicle. Figure 7. The fluid reservoir needs to be loosened for access to passenger side bolts. Figure 8.

8. Hold baseplate up to the vehicle so side plates are positioned over the holes from the tie down brackets and using four of the original bolts (two on each side) fasten the baseplate to the car. Figure 8.



Figure 5



Figure 6



Figure 7



Figure 8

Automatic