



Installation Instruction BX2403

Isuzu Rodeo 1998-2002

Isuzu Amigo 1998-01 4WD

Honda Passport 1998-02

The steel belly pan will need to be removed for installation of the baseplate. The baseplate is bolted between the tow hooks and uses the front bolt holes used by the steel belly pan. The main weldment will be exposed after installation.

1. There are four bolts that hold the steel belly pan. First remove the two back bolts with a 14mm wrench. Then loosen the front two bolts, slide the belly pan back and remove. Remove the two front bolts completely.
2. Position the baseplate between the two tow hooks, there are existing holes that match to the baseplates bolt holes. Use the 3/8 x 1 1/4" bolts, 3/8" lock washer and nut (Items 3, 5 and 6) on the back holes. Use the 3/8 x 1 1/2" bolts (Item 2) for the front holes that extend through the baseplate tube. Use Loctite Blue on each bolt to ensure they do not loosen while the car is being towed.
3. The back braces of the baseplate will match to the holes used by the steel belly pan. Hold the baseplate up to the metal frame then replace the steel belly pan. Use the 10mm - 1.25 x 30mm bolts with 10mm lock washer (Items 4 and 7) for the front holes. Use the original bolts for the back of the belly pan. Tighten all bolts.
4. The dimensional variations between otherwise identical cars can be considerable. While the location and size of the holes in the baseplate were designed to allow for easy installation, it may be necessary to ream a hole slightly to allow a bolt to clear.
5. Install the tow bar and safety cables according to the instructions included in the pack6. Do not substitute other devices if the tow bar pin and clip are lost.
7. DEALER OR INSTALLER: BE CERTAIN THE USER RECEIVES THE INSTRUCTION SHEET.

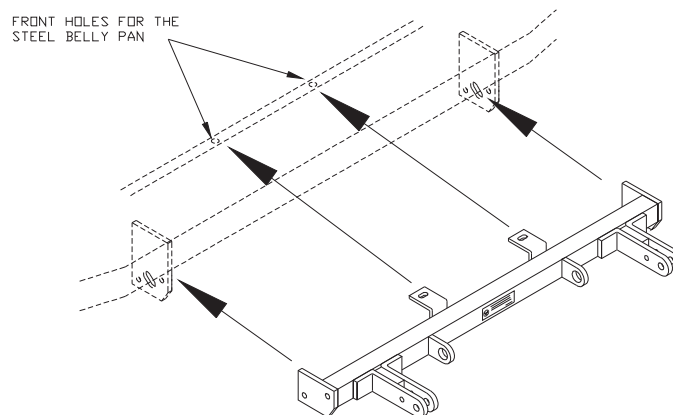

Automatic

Tools Required

14MM Wrench
9/16" Wrench

14MM Socket
9/16" Socket

Loctite Blue

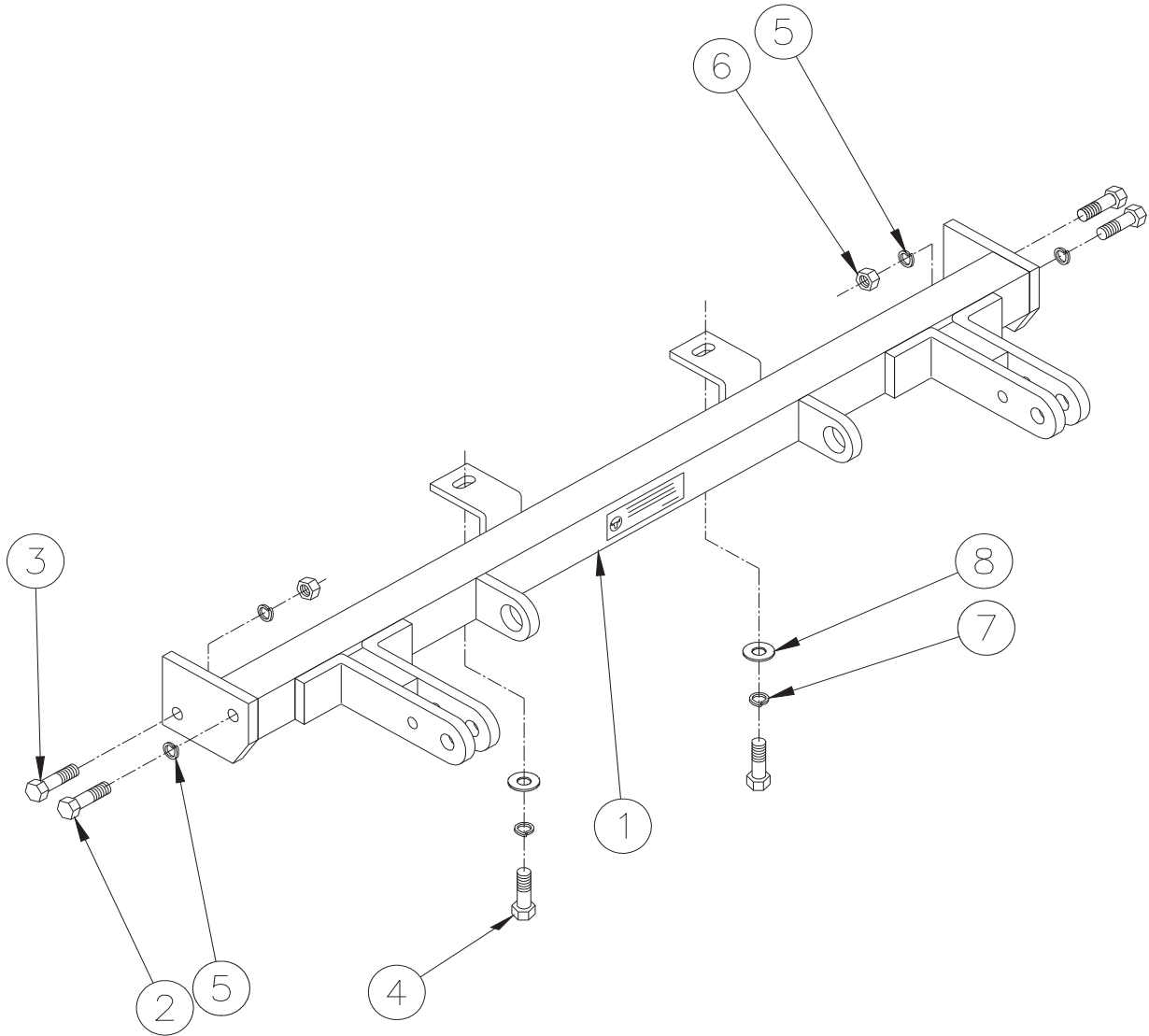

Parts List

Ref. No.	Qty.	Part No.	Description
1.	1	61-5193	Weldment Baseplate BX2403
2.	2	201-0440	3/8-16 x 1 1/2 Hex Bolt, Grade 5
3.	2	201-0368	3/8-16 x 1 1/4 Hex Bolt, Grade 5
4.	2	201-0422	10MM-1.25 x 30MM Hex Bolt, Grade 8.8
5.	4	203-0010	3/8 Lock Washer
6.	2	202-0003	3/8 - 16 Hex Nut
7.	2	203-0104	10MM Lock Washer
8.	2	203-0103	10MM Flat Washer
	2	226-0046	Baseplate Safety Cable, 36" CL III (Not Shown)
	4	229-0359	Quicklink, 3/8, ZP (Not Shown)