



INSTALLATION INSTRUCTIONS UTILITY VEHICLE (UTV) SIDE MIRROR

M37 - Left (Driver) Side/Flat Glass
M38 - Right (Passenger) Side/Flat Glass
M39 - Pair/Flat Glass

PARTS LIST



Bar Clamp (1 per side)



Lock Washer
(2 per side)

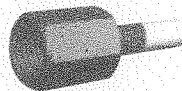

Machined Mount
(1 per side)



Adjusting Nut
(1 per side)

TOOLS NEEDED



11/16" Open End Wrench



3/4" Open End Wrench

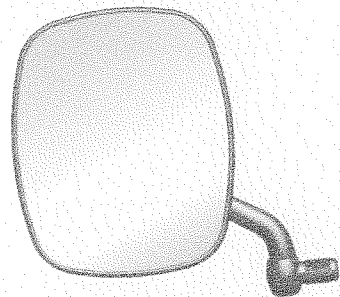

Mirror Assembly (1 per side)

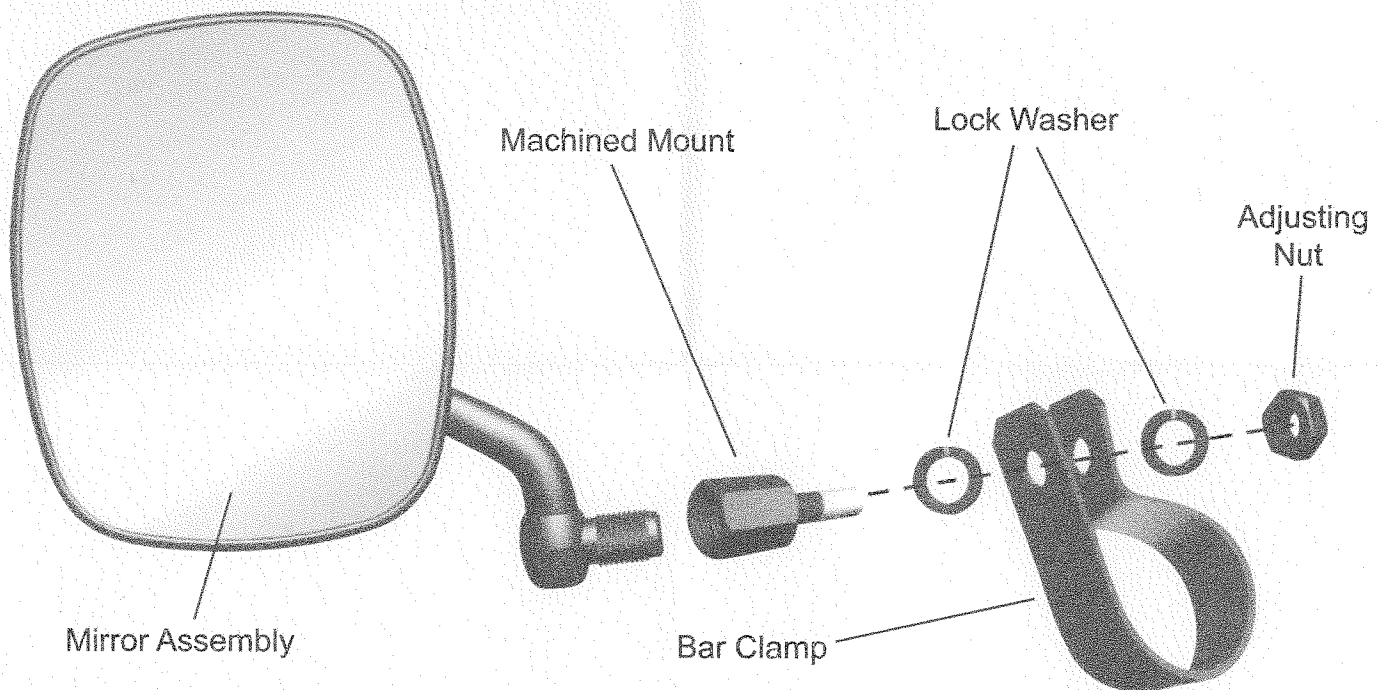

Preparation:

- 1 - Clean all mounting surfaces before beginning installation
- 2 - Apply a medium-strength thread-locking agent (such as Threadlocker 242 by Loctite) to bolts before installation

Installation:

- 1 - Install the Clamp around the frame tube on the appropriate side of the vehicle. The clamp should be installed so that the mirror is positioned on the front side of the frame tube, with the flat side of the clamp facing outward
- 2 - Install the mirror into the mount and tighten snugly. Do not use thread locking agent on this connection, and do not over-tighten as damage to the plastic threads may occur.
- 3 - Install one of the lock washers onto the mount, and then install the mount through the hole in the clamp.
- 4 - Install the second lock washer and the nut, but do not tighten fully.
- 5 - Adjust the position by sliding the mirror up or down the frame tube to the desired location, and rotating until the best view is achieved
- 6 - Tighten the nut to 7in-1b.

Maintenance, Care and Cleaning:

Periodically check fasteners for tightness and re-torque as needed. Clean with mild soap and water solution and a soft cloth.