



Extendable Trailer Towing Mirror Installation Instructions

For: All Dodge Ram Trucks 2002 – 2006



**CIPA Part Numbers
73200, 73600 & 83100**

WARNING

Manufacturer recommends this installation be carried out by a professional installer or your local dealership. **PLEASE** read **ALL INSTRUCTIONS** and warnings carefully before installing this product. These mirrors are designed only for the vehicle listed on this page. Ensure that the fitting instructions are followed exactly, as failure to do so may result in incorrect installation, or result in the driver, passenger or vehicle being placed in a hazardous condition, as well as voiding any warranty, implied or otherwise.

PARTS LIST

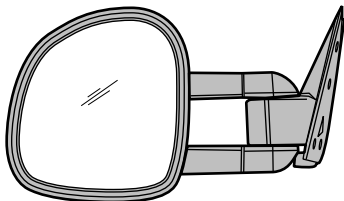

Driver's Side Mirror

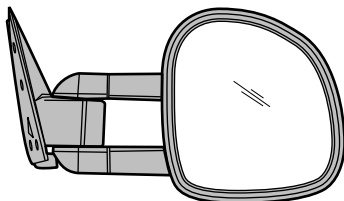

Passenger Side Mirror



Installation Instructions



10mm Nut (x6)

TOOLS NEEDED



Ratchet



10mm Socket

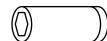

13/16 Socket

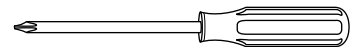

Phillips Screwdriver

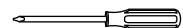

Small Slotted Screwdriver

Note: Two people are required for proper installation of this product.

STEP ONE

Removing Trim Panel

Open the door and roll the window completely down.

Use a Phillips screwdriver to remove the screws in the trim panel. Set the screws aside to be reused.

Use a trim panel removal tool (or small slotted screwdriver) to remove the instrument panel cover.

Gently lift up to remove Trim Panel

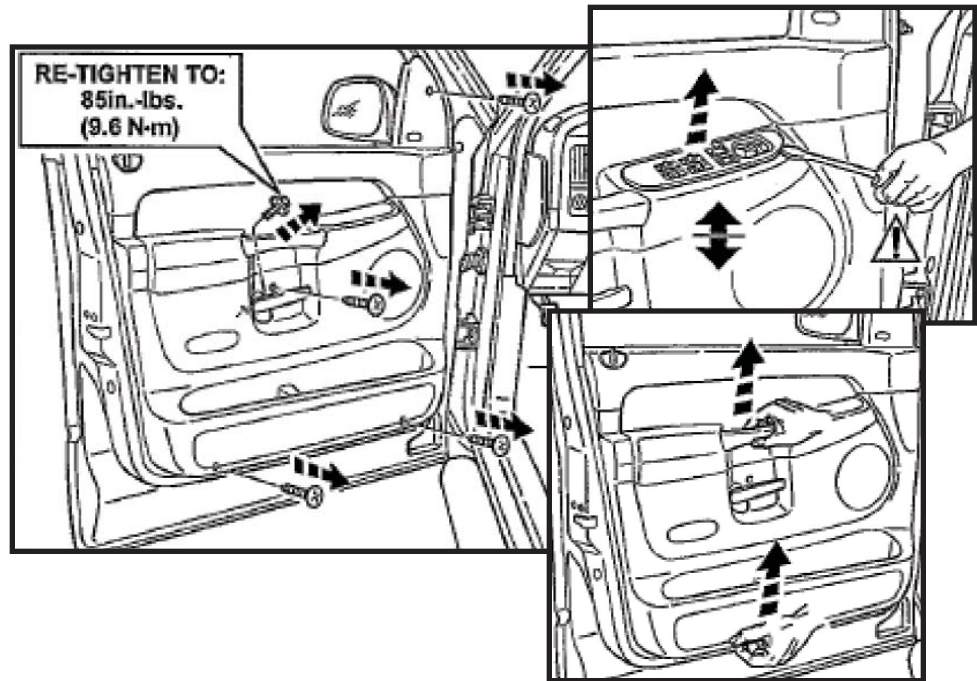

STEP TWO

Disconnecting Electrical Connector – Electric Mirrors Only

For manual mirror installation proceed to Step Three.

If you are installing an electric mirror, pull the wiring harness out of the door to access the plug. Gently pry the locking tab on the side of the plug and pull the harness away. **DO NOT** allow the harness and connector to fall into the door cavity.

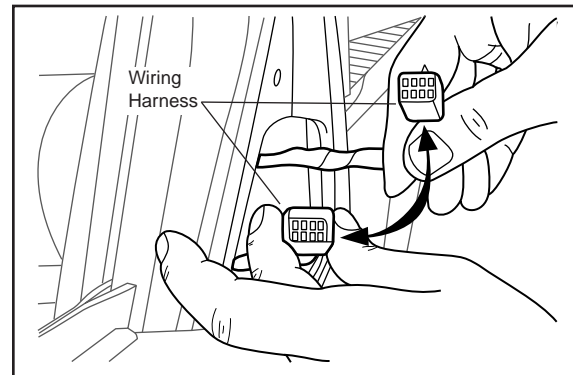

STEP THREE

Removing Factory Mirror

While a second individual holds the factory mirror, use a socket to remove the three 10mm nuts inside the door. Make sure not to drop loose nuts into door cavity. Slowly remove factory mirror from door.

If the vehicle is equipped with an electrical harness feed it through as the mirror is removed.

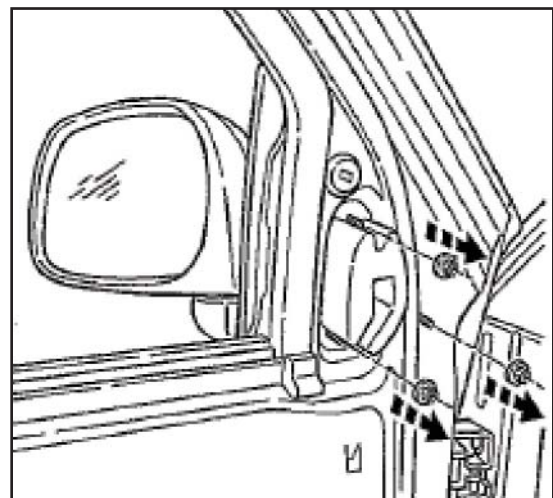

STEP FOUR
Reconnecting Electric Mirror

If you are installing an electric mirror, feed the wire harness through the center hole in the door and also through the center access hole of the reinforcement plate. Connect the wiring harness to the plug in the door.

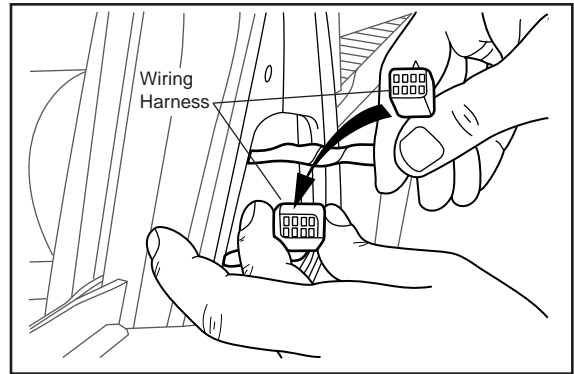

STEP FIVE
Installing Extendable Trailer Tow Mirror

Clean any foreign material from sheet metal of door exterior with a clean, soft cloth.

Slide the studs on the mirror into the holes in the door. While a second person holds the mirror in place, thread a 10mm nut from the parts kit onto the two bottom studs and the one 10mm bolt to the top hole. Once the nuts and bolt are installed on each stud, tighten them in an alternating pattern to 40 in. lbs.

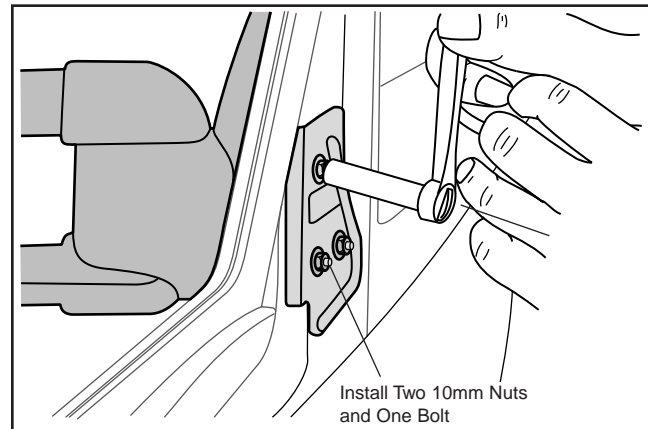

STEP SIX
Finishing Installation

Replace the trim panel. Reinstall the phillips screw removed in Step One.

STEP SEVEN

Repeat this installation procedure with the remaining mirror on the other side of the vehicle.

This completes the installation of your Towing Mirror.