

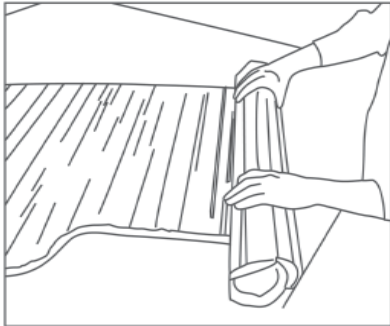

Custom Patterned FLEX SHADE™ UV WINDSHIELD SUNSCREEN

Your new FlexShade is patterned from an outline of the front windshield, to block as much UV rays as possible from entering your vehicle. Due to A-pillar location and rear-view mirrors it may not be possible to block the entire glass area, but our custom pattern will provide maximum coverage and assure easy installation and removal.

Before using your FlexShade you must do the following:



Place the Flexshade on a flat surface and roll it up.

- Be sure the surface facing outside of the vehicle is on the flat surface. The outside facing surface has a FlexShade tag sewn into the binding.
- The “inside” of the FlexShade has a hook & loop tab affixed to one side of the shade.
- Roll the cover **towards** the hook & loop tab.

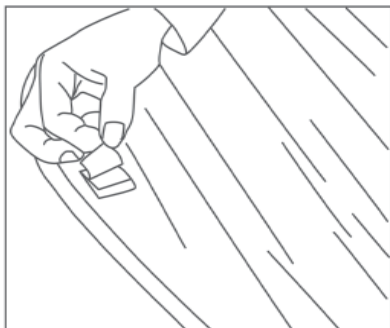

Remove the cover sheet from the hook & loop tab.

- This will expose an adhesive surface. Do not touch the adhesive surface, or allow it to contact anything.

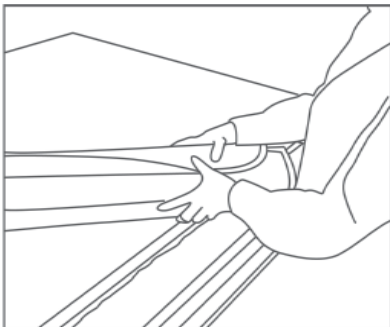

Gently press the cover together, finishing the roll-up process.

- Hold the FlexShade in this fashion for 30 seconds.
- You can then open the FlexShade for use. A piece of the hook & loop security tab will remain on each piece of the shade.

Your FlexShade is now ready for use. When not in use you simply roll it up and the hook & loop tab will secure the rolled shade for storage.

To use the FlexShade:

- 1 - Unfasten the security tab
- 2 - Start from the passenger side and unroll the shade across the windshield.
- 3 - Fold down the sun visors to hold it in place.



Reverse process to remove.