



IMPORTANT WARRANTY & INSTALLATION
INSTRUCTIONS ATTACHED

*Please Forward All Attached Information to Consumer
Warranty Not Valid Unless Returned to CORSA Performance*

We ask that you take a few moments to complete our warranty registration form:

TO ACTIVATE YOUR LIMITED LIFETIME WARRANTY GO TO:
CORSAPERFORMANCE.COM/WARRANTY



**For Full-Color Installation Instructions, Please Visit:
CORSAPERFORMANCE.COM and Search by Part Number**

Please be sure to review the enclosed instructions prior to beginning the installation process. If you have any questions about the enclosed parts, instructions or encounter a problem during installation:
CALL CORSA PERFORMANCE TECHNICAL ASSISTANCE AT 800.486.0999

Please take time to read and understand these installation instructions.

CORSA recommends that the installation of this system be performed by a qualified service center or professional muffler installer who has the necessary equipment, tools and experienced personnel. However, if you decide to perform this install, the use of a hoist and an additional person will be required.

CAUTION: Never work on a hot exhaust system. Allow time for the vehicle to cool. Always wear eye protection when working under a vehicle.

Recommended Tools:

- Ratchet
- 13mm socket
- 15mm socket
- Grommet Pullers
- Soap & Water Solution
- Torque Wrench
- Safety Glasses

Please confirm that all parts are present according to the bill of materials before beginning the installation.

If something is missing call Tech Support at 1- 800-486-0999

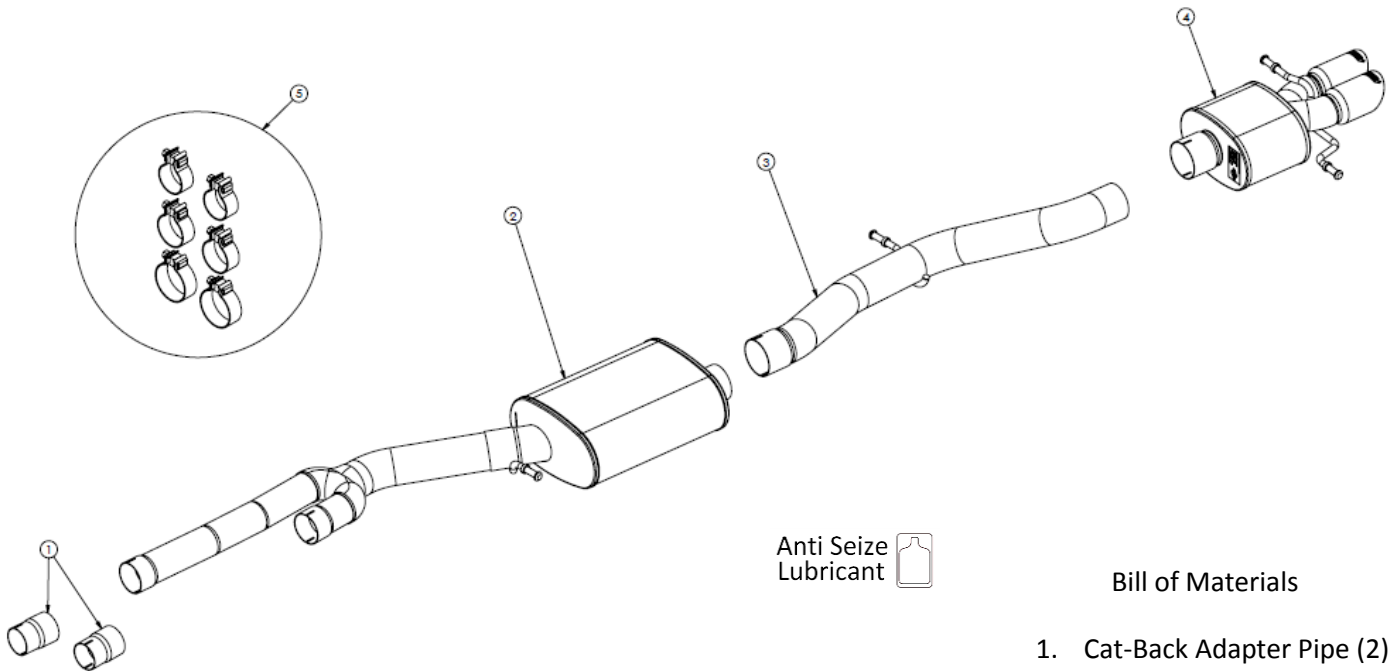

Anti Seize
Lubricant 

Bill of Materials

1. Cat-Back Adapter Pipe (2)
2. Tunnel Muffler Assembly
3. Axle Pipe Assembly
4. Rear Muffler Assembly
5. Hardware Kit
6. Anti-Seize Lubricant Packet

Factory Exhaust System Removal:

The factory exhaust system will be removed in one section. Having another person to assist with removal of the cat-section is highly recommended.

1. Using a 13mm socket and ratchet, loosen the bolts on the sleeve clamps connecting the cat-back section to the downpipes. **(See Fig. A, B)**
2. Support the front part of the cat-back section using another person or stand to keep the front of the exhaust from falling. **(See Fig. C)**
3. Using grommet pullers or similar device, remove the factory hanger from the factory grommet near the stock tunnel muffler. **(See Fig. D)**
NOTE: The use of a soapy water solution may aid in the removal and later installation of the hangers in the rubber isolators.
4. Remove the axle pipe hanger from the factory grommet. **(See Fig. E)**
5. While supporting the rear of the cat-back section, remove the rear muffler hanger from the factory grommet **(See Fig. F, G)**. The cat-back section will now be free to remove from the vehicle.
6. Pull the cat-back towards the rear of the car first to separate the cat-back section from the sleeve clamps. Then lower the cat-back section and remove from the vehicle. Also remove the sleeve clamps at this time.
7. The stock system removal is now complete.

Factory Exhaust Removal Pictures

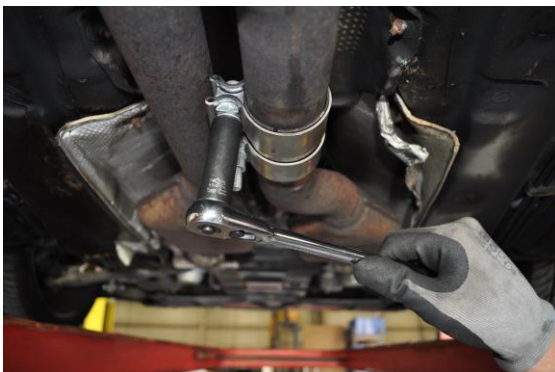

Fig. A



Fig. B

CONTINUED ON NEXT PAGE



Factory Exhaust Removal Pictures

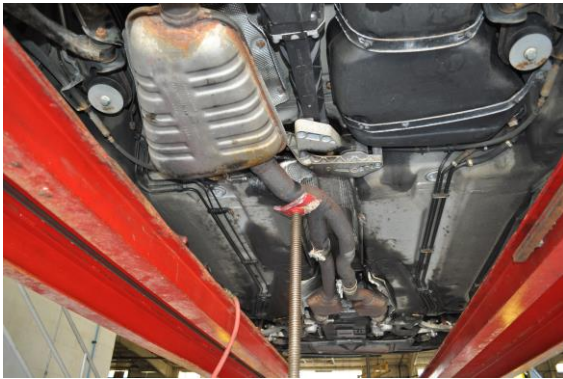

Fig. C



Fig. D

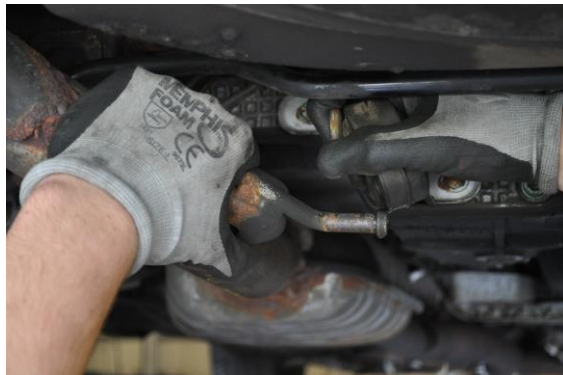

Fig. E



Fig. F

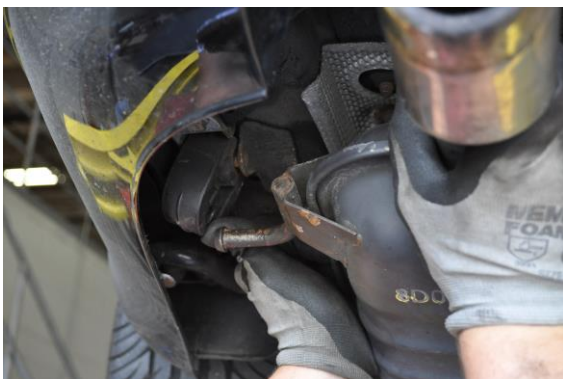
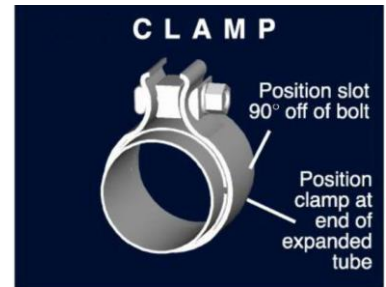

Fig. G

Installation of CORSA Exhaust System:

NOTE: Apply the anti-seize lubricant (*supplied*) to the threads **ONLY** of all the clamps and flange bolts. Failure to follow this procedure can cause nuts to seize on clamps and potentially destroy threads. After applying anti-seize lubricant, be sure to thoroughly clean your hands, as lubricant will tarnish stainless steel. All clamps should be tightened using a properly calibrated Torque Wrench. Using an air impact gun will damage the clamp and reduce its ability to effectively seal the joint. It may also cause the joint to separate, thereby causing damage to your exhaust system and to your vehicle.

NOTE: Align all clamps so that the center of the clamp bolt is 90 degrees from the notch in the pipe. (See Fig. CLAMP)



1. Remove all exhaust system components from the shipping carton, including the 6 exhaust clamps (two 2.25", two 2.5", & two 3.0").
2. If connecting to CORSA downpipes, skip this step and go to step #3. If connecting to the stock downpipes, locate the two CORSA cat-back adapter pipes and two 2.25" clamps. Slide the 2.25" clamps over the notched side of the adapter pipes and slide onto the stock downpipes with the notches and clamps oriented towards the center of the car as shown. (See Fig. H, I, J).
3. Locate the CORSA tunnel muffler assembly and two 2.5" clamps. Slide one clamp over each inlet of the tunnel muffler assembly. Slide the inlets of the tunnel muffler assembly onto the cat-back adapter pipes/downpipes. Insert the hanger into the factory rubber grommet. A soapy water solution will aid in the installation process of the hangers. While supporting the rear of the tunnel muffler, loosely snug the 2.5" clamps at the front of the tunnel muffler assembly using a 15mm socket and ratchet. Keep the tunnel muffler supported until system installation is complete. (See Fig. K, L, M)
4. Locate the CORSA axle pipe and one 3.0" clamp. Slide the 3.0" clamp over the expanded end of the axle pipe and slide the expansion over the outlet of the tunnel muffler. Insert the hanger into the factory rubber grommet. Loosely snug the clamp using a 15mm socket and ratchet. (See Fig. N, O, P)
5. Locate the CORSA rear muffler and one 3.0" clamp. Slide the 3.0" clamp over the expanded end of the rear muffler and slide the expansion over the axle pipe outlet. Insert the hangers into the factory rubber grommets. Loosely snug the clamp using a 15mm socket and ratchet. (See Fig Q, R, S, T)
6. Visually inspect the exhaust system position, tip alignment, clamp orientation, and exhaust system clearances (See Fig U, V). Make any necessary adjustments at the clamp joints.

CONTINUED ON NEXT PAGE 

7. Once the exhaust system is in the desired location, starting at the front of the system, tighten all exhaust clamps to 45 ft-lbs. After all clamps have been tightened, remove support from the tunnel muffler. Re-check tunnel muffler clearance, loosen clamps and readjust if necessary.

8. It is strongly suggested that all clamps be checked and re-tightened (if necessary) to the recommended torque after initial road resting of the vehicle, as thermal cycling has occurred on the system. Please wait until system has fully cooled to perform this step.

NOTE: During cold weather start-ups, you may experience an exhaust sound that is deeper and louder in tone than usual. This is temporary and will diminish to normal levels once your engine has reached its normal operating temperature.

NOTE: Immediately following the installation of your exhaust system, you may experience a trace of smoke after initial start-up. DO NOT be alarmed. The smoke is caused by the burning of a small amount of forming oil residue used in the manufacturing process.

INSTALLATION PICTURES ON NEXT PAGE 

CORSA Exhaust Installation Pictures



Fig. H



Fig. I



Fig. J



Fig. K



Fig. L

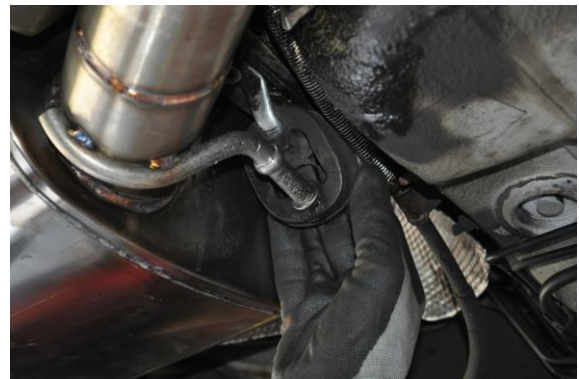

Fig. M

CONTINUED ON NEXT PAGE 

CORSA Exhaust Installation Pictures:



Fig. N



Fig. O



Fig. P



Fig. Q



Fig. R

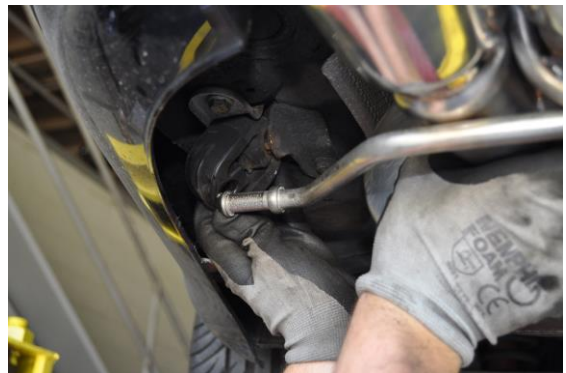

Fig. S

CONTINUED ON NEXT PAGE 

CORSA Exhaust Installation Pictures:



Fig. T



Fig. U



Fig. V