

VW® PASSAT FRONT DOOR PANEL INSERT INSTALLATION INSTRUCTIONS

IMPORTANT:

- READ ALL INSTRUCTIONS BEFORE ATTEMPTING TO INSTALL INSERTS.
 - MAKE SURE YOU HAVE THE CORRECT INSERTS FOR YOUR AUTOMOBILE.
 - TO VIEW AN INSTRUCTIONAL VIDEO PLEASE VISIT OUR WEBSITE: www.coverlaymfg.com
1. **Installing driver's side front door insert - Steps 1.a through 1.c, are for driver's side front door only.**
 - a. Using a utility knife or razor blade, cut along lines shown in figure 1-a, to ensure fabric lays flat. Gluing down fabric is not necessary.
 - b. Place new insert into position making sure to push in from the side to close any gaps under the pull handle. While holding in place, pre-drill the 6 countersunk indentions into the door using a 1/8" drill bit. **(See figure 1-b)**
 - c. Install screws provided in hardware kit through the 6 pre-drilled holes using a Phillips screw driver. **DO NOT APPLY TOO MUCH PRESSURE AS THE SCREWS SHOULD ONLY BE SNUG.**



1-a & 3-a



1-b & 3-c

2. **Removing Passenger Side Door Panel - Steps 2.a through 3.j are for front passenger side panel only.**
 - a. Use a t20 torx screwdriver and unscrew 2 screws located on the bottom center of panel. **(See figure 2-a)**
 - b. Pop off cover of door handle by inserting a flat head screw driver in small gap located at bottom front of door handle. Using a Phillips screwdriver unscrew the two Phillips head screws located inside the handle. **(See figure 2-b)**
 - c. Using a panel removal tool (or putty knife if panel tool is not available), slide under edge of door panel and carefully pop panel clips off, lift panel up and over edge by window.
 - d. Disconnect window and door lock plugs (2) located at top of door panel as well as the panel light plug located at the bottom of panel. **(See figure 2-d)**
 - e. Remove panel and turn over, remove two screws on the backside of the handle and detach handle. **(See figure 2-e)**

Instructions Continue on Back Page

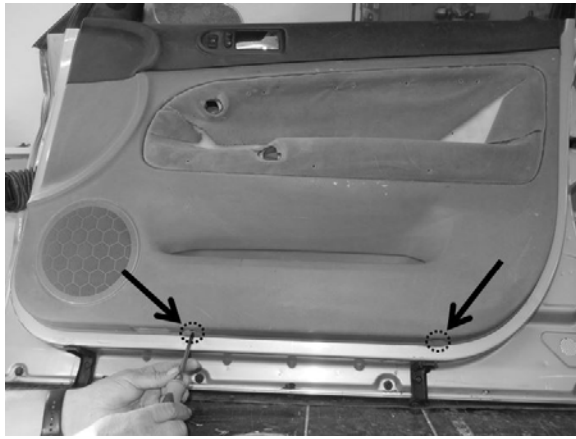

2-a

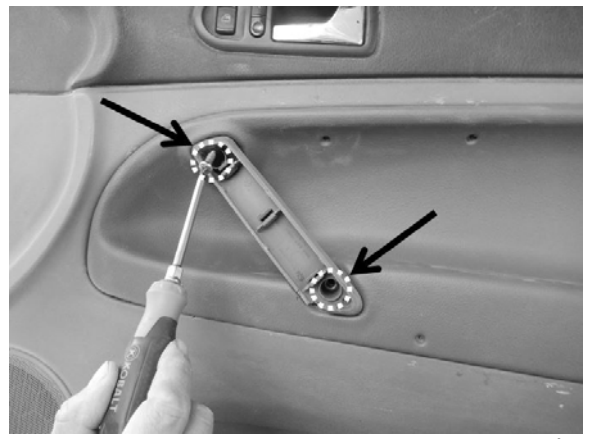

2-b

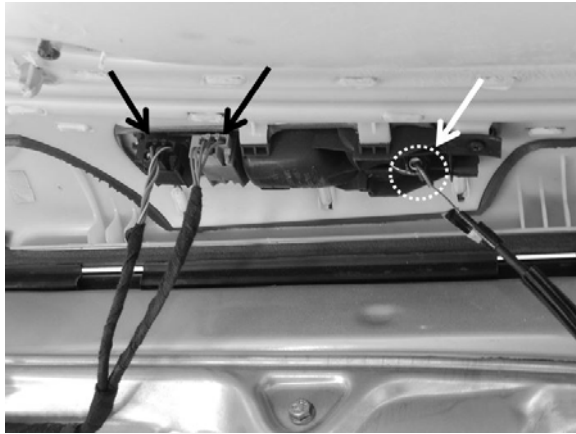

2-d

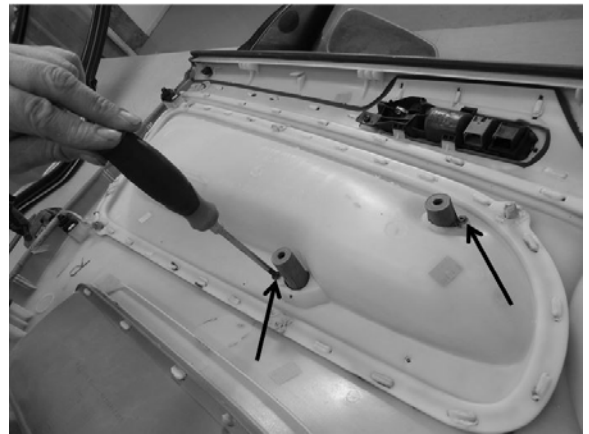

2-e

3. Installation of New Inserts

- a. Using a utility knife or razor blade, cut along lines shown in figure 3-a, to ensure fabric lays flat. Gluing down fabric is not necessary.
- b. Test fit new insert.
- c. Place new insert into position making sure to push in from the side to close any gap under the pull handle. While holding in place, pre-drill the countersunk indentions into the door using a 1/8" drill bit. **(See figure 3-c)**
- d. Install screws provided in hardware kit through pre-drilled holes using a Phillips screwdriver. **DO NOT APPLY TOO MUCH PRESSURE AS THE SCREWS SHOULD ONLY BE SNUG.**
- e. Reattach handle.
- f. Hook door latch back in door and reconnect window, door lock and light plugs.
- g. Guide door lock latch through the hole at the top of the panel. Using a Phillips screw driver screw the two screws to the handle and replace handle cover.
- h. Remove any broken door panel fasteners and replace with fasteners provided in kit and snap panel back in. (clips should just snap in)
- i. Using the t20 torx, screw the two torx screws back in. (located at the bottom of panel)
- j. Installation complete.

Tools Needed:

Utility Knife or Razor Blade
 Phillips Screw driver
 Precision Screw Driver or Panel Removal Tool
 Drill with 1/8" Drill Bit
 T20 Torx screw driver
 Small flat head screw driver

Included in Hardware Kit:

Qty. 14 fasteners
 Qty. 15 of 5/8" Phillips Tapping Screws

Installation Assistance is Available

Mon.-Fri. 8:00 am – 3:30 pm CST

Call 1-800-633-7090.



Our Warranty

Coverlay Manufacturing, Inc. warrants all of its products to be free of defects in workmanship and material. It further warrants that when properly installed our products will not warp or crack for the life of the vehicle. Uninstalled products reported defective after 30 days of receipt will not be covered under warranty. Color is not covered under warranty and photos may be required to determine warranty issues. If a product failure occurs, we will only replace the defective product in the original color. Cost of shipping and handling of replacement parts is not covered on warranty claims made after 30 days of receipt.

Furthermore, it is our policy that returns must be requested within 30 days of purchase. If a **Retail Purchaser** of any Coverlay® product which is purchased directly from our manufacturing site is not totally satisfied with his or her purchase they may request to return it within **30 days** of delivery date with copy of receipt for a full product refund. If purchased indirectly through a supplier of our product, the supplier must be contacted for return authorization. **Dealers and Distributors** must also request return authorization within **30 days** of delivery and upon receipt of return, credit for product will be issued less applicable restock fees. All products must not have been installed or altered and received back in “re-stock” condition or no refund will be applied. Products returned under this policy must be shipped back in original unaltered packaging with freight prepaid by purchaser.

Prior to return of any product purchased directly, you must contact us at 1-800-633-7090 for an authorization number and return instructions. Return product must be received within 30 days of return authorization. *You must contact your supplier for return instructions if purchased indirectly.*

COLOR MATCH IS NOT GUARANTEED OR COVERED UNDER WARRANTY

We offer 15 generic colors as a no charge convenience. These will not be a perfect match but will normally be complimentary to the vehicle interior. If an exact match is desired then you may obtain color code matched plastic dye in an aerosol can from your local automotive paint store. Repaint to your satisfaction before installing in your vehicle.