

11109

95-99 CHEVROLET CAVALIER (EXCEPT Z24)
00-05 CHEVROLET CAVALIER (EXCEPT LS SPORT)
95-05 PONTIAC SUNFIRE (EXCEPT CONVERTIBLE, GT COUPE, AND LS SPORT)

7/18/2012

GROSS LOAD CAPACITY WHEN USED AS A WEIGHT CARRYING HITCH: 2,000 LBS. TRAILER WEIGHT & 200 LBS. TONGUE WEIGHT.

DO NOT EXCEED VEHICLE MANUFACTURER'S RECOMMENDED TOWING CAPACITY.

WARNING: ALL NON-TRAILER LOADS APPLIED TO THIS PRODUCT MUST BE SUPPORTED BY AUXILIARY STABILIZING STRAPS.

** FAILURE TO PROPERLY SUPPORT NON-TRAILER LOADS WILL VOID PRODUCT WARRANTY**

HAVING INSTALLATION QUESTIONS? CALL TECHNICAL SUPPORT AT 1-800-798-0813

		Parts List	
ITEM	QTY	PART NUMBER	DESCRIPTION
1	1	CM-438-FW	7/16" FISHWIRE TOOL
2	2	CM-SP31	.250 x 1.75 x 2.00" U-SHAPE SPACER
3	2	CM-SP7	.250 x 1.00 x 2.00" SQUARE HOLE SPACER
4	2	7/16-14	HEX FLANGE NUT
5	2	3/8-16 X 1 1/2	HEX BOLT
6	2	3/8"	CONICAL TOOTHED WASHER
7	2	HFN3816	HEX FLANGE NUT
8	2	7/16 - 14 x 1 3/4	CARRIAGE BOLT

FISHWIRE TECHNIQUE
 INSERT COILED END OF FISHWIRE TOOL THROUGH HITCH MOUNTING HOLE IN VEHICLE FRAME RAIL AND OUT THE ACCESS HOLE. PASS COILED END OF FISHWIRE THROUGH SPACER AND THREAD BOLT INTO COIL. KINK WIRE TO KEEP SPACER SEPERATE FROM BOLT AS SHOWN. PULL FISHWIRE, SPACER, AND BOLT THROUGH FRAME AND OUT MOUNTING HOLE. USE FISHWIRE TO GUIDE HITCH DURING MOUNTING AND PREVENT LOSS OF BOLT / SPACER INSIDE FRAME RAIL.

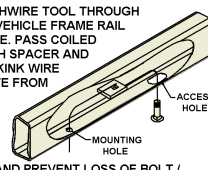

NOTE: SOME VEHICLES MAY FISHWIRE THROUGH END OF FRAME

RUBBER ISOLATOR REMOVAL DIAGRAM
 This technique can be used if and Exhaust Hanger Removal Pliers is not available.
 Using a 5/8" open end wrench, slide the wrench up to the rubber isolator, cradling the hanger rod as shown. Next place the flat edge of a pry bar between the wrench and the hanger stop or hanger rod. Then simply rotate the pry bar toward the wrench to remove the rubber isolator.
 Note: Using a spray lubricant or soapy water on the hanger rod and the rubber isolator helps removal.

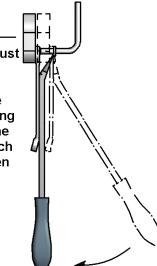
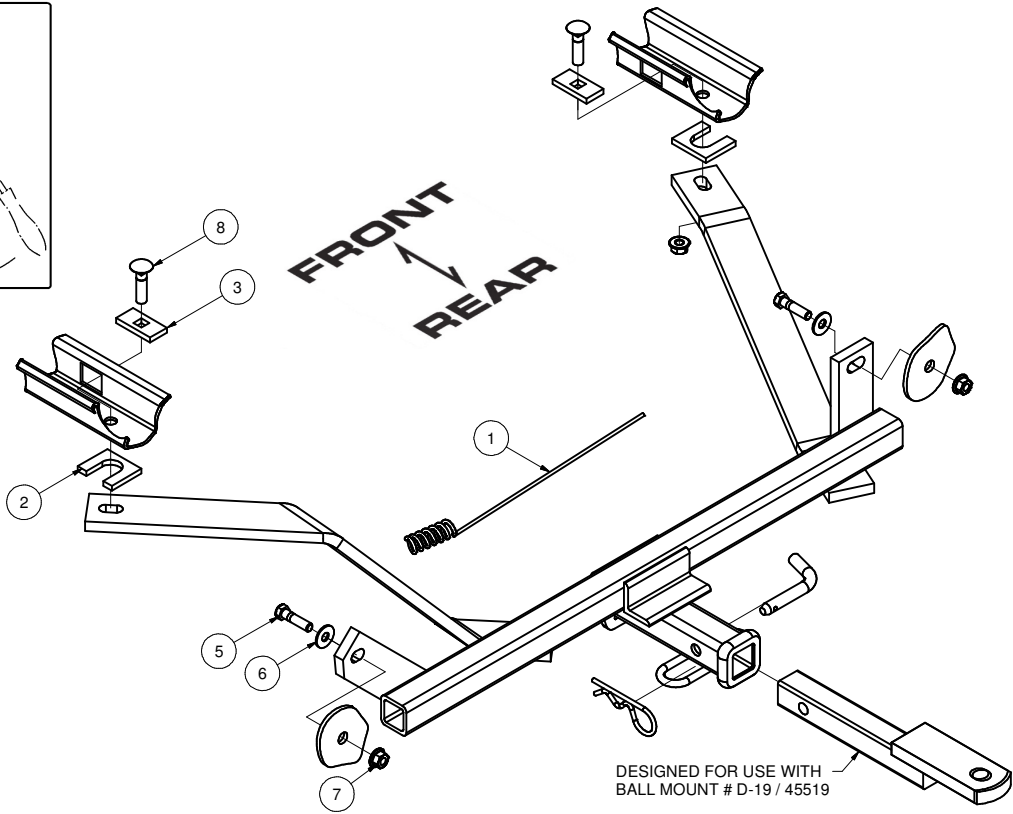
HITCH WEIGHT: 37 LBS.
 INSTALL TIME
 PROFESSIONAL: 45 MINUTES
 NOVICE (DIY): 90 MINUTES
 INSTALL NOTES:
 -LOWER EXHAUST
 -DRILLING REQUIRED

- INSTALLATION STEPS**
- 1) Remove two (2) 8mm bolts from inboard lower corners which attach bumper brackets to vehicle frame. Enlarge holes with 7/16 drill bit.
 - 2) Temporarily lower exhaust system.
 - 3) Remove the (two) rearmost exhaust heat shield rivets. Raise hitch up into position and trim heat shield to provide clearance for hitch installation.
 - 4) Raise hitch into position, lining up holes in hitch upright mounting plates with holes in forward surface of vehicle. Install 3/8 fasteners through valence panel and hitch upright bracket, each side.
 - 5) Fishwire 7/16" fasteners with spacers through square access hole on inboard side of frame.
 Note: Use of u-shape block on passenger side, place u-shape block if nessesary on driver side.
 - 6) Reattach exhaust system.
 - 7) Torque 3/8" fasteners to 45 LB.-FT. and 7/16" fasteners to 70 LB.-FT.
- PERIODICALLY CHECK THIS RECEIVER HITCH TO ENSURE THAT ALL FASTENERS ARE TIGHT AND THAT ALL STRUCTURAL COMPONENTS ARE SOUND.**

Curt Manufacturing Inc., warrants this product to be free of defects in material and/or workmanship at the time of retail purchase by the original purchaser. If the product is found to be defective, Curt Manufacturing Inc., may repair or replace the product, at their option, when the product is returned, prepaid, with proof of purchase. Alteration to, misuse of, or improper installation of this product voids the warranty. Curt Manufacturing Inc.'s liability is limited to repair or replacement of products found to be defective, and specifically excludes liability for incidental or consequential loss or damage.