

INSTALLATION MANUAL

19105

Level of Difficulty

Easy

Installation difficulty levels are based on time and effort involved and may vary depending on the installer level of expertise, condition of the vehicle and proper tools and equipment.

Parts List

Item	Qty	Description
1	2	Pin plate
2	4	Nylock nut, M14
3	4	Flat washer, M14
4	4	Hex bolt, M14

Tools Required

Ratchet	Socket set
Wrench, M22	--

Product Registration and Warranty

CURT stands behind our products with industry-leading warranties. To get copies of the product warranties, register your purchase or provide feedback, visit: warranty.curtgroup.com/surveys

WARNING

Never exceed the vehicle manufacturer's recommended towing capacity.

Product Photo

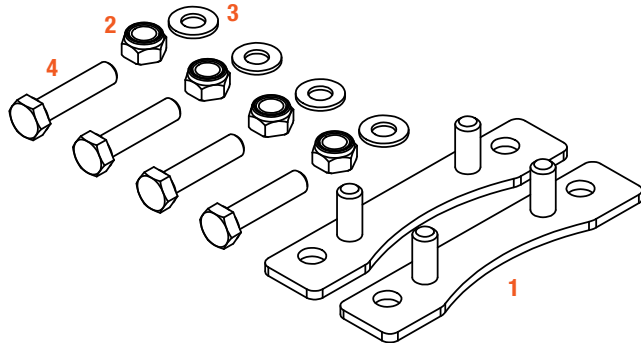

NOTICE

Visit www.curtmfg.com for a full-color copy of this instruction manual, as well as helpful videos, guides and much more!

Before you begin installation, read all instructions thoroughly.

Proper tools will improve the quality of installation and reduce the time required.

Periodic inspection of your product should be performed to ensure all hardware and / or components remain secure.

To help prevent damage to the product or vehicle, refer to the specified torque specifications when securing hardware during the installation process.

ASSEMBLY

Step 1

Insert the machine pins of the pin plate into the center-most holes, aligning the outer-most holes with the mounting holes on the slider carriage. The pins in the pin plate will insert into the 5th wheel head as well.

Secure the 5th wheel head and pin plate to the slider using two M14 hex head bolts and two M14 nylock nuts. Torque hardware to 100 ft-lbs.

Repeat for the remaining mounting points.

