

INSTALLATION MANUAL

Level of Difficulty

Easy

Installation difficulty levels are based on time and effort involved and may vary depending on the installer level of expertise, condition of the vehicle and proper tools and equipment.

Electrical Ratings

Signal circuits	3.0-amps per side
Tail / Running Circuits	6.0-amps total

Check vehicle owner's manual or contact the vehicle manufacturer for more information.

Wiring Location(s)

P3 and P4, S3 and S4

Wiring Location Guide* for Passenger Cars (P)

P3	Behind driver side taillight housing, inside of trunk
P4	Behind passenger side taillight housing, inside of trunk

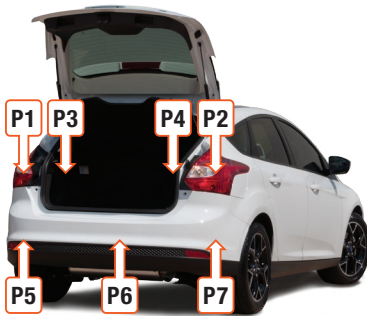

* Representative vehicle shown

Wiring Location Guide* for SUVs and Vans (S)

S3	Behind driver side rear access panel
S4	Behind passenger side rear access panel

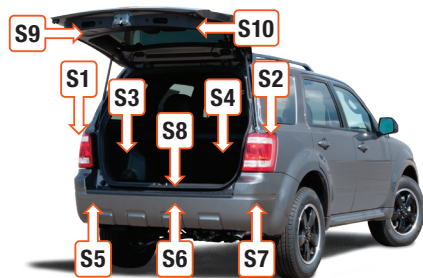

* Representative vehicle shown

WARNING

Do not exceed product rating or tow vehicle lamp load rating, whichever is lower.

The battery connection must be fuse-protected, 10-amp max. Exceeding the product rating can cause loss of warranty, overheating and potential fire.

Product Photo

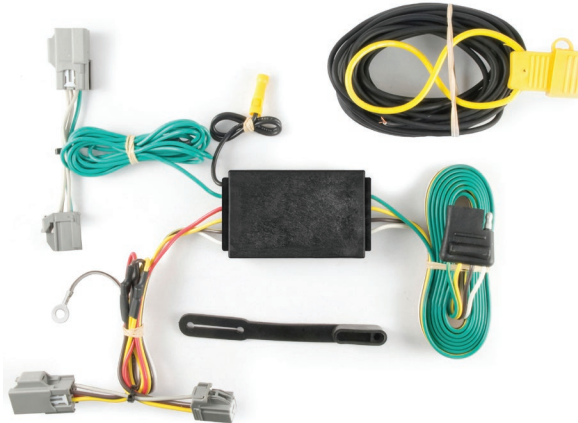

Hardware Photo

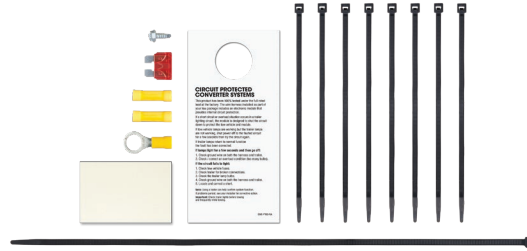

NOTICE

Before you begin installation, read all instructions thoroughly.

Proper tools will improve the quality of installation and reduce the time required.

All steps must be followed to ensure the product will function properly. Once installed, test for proper function by using a test light or connecting a properly wired trailer.

Maintenance

Periodic inspection of all wires and connections should be performed to ensure there is no visible damage or loose connections.

Tools Required

Ratchet	Panel trim removal tool	Wire crimper	Paint marker
Socket, 8mm	Pliers	Wire stripper	Electrical tape
Socket extension	Cutting tool	Heat gun	--

Step 1A: Taurus

Locate the vehicle's battery in the engine compartment on the driver side and disconnect the negative battery terminal. Be sure to fasten this wire down and away from the battery while completing the installation process.



Step 2A: Taurus

Open the vehicle tailgate and remove the floor coverings to expose the spare tire. Use a panel trim removal tool to remove the scuff panel by pulling out on the bottom and then up. Take care not to damage the alignment tabs on the back.



Step 3A: Taurus

On both sides of the vehicle, use a panel trim removal tool to remove the three plastic fasteners securing the felt trunk liner.

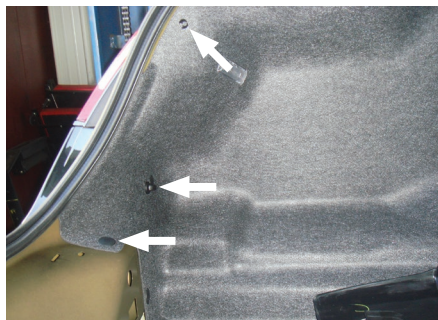

Step 4A: Taurus

Starting on the driver side, pull back on the felt liner to locate the vehicle taillight wiring harness connectors. The connectors will be similar to those on the custom wiring harness. Separate the connectors from the taillight housing taking care not to damage the locking tabs.

Insert the custom wiring end with yellow wire between the separated connectors. Make sure the connectors are fully inserted with locking tabs in place.

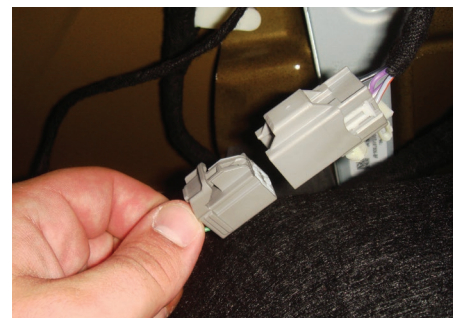

Step 5A: Taurus

Locate a suitable grounding point near the connector such as an existing screw with nut in the vehicle frame or drill a 3/32" pilot hole for the provided screw. The area should be free of rust, dirt and paint. Secure the white ground wire using the ring terminal and provided screw.

WARNING

Check for miscellaneous items that may be hidden behind or under any surface before drilling to avoid damage and / or personal injury.

Step 6A: Taurus

Route the green wire along the back of the vehicle under the scuff plate. Secure any loose wires with the provided cable ties. Repeat step 4A on the passenger side with the green wire.

Step 7A: Taurus

Route the black power wire from the vehicle battery as shown on the provided 'Powered Converter Lead Instruction Sheet'.

NOTICE

Once 12 volt power wire is connected to the harness verify that the harness is functioning by attaching the battery and testing with a test light, 4-flat tester or a functioning trailer.

Step 8A: Taurus

When in use, route the 4-flat to the center of the vehicle. When not in use, roll up and store in a convenient, out of the way location. Secure any loose wires with the provided cable ties.

Reinstall all items removed during install. If it was disconnected at the beginning of the installation, reconnect the negative battery terminal. Install the provided 4-flat dust cover to help prevent corrosion.

Step 1B: Explorer (10th vin B, C, D)

Locate the vehicle's battery in the engine compartment on the driver side and disconnect the negative battery terminal. Be sure to fasten this wire down and away from the battery while completing the installation process.



Step 2B: Explorer (10th vin B, C, D)

Open the vehicle tailgate, fold the third row seats forward and remove the floor coverings to expose the spare tire. Use a panel trim removal tool to remove the scuff plate by pulling out on the bottom and then up. Take care not to damage the alignment tabs on the back.



Step 3B: Explorer (10th vin B, C, D)

Use a panel trim removal tool to remove the covers on the cargo hold-downs and remove the plastic fasteners securing the side panels.

Repeat on the other side of the vehicle.



Step 4B: Explorer (10th vin B, C, D)

Starting on the driver side, use a panel trim removal tool to loosen the side wall panels. Loosen the panels starting at the floor and up to the head liner. Pull back on the panel to locate the taillight housing. The connectors will be similar to those on the custom wiring harness. Separate the connectors from the taillight housing, taking care not to damage the locking tabs.

Insert the custom wiring end with yellow wire between the separated connectors. Make sure the connectors are fully inserted with locking tabs in place.

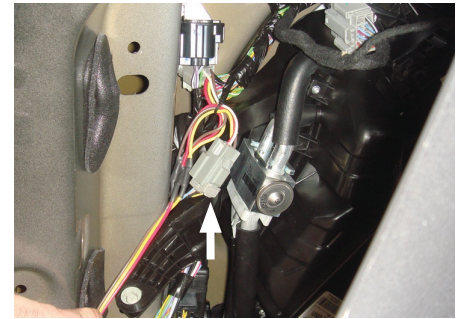

Step 5B: Explorer (10th vin B, C, D)

Locate a suitable grounding point near the connector such as an existing screw with nut in the vehicle frame or drill a 3/32" pilot hole for the provided screw. The area should be free of rust, dirt and paint. Secure the white ground wire using the ring terminal and provided screw.

WARNING

Check for miscellaneous items that may be hidden behind or under any surface before drilling to avoid damage and / or personal injury.

Step 6B: Explorer (10th vin B, C, D)

Route the green wire along the back of the vehicle under the scuff plate. Secure any loose wires with the provided cable ties. Repeat step 4B on the passenger side with the green wire.

Step 7B: Explorer (10th vin B, C, D)

Route the black power wire from the vehicle battery as shown on the provided 'Powered Converter Lead Instruction Sheet'.

NOTICE

Once 12 volt power wire is connected to the harness verify that the harness is functioning by attaching the battery and testing with a test light, 4-flat tester or a functioning trailer.

Step 8B: Explorer (10th vin B, C, D)

When in use, route the 4-flat to the center of the vehicle. When not in use, roll up and store in a convenient, out of the way location. Secure any loose wires with the provided cable ties.

Reinstall all items removed during install. If it was disconnected at the beginning of the installation, reconnect the negative battery terminal. Install the provided 4-flat dust cover to help prevent corrosion.

Step 1C: Explorer (10th vin L)

Locate the vehicle's battery in the engine compartment towards the back on the passenger. The battery will be under a cover. Push both tabs on the cover towards the rear of the vehicle and lift. Once the cover is removed, disconnect the negative battery terminal. Be sure to fasten this wire down and away from the battery while completing the installation process.



Step 2C: Explorer (10th vin L)

Open the vehicle tailgate, fold the third row seats forward and remove the floor coverings to expose the spare tire. Use a panel trim removal tool to remove the scuff panel by pulling out on the bottom and then up. Take care not to damage the alignment tabs on the back.



Step 3C: Explorer (10th vin L)

Use a pair of pliers to unthread the screw behind this cargo net hold-down. Use a panel trim removal tool to loosen the cargo hook fastener cover. Use an 8mm socket to remove the cargo hook.

Repeat on the other side of the vehicle.



Step 4C: Explorer (10th vin L)

Starting on the driver side, use a panel trim removal tool to loosen the side wall panels. Loosen the panels starting at the floor and up to the head liner. Pull back on the panel to locate the taillight housing. The connectors will be similar to those on the custom wiring harness. Separate the connectors from the taillight housing, taking care not to damage the locking tabs.

Insert the custom wiring end with yellow wire between the separated connectors. Make sure the connectors are fully inserted with locking tabs in place.

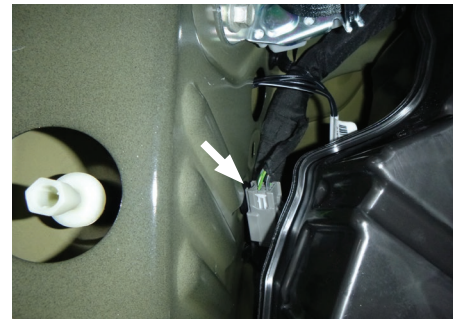

Step 5C: Explorer (10th vin L)

Locate a suitable grounding point near the connector such as an existing screw with nut in the vehicle frame or drill a 3/32" pilot hole for the provided screw. The area should be free of rust, dirt and paint. Secure the white ground wire using the ring terminal and provided screw.

WARNING

Check for miscellaneous items that may be hidden behind or under any surface before drilling to avoid damage and / or personal injury.

Step 6C: Explorer (10th vin L)

Route the green wire along the back of the vehicle under the scuff plate. Secure any loose wires with the provided cable ties. Repeat step 4C on the passenger side with the green wire.

Step 7C: Explorer (10th vin L)

Route the black power wire from the vehicle battery as shown on the provided 'Powered Converter Lead Instruction Sheet'.

NOTICE

Once 12 volt power wire is connected to the harness verify that the harness is functioning by attaching the battery and testing with a test light, 4-flat tester or a functioning trailer.

Step 8C: Explorer (10th vin L)

When in use, route the 4-flat to the center of the vehicle. When not in use, roll up and store in a convenient, out of the way location. Secure any loose wires with the provided cable ties.

Reinstall all items removed during install. If it was disconnected at the beginning of the installation, reconnect the negative battery terminal. Install the provided 4-flat dust cover to help prevent corrosion.

POWERED CONVERTER LEAD INSTRUCTION SHEET

FICHE DE CONSIGNES DU CONVERTISSEUR D'ALIMENTATION

HOJA DE INSTRUCCIONES DEL CONDUCTOR DEL ADAPTADOR ALIMENTADO POR BATERÍA

NOTICE AVIS / AVISO

Illustrations are for reference only. Battery location may differ depending on the vehicle.

Les images ne sont fournies qu'à des fins de référence. L'emplacement de la batterie peut varier en fonction du véhicule.

Las ilustraciones son solo para referencia. La ubicación de la batería puede variar según el vehículo.

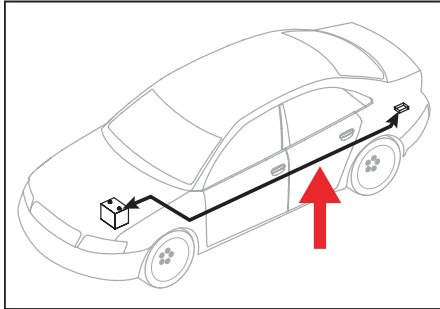

WARNING AVERTISSEMENT / ADVERTENCIA

Route 12 GA wire to vehicle battery location, taking care to avoid any pinch points and hot or rotating components.

Acheminer le câble de calibre 12 à la batterie du véhicule en prenant soin d'éviter les points de pincement et les éléments chauds ou pivotants.

Pase el cable calibre 12 hacia la ubicación de la batería del vehículo, con cuidado de evitar atascos y componentes calientes o giratorios.

WARNING AVERTISSEMENT / ADVERTENCIA

To avoid personal injury or property damage, check for miscellaneous items that may be behind or under any surface before drilling.

Pour éviter les blessures et les dommages matériels, vérifier les divers articles qui peuvent se trouver derrière ou sous la surface avant de percer.

Para evitar lesiones personales o daños materiales, verifique que no haya ningún elemento detrás o debajo de la superficie antes de perforar.

NOTICE AVIS / AVISO

1. This converter system is to be used only on 12 volt negative ground systems.
2. Secure power wire to vehicle chassis using cable ties provided.
3. When passing the power wire through sheet metal, use an existing grommet, add a grommet or use silicone to protect the power wire from sharp edges.
4. Overall T-connector design may differ from illustration. The illustration should be used for power lead instruction only. Illustration is not to scale.

1. Ce système de convertisseur ne doit être utilisé qu'avec une prise de masse de polarité négative de 12 volts.
2. Fixer le câble d'alimentation au châssis du véhicule à l'aide des courroies d'attache de câble fournies.
3. Utiliser un œillet existant, ajouter un œillet ou appliquer du silicone pour protéger le câble d'alimentation des rebords tranchants au moment de le passer à travers la tôle.
4. La disposition générale du connecteur en T peut différer de l'illustration. Celle-ci ne doit être utilisée que pour le convertisseur d'alimentation. L'illustration n'est pas à l'échelle.

1. Este sistema de adaptadores solo se debe utilizar con sistemas con polo negativo a masa de 12 voltios.
2. Sujete el cable de alimentación al chasis del vehículo utilizando los sujetacables suministrados.
3. Al pasar el cable de alimentación por la lámina de metal, utilice la arandela pasacable existente, agregue una arandela pasacable o utilice silicona para proteger el cable de alimentación de los bordes filosos.
4. El diseño general del conector T puede ser distinto de la ilustración. La ilustración solo se debe utilizar para la instrucción del conductor de alimentación. La ilustración no está a escala.

