

1156581-90 FORD ESCORT, 87-94 FORD TEMPO
81-88 MERCURY LYNX, 87-94 MERCURY TOPAZ

11/26/2012

GROSS LOAD CAPACITY WHEN USED AS A WEIGHT CARRYING HITCH: 2,000 LBS. TRAILER WEIGHT & 200 LBS. TONGUE WEIGHT.

*****DO NOT EXCEED VEHICLE MANUFACTURER'S RECOMMENDED TOWING CAPACITY.*****

WARNING: ALL NON-TRAILER LOADS APPLIED TO THIS PRODUCT MUST BE SUPPORTED BY 18050 STABILIZING STRAPS.

**** FAILURE TO PROPERLY SUPPORT NON-TRAILER LOADS WILL VOID PRODUCT WARRANTY****

HAVING INSTALLATION QUESTIONS? CALL TECHNICAL SUPPORT AT 1-800-798-0813

Parts List			
ITEM	QTY	PART NUMBER	DESCRIPTION
1	2	3_8 - 16 x 1.250 x 2.000 C-C U-BOLT	U-BOLT
2	10	HFN3816	HEX FLANGE NUT
3	4	3/8-16 X 1 1/2	HEX BOLT
4	2	3/8 - 16 x 1 1/4	HEX BOLT
5	2	3/8"	FENDER WASHER
6	1	CM-11565-BP	.250" BACKING PLATE
7	1	CM-11565-SBB	.500" SUB BUMPER BRACKET

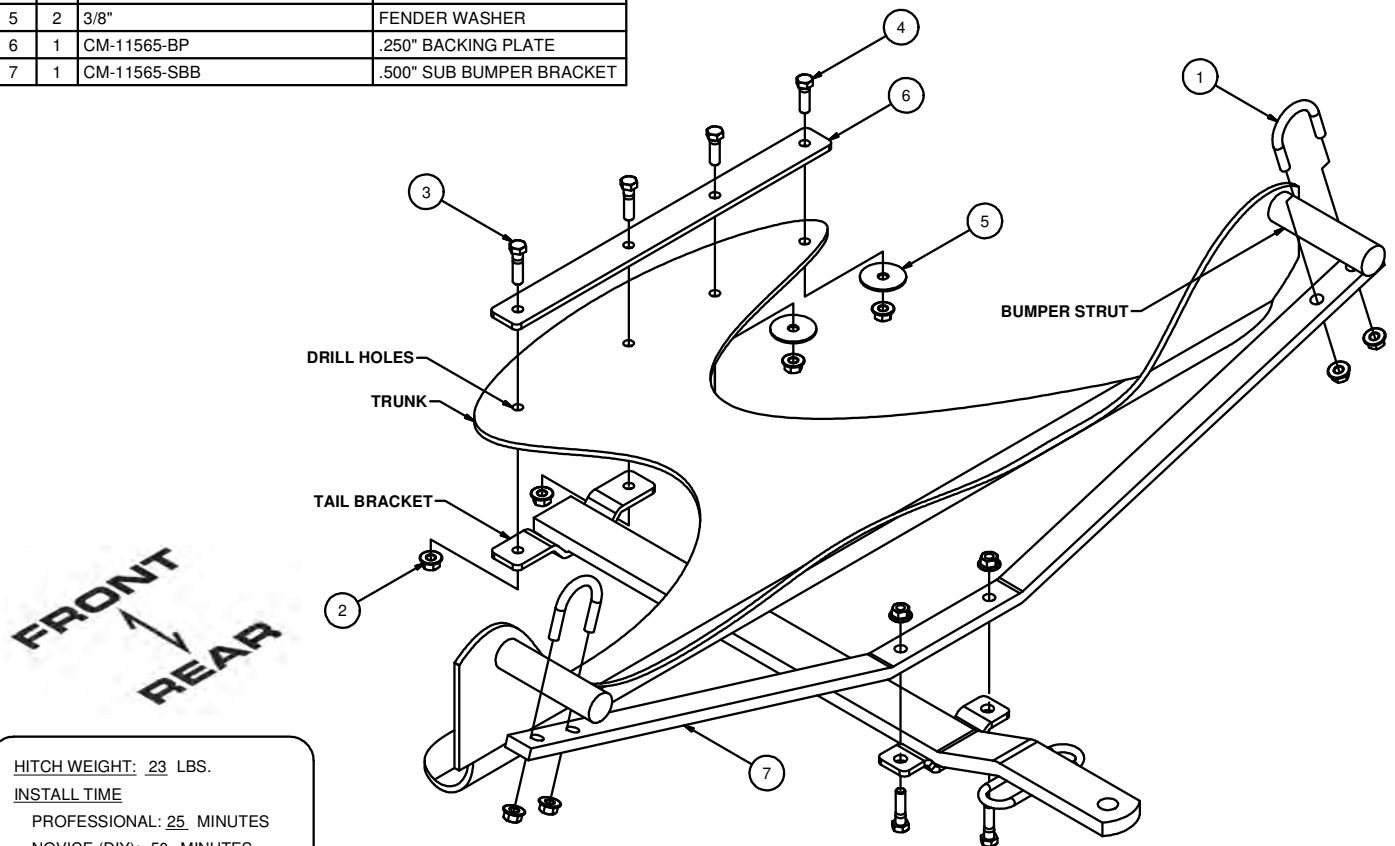

HITCH WEIGHT: 23 LBS.

INSTALL TIME

PROFESSIONAL: 25 MINUTES

NOVICE (DIY): 50 MINUTES

INSTALL NOTES:

- CLEAR TRUNK
- DRILLING REQUIRED
- SILICONE HARDWARE

INSTALLATION STEPS

1. Clear vehicle's trunk for drilling for the hitch.
2. Assemble hitch sub bumper bracket (7) to hitch tongue at brackets. Attach sub bumper across under vehicle's tubular bumper struts using U-bolts provided. Tighten nuts until tail bracket is resting against trunk floor.
3. Support the hitch tongue against underside of floor pan. Check for hitch ball clearance with bumper and check for best fit with trunk. Using hitch as a template, mark and drill (4) holes at the tail bracket as shown including the backing plate inside the vehicle. Install as shown with large fender washers outside of the vehicle.
4. Torque all fasteners to 45 ft.-lbs. DO NOT USE IMPACT WRENCH ON U-BOLTS!
5. Use silicone sealant around fasteners installed in truck to seal out water and exhaust fumes.
6. Reinstall trunk contents removed in step 1.

PERIODICALLY CHECK THIS RECEIVER HITCH TO ENSURE THAT ALL FASTENERS ARE TIGHT AND THAT ALL STRUCTURAL COMPONENTS ARE SOUND.

Curt Manufacturing Inc., warrants this product to be free of defects in material and/or workmanship at the time of retail purchase by the original purchaser. If the product is found to be defective, Curt Manufacturing Inc., may repair or replace the product, at their option, when the product is returned, prepaid, with proof of purchase. Alteration to, misuse of, or improper installation of this product voids the warranty. Curt Manufacturing Inc.'s liability is limited to repair or replacement of products found to be defective, and specifically excludes liability for incidental or consequential loss or damage.