

12103

## 95-99 BUICK RIVIERA &amp; 95-99 OLDSMOBILE AURORA

11/19/2012

GROSS LOAD CAPACITY WHEN USED AS A WEIGHT CARRYING HITCH: 3500 LBS. TRAILER WEIGHT &amp; 350 LBS. TONGUE WEIGHT.

\*\*\*DO NOT EXCEED VEHICLE MANUFACTURER'S RECOMMENDED TOWING CAPACITY.\*\*\*

WARNING: ALL NON-TRAILER LOADS APPLIED TO THIS PRODUCT MUST BE SUPPORTED BY AUXILIARY STABILIZING STRAPS.

\*\* FAILURE TO PROPERLY SUPPORT NON-TRAILER LOADS WILL VOID PRODUCT WARRANTY\*\*

HAVING INSTALLATION QUESTIONS? CALL TECHNICAL SUPPORT AT 1-800-798-0813

Parts List			
ITEM	QTY	PART NUMBER	DESCRIPTION
1	1	1/2"	FISHWIRE TOOL
2	2	1/2-13	HANDLE NUT
3	2	1/2 - 13 x 2"	CARRIAGE BOLT
4	4	1/2"	NYLON WASHER
5	2	CM-SP31	.250 x 1.75 x 2.00" U-SHAPE SPACER
6	2	CM-SP6	.250 x 1.00 x 3.00" SQUARE HOLE SPACER
7	2	1/2-13 x 2"	HEX BOLT
8	2	1/2"	CONICAL TOOTHED WASHER
9	2	CM-SP33	.250 x 1.50 x 2.00" SQUARE HOLE SPACER
10	4	HFN 1213	HEX FLANGE NUT
11	2	3/8-16 x 2	CARRIAGE BOLT
12	2	HFN3816	HEX FLANGE NUT
13	2	1/2-13 x 1 3/4	CARRIAGE BOLT
14	2	CM-SP16	.250 x 1.50 x 2.00" ROUND HOLE SPACER
15	2	CM-12103-EHB	.250" EXHAUST HANGER BRACKET

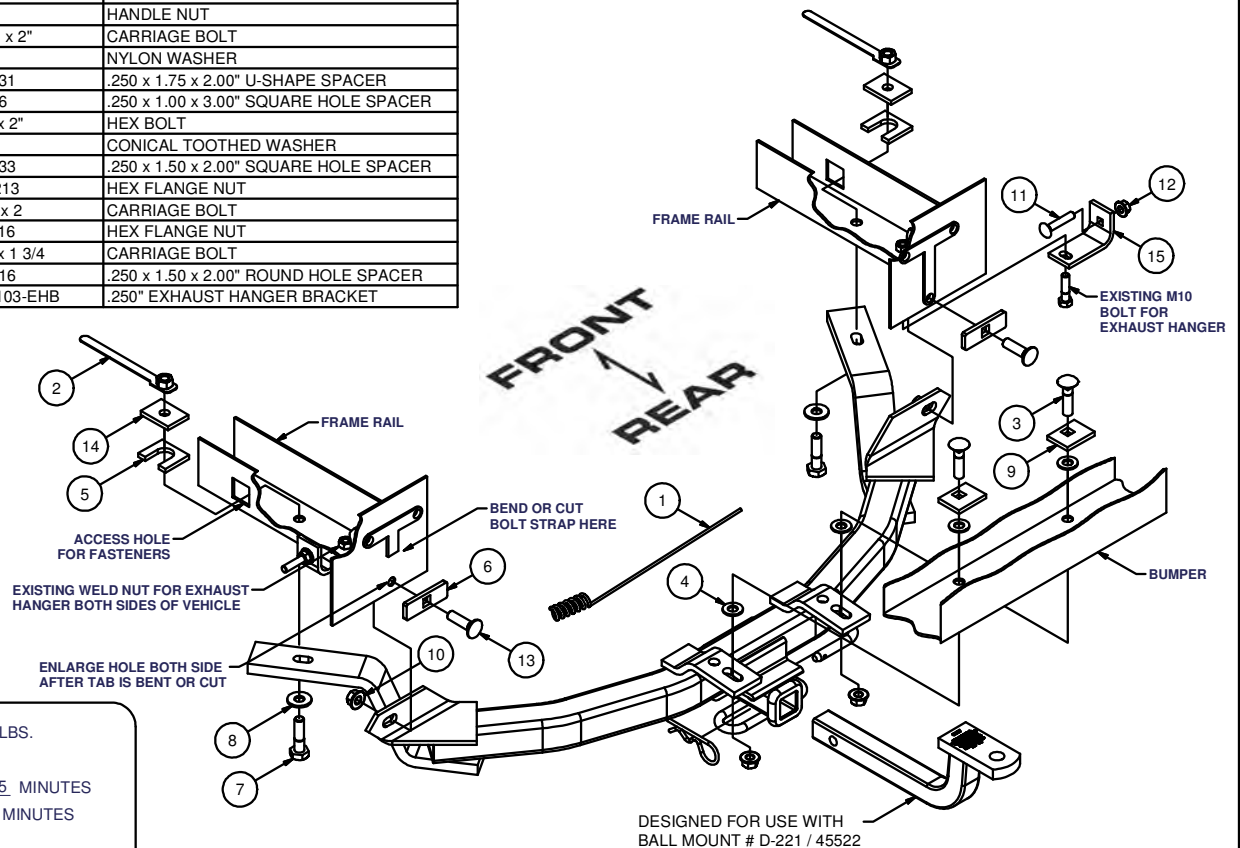

HITCH WEIGHT: 43 LBS.

## INSTALL TIME

PROFESSIONAL: 45 MINUTES

NOVICE (DIY): 90 MINUTES

## INSTALL NOTES:

- DRILLING REQUIRED
- FISHWIRE
- SOME FASTENERS

## INSTALLATION STEPS

- 1) Remove two M8 bolts which attach bumper brackets to vehicle frame. Enlarge holes to 1/2" and bend the bottom tab out of the way or cut tab if needed.
- 2) Lower vehicle exhaust, be sure to support the exhaust. Exhaust on pre 1998 models will be reinstalled after hitch installation. On later models, remove the exhaust hanger bracket from the bottom of the frame rail and disconnect from rubber hanger attached to the exhaust tail pipe. A replacement bracket is provided and will be installed later. Return factory exhaust brackets to the vehicle owner.
- 3) Raise hitch into position, align holes in hitch with enlarged E/A attachment holes on vehicle (see step 2) and loosely install 1/2" fasteners.
- 4) Use hitch as a template, drill two 1/2" holes in bumper. Use holes that are best centered on bumper. (Note: Trim aurora fascia to allow for fastener clearance.)
- 5) Place nylon washers between hitch and bumper, and between carriage bolt spacer and bumper.
- 6) Fishwire the 1/2" carriage bolts, spacer blocks, and nylon washers through the end of the bumper and thru the holes drilled in step 4. (Note: Nylon washers must be between spacer and bumper.) Install remaining fasteners as shown.
- 7) On pre 1998 models, reattach exhaust bracket removed in step 2. On later models, install 3/8" carriage bolt through square hole in bracket and fasten bracket to bottom of frame, using bolt removed in step 2. Slide the rubber hanger onto the 3/8" carriage bolt and secure with flanged locknut. Tighten nut against the rubber hanger allowing the hanger to rotate. Do not over tighten.
- 8) Torque all M10 fasteners to 48 lb.-ft. Torque all 1/2" fasteners to 110 lb.-ft.

**PERIODICALLY CHECK THIS RECEIVER HITCH TO ENSURE THAT ALL FASTENERS ARE TIGHT AND THAT ALL STRUCTURAL COMPONENTS ARE SOUND.**

Curt Manufacturing Inc., warrants this product to be free of defects in material and/or workmanship at the time of retail purchase by the original purchaser. If the product is found to be defective, Curt Manufacturing Inc., may repair or replace the product, at their option, when the product is returned, prepaid, with proof of purchase. Alteration to, misuse of, or improper installation of this product voids the warranty. Curt Manufacturing Inc.'s liability is limited to repair or replacement of products found to be defective, and specifically excludes liability for incidental or consequential loss or damage.