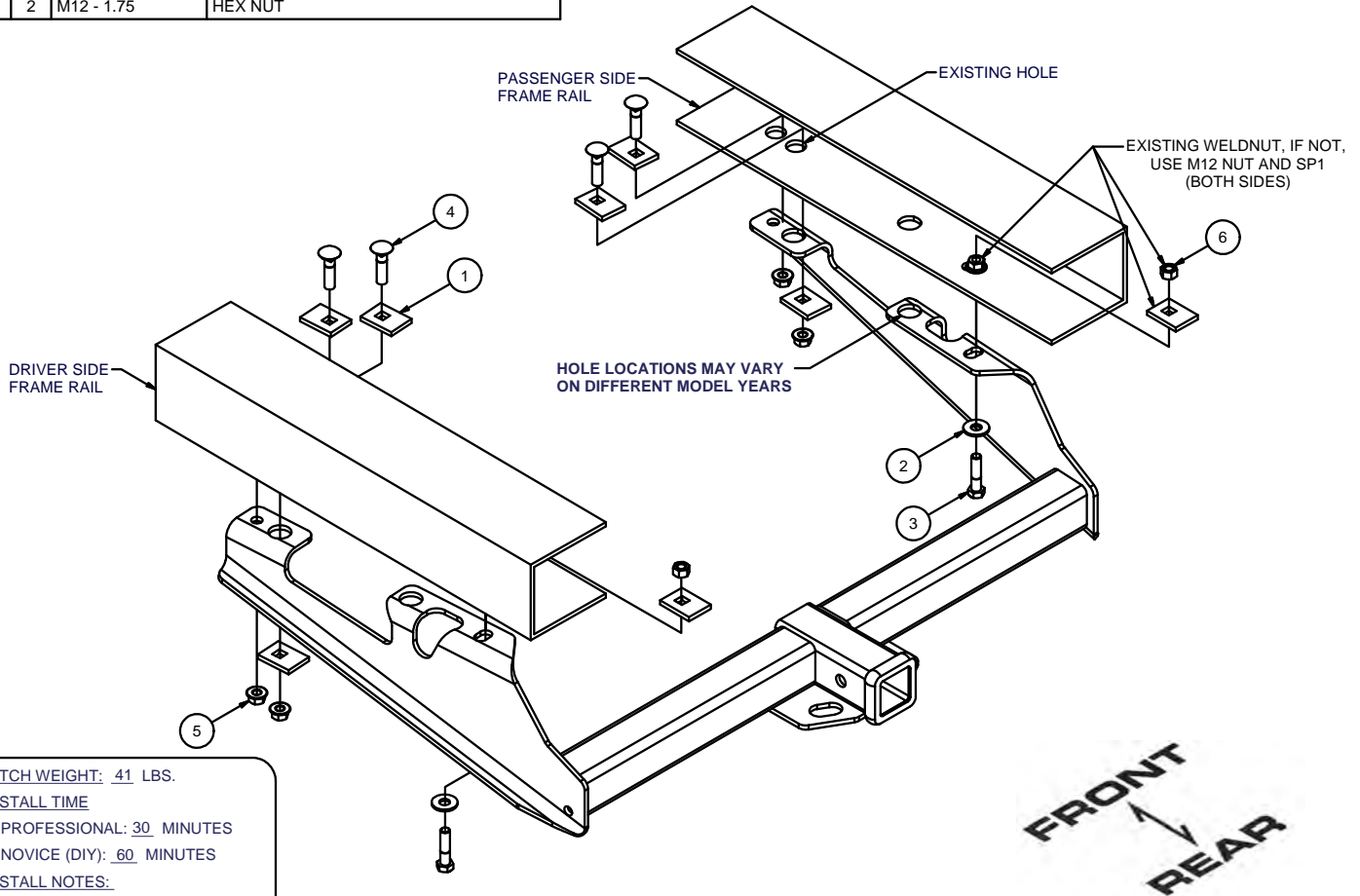
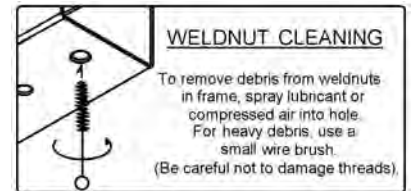

13082**1988-00 CHEVY/GMC 1500(OLD STYLE)
1992-00 CHEVY/GMC 4DR CREW CAB ONLY****5/15/2018****GROSS LOAD CAPACITY WHEN USED AS A WEIGHT CARRYING HITCH: 6,000 LBS. TRAILER WEIGHT & 600 LBS. TONGUE WEIGHT.
GROSS LOAD CAPACITY WHEN USED AS A WEIGHT DISTRIBUTION HITCH: 10,000 LBS. TRAILER WEIGHT & 1,000 LBS. TONGUE WEIGHT****WARNING: *** DO NOT EXCEED VEHICLE MANUFACTURER'S RECOMMENDED TOWING CAPACITY. *******FOR MORE INFORMATION LOG ONTO WWW.CURTMFG.COM****HAVING INSTALLATION QUESTIONS? CALL TECHNICAL SUPPORT AT 1-800-798-0813**

| Parts List | | | |
|------------|-----|-------------------|--|
| ITEM | QTY | PART NUMBER | DESCRIPTION |
| 1 | 8 | CM-SP1 | .250 x 1.50 x 2.00" SQUARE HOLE SPACER |
| 2 | 2 | 1/2" | CONICAL TOOTHED WASHER |
| 3 | 2 | M12 - 1.75 x 50mm | HEX BOLT |
| 4 | 4 | 1/2 - 13 x 2" | CARRIAGE BOLT |
| 5 | 4 | HFN 1213 | HEX FLANGE NUT |
| 6 | 2 | M12 - 1.75 | HEX NUT |

**HITCH WEIGHT: 41 LBS.****INSTALL TIME****PROFESSIONAL: 30 MINUTES****NOVICE (DIY): 60 MINUTES****INSTALL NOTES:**

- NO DRILLING REQUIRED
- LOWER SPARE TIRE

INSTALLATION STEPS

- 1) Lower the spare tire. The rear bolt in the bottom of the frame on each side must be removed, if equipped with factory step bumper. Clean away any mud and undercoating present.
- 2) Position the receiver against the frame. The large cut outs in the hangers should clear rivets and cross member bolts.
- 3) Secure the hitch to vehicle using all existing holes in vehicle frame as illustrated above.
- 4) Reposition spare tire slightly forward to clear hitch. Oversized spare tire may have to be relocated.
- 5) Torque all 1/2" fasteners to 110 lb.-ft. and all M12 fasteners to 86 lb.-ft.

**Scan
for more
information****PERIODICALLY CHECK THIS RECEIVER HITCH TO ENSURE THAT ALL FASTENERS
ARE TIGHT AND THAT ALL STRUCTURAL COMPONENTS ARE SOUND.**

CURT Manufacturing LLC., warrants this product to be free of defects in material and/or workmanship at the time of retail purchase by the original purchaser. If the product is found to be defective, CURT Manufacturing LLC., may repair or replace the product, at their option, when the product is returned, prepaid, with proof of purchase. Alteration to, misuse of, or improper installation of this product voids the warranty. CURT Manufacturing LLC.'s liability is limited to repair or replacement of products found to be defective, and specifically excludes liability for incidental or consequential loss or damage.

This product complies with safety specifications and requirements for connecting devices and towing systems of the state of New York, V.E.S.C.Regulation V-5 and SAE J684.