



Safety glasses should be worn at all times while installing this product.

YEARS: 2013-2018

MAKE: TOYOTA

MODEL: RAV4

STYLE: SUV

WARNING: NEVER EXCEED YOUR VEHICLE MANUFACTURER'S RECOMMENDED TOWING CAPACITY
 For more information log onto www.curtmfg.com & for helpful towing tips log onto www.hitchinfo.com

WEIGHT CARRYING:
 TRAILER WEIGHT: 3,500 LBS.
 TONGUE WEIGHT: 350 LBS.

PRO INSTALL TIME: 20 MIN.
NOVICE INSTALL TIME: 40 MIN.

IF YOU ARE HESITANT TO UNDERTAKE THIS TASK ON YOUR OWN, CONTACT AN AUTHORIZED CURT INSTALLER FOR ADDITIONAL ASSISTANCE.

INSTALLATION REQUIRES:

RATCHET	TORQUE WRENCH	10mm 17mm 19mm SOCKET
6" SOCKET EXTENSION	MARKER	TAPE MEASURE
UTILITY KNIFE	AVIATION SHEARS	SCREW DRIVER
SAFETY GLASSES		

INSTALLATION TIPS:

- BEFORE YOU BEGIN INSTALLATION, READ ALL INSTRUCTIONS THOROUGHLY.
- TO EASE INSTALLATION, 2 PEOPLE MAY BE REQUIRED.
- USING PROPER TOOLS WILL GREATLY IMPROVE THE QUALITY OF THE INSTALL AND REDUCE THE TIME REQUIRED.
- NEED HELP OR HAVE SOME QUESTIONS? CALL TECHNICAL SUPPORT AT 800.798.0813

LEVEL OF DIFFICULTY: MODERATE

EASY	MODERATE	CHALLENGING
	NO DRILLING REQUIRED	
	LOWER REARWARD MOST EXHAUST HANGER	
	WELDNUT CLEANING MAY BE REQUIRED	
	TRIM UNDERBODY PANELS AND LOWER FASCIA	
	TEMPORARILY REMOVE UNDERBODY PANELS	

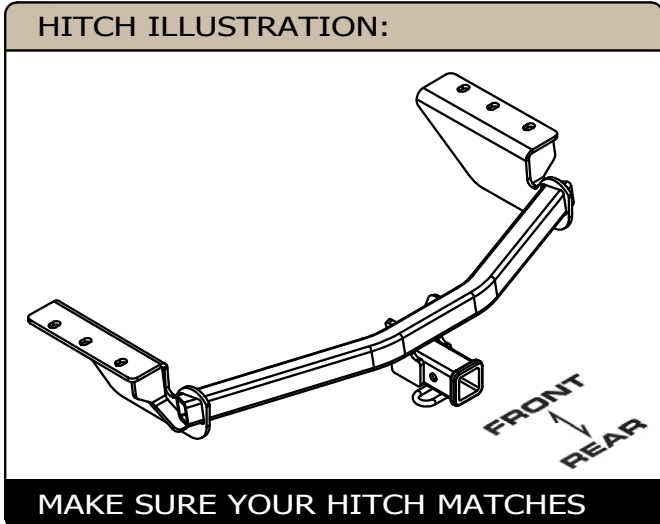

PERIODICALLY CHECK THIS RECEIVER HITCH TO ENSURE ALL FASTENERS ARE TIGHT AND ALL STRUCTURAL COMPONENTS ARE SOUND
 CURT Manufacturing LLC. warrants this product to be free of defects in material and/or workmanship at the time of retail purchase by the original purchaser. If the product is found to be defective, CURT Manufacturing LLC. may repair or replace the product at their option, when the product is returned, prepaid, with proof of purchase. Alteration to, misuse of, or improper installation of this product voids the warranty. CURT Manufacturing LLC.'s liability is limited to repair or replacement of products found to be defective, and specifically excludes liability for incidental or consequential loss or damage.
 For more information log onto www.curtmfg.com
 This product complies with safety specifications and requirements for connecting devices and towing systems of the state of New York, V.E.S.C.Regulation V-5 and SAE J684.

INSTALLATION WALKTHROUGH:

Parts List			
ITEM	QTY	PART NUMBER	DESCRIPTION
1	5	30-00149	WASHER, S-CON, 1/2, YZ
2	5	10-10277	HHCS, M12x1.25, 40, CL10.9, YZ
3	2	CM-116415-CT	CABLE TIE 11/64 X 15" 50# UV BLACK

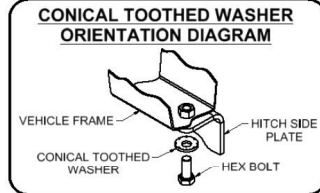

DRIVER SIDE UNDERBODY PANEL

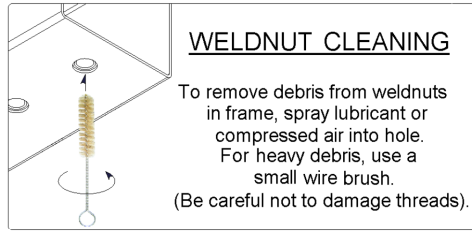

REARWARD PASSENGER SIDE UNDERBODY PANEL

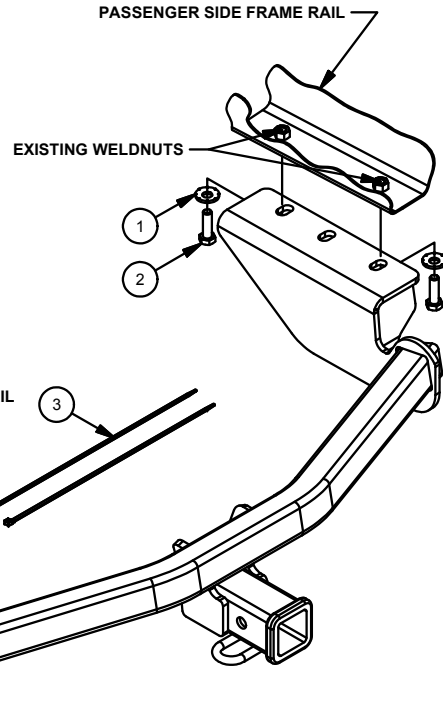

"HANDS FREE, FOOT-ACTIVATED POWER LIFTGATE" MAY ONLY WORK IN LIMITED AREAS WHEN HITCH INSTALLED



Installation on 2013-2015 models

1. Follow steps 6-9.
2. Trim fascia by locating the center and mark 4" wide centered and mark 1" up from the lower edge. Before trimming make sure there are no wires in the way. Trim as needed.

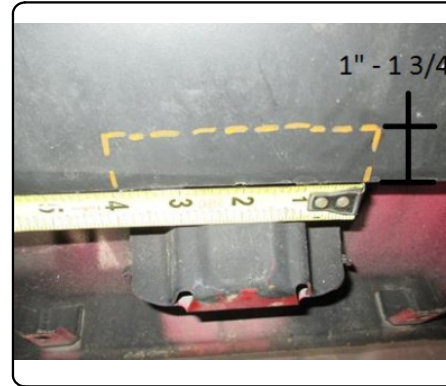

3. Bend the frame tab at the end of the frame rearward to make room for the hitch on both sides.
4. Pull the fascia tabs away and raise the hitch over the passenger side exhaust then slide under the fascia into position. May need to gently pull out fascia to get hitch into place.
5. Skip to steps 11-13 and 14-15 as needed.



INSTALLATION WALKTHROUGH:

Installation on 2016-2018 models

6. If present, remove the driver side underbody panel and panels between the fascia and end panels with a flat screw driver and 10mm socket. Return panel(s) to vehicle owner if not trimming.
7. Remove the recover loop bracket using a 17mm socket and return to vehicle owner.



8. Lower exhaust by lowering the rearmost exhaust isolator while supporting the exhaust.
9. If present, remove kick sensor from lower bumper cover before trimming to prevent damage.

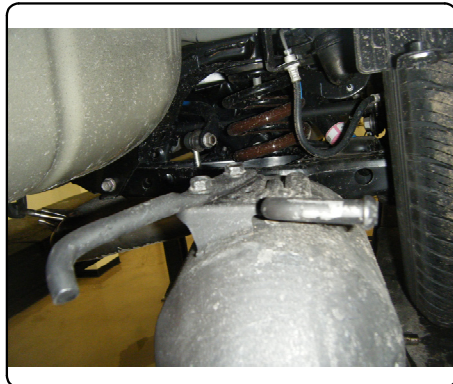

10. Trim fascia by locating the center and mark 4" wide centered and mark 1 3/4" up from the lower edge. Before trimming make sure there are no wires in the way. Trim as needed.
11. Raise hitch into position over the exhaust and into the bumper cavity. Loosely install supplied bolts and conical tooth washers to hold hitch in place.

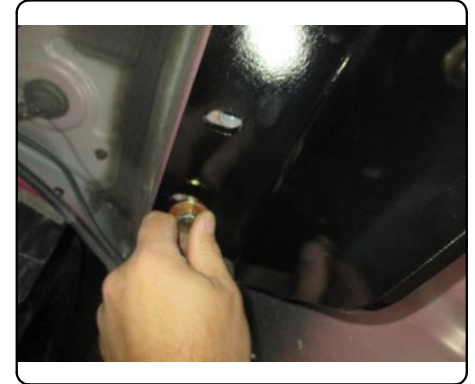

12. Torque all 12mm bolts to 86 lb-ft.
13. If removed in step 9, return kick sensor to bumper area and attach to the main cross tube of the hitch with supplied cable ties.
14. Raise exhaust back into position and reinstall exhaust isolator.
15. Trim and reinstall underbody panel(s) if reinstalling on vehicle.

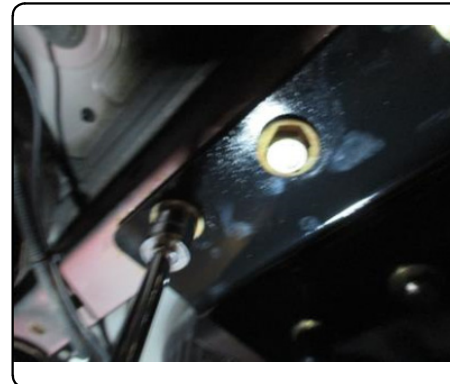

TOWING SAFETY INFORMATION

Gross Trailer Weight / GTW

The Gross Trailer Weight is the weight of the trailer & cargo. Measure this by putting the fully loaded trailer on a vehicle scale.

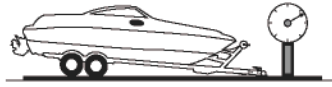

Tongue Weight / TW

The downward force that is exerted on the hitch ball by the coupler. The tongue weight will vary depending on where the load is positioned in relationship to the trailer axle(s). To measure the tongue weight, use either a commercial scale or a bathroom scale with the coupler at towing height. When using a bathroom scale with heavier tongue weights, use the method shown and multiply the scale reading by 3.

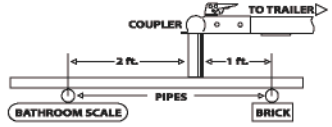

Weight Carrying / WC

The total weight of both the trailer and the cargo inside. Never exceed the weight capacity of your trailer hitch.

Weight Distribution / WD

Used to balance the weight of the cargo between the front and rear wheels throughout the trailer, allowing for better steering, braking, and level riding.



Sway Control

A device used to reduce the lateral movements of the trailer that are caused by the wind. This works in conjunction with a weight distribution hitch. Do not use this on a class 1 or 2 hitch, or with surge brakes.

How Much Can You Safely Tow?

TONGUE WEIGHT lbs	1000	2000	3000	4000	5000	6000	7000	8000	10,000	12,000
Tongue weight should be about 10 to 15 percent of the gross trailer weight.										
CLASS 1										
CLASS 2										
CLASS 3										
CLASS 4										
CLASS 5										
TRAILER TYPE										
Camper	11'	12'	13'	14'	15'	16'				
lbs	1100	1200	1300	1400	1500	1600				
Vacation	14'	16'	18'	20'	22'	24'	26'	28'	30'	32'
lbs	2100	2400	2700	3000	3300	3600	3900	4200	4500	4800
Vacation	14'	16'	18'	20'	22'	24'	26'	28'	30'	32'
lbs	2800	3200	3600	4000	4400	4800	5200	5600	6000	6400
5th Wheel										
Refer to owner's manual for towing capabilities and limitations.										

Ball Mount

The ball mount is placed inside the opening of the receiver hitch which is mounted to the vehicle. Make sure a hitch pin and clip is properly securing the ball mount to the receiver hitch before you begin towing.

- A: Rise. B: Drop. C: Hole Size. D: Length.



Trailer Ball

The connection from the hitch to the trailer. There are many factors that determine the correct hitch ball:

- Number one is the hitch ball's gross trailer weight rating.
- The mounting platform must be at least 3/8" thick.
- The hole diameter must not be more than 1/16" larger than the threaded shank.
- Every time you tow, check the nut and lock washer to make sure they are fastened securely.
- A: Ball Dia. B: Shank Dia. C: Shank Length. D: Shank Rise.

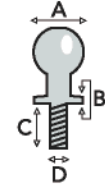

Coupler

The component that is placed over the trailer ball to connect the vehicle to the trailer. Be sure that the coupler size matches the size of the hitch ball and that the coupler handle is securely fastened. To determine what size hitch ball you need for your application you will need to know the size of coupler that is on the trailer. Be sure your coupler is properly adjusted to the ball you are using.

NOTE: For added security the use of safety devices such as Coupler Safety Pins and Locks is strongly recommended.

Safety Chains

Safety chains are a requirement and should be crossed under the tongue of the trailer so that the tongue will not drop to the road if it becomes separated from the hitch. Always leave enough slack so you can turn. Never allow the safety chains to drag on the ground and never attach the chains to the bumper.

Trailer Classification: Safety Chain Breaking Force - Minimum

- Class 1: 2,000 lbs. (8.9 kN)
- Class 2: 3,500 lbs. (15.6 kN)
- Class 3: 5,000 lbs. (22.2 kN)

The strength rating of each length of safety chain or its equivalent and its attachments shall be equal to or exceed in minimum breaking force the GVWR (Gross Vehicle Weight Rating) of the trailer.

Electrical

Trailer lights, Electric Brakes, Break-away systems - Every time you tow, be sure to check that all components are working properly.

Wiring identification by color:

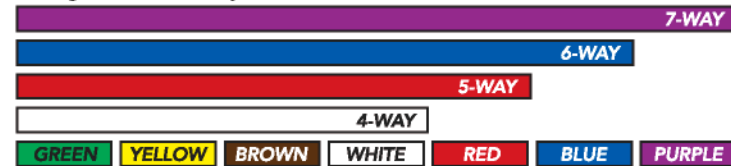

13406**TOYOTA RAV4****5/13/2019**

GROSS LOAD CAPACITY WHEN USED AS A WEIGHT CARRYING HITCH: 3,500 LBS. TRAILER WEIGHT & 350 LBS. TONGUE WEIGHT.

**WARNING: *** DO NOT EXCEED VEHICLE MANUFACTURER'S RECOMMENDED TOWING CAPACITY *****FOR MORE INFORMATION LOG ONTO WWW.CURTMFG.COM
HAVING INSTALLATION QUESTIONS? CALL TECHNICAL SUPPORT AT 1-800-798-0813

Parts List			
ITEM	QTY	PART NUMBER	DESCRIPTION
1	5	30-00149	WASHER, S-CON,1/2,YZ
2	5	10-10277	HHCS,M12x1.25,40,CL10.9,YZ
3	2	CM-116415-CT	CABLE TIE 11/64 X 15" 50# UV BLACK

TOOLS REQUIRED
TORQUE WRENCH
RATCHET
10, 17, 19mm SOCKETS
STRAIGHT SCREW DRIVER
AVIATOR SHEARS
TAPE MEASURE
MARKER
6" SOCKET EXTENSION
UTILITY KNIFE
SAFETY GLASSES

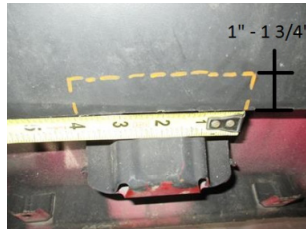
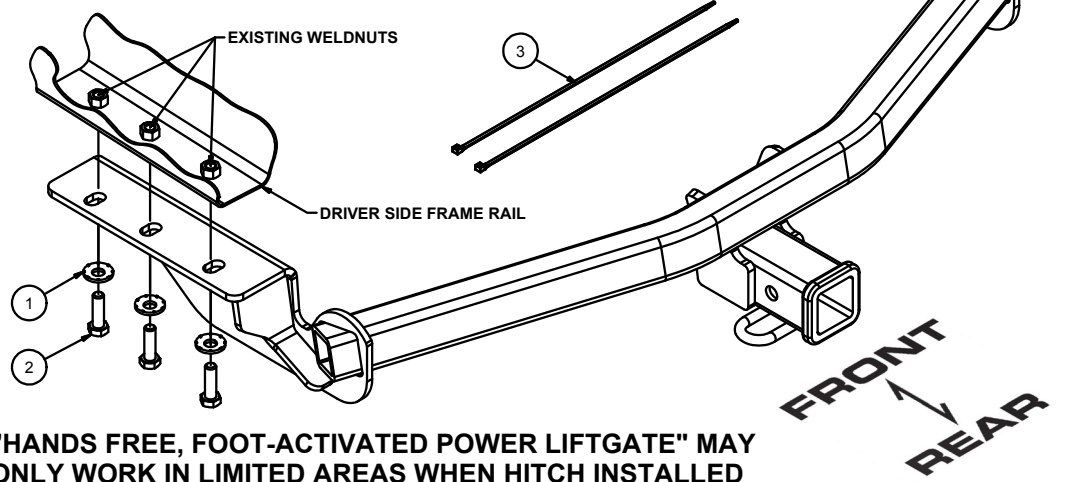
**DRIVER SIDE UNDERBODY PANEL****LOWER FASCIA TRIM DIAGRAM****REARWARD PASSENGER SIDE UNDERBODY PANEL****"HANDS FREE, FOOT-ACTIVATED POWER LIFTGATE" MAY ONLY WORK IN LIMITED AREAS WHEN HITCH INSTALLED**

HITCH WEIGHT: 46 LBS.

INSTALL TIME

PROFESSIONAL: 20 MINUTES

NOVICE (DIY): 40 MINUTES

INSTALL NOTES:

- NO DRILLING REQUIRED
- TRIMMING REQUIRED
- LOWER EXHAUST
- RELOCATE KICK SENSOR

INSTALLATION STEPS**Installation on 2013-2015 models**

1. Follow steps 6-9.
2. Trim fascia by locating the center and mark 4" wide centered and mark 1" up from the lower edge. Before trimming make sure there are no wires in the way. Trim as needed.
3. Bend the frame tab at the end of the frame rearward to make room for the hitch on both sides.
4. Pull the fascia tabs away and raise the hitch over the passenger side exhaust then slide under the fascia into position. May need to gently pull out fascia to get hitch into place.
5. Skip to steps 11-13 and 14-15 as needed.

Installation on 2016-2018 models

6. If present, remove the driver side underbody panel and panels between the fascia and end panels with a flat screw driver and 10mm socket. Return panel(s) to vehicle owner if not trimming.
7. Remove the recover loop bracket using a 17mm socket and return to vehicle owner.
8. Lower exhaust by lowering the rearmost exhaust isolator while supporting the exhaust.
9. If present, remove kick sensor from lower bumper cover before trimming to prevent damage.
10. Trim fascia by locating the center and mark 4" wide centered and mark 1 3/4" up from the lower edge. Before trimming make sure there are no wires in the way. Trim as needed.
11. Raise hitch into position over the exhaust and into the bumper cavity. Loosely install supplied bolts and conical tooth washers to hold hitch in place.
12. Torque all 12mm bolts to 86 lb-ft.
13. If removed in step 9, return kick sensor to bumper area and attach to the main cross tube of the hitch with supplied cable ties.
14. Raise exhaust back into position and reinstall exhaust isolator.
15. Trim and reinstall underbody panel(s) if reinstalling on vehicle.

PERIODICALLY CHECK THIS RECEIVER HITCH TO ENSURE THAT ALL FASTENERS ARE TIGHT AND THAT ALL STRUCTURAL COMPONENTS ARE SOUND.

Scan for more information

CURT Manufacturing LLC., warrants this product to be free of defects in material and/or workmanship at the time of retail purchase by the original purchaser. If the product is found to be defective, CURT Manufacturing LLC., may repair or replace the product, at their option, when the product is returned, prepaid, with proof of purchase. Alteration to, misuse of, or improper installation of this product voids the warranty. CURT Manufacturing LLC.'s liability is limited to repair or replacement of products found to be defective, and specifically excludes liability for incidental or consequential loss or damage.

This product complies with safety specifications and requirements for connecting devices and towing systems of the state of New York, V.E.S.C.Regulation V-5 and SAE J684.