



# HOW TO: CORE TRAX INSTALL

### EASY TO DO RIGHT:

Read **AND FOLLOW** the instructions provided below

### REALLY EASY TO DO WRONG:

There are four **SUPER EASY** ways to screw up. RESULT: You **WRECK** your deck

### TOOLS NEEDED:

- DRILL
- 1/16" DRILL BIT
- 11/64" DRILL BIT
- 1/2" DRILL STOP
- #3 PHILLIPS SCREWDRIVER (CAUTION: YOU'LL MOST LIKELY STRIP OUT THE SCREWS IF YOU USE A #2 SCREWDRIVER. BAD.)

**STEP 1:** Place the track in the slot on the deck as shown below (left). The tracks must be placed in this slot only; it's wider than the others. The tracks can be oriented to either the tailgate end or the cabside end of the deck, but make sure each track hole is over a deck dimple (those dimples correspond to the steel tubes, see below, right).

**EASY MISTAKE # 1:** The track can be placed on the tailgate end or the cabside end of the deck. If you orient the tracks incorrectly, all the track holes will not match all the steel tubes (marked by dimples) you are drilling into. Make sure the pre-drilled holes (on the track) are ALL over the dimples. And whatever you do, **DO NOT DRILL ANY HOLES YET!**

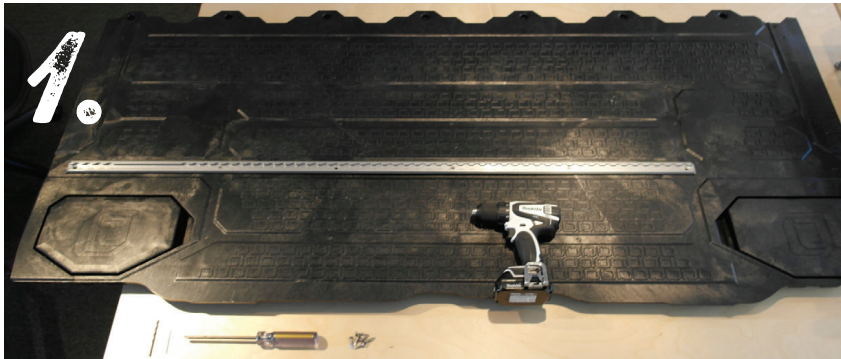

**EASY MISTAKE # 2:** Drilling through both sides of steel tubes. **ONLY** drill through the top of steel tube! Make sure to use a 1/2" drill stop.



**THESE ARE THE STEEL TUBES (UNDERSIDE OF DECK)**

**THESE MIGHT BE USEFUL:** Watch installation videos at [www.DECKED.com/video](http://www.DECKED.com/video)



# HOW TO: CORE TRAX INSTALL (continued)

**STEP 2:** Center the track end slots over **BOTH** the end dimples as best you can. You'll need to slightly shift the track to get it as centered as possible. **MAKE SURE EACH AND EVERY TRACK HOLE IS OVER A DIMPLE.**

2.

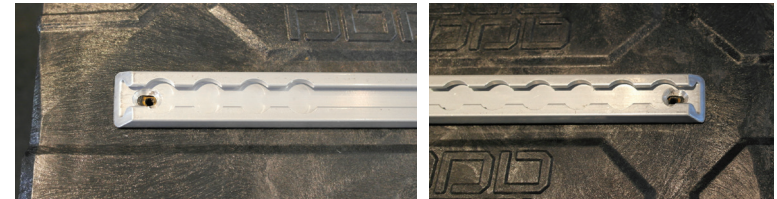

**STEP 3:** After you've checked to make sure you're lined up properly, fore & aft:

a) Drill a starter hole in each **END DIMPLE ONLY** using a 1/16" bit; **ONLY DRILL THROUGH TOP OF STEEL TUBE! DRILLING ALL THE WAY THROUGH WILL LET WATER INTO YOUR DRAWERS = BAD!**

**EASY MISTAKE #3: DO NOT drill interior holes yet; only the end holes**

b) With the track in place, drill a 11/64" hole on each end, **CENTERED** as best you can over the dimples; **THROUGH THE TOP OF THE STEEL TUBE ONLY!**

c) Install with #3 Phillips screwdriver but do not tighten down end screws.

**EASY MISTAKE #4: Using a #2 Phillips screwdriver**

3.

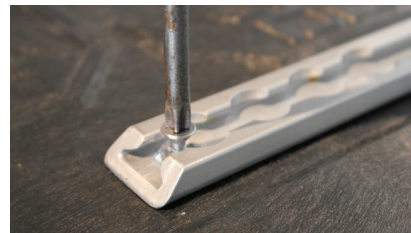

**STEP 4:** If you've gotten to this point following the directions, it should be a cake walk:

a) Locate and center the central hole in the core track to the center of the nearest dimple in the deck, drill holes using a 1/16" bit install and tighten center screw.

b) Tighten end screws.

c) Using Core Trax as a guide, drill the rest of the interior 11/64" holes and install screws.

**NOTE:** Even if you've been careful, some track holes won't be perfectly centered over the interior dimples. That's OK, you're still mounting into the steel tubes

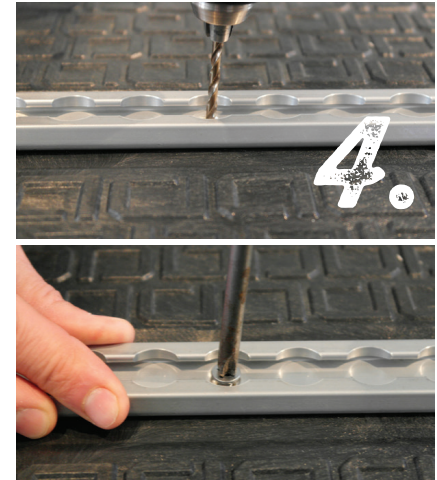

**THESE MIGHT BE USEFUL:** Watch installation videos at [www.DECKED.com/video](http://www.DECKED.com/video)