



INSTALLATION MANUAL
FORD BRONCO FRONT FENDERS
PRODUCT NUMBER: FB2000
APPLICATION: 2021 FORD BRONCO



IMPORTANT SAFETY GUIDE | Your safety and the safety of others is very important.

In order to help you make informed decisions about safety, we have provided the following warnings, safety precautions, installation instructions, and other important information to alert you to potential hazards that could hurt you or others.

Please do a job safety analysis before each task to identify potential hazards for your situation and remove/protect against them. Use own good judgment and take your time.

Check packaged materials immediately upon arrival to ensure that all listed parts are included and undamaged.

Read and understand all warnings, safety precautions, and instructions before installing this product.

SENSORS FIELD OF VIEW MAY BE ALTERED WITH USE OF THE REPLACEMENT BUMPER.

WARNINGS

- Failure to observe the following warnings and instructions provided in this manual could lead to severe injury and/or death.
- For professional installation only. Careless installation and/or operation can result in serious injury, death, and/or equipment damage. All liability for installation and use rests with the user or consumer.
- Fab Fours, Inc. only approves installing this product according to these written instructions with the hardware provided. Failure to install according to these instructions will invalidate the warranty. This includes, but is not limited to, using alternative installation methods, hardware, or materials.
- This product is for off road use only.

SAFETY PRECAUTIONS

- Always remove jewelry and wear eye protection.
- Always use extreme caution when jacking up a vehicle for work. Set emergency brake and use tire blocks. Locate and use the vehicle manufacturers designated lifting points. Use jack stands.
- Always use appropriate and adequate care in lifting components into place.
- Always ensure components will remain secure during installation and operation.
- Always wear safety glasses when installing this kit. A drilling operation will cause flying metal chips. Flying chips can cause serious eye injury.
- Always use extreme caution when drilling a vehicle. Always disconnect power before welding. Thoroughly inspect the area to be drilled (on both sides of material when possible) prior to drilling, and relocate any objects that may be damaged.
- Always use extreme caution when welding a vehicle. Thoroughly inspect the area to be welded (on both sides of material when possible) prior to welding, and relocate any objects that may be a fire hazard. When welding in a cab, make sure the interior surfaces are covered (e.g., welding blanket) and a fire extinguisher is at hand.
- Always use extreme caution when cutting and trimming during fitting.
- Always tighten all nuts and bolts securely per installation instructions.
- Always route electrical cables carefully. Avoid moving parts, components that become hot, and rough or sharp edges.
- Always insulate and protect all exposed wiring and electrical terminals.
- Perform regular inspections and maintenance on mounts and hardware.

TABLE OF CONTENTS

- 2 SAFETY / DISCLAIMER
- 3 TABLE OF CONTENTS
- 4 A MESSAGE FROM THE OWNER
- 5 GETTING STARTED
- 6 PROVIDED MATERIAL
- 8 DISASSEMBLY
- 17 PREINSTALLATION
- 18 INSTALLATION
- 21 CONTACT

A MESSAGE FROM THE OWNER



Fab Fours' was born out of a passion for customizing vehicles and a love of the outdoors. Our engineering team uses the latest 3D design software to turn new product ideas into reality. In our factory, designs come to life with the combination of cutting edge technology for metal cutting and forming and an American workforce that puts its' heart and pride into every product.

From design and manufacturing, to quality and delivery, Fab Fours' mission is to be the market leader for steel truck and jeep accessories. We make sure a quality product is delivered on time, more than expected, better than expected to our customers.

Enjoy your new Fab Fours product. Welcome to the family!

Greg Higgs

FOUNDER, FAB FOURS

GETTING STARTED

Before you begin the installation process of your new Fab Fours product, we suggest laying out all materials and parts on a pad or protective surface.

Failure to fully account for all components before beginning installation may leave vehicle immobile until part is acquired. Refer to the next pages as an inventory check.

PROVIDED MATERIALS

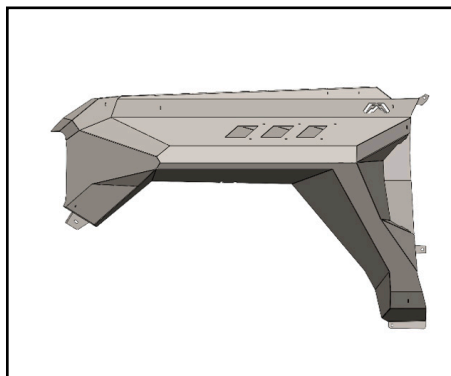

22792 - DS FRONT FENDER

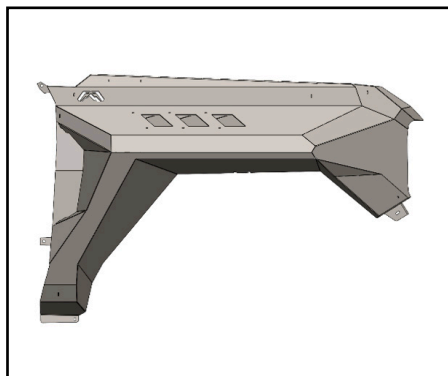

22793 - PS FRONT FENDER

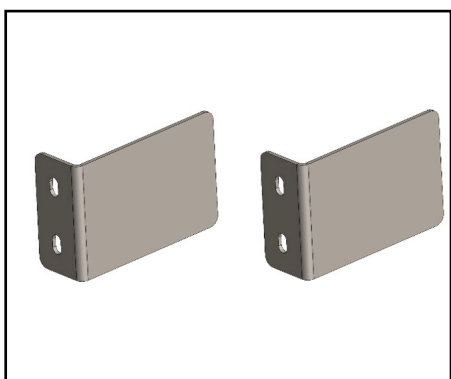

22813 - LOGO BACKING
PLATE (QTY: 2)

FB2000-IM
INSTRUCTION
MANUAL

50353-HW -
HARDWARE
KIT

TOOLS REQUIRED

- PLASTIC PUSH RIVET
REMOVAL TOOL
- NEEDLE NOSE PLIERS
- 7MM SOCKET WRENCH
- 8MM SOCKET WRENCH
- 10MM SOCKET WRENCH
- 13MM SOCKET WRENCH
- 3/8" SOCKET WRENCH
- 5/16" COMBINATION
WRENCH

ASSISTANCE

We recommend two people perform the installation as items are heavy and may need to be held in place while installing.

ORGANIZATION

Disassemble the vehicle where you can catalog and store everything. We suggest labeling and bagging all the OEM bolts when removing from the vehicle. Failure to keep track of parts could lead to an inability to properly reinstall components.

HARDWARE KIT | FB2000-IM

FAB FOURS IDENTIFICATION	COMPONENT DESCRIPTION	QTY
50353-HW	1/4" Bolt Yellow Zinc Steel	4
50353-HW	1/4" Hex Nut Zinc Steel	4
50353-HW	1/4" Flat Washer Zinc Steel	8
50353-HW	1/4" Lock Washer Zinc Steel	4
50353-HW	#10 Bolt Yellow Zinc Steel	4
50353-HW	#10 Hex Nut Steel	4
50353-HW	#10 Split Washer Steel	4
50353-HW	#10 Flat Washer Steel	8

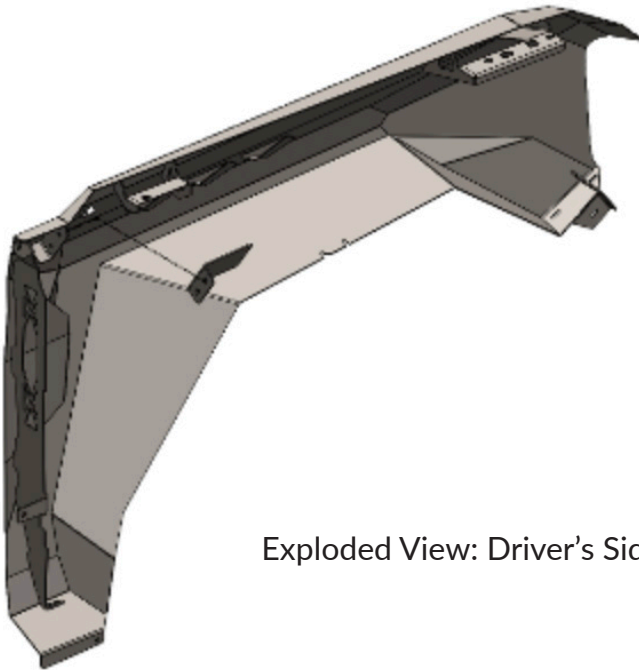

Exploded View: Driver's Side

DISASSEMBLY

1. Roll down all four windows. (Figure 1)



Figure 1

2. Push the side view mirrors forward. (Figure 2)



Figure 2

3. Place the fender and door protectors in the OE provided tool pouch; install one over the fender edge near the upper door hinge and the other on the door edge near the bottom door hinge; see your OE provided Owner's Manual for specific placement.

4. Pull on the electrical connector door to release the electrical connector. (Figure 3)

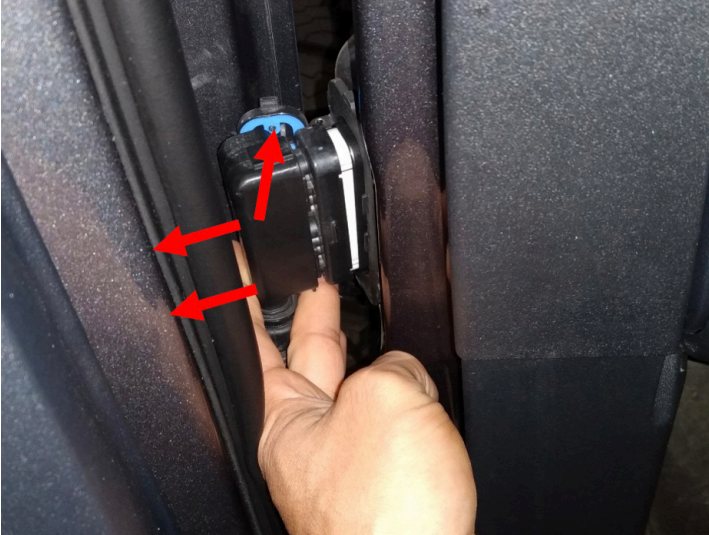

Figure 3

5. Install the door storage bag on the door being removed, if equipped. (Figure 4)



Figure 4

6. Using the OE provided 13mm socket and wrench, remove the lower hinge bolt. (Figure 5)



Figure 5

7. Using the OE provided 13mm socket and wrench, remove the upper hinge bolt. (Figure 6)



Figure 6

8. Lift the door, using the lift handle and exterior door handle to remove the door from the vehicle. (Figure 7)



Figure 7

9. Repeat these steps to remove the front passenger door.

10. Remove factory fender flares by turning plastic levers and pulling off flares. (Figure 8)



Figure 8

11. Using pop rivet removal tool and Phillip's head screwdriver, remove plastic push rivets from inner fender. Use 7mm socket to remove remaining sheet metal screws from inner fender. Remove plastic inner fender and set aside.

12. Using 13mm socket, remove three (3) OE Bolts from plastic block inside wheel well and remove block. (Figure 9)



Figure 9

13. Gently pull front valence from plastic clips. (Figure 10)



Figure 10

14. Pull side plastic valence to gain access to three (3) 8mm screws. Remove screws using 8mm socket. Remove plastic block by squeezing plastic clip together with needle nose pliers (Figure 11)



Figure 11

15. Use 10mm socket to remove lower front fender bolt. (Figure 12) Save bolt for later use.



Figure 12

16. Use 7mm socket to remove fender bolt under side view mirror. (Figure 13) Save for a later use.



Figure 13

17. Use 10mm socket to remove two (2) nuts, and bolt from front trail sight and remove. (Figure 14) Save bolt and one (1) nut for later use.



Figure 14

18. Use 10mm socket to remove all remaining bolts from fender. (Figures 15 & 16) Remove fender and set aside. Save bolts for later use.



Figure 15



Figure 16

19. Remove all push pins holding the plastic radiator cover. (Figure 17)



Figure 17

20. Using a 10mm socket, remove the four (4) bolts holding the top of the grill to the radiator frame. (Figure 18)

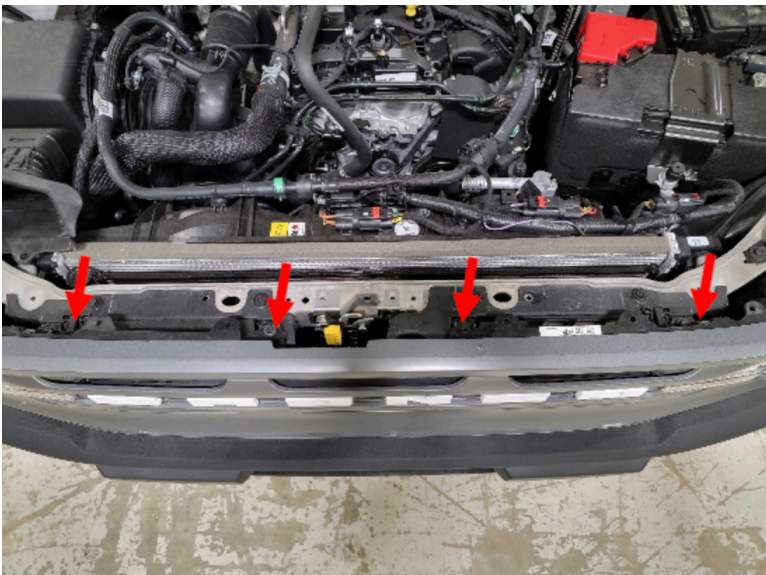

Figure 18

21. Remove OEM grill by carefully pulling the clips free at the base and sides of grill.

PREINSTALLATION

****Note: The following preinstallation steps should be repeated on opposite fender ****

22. Using 7/16" socket and combination wrench attach logo backing plate (22813) to mounting bracket on inside of fender using two (2) 1/4" bolts, nuts, flat washers (4) and lock washers (50353-HW). (Figure 19)

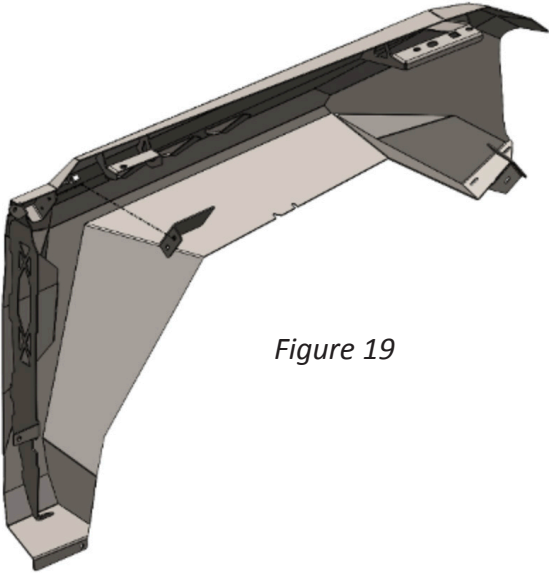

Figure 19

INSTALLATION

23. Locate sheet metal mounting tab on vehicle door jam. Bend tab forward to avoid interference. This tab will not be used. (Figure 20)



Figure 20

24. With assistance, set new fender (22792 & 22793) on vehicle and line up top mounting holes under hood.

25. Insert OEM bolts into rearmost and frontmost mounting holes under hood. Do not tighten at this time. (Figure 21)



Figure 21

26. Insert four (4) OEM bolts into lower front mounting hole (Figure 22) and mounting holes in door jam and rocker panel (Figures 23-25) Do not tighten at this time.



Figure 22



Figure 23



Figure 24



Figure 25

27. Properly align fender with hood by gently closing and checking gap. Once satisfied with alignment, tighten OEM mounting bolts installed in steps 21 & 22.

28. Insert two (2) #10 bolts through existing slots in valence and through provided slots in fender. Using 3/8" socket and 5/16" combination wrench, tighten bolts to secure valence to fender. (Figure 26)



Figure 26

29. Reinstall front trail sight removed in step 17. Note: Front mounting stud and nut will no longer be used.

30. Repeat steps 23-26 on opposite side fender.

31. Reverse steps 19-21 to reinstall front grill.

INSTALLATION COMPLETE

CONTACT INFORMATION

**FAB FOURS INC.
2213 INDUSTRIAL PARK ROAD
LANCASTER, SC 29720**

PHONE: (866) 385-1905

FAX: 970-385-1914

EMAIL: SUPPORT@FABFOURS.COM

FABFOURS.COM



**“IF YOU’RE LOOKING FOR MORE OF THE SAME,
THEN YOU’VE COME TO THE WRONG PLACE.”**

- GREG HIGGS

