



FRONT RUNNER

**LAND ROVER DEFENDER
SUMP GUARD**

ENG

SGLD010



INSTALL TIME: 45 mins

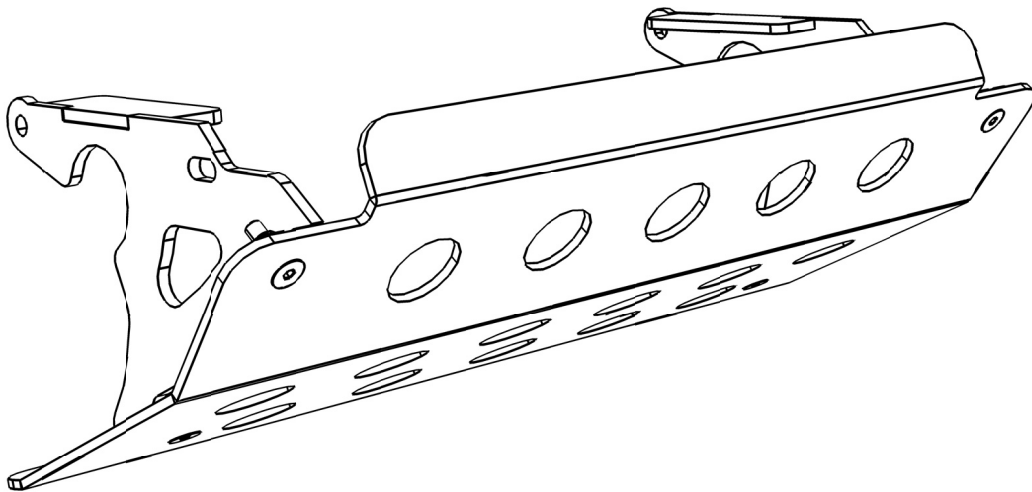

IMPORTANT WARNING!

IT IS CRITICAL THAT ALL FRONT RUNNER PRODUCTS BE PROPERLY AND SECURELY ASSEMBLED AND ATTACHED TO YOUR VEHICLE. IMPROPER ATTACHMENT COULD RESULT IN AN AUTOMOBILE ACCIDENT, AND COULD CAUSE SERIOUS BODILY INJURY OR DEATH TO YOU OR TO OTHERS. YOU ARE RESPONSIBLE FOR ASSEMBLING AND SECURING ALL FRONT RUNNER PRODUCTS TO YOUR VEHICLE, CHECKING THE ATTACHMENTS PRIOR TO USE, AND PERIODICALLY INSPECTING THE PRODUCTS FOR ADJUSTMENT, WEAR, AND DAMAGE. THEREFORE, YOU MUST READ AND UNDERSTAND ALL OF THE INSTRUCTIONS AND CAUTIONS SUPPLIED WITH YOUR FRONT RUNNER PRODUCT PRIOR TO INSTALLATION OR USE. IF YOU DO NOT UNDERSTAND ALL OF THE INSTRUCTIONS AND CAUTIONS, OR IF YOU HAVE NO MECHANICAL EXPERIENCE AND ARE NOT THOROUGHLY FAMILIAR WITH THE INSTALLATION PROCEDURES, YOU SHOULD HAVE THE PRODUCT INSTALLED BY A PROFESSIONAL INSTALLER OR OTHER QUALIFIED PERSONNEL.

1 GET ORGANIZED...

Here is what you are looking at:

Item #	Quantity	Description
1	4	M10X30X3 Flat Washer
2	4	M10 Nyloc Hex Nut
3	4	M10X40 Countersunk Cap Screw
4	2	Sump Guard Brackets Left and Right
5	1	Sump Guard

You will need:

2x 19mm Socket or Wrench

17mm Socket or Wrench

6mm Hex Key

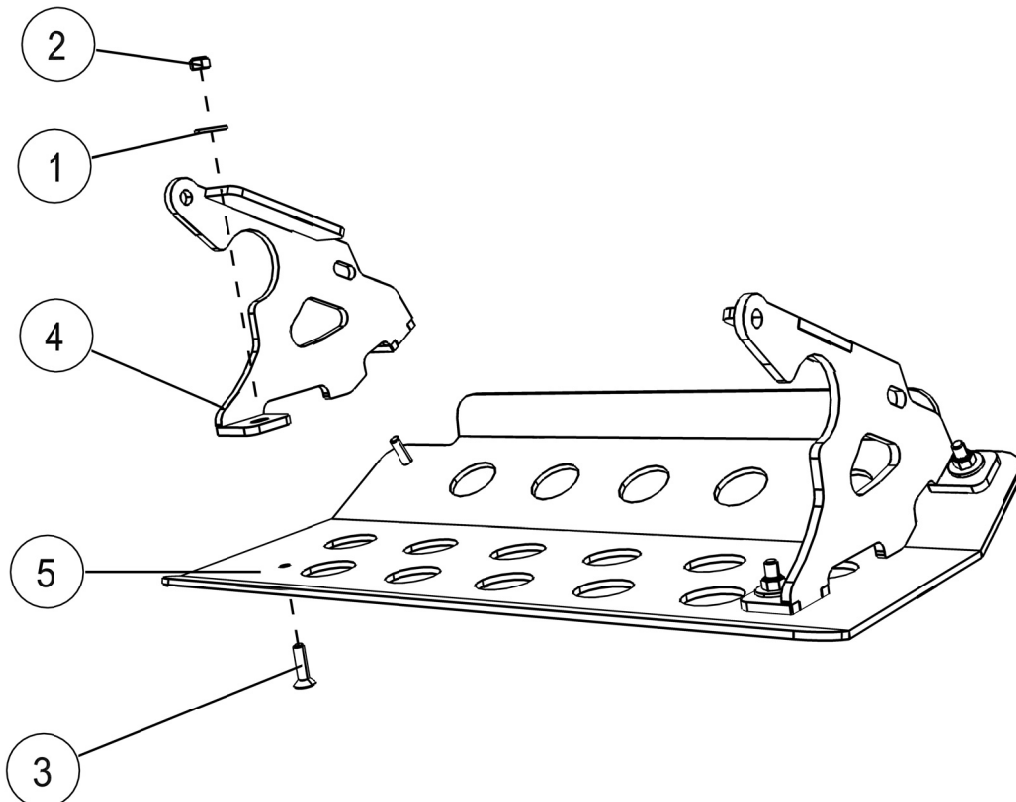
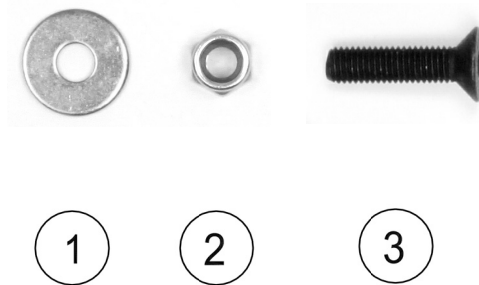

(A) Familiarize yourself with the parts and then step away from the work area and read through these instructions from beginning to end. Take a moment as a little prep now may save you a lot of time later.

2 INSTALLING SUMP GUARD



To install your Front Runner Sump Guard you will need to remove the factory fitted "Bush Bar".

- (A)** Remove Bush Bar by loosening the four Hex Bolts that go through the chassis rails. Retain the Hex Bolts and Hex Nuts for later use. Discard the Bush Bar and if your vehicle is fitted with Lashing Eye discard this too, you will not need these anymore.



- (B)** Working on the left-hand side of your vehicle. Insert the Hex Bolts with their respective Washers from the outside in. In the case of a right-hand drive vehicle leave the Spacer off the Rear Hex Bolt in this step, you will use it in Step 2C.

Identify the left-hand Bracket by the top and bottom flange that point inward. Once identified hang the bracket over the steering dampener and seat it over the Hex Bolts and against the chassis rail.

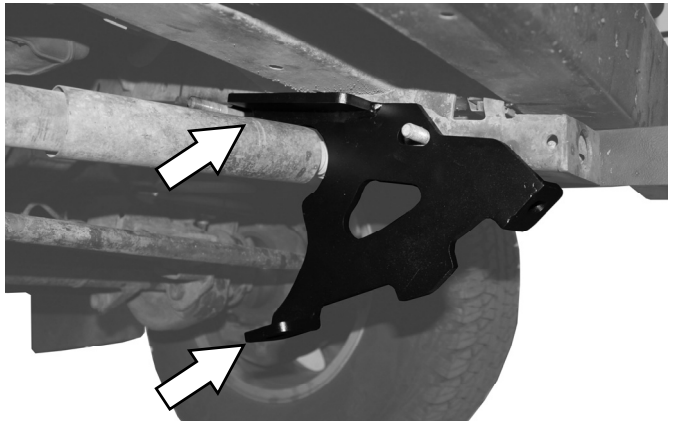

- (C)** Place the Spacer over the Rear Hex Bolt and fasten loosely with it's respective washer and Nyloc Hex Nut.

Loosely fasten the Front Hex Bolt with it's Washer and Nyloc Hex Nut.



2 INSTALLING SUMP GUARD CONT...

- (D)** Repeat Step 2C for the right-hand side Bracket. In this image you will see there is no Space on the Rear Hex Bolt. If your vehicle is a left-hand drive the steering gearbox would be on the other side of the vehicle. Fasten Hex Nuts loosely.



- (E)** Now fasten the Sump Guard on to the Brackets with the Four M10 Counter Sunk Cap Screws, four M10 Flat Washers and four M10 Nyloc Hex Nuts (Items 3, 2 & 1). Fasten the Sump Guard Fully.



- (F)** Finally fully fasten the Sump Guard Bracket to the chassis rails.

Congratulations, you have completed your installation. Take a step back and admire your work. Good Job!

