

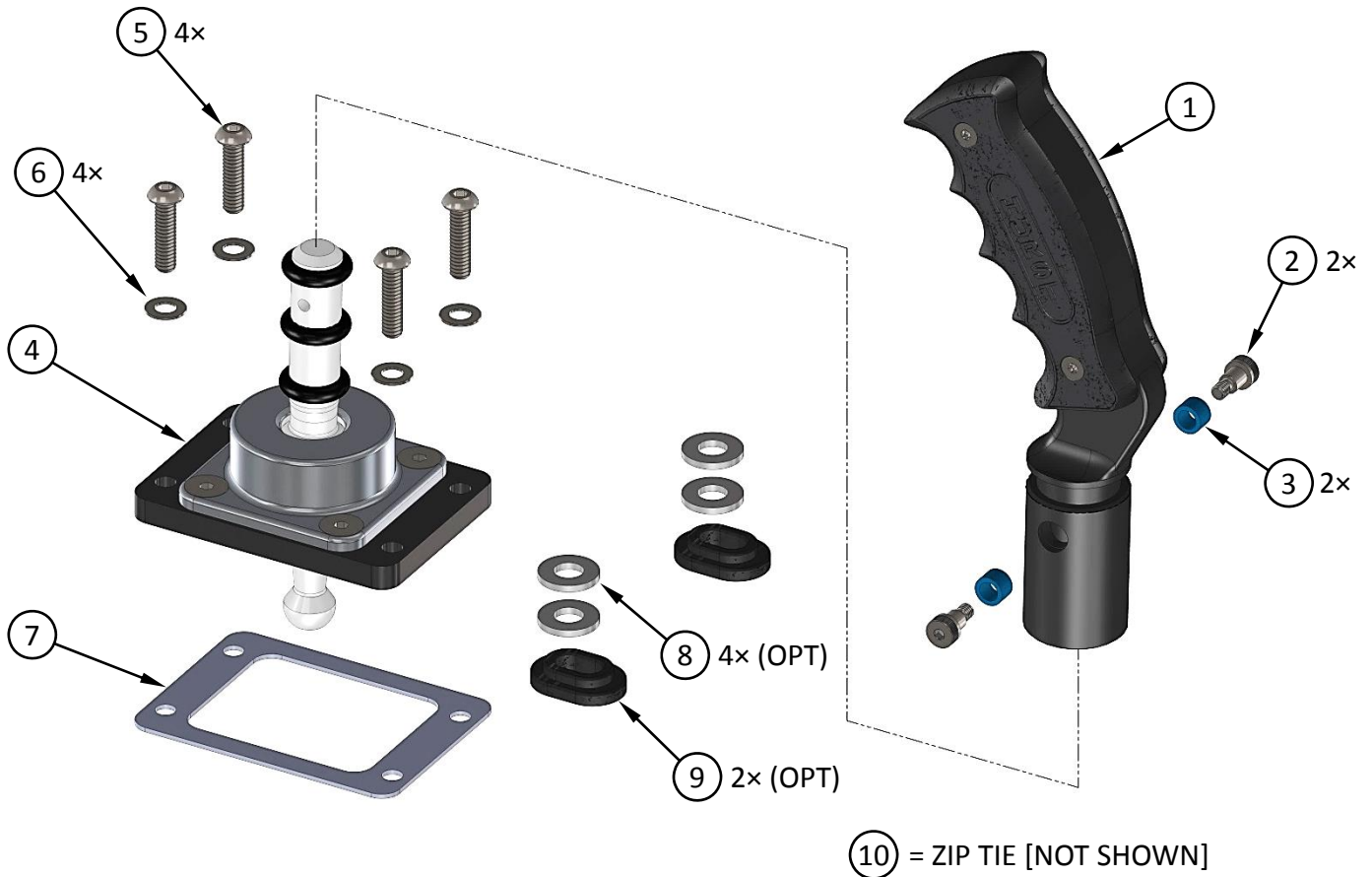

Installation Instructions for Catalog # 3916042
BILLET/PLUS PISTOL GRIP SHIFTER
 for 2014-2017 CHEVROLET CORVETTE
 w/MANUAL TRANSMISSION



ITEM NO.	PART NO.	DESCRIPTION	QTY.
1	N/A (SHIPS ASSEMBLED)	PISTOL GRIP ASSY	1
2	2156031	SHOULDER BOLT, 1/4" O.D. × 1/4" L × 10-32	2
3	2596031	ISOLATION SLEEVE, BLUE VINYL 1/4" I.D. × 1/4" L	2
4	N/A (SHIPS ASSEMBLED)	SHIFTER ASSY, 14-17 CHEV CORVETTE W/MAN TRANS	1
5	3401558	SCREW, 1/4-20 × 1" BUTTONHEAD SS	4
6	3400826	WASHER, FLAT 1/4"	4
7	4100528	GASKET, C5 CORVETTE SHFTR	1
8	3401039	WASHER, FLAT M8 OVERSIZED (OPTIONAL)	4
9	4101126	BUSHING, C5 & C6, ANODIZED (OPTIONAL)	2
10	5000250	6" ZIP TIE (NOT SHOWN)	1

BEFORE STARTING

- Take a moment to read and understand these instructions before installing your Hurst Billet/Plus Pistol Grip Shifter.
- Use the parts drawing and list (front page) to verify your kit's contents. In the unlikely event of missing parts, please contact Hurst Technical Support for replacements.
- We highly recommend that you retain all factory parts.
- **WORK SAFELY! TURN OFF YOUR VEHICLE'S IGNITION AND SET THE PARKING BRAKE BEFORE STARTING.**

RECOMMENDED MATERIALS

- General Purpose Grease
- Threadlocker (e.g., Loctite Blue 242)

REMOVE THE STOCK SHIFTER

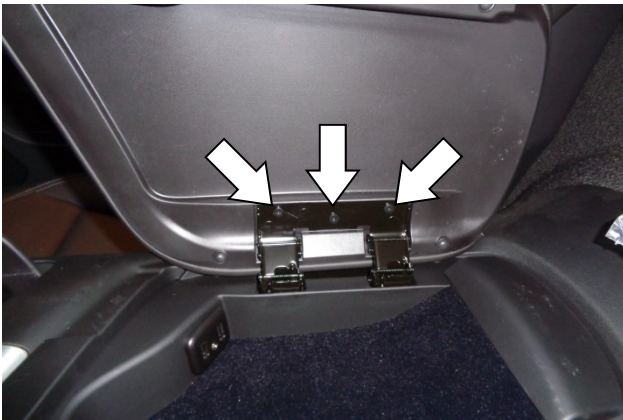

1. Remove the armrest door by removing the three screws shown.



2. Use a plastic trim tool to remove the driver side trim panel.



3. Rotate the shift boot collar (located inside the boot, just below the shift knob) 1/4 turn counter-clockwise and slide it down (away from the knob).



4. Remove the screw from the side of the shift knob, then lift the knob off of the shift lever.



5. Use a plastic trim tool on the sides and back of the center console panel to separate it from the center console.



6. Carefully lift the back end of the panel while lowering the front end, to view the three electrical connectors underneath.

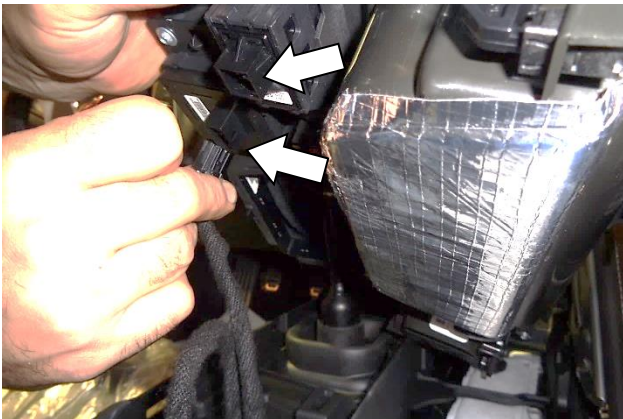

7. At the back end of the panel, disconnect the Parking Brake and Mode Select plugs.

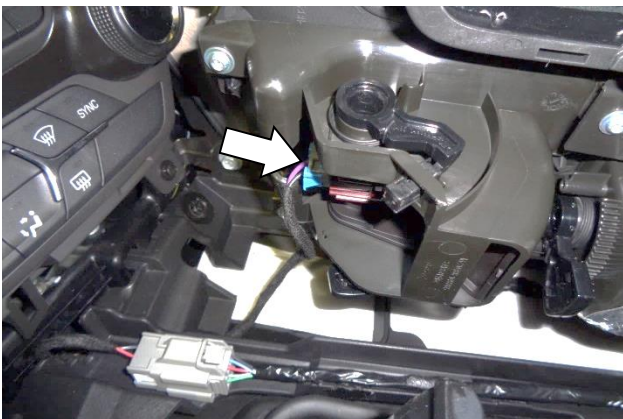

8. Carefully tilt the panel toward the passenger side to view the Cigarette Lighter plug.

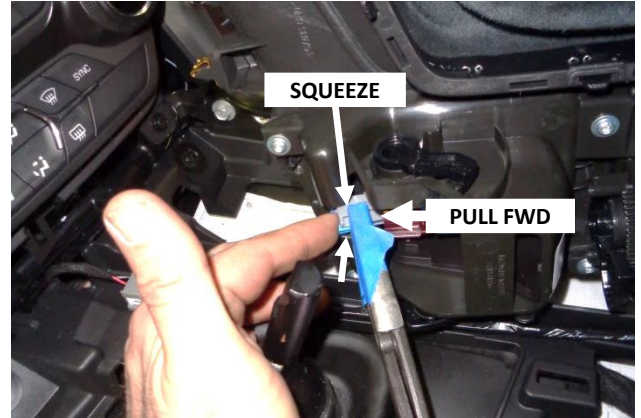

9. Gently squeeze the side of the plug (gray) with pliers to release the locking tab, while pulling the plug forward to remove it from its socket (red).



10. Remove the panel from the vehicle, then carefully pull the chrome collar off the inside of the shift boot. **NOTE: The parts are glued together; use care not to tear the shift boot.**



11. Use a plastic trim tool to remove the access cover at the rear of the center console.

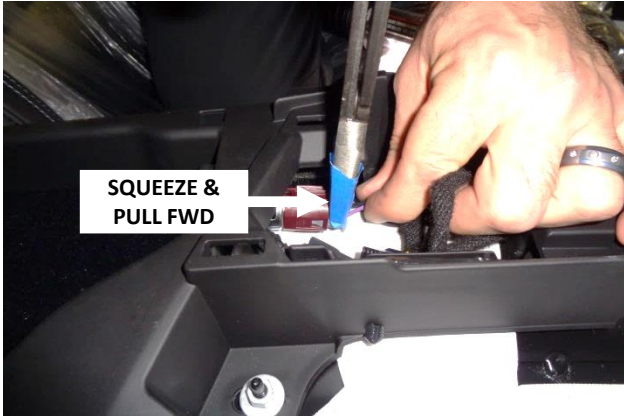

12. At the DC power connector, gently squeeze the side of the plug (gray) with pliers to release the locking tab, while pulling the plug forward to remove it from its socket (red).



13. Disconnect the USB charger plug.



14. At the front end of the center console, disconnect the console harness plug.



15. Remove the two nuts at the back of the center console.



16. Remove the two bolts at the front of the center console.



17. Remove the two nuts at the middle of the center console.



18. Release the console harness plug from the notch at the front of the center console, and carefully lift the console out of the vehicle.



19. Remove the upper plate from the shifter.

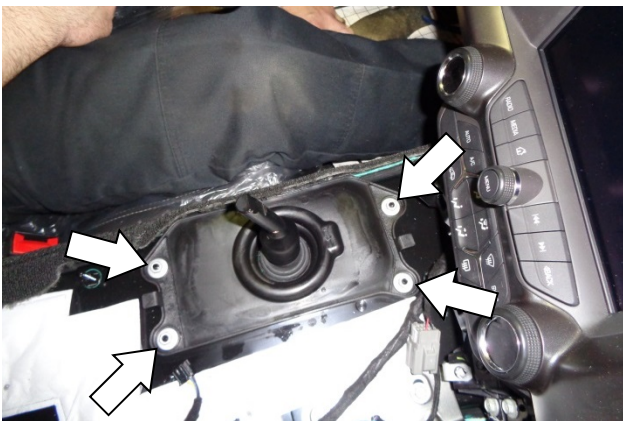

20. Remove the four nuts, then remove the lower plate from the shifter.

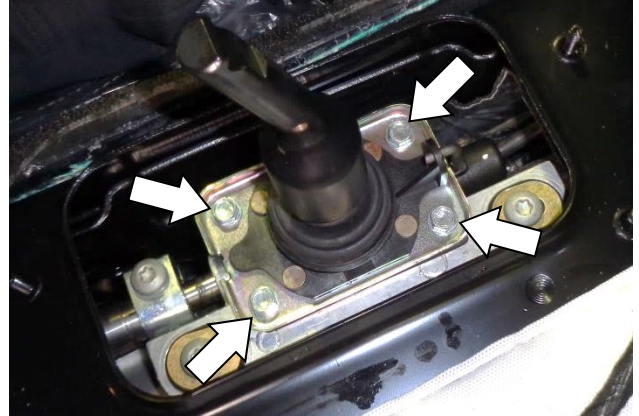

21. Put the transmission in NEUTRAL. Remove the four bolts, then remove the shifter assembly. If there is a rubber gasket on the shifter pad, remove it.

OPTIONAL: REPLACE RUBBER BUSHINGS

NOTE: The following section (Steps A – F) describes the installation of the optional metal bushings included in this kit. Because it replaces the rubber stock bushings, this configuration provides a more solid-feeling shift. (These steps are not necessary on the Z06 Corvette, as the stock shifter pad already uses metal bushings.)

IMPORTANT: Installation of the optional metal bushings will transmit more noise and vibration to the passenger compartment than the stock rubber bushings. **If a quieter, smoother shift is preferred, skip this section and proceed to Step 22.**

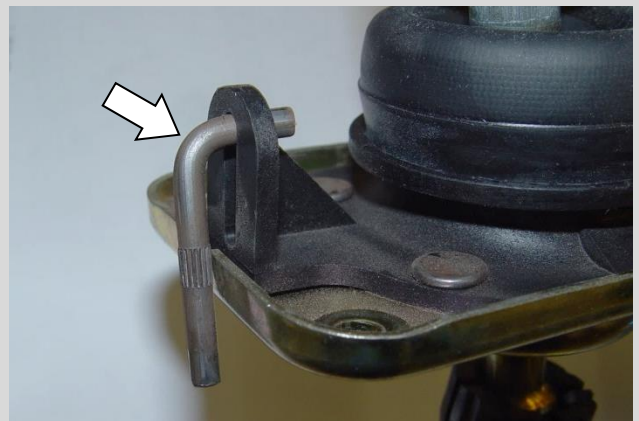

A. Remove "L" pin from the stock shifter.



B. Insert the "L" pin FULLY into the hole in the shift linkage support in front of the pad. Full insertion is required to maintain shift linkage alignment while replacing the bushings.



C. Remove the two screws that secure the shifter pad to the vehicle.



D. Remove the metal spacers and rubber bushings from both holes.



E. Lift the right side of shifter pad slightly, insert the bushings, item (9), into the holes from the underside, then return the pad to its normal position. **CAUTION: Handle the bushings with care so as to prevent them from falling into the shifter cavity!**



F. Reinstall the stock screws, using two washers (8) at each location (four washers total). After tightening both screws, remove the "L" pin and return it to the stock shifter.

INSTALL SHIFTER



22. Grease the pivot ball on the Hurst shifter assembly (4). Remove the pivot cup from the stock shifter, and snap it onto the new shifter's pivot ball.



23. Install gasket (7) on the shifter pad.



26. Reinstall the upper plate.

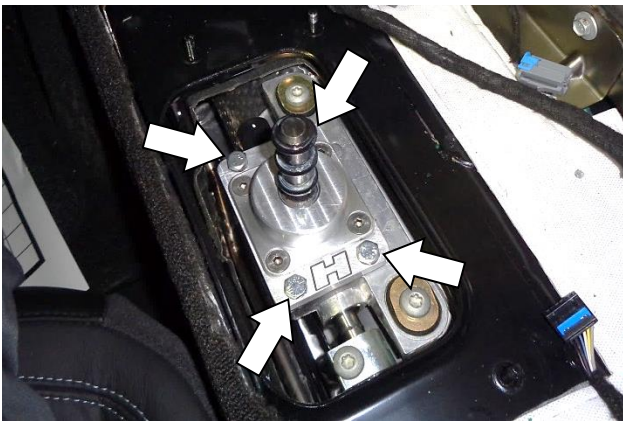

24. Apply a drop of threadlocker to the threads of each 1/4"-20 screw (5). Install the shifter assembly with the screws and the 1/4" washers (6).



27. Carefully return the center console to the vehicle, situating the console harness plug in the notch at the front.

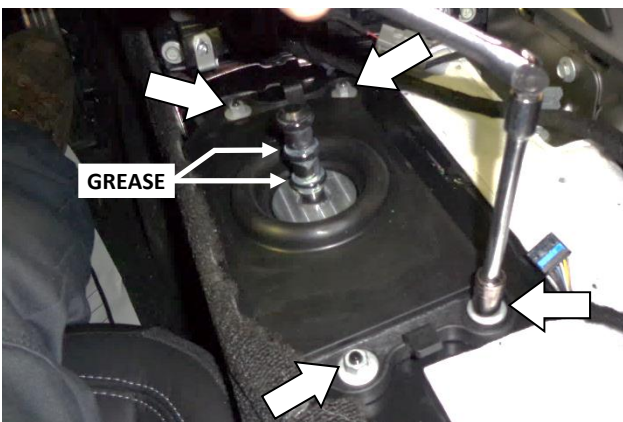

25. Reinstall the lower plate using the four stock nuts. Then grease the two lower o-rings on the shift rod.



28. Reinstall the two nuts at the middle of the center console.



29. Reinstall the two bolts at the front of the center console.



30. Reinstall the two nuts at the back of the center console.



31. Reconnect the console harness plug at the front end of the center console, and check the security of the connection.



32. Reconnect the USB charger plug, and check the security of the connection.



33. Reconnect the DC power connector, and check the security of the connection.



34. Snap the access cover back onto the rear of the center console.



35. Insert the pistol grip assembly (1) through the top of the shift boot, with its finger grooves facing forward. Secure the boot to the pistol grip at the groove with the zip tie (10) and trim off the excess.

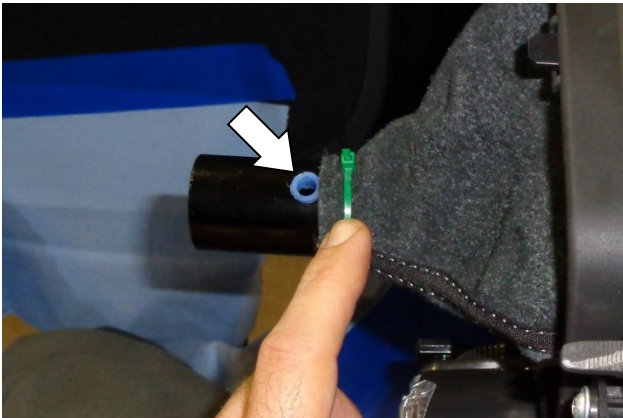

36. Insert an isolation sleeve (3) in the hole in each side of the pistol grip (2 places).



37. Bring the center console panel back into the vehicle and tilt it toward the passenger side. Reconnect the cigarette lighter plug, and check the security of the connection.



38. Grease the top o-ring on the shift rod. Slide the pistol grip assembly down over the shift rod, aligning the screw holes in the pistol grip and shift rod. Then secure the pistol grip to the shift rod with two shoulder screws (2).

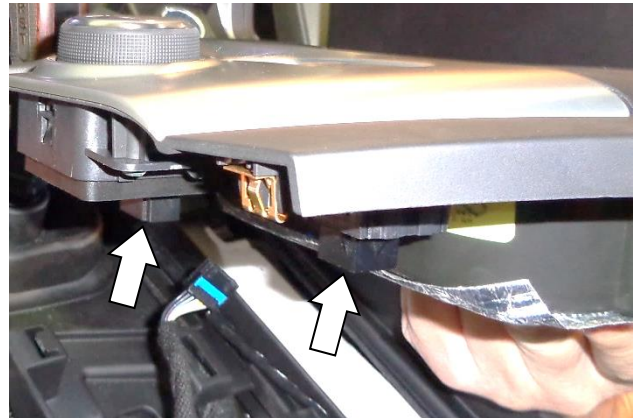

39. Reconnect the Parking Brake and Mode Select plugs, and check the security of the connections.



40. Reinstall the center console panel, ensuring that it is securely snapped into place on all four sides.



41. Reinstall the driver side trim panel.

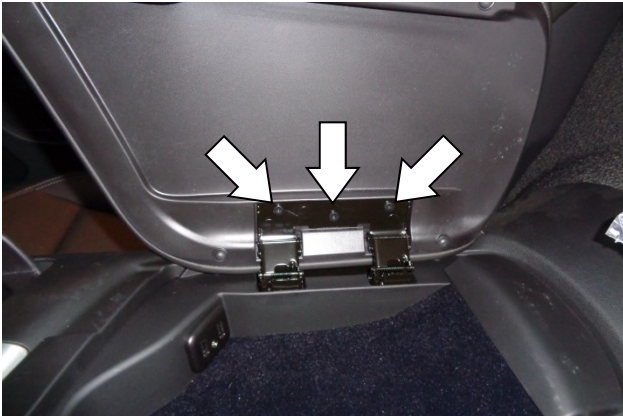

42. Reinstall the armrest door.



Congratulations, the installation of your Hurst Billet/Plus Pistol Grip Shifter is now complete!

IMPORTANT: RETAIN THESE INSTRUCTIONS FOR FUTURE REFERENCE

Hurst Technical Service: (707) 544-4761

Hurst Shifters maintains a highly-trained technical service department to answer your technical questions, provide additional product information and offer various recommendations.

Direct all correspondence and warranty questions to:

Hurst Shifters
100 Stony Point Rd.
Suite 125
Santa Rosa, CA 95401

