

**THANK YOU FOR SELECTING A HUSKY FLOOR LINER
FROM WINFIELD CONSUMER PRODUCTS
CARE AND USE INSTRUCTIONS**

Your new floor liners are custom molded to fit your Toyota 4Runner. The liners are made to take the place of your factory floor mats. **For correct fit, it is necessary to remove the factory floor mats before installing your new floor liner.** However, do not remove the factory-installed carpeting.

Your liners are made from an engineering resin that is lightweight and extremely tough and durable. The easiest way to clean your liners is with a damp cloth or sponge. If using a cleaner, 409[®] or Glass Plus[®] work well. Use of Armor All[®], Son-of-a-Gun[®] or similar items is discouraged as these products make the liners slick.

**INSTALLATION INSTRUCTIONS FOR YOUR
TOYOTA 4RUNNER FRONT FLOOR LINERS**

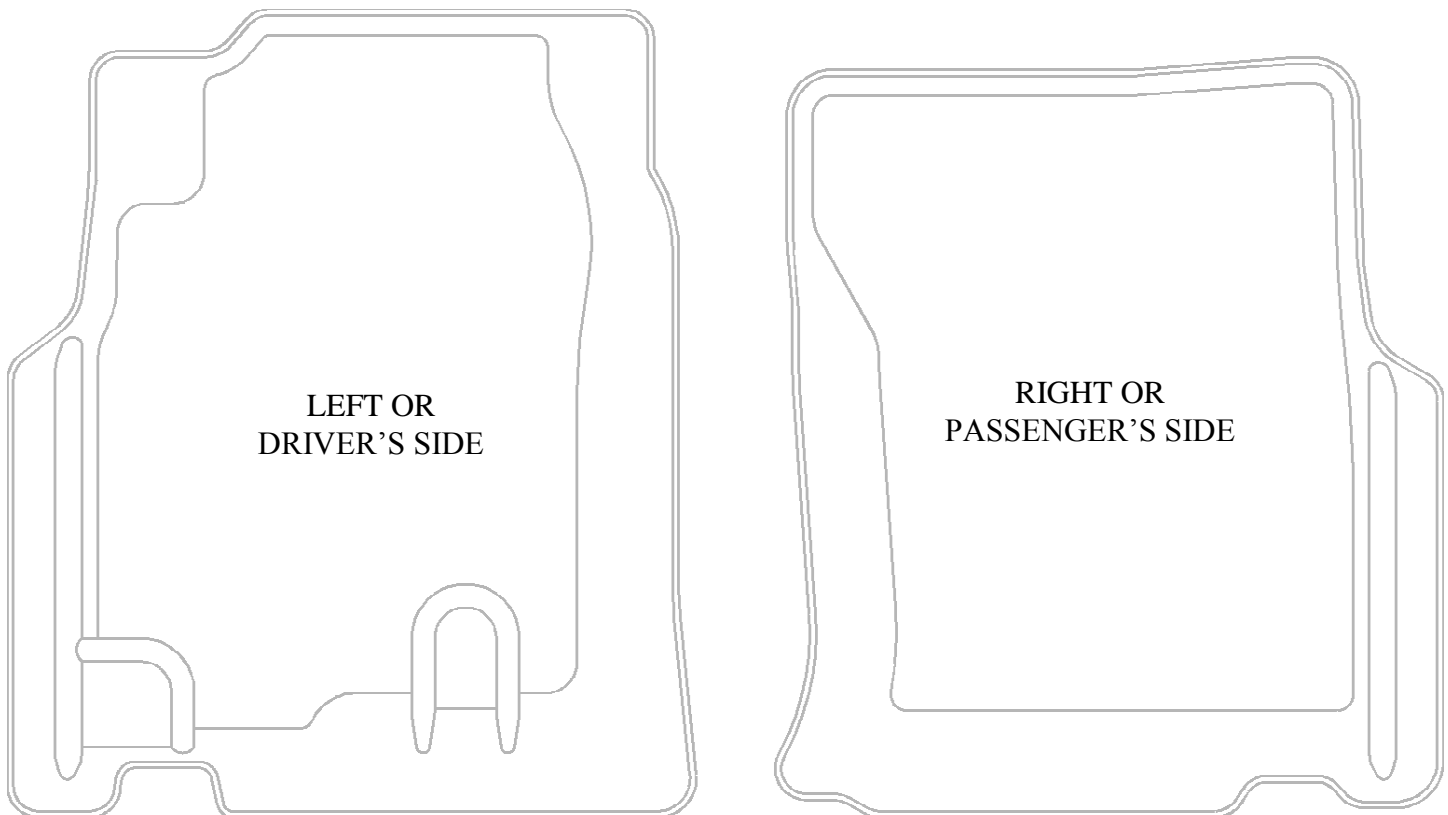

YOUR HUSKY LINERS COME WITH RETAINING CLIPS THAT SECURE YOUR LINER TO THE EXISTING FACTORY CARPET HOOK MOUNTING LOCATIONS. TO INSTALL THESE CLIPS, YOU WILL FIRST NEED TO REMOVE THE FACTORY HOOKS. PLEASE REFER TO THE CLIP INSTALLATION INSTRUCTIONS ON THE BACK OF THIS PAGE FOR FURTHER INFORMATION.

HUSKY FLOOR LINER RETAINING CLIP #1112 INSTALLATION INSTRUCTIONS FOR USE IN VEHICLES WITH REMOVABLE FACTORY MAT HOOKS

YOUR NEW HUSKY® FLOOR LINER SET INCLUDES OUR NEW PATENT PENDING FLOOR LINER RETAINING CLIP SYSTEM. THIS RETAINING CLIP GIVES THE EXTRA SECURITY PROVIDED BY AN OEM STYLE FASTENER WHILE KEEPING SPILLS AND DEBRIS TRAPPED INSIDE THE LINERS. TO INSTALL THE HUSKY® LINER RETAINING CLIPS, SIMPLY FOLLOW THE INSTRUCTIONS BELOW:

- 1) REMOVE THE EXISTING FACTORY MAT HOOK AS SHOWN IN IMAGE 1 AND IMAGE 2 BELOW. MODERATE EFFORT IS REQUIRED TO POP THE FACTORY HOOKS OUT. YOU CAN WATCH A YOUTUBE VIDEO OF THE HOOK REMOVAL BY ACCESSING THIS LINK-- <http://www.youtube.com/watch?v=5P-d BkQ6Uc>.

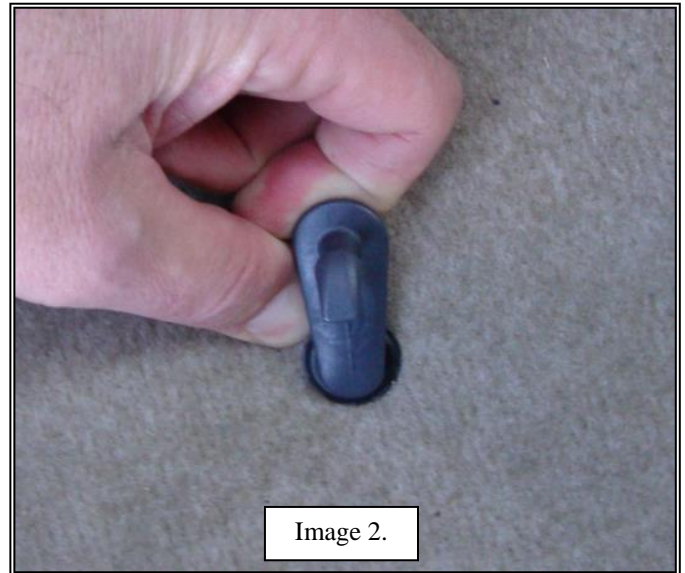

- 2) WITH THE FACTORY CLIPS REMOVED, UNSCREW THE TWO HALVES OF THE HUSKY® RETAINING CLIP AND INSERT THE BOTTOM HALF INTO THE EXISTING FACTORY GROMMETS LOCATION AS SHOWN BELOW IN IMAGE 4 AND IMAGE 5. THE BOTTOM PORTION WILL “SNAP” SECURELY INTO THE FACTORY GROMMET LOCATION. RETAIN THE TOP HALF OF THE CLIP FOR LATER INSTALLATION.

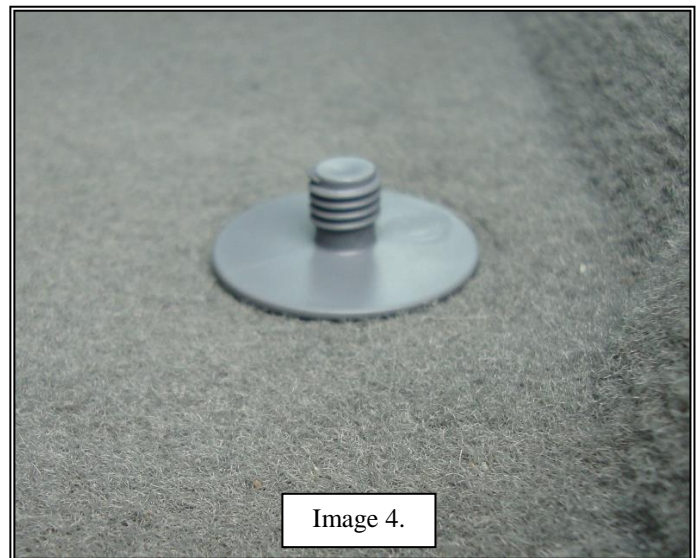
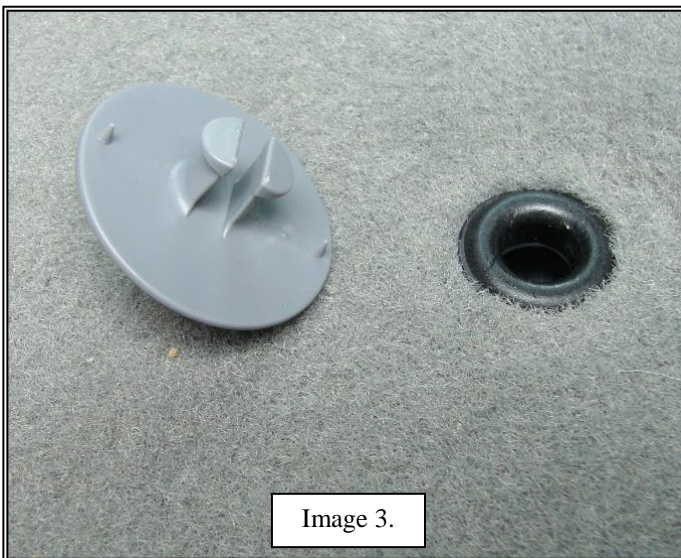

- 3) NOW THAT YOU HAVE THE BOTTOM PORTION OF THE RETAINING CLIPS INSTALLED, PLACE THE LINER IN THE VEHICLE TAKING CARE TO ALIGN THE HOLES IN THE LINER WITH THE THREADED PORTION OF THE BOTTOM RETAINING CLIPS AS SHOWN IN IMAGE 5 BELOW. LASTLY, SCREW THE TOP HALF OF THE RETAINING CLIPS ONTO THE TREADED POST OF THE BOTTOM PORTION, SECURING THE LINER IN PLACE AS SHOWN IN IMAGE 6.



Image 5.

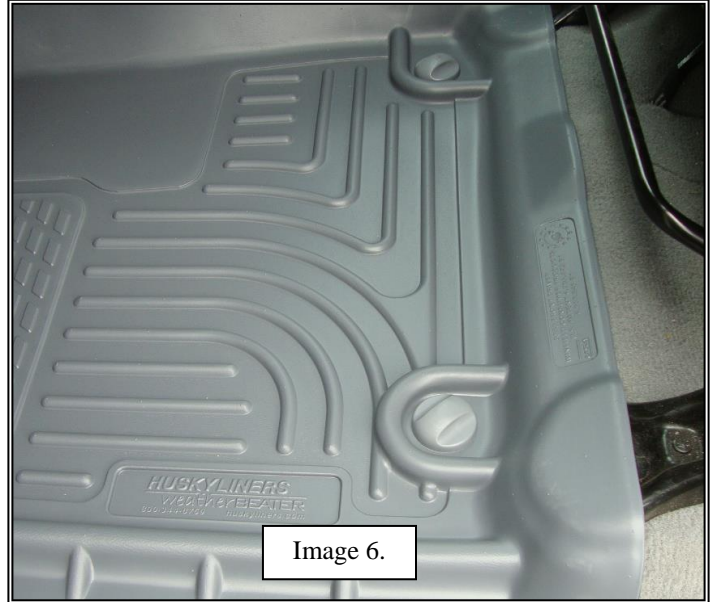

Image 6.

IF YOU HAVE ANY QUESTIONS REGARDING THE INSTALLATION OF YOUR HUSKY® LINER RETAINING CLIPS, JUST GIVE US A CALL MONDAY THROUGH FRIDAY FROM 8:00 AM – 5:00 PM CENTRAL TIME AT 800-344-8759 OR E-MAIL US AT: contactus@huskyliners.com.