



AIRCHARGER®

HIGH-FLOW INTAKE KITS

NOT LEGAL FOR SALE OR USE ON ANY POLLUTION CONTROLLED MOTOR VEHICLE IN CALIFORNIA OR STATES ADOPTING CALIFORNIA EMISSION PROCEDURES.
See knfilters.com for CARB status on each part for a specific vehicle

INSTALLATION INSTRUCTIONS

63-1579

JEEP / DODGE

2018-19 Grand Cherokee Trackhawk

2021 Durango

V8-6.2L Supercharged

TOOLS NEEDED:

Flat blade screw driver
10mm wrench

PARTS LIST:

Description	Qty.	Part #
A HOSE CLAMP; #64, BLACK	2	08645KA
B HOSE; HUMP 4"ID X 3"L	1	08418
C INTAKE TUBE	1	087416
D GROMMET; 3/4" BLACK	1	KITGRMT19
E GROMMET; 1"OD,1/2"ID,1/2"	1	08064
F WASHER; 6MM FLAT, SS	2	08269
G WASHER, M6 SPLIT LOCK ZINC	2	1-3025
H BOLT; M6 X 1.00 X 12MM, SS	2	07727
I HEAT SHIELD	1	073277
J EDGE TRIM (35")	1	102471A
K BLOCK OFF; 77-1567, EPDM	1	21575
L BLOCK OFF;	1	21597
M HOSE CLAMP; #104, BLACK	1	08697KA
N FILTER CHARGER	1	RU-1042
O VENT; 90DEG, 3/4" HOSE	2	A2128-44
P HOSE; 3/4"ID X 15"L	1	5-4015
Q HOSE; 3/4"ID X 2.25"L REIN.	1	08709
R HOSE CLAMP; #16	1	08413
S CABLE TIE; W/FIR TREE	1	KITCABLETIE1
T BLOCK OFF	1	073262

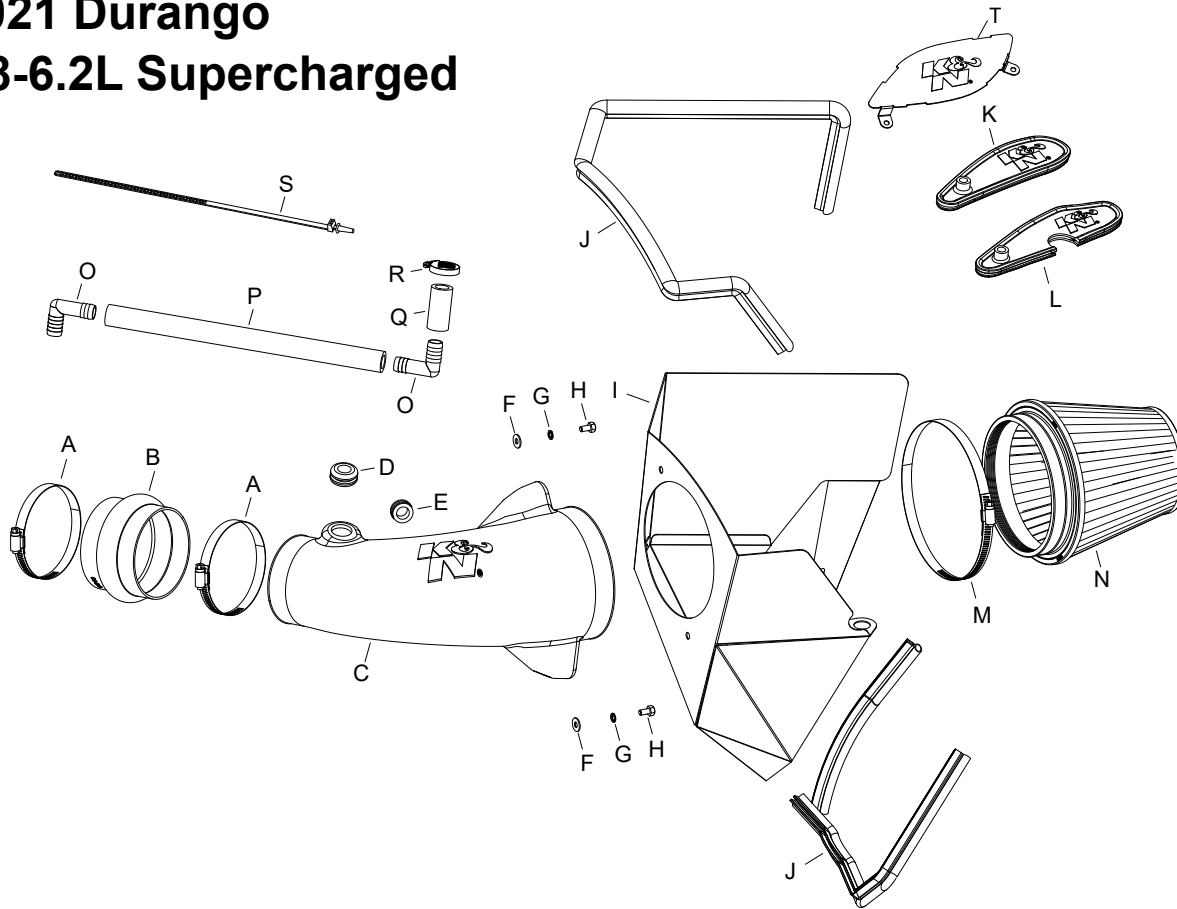

If you need any assistance please call 1-800-858-3333 to speak with a representative in our Customer Service Center before returning the product.

NOTE: FAILURE TO FOLLOW INSTALLATION INSTRUCTIONS AND NOT USING THE PROVIDED HARDWARE MAY DAMAGE THE INTAKE TUBE, THROTTLE BODY AND ENGINE.

TO START:

1. Turn off the ignition and disconnect the negative battery cable.

NOTE: Disconnecting the negative battery cable erases pre-programmed electronic memories. Write down all memory settings before disconnecting the negative battery cable. Some radios will require an anti-theft code to be entered after the battery is reconnected. The anti-theft code is typically supplied with your owner's manual. In the event your vehicles anti-theft code cannot be recovered, contact an authorized dealership to obtain your vehicles anti-theft code.



2. Disconnect the IAT sensor electrical connection. Disconnect the CCV hose from the quick connect fitting.



2a. On later models the CCV hose will connect to a valve on the air filter housing lid, disconnect the CCV hose and electrical connection at the valve.



3. Loosen the hose clamp that secures the factory intake tube to the throttle body.



4. Lift the air filter housing assembly up to release it from the mounting grommets and then remove the complete intake system from the vehicle.

NOTE: K&N Engineering, Inc., recommends that customers do not discard factory air intake.



5. Remove the lower fresh air tray.

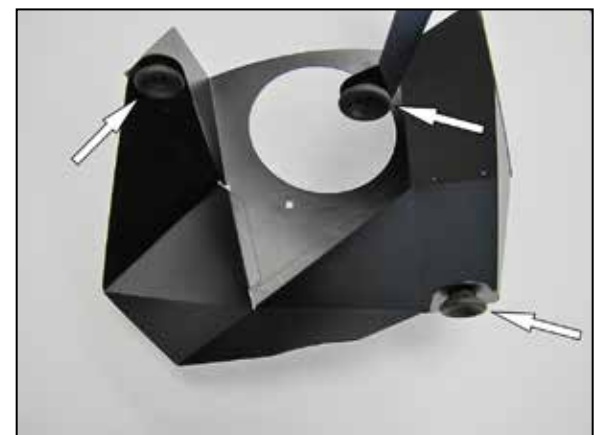

6. Remove the three mounting grommets from the factory air filter housing and install them into the K&N® heat shield as shown.



7. Install the provided edge trim onto the heat shield as shown.

NOTE: Some trimming of the edge trim will be necessary.

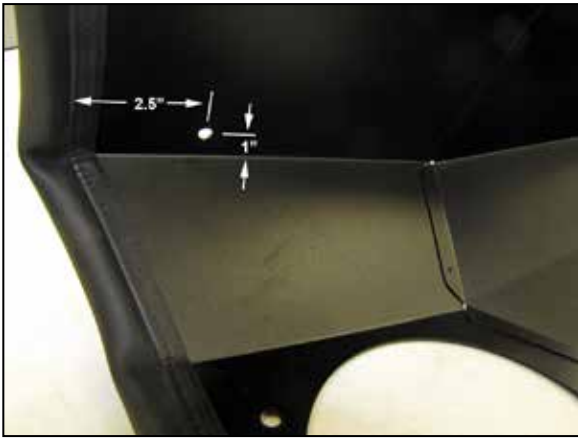

7a. On vehicles equipped with the CCV valve on the air filter housing lid, drill a $\frac{1}{4}$ " id hole 2.5" down from the top of the heat shield and 1.0" from the bend as shown. This hole will be used to secure the CCV valve to the heat shield.



8. Install the heat shield so the mounting grommets engage with the factory mounting studs.



9. Install the provided hump coupler (08418) onto the throttle body and secure with the provided hose clamps.



10. Install the provided grommets into the K&N® intake tube as shown.



11. Remove the IAT sensor and quick connect CCV fitting from the factory intake tube.

NOTE: Use caution while handling the inlet air temperature sensor as it is very fragile.



12. Remove the O-ring from the IAT sensor and then install the sensor into the K&N® intake tube as shown. Install the factory quick connect CCV fitting into the K&N® intake tube as shown.



12a. On vehicles equipped with a CCV valve, install the provided 90deg union fitting into the K&N® intake tube as shown.



13. Install the K&N® intake tube into the heat shield and coupler as shown and secure with the hardware and hose clamp provided.



14. On vehicles not equipped with the CCV valve on the air filter housing lid, Reconnect the CCV quick connect fitting. Reconnect the IAT sensor electrical connection.

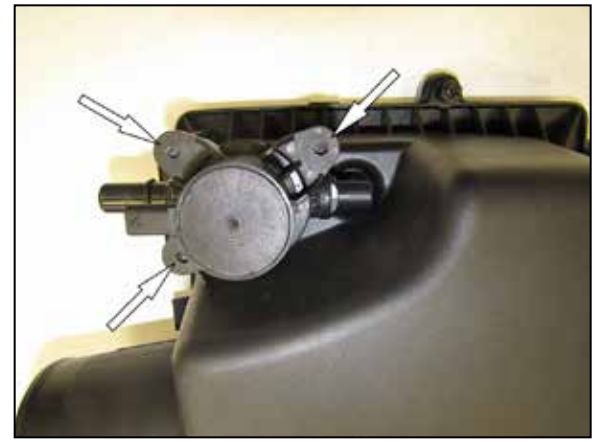

14a. On vehicles equipped with the CCV valve, carefully drill out the center of the plastic weld rivets that secure the valve and then remove the valve from the air filter lid.



14b. remove the O-ring from the valve and then assemble the provided $\frac{3}{4}$ " hoses and 90deg. Union as shown. Secure the hose to the valve with the clamp provided.



14c. Connect the factory CCV connector to the valve, route the $\frac{3}{4}$ " hose to the fitting installed into the intake tube as shown. Using the mounting tree tie wrap, secure the valve to the heat shield.



15. Install the K&N® air filter onto the intake tube and secure with the provided hose clamp.
NOTE: Drycharger® air filter wrap; part # RF-1042DK is available to purchase separately. To learn more about Drycharger® filter wraps or look up color availability please visit <http://www.knfilters.com>®.



16. During wet conditions, install the provided hood vent block off to minimize water intrusion to the intake system. For Dodge vehicles, see step #17.



17. During wet conditions on Dodge vehicles to minimize water intrusion to the intake system, remove the two bolts that secure the heat extraction gill to the hood. Do not remove the grill.



18. Install the provided block off plate and secure with the factory bolts from the previous step.



19. Reconnect the vehicle's negative battery cable. Double check to make sure everything is tight and properly positioned before starting the vehicle.

20. It will be necessary for all K&N® high flow intake systems to be checked periodically for realignment, clearance and tightening of all connections. Failure to follow the above instructions or proper maintenance may void warranty.

ROAD TESTING:

1. Start the engine with the transmission in neutral or park, and the parking brake engaged. Listen for air leaks or odd noises. For air leaks secure hoses and connections. For odd noises, find cause and repair before proceeding. This kit will function identically to the factory system except for being louder and much more responsive.

2. Test drive the vehicle. Listen for odd noises or rattles and fix as necessary.

3. If road test is fine, you can now enjoy the added power and performance from your kit.

4. K&N Engineering, Inc., requires cleaning the intake system's air filter element every 100,000 miles. When used in dusty or off-road environments, our filters will require cleaning more often. We recommend that you visually inspect your filter once every 25,000 miles to determine if the screen is still visible. When the screen is no longer visible some place on the filter element, it is time to clean it. To clean and re-oil, purchase our filter Recharger® service kit, part number 99-5050 or 99-5000 and follow the easy instructions.

NOT LEGAL FOR SALE OR USE ON ANY POLLUTION CONTROLLED MOTOR VEHICLE IN CALIFORNIA OR STATES ADOPTING CALIFORNIA EMISSION PROCEDURES.

See knfilters.com for CARB status on each part for a specific vehicle