



AIRCHARGER®

HIGH-FLOW INTAKE KITS

NOT LEGAL FOR SALE OR USE ON ANY POLLUTION CONTROLLED MOTOR VEHICLE IN CALIFORNIA OR STATES ADOPTING CALIFORNIA EMISSION PROCEDURES.
See knfilters.com for CARB status on each part for a specific vehicle

INSTALLATION INSTRUCTIONS

63-3116
CHEVROLET / GMC
2019-20 Silverado 1500
2019-20 Sierra 1500
V6-4.3L

TOOLS NEEDED:
Flat blade screw driver

PARTS LIST:

Description	Qty.	Part #
A VENT; STRT QUICK DISC.	2	08526
B HOSE CLAMP; #10 MINI	2	08411
C HOSE; 5/8"ID X 15"L	1	5-7015
D VENT; 90°D, 1/4"NPT, TO .600"	1	82633
E HOSE CLAMP #48	1	08601
F HOSE; 3.5" TO 3"ID X 3"L TPRD	1	084055
G HOSE CLAMP; #56	1	08620
H TUBE; FIPK, 63-3116, NM	1	087455
I HOSE CLAMP; #64, STAINLESS	2	08645
J HOSE; HUMP 4"ID X 3"L	1	08418
K AIR FILTER	1	33-5083

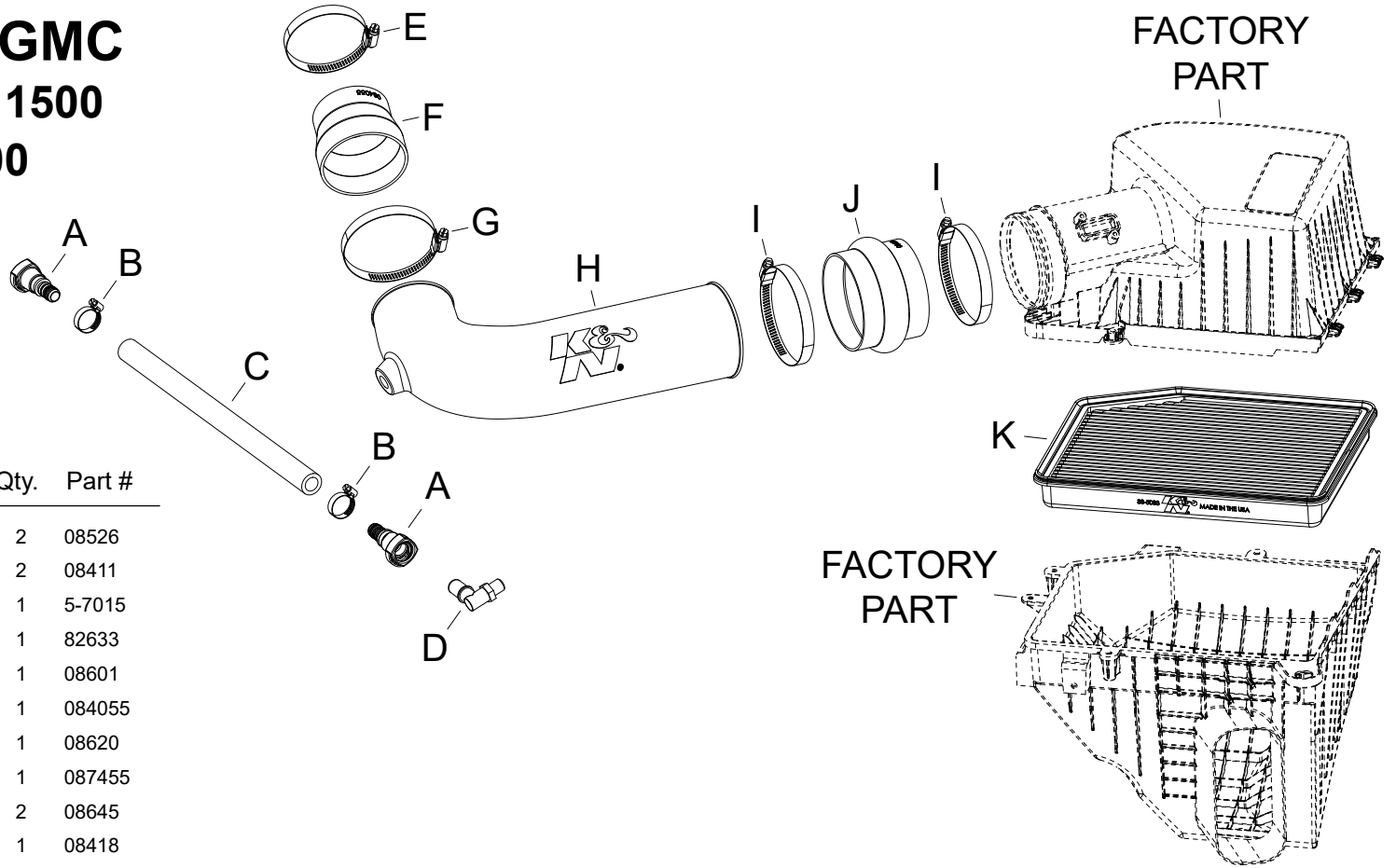

If you need any assistance please call 1-800-858-3333 to speak with a representative in our Customer Service Center before returning the product.

NOTE: FAILURE TO FOLLOW INSTALLATION INSTRUCTIONS AND NOT USING THE PROVIDED HARDWARE MAY DAMAGE THE INTAKE TUBE, THROTTLE BODY AND ENGINE.

TO START:

1. Turn off the ignition and disconnect the negative battery cable.
NOTE: Disconnecting the negative battery cable erases pre-programmed electronic memories. Write down all memory settings before disconnecting the negative battery cable. Some radios will require an anti-theft code to be entered after the battery is reconnected. The anti-theft code is typically supplied with your owner's manual. In the event your vehicles anti-theft code cannot be recovered, contact an authorized dealership to obtain your vehicles anti-theft code.



2. Depress the locking tabs and disconnect the crank case vent line from the intake plenum and valve cover.



3. Loosen the hose clamp that secures the intake tube to the air filter housing.



4. Loosen the hose clamp that secures the intake plenum to the throttle body. Rotate the plenum counter clockwise to unlatch it from the mounting bracket and then remove the plenum from the vehicle.
NOTE: K&N Engineering, Inc., recommends that customers do not discard factory air intake.



5. Remove the upper air filter housing and replace the factory air filter with the provided K&N® air filter and then reinstall the upper housing and secure with the factory hardware.



6. Install the provided hump coupler (08418) onto the air filter housing and secure with the provided hose clamp.



7. Install the provided straight coupler (084055) onto the throttle body and secure with the provided hose clamp.



8. Install the provided 90° vent fitting into the K&N® intake tube as shown.
NOTE: Plastic NPT fittings are easy to cross thread. Install the vent fitting "hand" tight, then turn it two complete turns with a wrench.



9. Install the K&N® intake tube into the coupler at the air filter housing and then into coupler on the throttle body, adjust the tube for best fit and then secure with the provided hose clamps.



10. Assemble the crank case vent hose assembly as shown.



11. Connect the crankcase vent hose assembly to the fitting in the K&N® intake tube and to the valve cover port.



12. Reconnect the vehicle's negative battery cable. Double check to make sure everything is tight and properly positioned before starting the vehicle.

13. **K&N AIR FILTER MONITOR LIGHT:** Some vehicles are equipped with a "Air Filter Monitor" system that will send a message to the instrument cluster indicating that the air filter needs to be replaced. This system is calibrated for the OEM intake system and air filter and will not be accurate when K&N products are in use. Always refer to WWW.KNFILTERS.COM for K&N air filter service procedures. The "Air Filter Monitor" system must be disabled to prevent the monitor from setting on and causing a factory dealership visit to reset the system. Follow the "Air Filter Monitor" system procedure listed in the factory owners manual.

14. It will be necessary for all K&N® high flow intake systems to be checked periodically for realignment, clearance and tightening of all connections. Failure to follow the above instructions or proper maintenance may void warranty.

ROAD TESTING:

1. Start the engine with the transmission in neutral or park, and the parking brake engaged. Listen for air leaks or odd noises. For air leaks secure hoses and connections. For odd noises, find cause and repair before proceeding. This kit will function identically to the factory system except for being louder and much more responsive.

2. Test drive the vehicle. Listen for odd noises or rattles and fix as necessary.

3. If road test is fine, you can now enjoy the added power and performance from your kit.

4. K&N Engineering, Inc., requires cleaning the intake system's air filter element every 100,000 miles. When used in dusty or off-road environments, our filters will require cleaning more often. We recommend that you visually inspect your filter once every 25,000 miles to determine if the screen is still visible. When the screen is no longer visible some place on the filter element, it is time to clean it. To clean and re-oil, purchase our filter Recharger® service kit, part number 99-5050 or 99-5000 and follow the easy instructions.

NOT LEGAL FOR SALE OR USE ON ANY POLLUTION CONTROLLED MOTOR VEHICLE IN CALIFORNIA OR STATES ADOPTING CALIFORNIA EMISSION PROCEDURES.

See knfilters.com for CARB status on each part for a specific vehicle