



NOT LEGAL FOR SALE OR USE ON ANY POLLUTION CONTROLLED MOTOR VEHICLE IN CALIFORNIA OR STATES ADOPTING CALIFORNIA EMISSION PROCEDURES.  
See knfilters.com for CARB status on each part for a specific vehicle

## INSTALLATION INSTRUCTIONS

**77-2593KC**  
**FORD**  
**2020-22 F-250**  
**2020-21 F-350**  
**V8-6.2L**

### TOOLS NEEDED:

Ratchet  
Extension  
13mm socket  
4mm allen key  
1/2" wrench  
Flat blade screw driver  
Side cutters  
Pliers

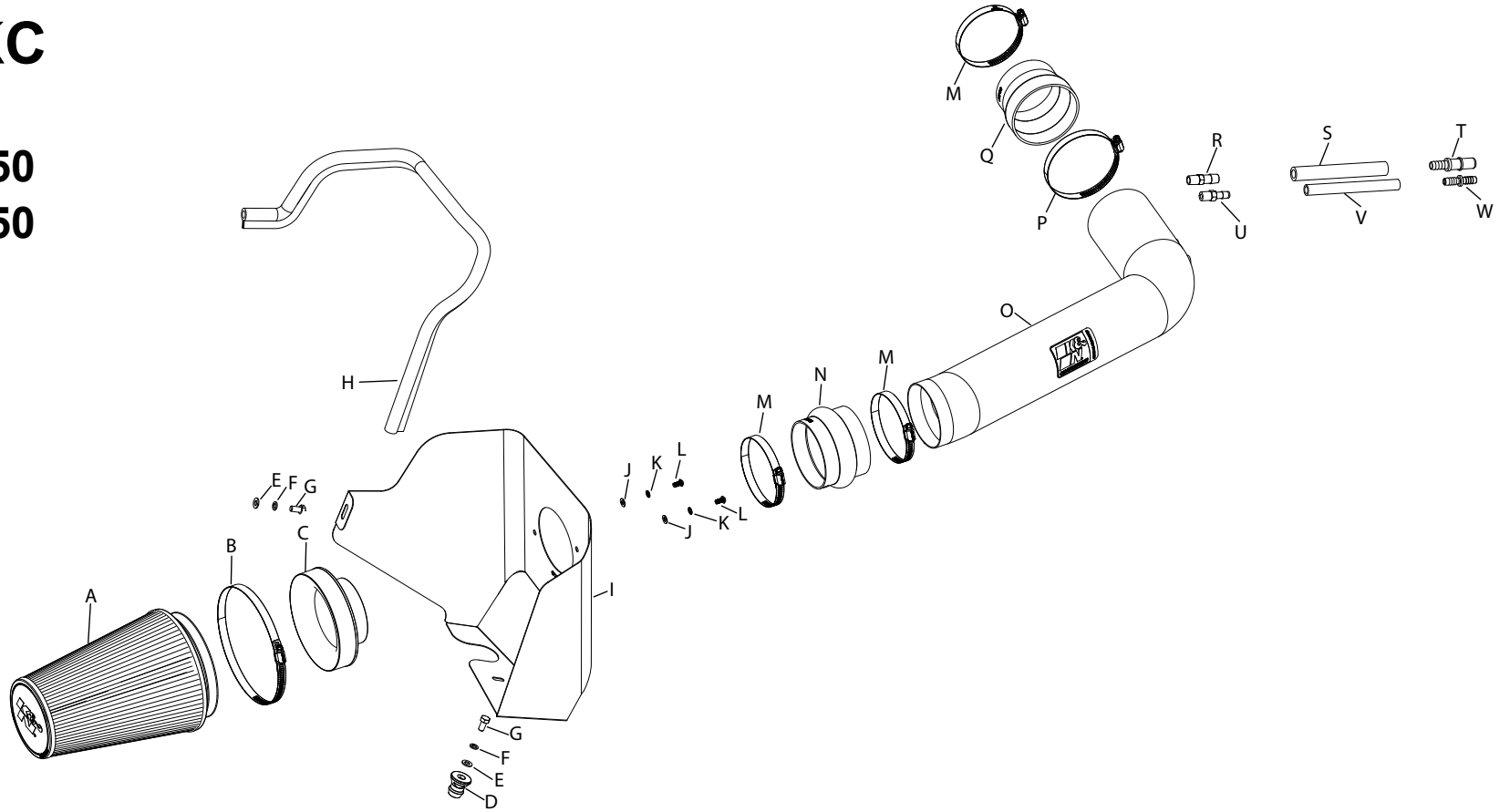

### PARTS LIST:

Description	Qty.	Part #	Description	Qty.	Part #	Description	Qty.	Part #
A AIR FILTER	1	RU-3280	I HEAT SHIELD	1	073314	Q HOSE; 4"ID TO 3.5"ID X 3"L	1	08497
B HOSE CLAMP #104	1	08697	J WASHER; 6MM FLAT	2	08269	R VENT; 3/8"HOSE, 1/4"NPT	1	08047
C ADAPTOR #454	1	27300	K WASHER; M6 SPLIT LOCK	2	1-3025	S HOSE; 1/2"ID X 6"L	1	5-5006
D HEAT SHIELD MOUNT	1	088078	L BOLT; M6 X 1 X 16MM BTNHHD	2	07730	T FITTING; VENT, 1/2" BARB	1	82629
E WASHER; 8MM FLAT	2	08272	M HOSE CLAMP #64 STAINLESS	3	08645	U VENT; 1/2"HOSE, 1/4"NPT	1	080022
F WASHER M8 SPLIT LOCK	2	1-3036	N HOSE; HUMP 4"ID X 3"L	1	08418	V HOSE; 3/8"ID X 6"L	1	5-1006
G BOLT; 8MM-1.25 X 16MM HEX	2	07844	O INTAKE TUBE; (AL)	1	25843C	W VENT; 3/8"HOSE	1	08041
H EDGE TRIM; 35"L	1	102471	P HOSE CLAMP #56	1	08620			

**If you need any assistance please call 1-800-858-3333 to speak with a representative in our Customer Service Center before returning the product.**

**NOTE: FAILURE TO FOLLOW INSTALLATION INSTRUCTIONS AND NOT USING THE PROVIDED HARDWARE MAY DAMAGE THE INTAKE TUBE, THROTTLE BODY AND ENGINE.**

### TO START:

1. Turn off the ignition and disconnect the negative battery cable.  
**NOTE: Disconnecting the negative battery cable erases pre-programmed electronic memories. Write down all memory settings before disconnecting the negative battery cable. Some radios will require an anti-theft code to be entered after the battery is reconnected. The anti-theft code is typically supplied with your owner's manual. In the event your vehicles anti-theft code cannot be recovered, contact an authorized dealership to obtain your vehicles anti-theft code.**



2. Loosen the hose clamp that secures the factory intake hose to the air filter housing.



3. Disconnect the vent lines from the intake plenum.



4. Unhook the vent line holder from the intake plenum.



5. Loosen the hose clamp that secures the intake plenum to the throttle body.



6. Lift the intake plenum up to dislodge it from the mounting grommets and then remove it from the vehicle.



7. Remove the push-pin that secures the fresh air duct and then remove the fresh air duct from the vehicle.



8. Release the three clips that secure the air filter lid and then remove the lid and factory air filter.



9. Pull the lower air filter housing up to dislodge it from the mounting grommets and then remove it from the vehicle.



10. Remove the two bolts that secure the air filter housing mounting bracket to the inner fender and then remove the bracket from the vehicle.



11. Install the provided edge trim onto the heat shield as shown. **NOTE: Some trimming will be necessary.**



12. Install the filter adapter into the heat shield and secure with the provided hardware.



13. Install the mounting post onto the heat shield using the provided hardware.



14. Install the heat shield so the mounting stud inserts into the mounting grommet and then secure to the inner fender with the provided hardware.



15. Install the provided hump coupler onto the filter adapter and secure with the provided hose clamp.



16. Install the straight coupler onto the throttle body and secure with the provided hose clamp.



17. Install the provided vent hoses and fittings onto the K&N intake tube as shown.



18. Install the K&N intake tube into the hump coupler and then into the straight coupler, adjust for best fit and then secure with the provided hose clamps.



19. Connect the factory vent hoses to the hoses and fittings attached to the K&N intake tube.



20. Install the K&N air filter onto the filter adapter and secure with the provided hose clamp.



21. Reinstall the fresh air duct and secure with the factory push pin.



22. Reconnect the vehicle's negative battery cable. Double check to make sure everything is tight and properly positioned before starting the vehicle.

23. It will be necessary for all K&N® high flow intake systems to be checked periodically for realignment, clearance and tightening of all connections. Failure to follow the above instructions or proper maintenance may void warranty.

#### ROAD TESTING:

1. Start the engine with the transmission in neutral or park, and the parking brake engaged. Listen for air leaks or odd noises. For air leaks secure hoses and connections. For odd noises, find cause and repair before proceeding. This kit will function identically to the factory system except for being louder and much more responsive.

2. Test drive the vehicle. Listen for odd noises or rattles and fix as necessary.

3. If road test is fine, you can now enjoy the added power and performance from your kit.

4. K&N Engineering, Inc., requires cleaning the intake system's air filter element every 100,000 miles. When used in dusty or off-road environments, our filters will require cleaning more often. We recommend that you visually inspect your filter once every 25,000 miles to determine if the screen is still visible. When the screen is no longer visible some place on the filter element, it is time to clean it. To clean and re-oil, purchase our filter Recharger® service kit, part number 99-5050 or 99-5000 and follow the easy instructions.

**NOT LEGAL FOR SALE OR USE ON ANY POLLUTION CONTROLLED MOTOR VEHICLE IN CALIFORNIA OR STATES ADOPTING CALIFORNIA EMISSION PROCEDURES.**

See [knfilters.com](http://knfilters.com) for CARB status on each part for a specific vehicle