



INTAKE SYSTEMS FOR VEHICLES LISTED ARE 50 STATE LEGAL. SEE KNFILTERS.COM FOR CARB STATUS ON EACH PART FOR A SPECIFIC VEHICLE.

INSTALLATION INSTRUCTIONS

77-9016KP
TOYOTA
2000-04 Tacoma
L4-2.4L / 2.7L
2000 4Runner
L4-2.7L

NOTE: This kit was not designed to fit vehicles with a body lift.

TOOLS NEEDED:

- Ratchet
- Extension
- 10mm Socket
- 12mm Socket
- 13mm Socket
- Flat Blade Screwdriver
- 10mm Wrench
- 12mm Wrench
- 9/64" Allen Wrench

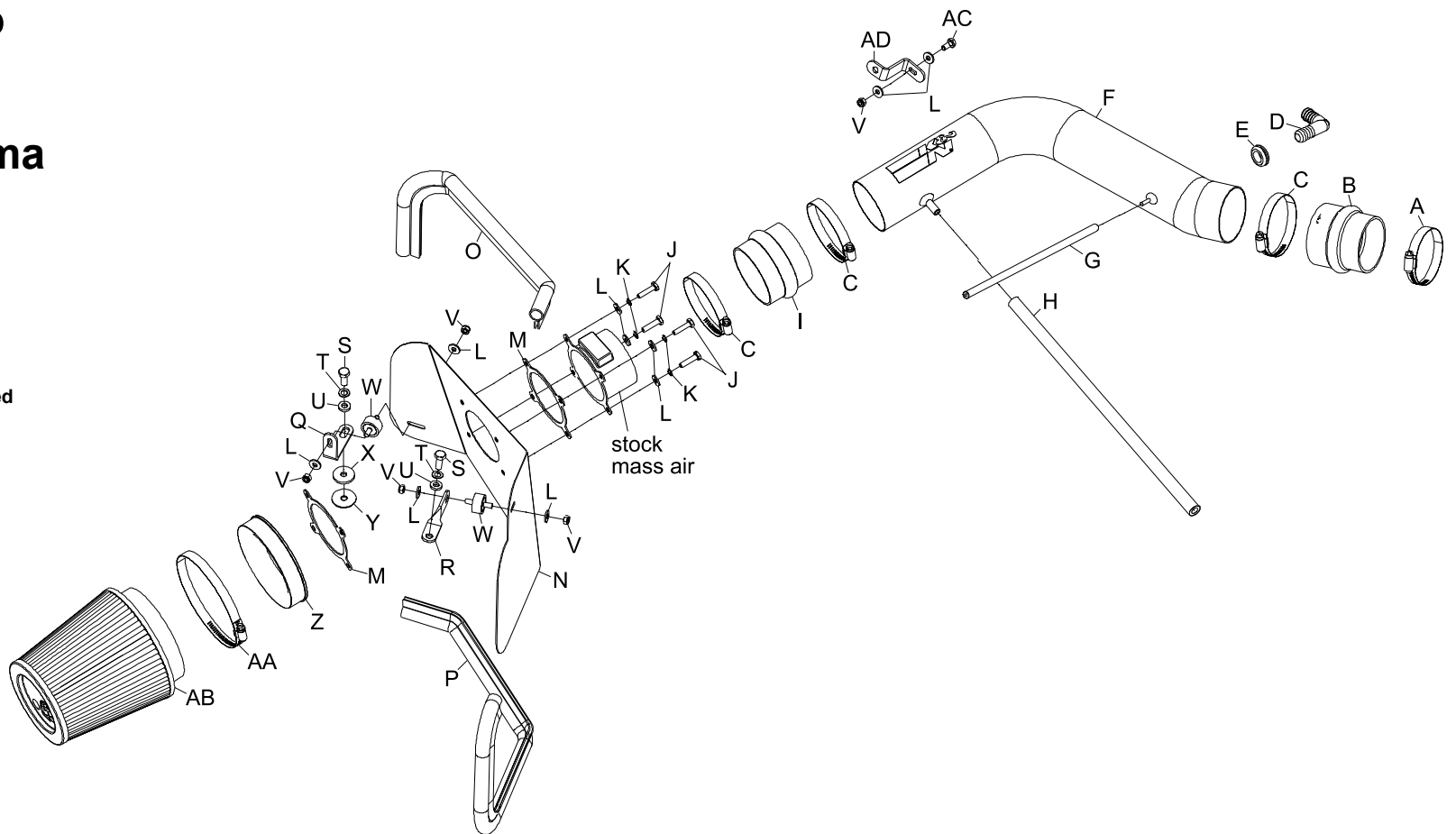

PARTS LIST:

Description	Qty.	Part #	Description	Qty.	Part #	Description	Qty.	Part #
A HOSE CLAMP; #44 STAINLESS	1	08560	K WASHER; 1/4" LOCK	4	08198	U WASHER; 5/16"ID X 5/8"OD	2	08276
B HOSE; HUMP 3" TO 2.75" X 3"L	1	08421	L WASHER; 1/4"ID X 5/8"OD	10	08275	V NUT; 6MM NYLOCK	5	07553
C HOSE CLAMP; #48	3	08601	M GASKET; 1/16" NEOPRENE	2	09040	W STUD; M6-1.00 RUBBER	2	07027
D VENT; 90DEG, 5/8"HOSE	1	08072	N HEAT SHIELD	1	07448	X WASHER; 5/16 X 1.25" FENDER	1	08130
E GROMMET; 1-1/8"OD, 5/8"ID	1	080601	O EDGE TRIM; 20"L	1	102494A	Y WASHER; 1.25 X .30 X .10	1	21708
F INTAKE TUBE; (BRIGHT)	1	27177AKP	P EDGE TRIM; 26"L	1	102488	Z ADAPTOR; #230	1	08781A
G HOSE; 4MM ID X 12"L	1	08147	Q BRACKET; "L" SM.	1	26607A	AA HOSE CLAMP; #88	1	KITHS88
H HOSE; 3/8"ID X 17"L	1	08404	R BRACKET	1	26606A	AB AIR FILTER	1	RU-1037
I HOSE; HUMP 3"ID X 3"L	1	08696	S BOLT; 8MM-1.25 X 20MM	2	07787	AC BOLT; M6-1.00 X 16MM	1	07703
J BOLT; M6-1 X 20MM	4	07865	T WASHER; 8MM SPRING	2	08239	AD BRACKET; "Z" SHORT	1	07958

NOTE: FAILURE TO FOLLOW INSTALLATION INSTRUCTIONS AND NOT USING THE PROVIDED HARDWARE MAY DAMAGE THE INTAKE TUBE, THROTTLE BODY AND ENGINE.

TO START:

1. Turn off the ignition and disconnect the negative battery cable.
NOTE: Disconnecting the negative battery cable erases pre-programmed electronic memories. Write down all memory settings before disconnecting the negative battery cable. Some radios will require an anti-theft code to be entered after the battery is reconnected. The anti-theft code is typically supplied with your owner's manual. In the event your vehicles' anti-theft code cannot be recovered, contact an authorized dealership to obtain your vehicles anti-theft code.



2. Disconnect the mass air sensor electrical connection.



3. Loosen the two hose clamps on the intake hose and remove the intake hose as shown.



4. Loosen the three bolts that secure the air cleaner assembly, then remove the complete assembly as shown.

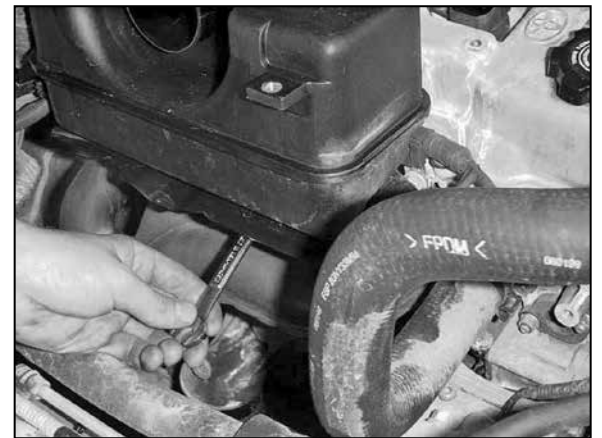

5. Loosen and remove the two nuts that secure the resonator.



6. Vehicles equipped with an idle air vent line, disconnect vent line as shown.

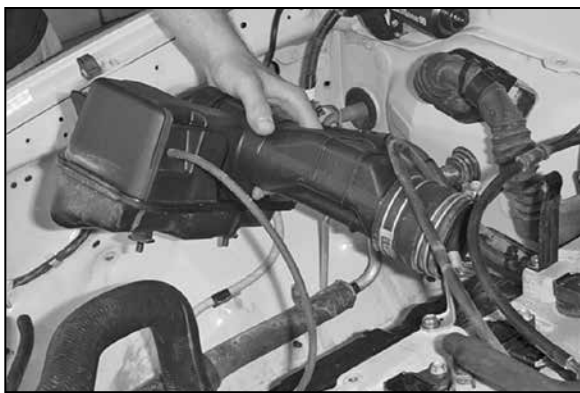

7. Loosen the hose clamp at the throttle body and remove the remaining section of the intake assembly.

NOTE: K&N Engineering, Inc., recommends that customers do not discard factory air intake.



8. Unhook the throttle cable from the hold down bracket and remove the bracket mounting bolt and bracket from the engine as shown.

NOTE: The mounting bolt will be reused.

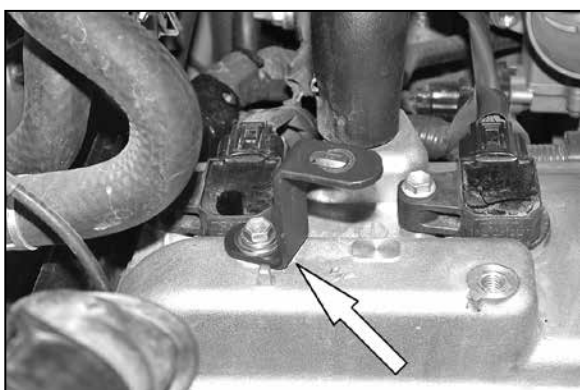

9. Install the "Z" bracket onto the engine using the throttle cable bracket mounting bolt removed in step #8 as shown.

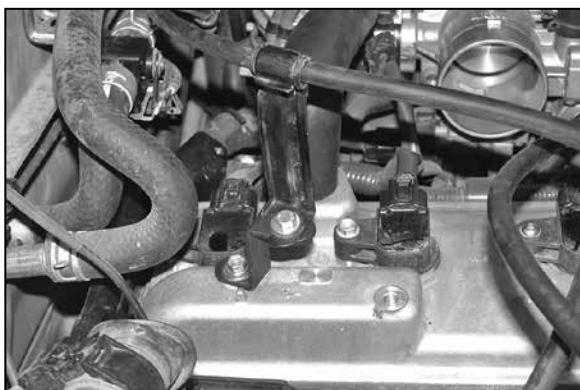

10. Install the throttle cable bracket onto the "Z" bracket installed in step #9 with the provided hardware and reattach the throttle cable to the mounting bracket as shown.



11. Loosen and remove the four hex nuts that secure the mass air sensor to the air cleaner assembly then remove the mass air sensor as shown.

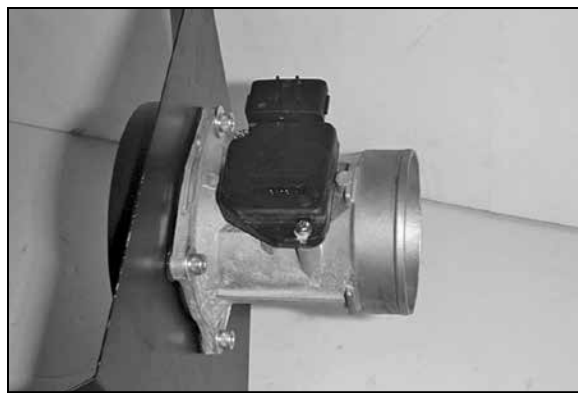

12. Assemble the mass air adapter, heat shield, gaskets and the mass air sensor using the hardware provided.



13. Assemble the rubber bumper stud onto the "L" bracket with the provided hardware as shown.

NOTE: Do not tighten completely.

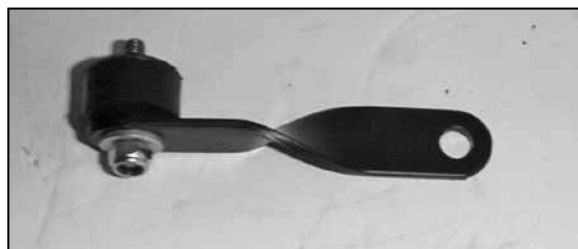

14. Assemble the rubber bumper stud onto the twist bracket with the provided hardware as shown.

NOTE: Do not tighten completely.



15. Install the twist bracket and the "L" bracket assembly onto the heat shield assembly with the provided hardware. Also install the trim seal onto the heat shield as shown.

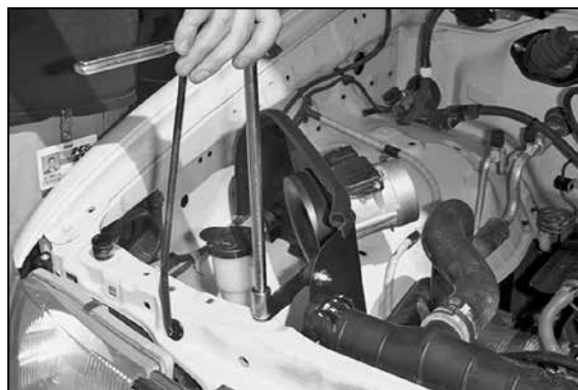

16. Install the heat shield assembly into the vehicle and secure it to the original air box mounting location as shown. Do not tighten completely.

NOTE: The fender washer and the rubber washer should be mounted between the fender and the "L" bracket.



17. Secure the hump hose #08696 to the mass air sensor end of the tube and hump hose #08421 to the throttle body end of the tube as shown with the hose clamps provided.



18. Install the intake tube onto the throttle body, then install onto the mass air sensor.

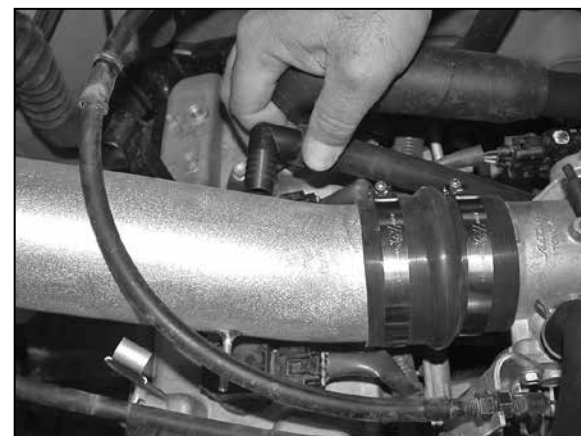

19. Vehicles equipped with an idle air vent line, install the 90 deg. fitting into vent line then mark the intake tube where the fitting lines up with tube.

NOTE: Vehicles that are not equipped with an idle air vent, continue on to step 23.



20. After marking the intake tube, remove from vehicle and drill a 7/8" hole into the intake tube then install the provided grommet as shown.



21. Install the 90 degree fitting into the intake tube as shown.



22. Vehicles equipped with the idle air vent line, reconnect vent line as shown.

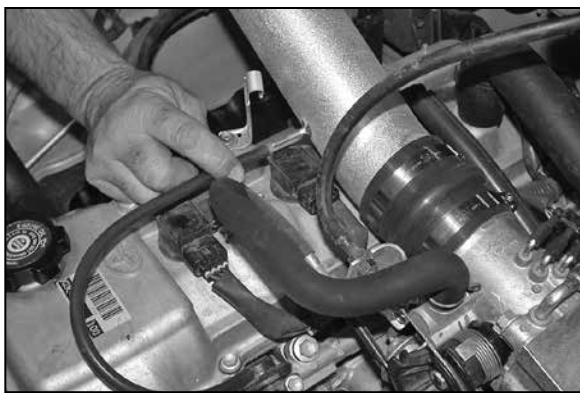

23. Install the provided silicone hose onto the fuel pressure regulator and connect the other end to the K&N® intake tube as shown.



24. Install the provided silicone hose onto the EVAP canister vent and secure the other end onto the K&N® intake tube as shown.



25. Install the K&N® air filter onto the mass air adapter and secure with the provided hose clamp as shown.

NOTE: Drycharger® air filter wrap; part # RF-1037DK is available to purchase separately. To learn more about Drycharger® filter wraps or look up color availability please visit <http://www.knfilters.com>®.



26. Reconnect the mass air sensor electrical connection.



27. Reconnect the vehicle's negative battery cable. Double check to make sure everything is tight and properly positioned before starting the vehicle.

28. The C.A.R.B. exemption sticker, (attached), must be visible under the hood so that an emissions inspector can see it when the vehicle is required to be tested for emissions. California requires testing every two years, other states may vary.

29. It will be necessary for all K&N® high flow intake systems to be checked periodically for realignment, clearance and tightening of all connections. Failure to follow the above instructions or proper maintenance may void warranty.

ROAD TESTING:

1. Start the engine with the transmission in neutral or park, and the parking brake engaged. Listen for air leaks or odd noises. For air leaks secure hoses and connections. For odd noises, find cause and repair before proceeding. This kit will function identically to the factory system except for being louder and much more responsive.

2. Test drive the vehicle. Listen for odd noises or rattles and fix as necessary.

3. If road test is fine, you can now enjoy the added power and performance from your kit.

4. K&N Engineering, Inc., requires cleaning the intake system's air filter element every 100,000 miles. When used in dusty or off-road environments, our filters will require cleaning more often. We recommend that you visually inspect your filter once every 25,000 miles to determine if the screen is still visible. When the screen is no longer visible some place on the filter element, it is time to clean it. To clean and re-oil, purchase our filter Recharger® service kit, part number 99-5050 or 99-5000 and follow the easy instructions.

INTAKE SYSTEMS FOR VEHICLES LISTED ARE 50 STATE LEGAL. SEE KNFILTERS.COM FOR CARB STATUS ON EACH PART FOR A SPECIFIC VEHICLE.