

On Super Cabs use the lower center hole on the rocker for the rear bracket location.
For the pinch weld on the rear bracket location use the one of the slots as a guide to drill a 5/16" hole in the center of the pinch weld.

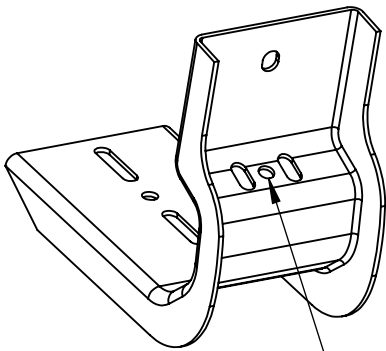

For the front bracket pinch weld location (M-1114) drill a 5/16" hole in the bracket between the two slots at the pinch weld location. (All models).