



Interceptor™

Thank you for purchasing one of the many quality items manufactured by Lund Industries, Inc. We take the utmost pride in our products and want you to enjoy years of satisfaction from your investment.

This product has been designed and engineered to correctly fit and complement your vehicle.

Package Contains:

Shield and hardware pack. (4 brackets, 8 wafer head machine screws, 4 rubber grommets, and 8 lock-nuts)

Tools needed:

Drill, 1/4" drill bit, phillips screwdriver, 3/8" wrench, tape measure, felt tip pen or marker.

(DO NOT USE POWER SCREWDRIVER)

Installation Instructions

Please read carefully and completely before starting.

Part A. Preparations to install shield.

1. Clean hood of vehicle using hot soapy water, rinse and dry thoroughly.

Part B. Shield installation.

1. Attach brackets to shield at each mount location with a pan head machine screw and lock-nut.

Important: Longer brackets go to the inside of shield, shorter ones go to the outside.

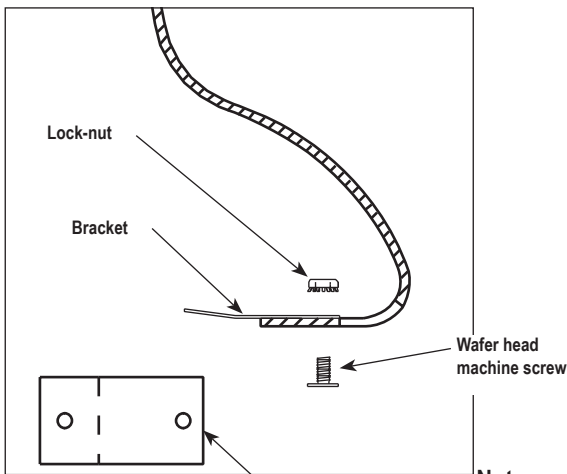

assure proper alignment, you may find it helpful to have assistance with step 2.

Note: Important: Fasten this slot to shield.

2. Position the shield and bracket assembly on the vehicle so that the brackets are against the underside of the hood and the shield is resting against the bumpers. The shield should be centered with equal clearance on both sides of hood. The bottom edge of the shield where the bracket is attached should be approximately 1/8" from the front edge of the hood. Mark the mount locations on the underside of the hood.

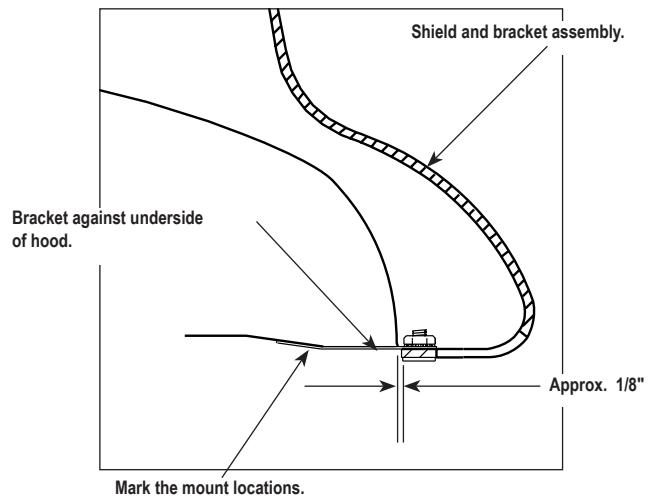

3. Remove shield from the vehicle and drill the marked mount locations. Use a 1/4" dia. drill bit.

Caution: Drill through the inside panel only.

4. Position the shield and bracket assembly back on the vehicle. Fasten the bracket to the hood and tighten firmly in place with the truss head machine screws and lock-nuts provided (see diagram below).

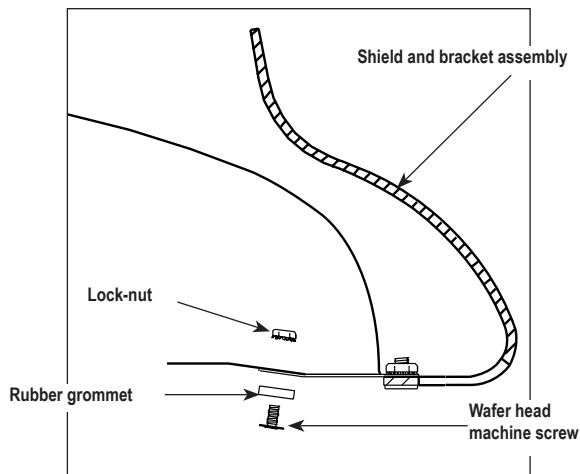

Caution: Carefully close hood after the shield has been installed. If the clearance is too tight between the shield and grill, hood and/or grill adjustment may be required. Consult your owners manual or your dealer concerning hood grill adjustments.

Care & Cleaning

1. Avoid the use of automatic "brush-style" car washes.
2. Do not use cleaning solvents of any kind.
3. To wash, use only a mild soap and dry with a clean cloth or sponge.
4. Do not pull on shield to close hood.

If painting of the shield is desired:

CHECK FIT BEFORE PAINTING. LUND WILL NOT WARRANT PAINTING ON MISFITTING SHIELDS

1. Prep shield by cleaning with mild soap and water, rinse and dry thoroughly.
DO NOT USE ANY SOLVENTS TO PREP SHIELD!
2. Use only an Acrylic Based Enamel.
3. Apply several light coats of paint as opposed to one thick coat.
4. Let dry for 24 hours.