

INSTALLATION INSTRUCTIONS AND PARTS LIST

MODEL 415114, GRIP STEPS (BOARDS ONLY)

UNIVERSAL APPLICATIONS

1. Read instructions completely and check to make sure that all required parts (listed on the service parts list) are on hand before starting the installation.
2. Follow the instructions included with the specific bracket package to mount the brackets to your vehicle.
3. Step assembly:
 - 3.1 This Board can be modified from its original length to fit many applications. Simply determine how long you will need the board, and cut to that length using a saber saw, chop saw, or hack saw. Use flat black paint to touch up the ends that were cut.
 - 3.2 Before attaching the grip steps to the brackets, slide the appropriate number of support braces (item #2) into the channel of the step (item #1).
 - 3.3 Slide the end cap (item #3) over the front and rear of each step. Using the supplied #8 x 1/2" self drilling tek screw (item #8), screw the end cap to the bottom of the step.
4. Attaching the step to the mounting bracket:
 - 4.1 Set the step on the mounting brackets, and slide each support brace over the top of each mounting bracket. Attach the flat spacer plate (item #4) to the bottom of the step, between the support brace, and the top of the mounting bracket.
 - 4.2 Using the supplied 5/16-18 x 1" carriage bolt, washer, and flange nuts, (item #5, 6, 7), attach the step assembly, flat spacer plate and mounting bracket. **(NOTE: Some of the flange nuts are supplied in the specific bracket package, not the step package.)**
 - 4.3 Set the step plate in the correct position and tighten all fasteners.
Torque all fasteners to 19 LB FT.

SERVICE PARTS LIST

ITEM	PART NO.	QTY	DESCRIPTION
1	551888	2	EXTRUSION-AL,97.87,GRIP STEP,BLK,415098
1	551889	2	EXTRUSION-AL,101.25,GRIP STEP,BLK,415102
1	551388	2	EXTRUSION-AL,113.62,GRIP STEP,BLK,415114
2	551296	10	SUPPORT BRACE, UPPER, GALV.
3	551394	4	CAP-END,GRIP STEP, BLACK, PLASTIC
4	551298	14	SPACER PLATE, LOWER, BLACK
5	108683	20	BOLT-CRG,5/16-18 X 1.0", SST
6	101369	20	WASHER-FLAT,5/16,SST
7	102680	20	NUT-SERR FLG,HX,SST,WX,5/16-18
8	107958	8	SCR-TEK #8-18 X 1/2",SST,BLK



1200 E. Birch St.

Brandon, SD 57005

REV C 01APR12

REV B 03DEC10

REV A 10JUL09

551391 SHEET 1 OF 2 01JUN09

SERVICE PARTS LIST

MODEL NO. - 415098
 415102
 415114

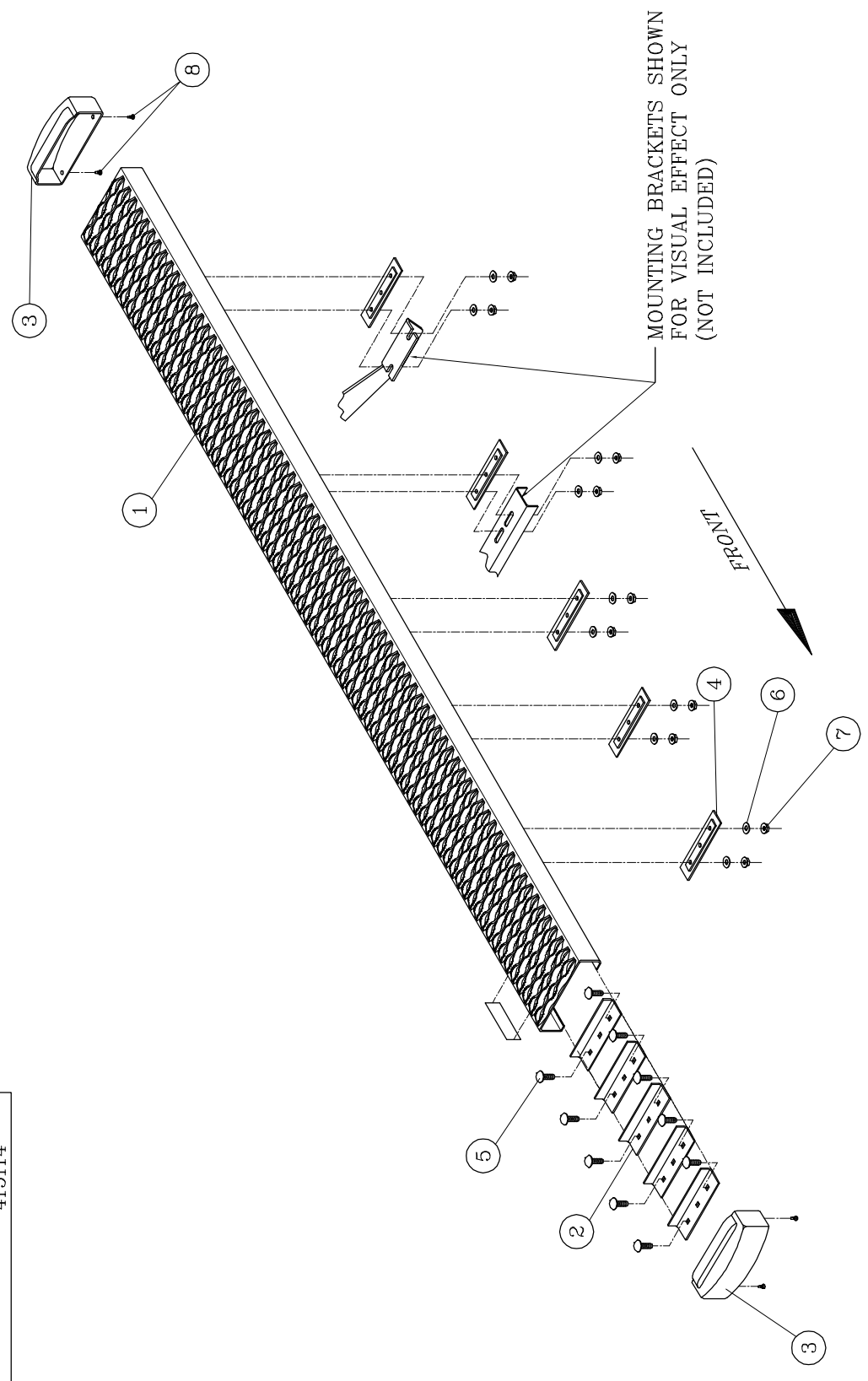

LOVERNE
 TELESCOPE & TELESCOPE UNIT
 (A LOVERNE Company)
 1200 E. Birch St. Brandon, SD 57005

REV C 01APR12
 REV B 03DEC10
 REV A 10JUL09
 SHEET 2 01JUN09

551391

INSTALLATION INSTRUCTIONS AND PARTS LIST

APPLICATION:

MODEL 401037 WHEEL TO WHEEL STEP BRACKETS:
2010 DODGE RAM 2500/3500 REGULAR/CREW/MEGA CAB PICKUPS



1. READ INSTRUCTIONS COMPLETELY AND CHECK TO MAKE SURE THAT ALL REQUIRED PARTS (LISTED ON THE SERVICE PARTS LIST) ARE ON HAND BEFORE STARTING THE INSTALLATION.
2. ATTACH THE MOUNTING BRACKETS TO THE VEHICLE AS FOLLOWS: [SEE FIG. 1]
 - 2.1 ON THE VERTICAL WALL OF THE ROCKER PANEL, INSTALL THE T-BOLT WELMENT (ITEM #2) INTO THE LARGE OBOUNDED HOLE AND FISH THE OTHER END THROUGH THE FORWARD 1/2" HEXAGON HOLE **BE CAREFULL NOT TO DROP THE T-BOLT INSIDE OF THE ROCKER PANEL.** ATTACH THE FLAT NYLON WASHER (ITEM #4) TO THE THREADED END OF EACH BOLT. (THIS IS TO BE USED AS A RETAINER.)
 - 2.2 POSITION THE MOUNTING BRACKET (ITEM #1) SO THAT THE HOLES IN THE BRACKETS LINE UP WITH THE THREADED STUDS ON THE INSIDE WALL OF THE ROCKER PANEL. INSTALL THE 3/8-16 SERRATED FLANGE NUTS (ITEM #3). TIGHTEN BRACKET FASTENERS TO 19 LB FT.
 - 2.3 ASSEMBLE THE DOUBLE ENDED STUD & FASTENERS TO THE BRACKETS AS FOLLOWS:
 - 2.4 INSTALL 3/8" SERRATED FLANGE NUTS (ITEM #3) BACKWARDS, TO THE END OF THE THREAD, ON EACH END OF THE DOUBLE ENDED STUD (ITEM #6).
 - 2.5 ON (1) THREADED END OF THE STUD, INSTALL A 3/8" FLAT WASHER (ITEM #7) AND THEN PUSH THE 3/4" THICK RUBBER WASHER (ITEM #5) AND FLAT WASHER TIGHT UP AGAINST THE SERRATED FLANGE NUT. **(THE END OF THE DOUBLE ENDED STUD SHOULD BE RECESSED BACK IN THE HOLE OF THE RUBBER WASHER APPROXIMATELY 3/16").**
 - 2.6 INSTALL THE SECOND THREADED END OF THE STUD ASSEMBLY THRU THE HOLE IN THE BRACKET (ITEM# 1) AS SHOWN AND INSTALL A 3/8" SERRATED FLANGE NUT. (FINGER TIGHT ONLY).
 - 2.7 POSITION SNUG AGAINST FRAME RAIL AND TIGHT ALL FASTENERS. THIS WILL REINFORCE THE STEP.
3. ATTACH THE MOUNTING BRACKETS TO THE BOX OF THE VEHICLE AS FOLLOWS (SEE FIG. 1)
 - 3.1. ATTACH THE UPPER MOUNTING BRACKET (ITEM#8) TO THE TOP OF THE SPRING SHACKLE USING THE 1/2" HOLE LOCATED ON THE TOP OF THE SPRING MOUNT. PLACE 1/2-13 BOLT AND WASHER (ITEM# 9&10) THROUGH THE BRACKET AND SPRING MOUNT. ATTACH THE 1/2-13 NUT (ITEM# 11) FINGER TIGHTEN. (THE BRACKET WILL SIT AT A 15 DEGREE ANGLE)
 - 3.2. PLACE LOWER BRACKET (ITEM# 8) BEHIND THE UPPER BRACKET. SO THAT IT SITS LEVEL TO THE FRONT BRACKETS. USE THE TWO HOLES AS SHOWN IN UPPER BRACKET AND THE TWO HOLES IN THE LOWER BRACKET. INSTALL THE 3/8" BOLT, WASHER AND NUT (ITEMS # 12,13, &3) TO AFFIX BRACKETS TOGETHER. ASSEMBLE THE DOUBLE ENDED STUD & FASTENERS. TIGHTEN TO 19 LBS FT.
4. ATTACHING THE STEP ASSEMBLY:
PLEASE REVIEW THE INSTALLATION INSTRUCTIONS THAT ARE INCLUDED IN YOUR STEP ASSEMBLY FOR SPECIFIC DETAILS.

LIVERNE
TRUCK EQUIPMENT

(A LIVERNE Company)

1200 E. Birch St.

Brandon, SD 57005

REVISION B 05MAR12
REVISION A 20JAN11
551887 SHEET 1 OF 3 29SEP10

INSTALLATION INSTRUCTIONS AND PARTS LIST

APPLICATION:

MODEL 401037 WHEEL TO WHEEL STEP BRACKETS:

2010 DODGE RAM 2500/3500 REGULAR/CREW/MEGA CAB PICKUPS

SERVICE PARTS LIST

ITEM	PART NO.	QTY	DESCRIPTION
PARTS INCLUDED IN THE BRACKET PACKAGE			
1	551858	6	MOUNTING BRACKET, BLK, DODGE, GRIP STEP
2	550147	6	T-BOLT WELDMENT, ZP
3	100181	40	NUT-SERRATED FLANGE,HEX,3/8-16,ZP
4	108442	12	WASHER-NYLON,.360 X 1.50 X .032
5	102592	8	WASHER-RUBBER,.354 X 1.00 X .748
6	551899	6	STUD-DBL THREADED,3/8-16 X 11.00,ZP
7	100062	12	WASHER-FLT,3/8,ZP
8	551885	2	MOUNTING BRACKET,LOWER,401037,LH/RH
9	551810	2	MOUNTING BRACKET,UPPER,571037,LH/RH
10	100085	2	SCR-HHC,1/2-13 X 1.00,ZP
11	100118	2	WASHER-FLAT,1/2",ZP
12	100123	2	NUT-HEX,SERRATED FLANGE, 1/2-13,ZP
13	100040	4	SCR-HEX HD,3/8-16 X 1.00,ZP
14	104673	2	STUD-DBL END,STL,3/8-16 X 5.00,ZP



1200 E. Birch St.

Brandon, SD 57005

REVISION B 05MAR12
REVISION A 20JAN11
551887 SHEET 2 OF 3 29SEP10

SERVICE PARTS LIST

MODEL NO. -401037

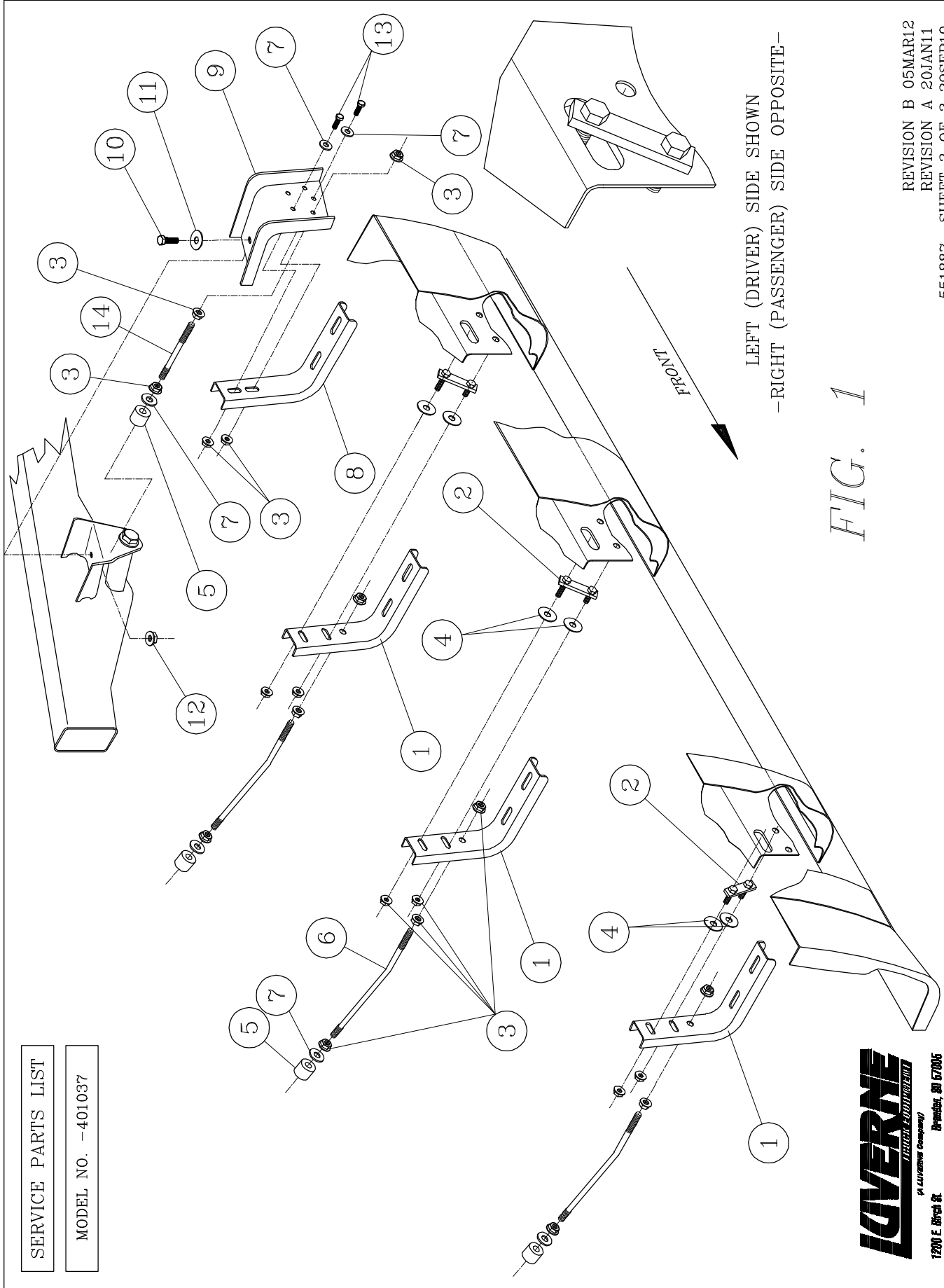

LEFT (DRIVER) SIDE SHOWN
-RIGHT (PASSENGER) SIDE OPPOSITE-

FIG. 1

LOVERNE
A LUYKENS COMPANY
1200 E. Street St. Philadelphia, PA 19106

REVISION B 05MAR12
REVISION A 20JAN11
551887 SHEET 3 OF 3 29SEP10