

INSTALLATION INSTRUCTIONS AND PARTS LIST
MODEL# 430717 BLACK W2W BAJA STEPS BARS:
1999 AND NEWER CHEVROLET/GMC EXTENDED CAB PICKUPS



1. READ INSTRUCTIONS COMPLETELY AND CHECK TO MAKE SURE THAT ALL REQUIRED PARTS (LISTED ON SERVICE PARTS LIST) ARE ON HAND BEFORE STARTING THE INSTALLATION.
2. ASSEMBLE THE BAJA STEP TUBES AND MOUNTING BRACKETS AS FOLLOWS.
NOTE: THE 1" X 3" SERIAL NUMBER DECAL IS LOCATED ON THE FRONT LEG OF THE LEFT (DRIVERS SIDE) BAJA STEP ASSEMBLY.
 - 2.1 LAY THE BAJA STEP ASSEMBLIES (ITEM #1) ON A FLAT SURFACE. (LEFT & RIGHT HAND ASSEMBLIES SHOULD BE MIRROR IMAGES OF ONE ANOTHER).
 - 2.2 ATTACH THE FRONT (4-1/8" TALL) BRACKET (ITEM #3) AND REAR (8-1/2" TALL) BRACKET (ITEM #4) TO THE BAJA STEP AS SHOWN. USE 1/2-13 X 2" LONG HEX HEAD BOLTS (ITEM #9). TORQUE THESE BOLTS TO 65 LB. FT.

NOTE:

DUE TO EXCESSIVE THREAD LOCKER IN THE BODY MOUNT BOLT AREA ON THE 2010+ GM SILVERADO/SIERRA, PLEASE USE CAUTION WHEN REMOVING THESE BODY MOUNT BOLTS IN ORDER TO REDUCE THE RISK OF CAUSING DAMAGE TO THE THREADED INSERTS INSIDE THE VEHICLE.

- 3 REMOVE THE FOUR (4) APPLICABLE FACTORY BODY MOUNT BOLTS FROM THE VEHICLE.
 - 3.1 THESE FOUR (4) BOLTS ARE REUSED IN THIS INSTALLATION.
 - 3.2 THE BODY MOUNT STEEL WASHER PLATES WITH RUBBER CUSHIONS ARE REUSED BETWEEN THE BODY MOUNT AND THE BAJA STEP MOUNTING BRACKET.
- 4 ASSEMBLE THE DOUBLE ENDED STUD & FASTENERS TO THE REAR BRACE AS FOLLOWS:
 - 4.1 INSTALL 3/8" SERRATED FLANGE NUTS (ITEM #7) BACKWARDS, TO THE END OF THE THREAD, ON EACH END OF THE DOUBLE ENDED STUD (ITEM #6).
 - 4.2 ON THE SHORT THREADED END OF THE STUD, INSTALL A 3/8" FLAT WASHER (ITEM #8) AND THEN PUSH THE 3/4" THICK RUBBER WASHER (ITEM #5) AND FLAT WASHER TIGHT UP AGAINST THE SERRATED FLANGE NUT. **(THE END OF THE DOUBLE ENDED STUD SHOULD BE RECESSED BACK IN THE HOLE OF THE RUBBER WASHER APPROXIMATELY 3/16").**
 - 4.3 INSTALL THE LONG THREADED END OF THE STUD ASSEMBLY THRU THE HOLE IN THE MOUNTING BRACKET AND INSTALL A 3/8" SERRATED FLANGE NUT. (FINGER TIGHT ONLY).
5. POSITION THE BAJA STEP ASSEMBLY UP UNDER THE VEHICLE AND ATTACH THE FRONT AND REAR BRACKETS TO THE BODY MOUNTS WITH FACTORY BODY MOUNT BOLTS AS SHOWN.
 - 5.1. TORQUE ALL BODY MOUNT BOLTS TO 65 LB. FT.
 - 5.2. POSITION THE STUD ASSEMBLIES SO THAT THE RUBBER WASHER IS SNUG UP AGAINST THE SIDE OF THE FRAME. **INSURE THAT THE THREADED STUD WILL NOT MAKE CONTACT WITH THE SIDE OF THE FRAME.** TIGHTEN THE 3/8" SERRATED FLANGE NUTS ON EITHER SIDE OF THE REAR BRACKET FLANGE TO LOCK THE STUD ASSEMBLY IN POSITION.



(A LUVERNE Company)

1200 E. Birch St.

Brandon, SD 57005

552231 SHEET 1 OF 3 15JAN13

SERVICE PARTS LIST

| ITEM | PART NO. | QTY | DESCRIPTION |
|------|----------|-----|---|
| 1 | 552227 | 1 | BAJA STEP WLDMT, LH, SST, BLK,430717 |
| 2 | 552228 | 1 | BAJA STEP WLDMT, RH ,SST, BLK,430717 |
| 3 | 552032 | 2 | BRKT MTG NERF BAR- RH/LH FRONT |
| 4 | 552031 | 2 | BRKT MTG NERF BAR- RH/LH REAR |
| 5 | 104687 | 2 | STUD-DOUBLE ENDED,STL,3/8-16 UNC X 7.00",ZP |
| 6 | 102592 | 2 | WASHER-RUBBER,.354 ID X 1.00 OD X .75 THK |
| 7 | 100181 | 6 | NUT-SERRATED FLANGE,HEX,3/8-16 UNC,ZP |
| 8 | 100062 | 2 | WASHER-FLAT,3/8",ZP |
| 9 | 104249 | 4 | BOLT-HEX HD CAP, SERRFLG, 1/2 X 2.00"LG,ZP |



(A LIVERNE Company)

1200 E. Birch St.

Brandon, SD 57005

552231 SHEET 2 OF 3 15JAN13

INSTALLATION INSTRUCTION AND PARTS LIST

MODEL NO. 430717

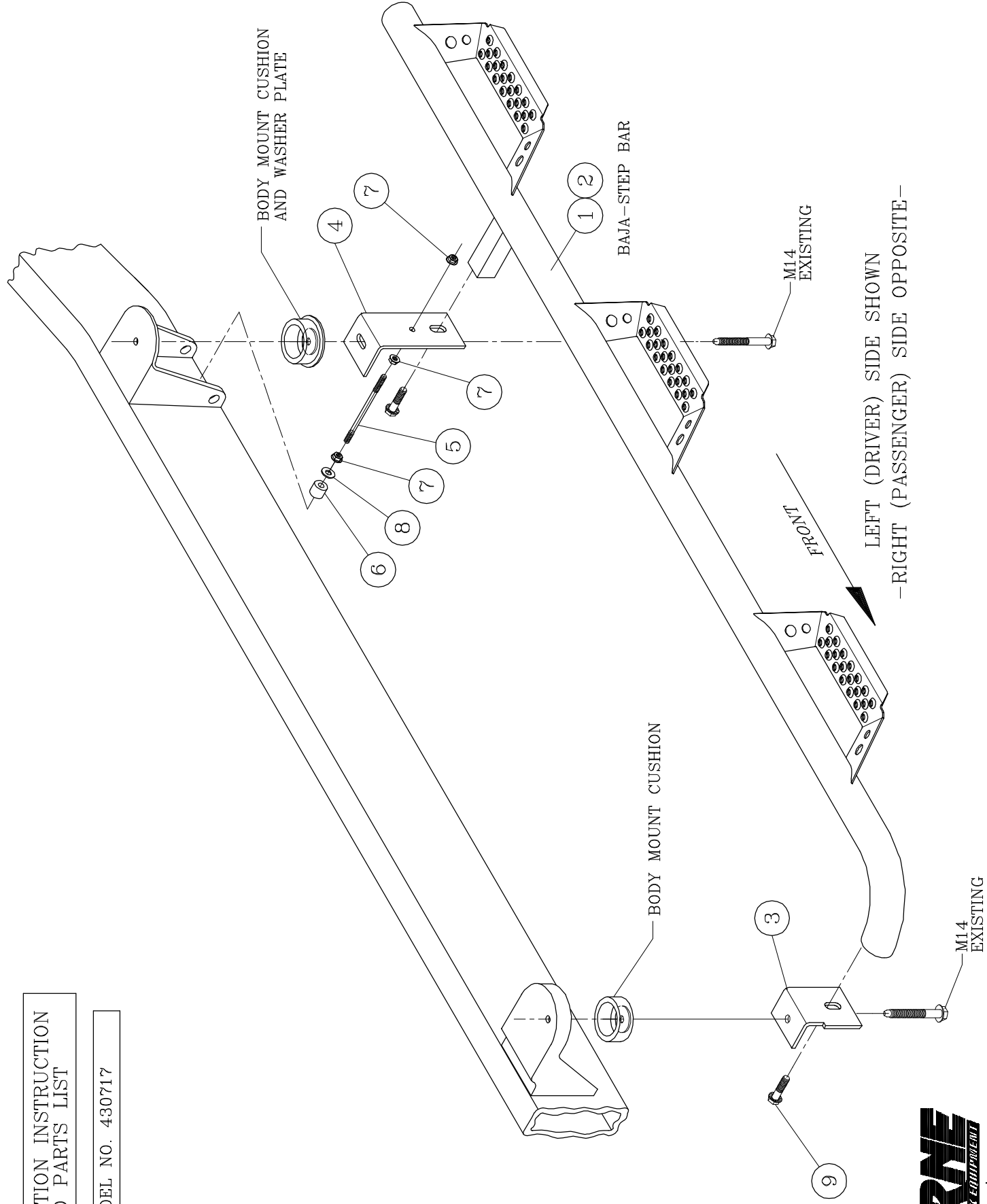

LOVERNE
TRUCK EQUIPMENT
(A LOVERNE COMPANY)

1200 E. Birch St.
Granville, SD 57035