

INSTALLATION INSTRUCTIONS AND PARTS LIST

431652 AND 431653 SST (BLACK) BAJA STEPS ON:
2005 AND NEWER TOYOTA TACOMA ACCESS CAB AND DOUBLE CAB PICKUPS



1. READ INSTRUCTIONS COMPLETELY AND CHECK TO MAKE SURE THAT ALL REQUIRED PARTS (LISTED ON SERVICE PARTS LIST) ARE ON HAND BEFORE STARTING THE INSTALLATION.
2. AT THE FRONT AND REAR ON EACH SIDE OF THE VEHICLE, REMOVE THE TWO PLASTIC SLOTTED HEAD HOLE PLUGS FROM THE 8mm THREADED INSERTS IN THE ROCKER PANEL.
3. INSTALL FRONT AND REAR MOUNTING BRACKETS (ITEMS #2,3,4,5) AS SHOWN IN FIGURE 1. USING THE SUPPLIED M8-1.25 X 25MM, AND 5/16 FLAT WASHER (ITEMS # 7,8) LEAVE FASTENERS FINGER TIGHT FOR NOW.
4. POSITION THE BAJA STEP UNDER THE BODY ROCKER PANEL: (NOTE: THE LUVERNE DECAL SHOULD BE AT THE FRONT ON THE DRIVER SIDE).
 - 4.1. ATTACH THE BAJA STEP TO THE VEHICLE. USE 1/2-13 HEX HD CAP SCREWS (ITEM #6) AS SHOWN IN FIGURE 1.
 - 4.2. TORQUE THE 8mm SCREWS TO 22 LB FT.
 - 4.3. TORQUE THE 1/2-13 BOLTS TO 65 LB FT.

SERVICE PARTS LIST

| ITEM | PART NO. | QTY | DESCRIPTION |
|------|----------|-----|---|
| 1 | 552172 | 2 | BAJA STEP WLDMT- ACCESS CAB, LH/RH, SST, 430552 |
| 1 | 552173 | 2 | BAJA STEP WLDMT- DOUBLE CAB, LH/RH, SST, 430553 |
| | | | |
| 2 | 551406 | 1 | BRKT WLDMT- MTG, NB, FRONT, LH, 05 TACOMA |
| 3 | 551407 | 1 | BRKT WLDMT- MTG, NB, FRONT, RH, 05 TACOMA |
| 4 | 551411 | 1 | BRKT WLDMT- MTG, NB, REAR, LH, 05 TACOMA |
| 5 | 551412 | 1 | BRKT WLDMT- MTG, NB, REAR, RH, 05 TACOMA |
| 6 | 104249 | 4 | BOLT- HEX HD CAP, SERR FLG 1/2-13 X 2.00, ZP |
| 7 | 102549 | 8 | SCR- CAP,HEX HD, M8-1.25 X 25mm, 10.9, ZP |
| 8 | 100034 | 8 | WASHER- FLAT, 5/16", ZP |



(A LUVERNE Company)

1200 E. Birch St.

Brandon, SD 57005

552947 SHEET 1 OF 2 28JAN16

SERVICE PARTS LIST

MODEL NO. - 431652/431653

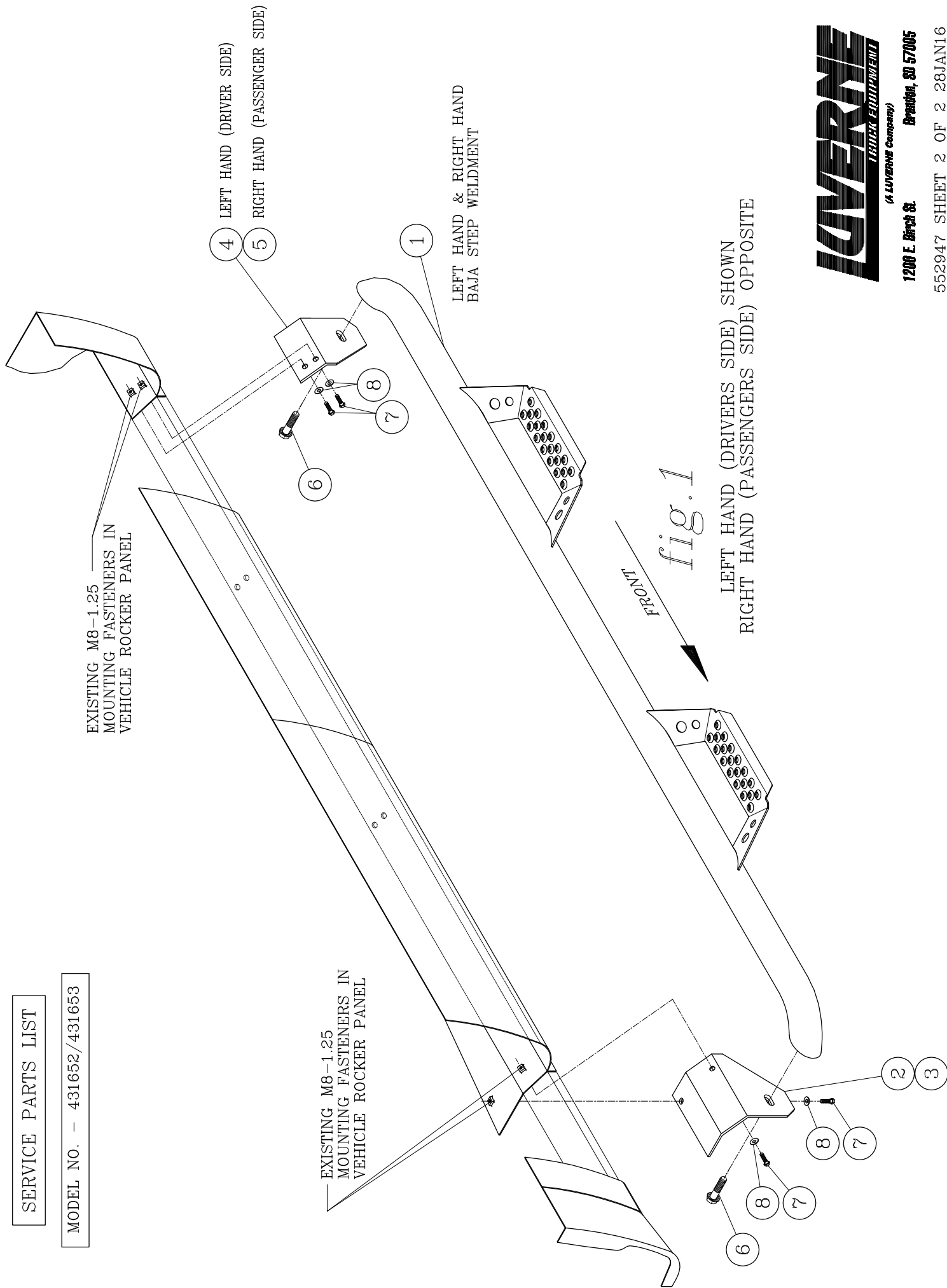

LAVERNE
TRUCK EQUIPMENT
(A LAVERNE Company)

1200 E. Birch St. Brandon, SD 57005

552947 SHEET 2 OF 2 28JAN16