

INSTALLATION INSTRUCTIONS AND PARTS LIST

440713 STAINLESS STEEL OVAL STEPS

APPLICATIONS:

2001 AND NEWER GM CREW CAB PICKUPS



1. Read instructions completely and check to make sure that all required parts (listed on service parts list) are on hand before starting the installation.
2. Assemble the Oval Step assemblies and mounting brackets as follows:
NOTE: The 1" X 3" serial number decal is located on the front leg of the driver's side.
 - 2.1 Lay the Oval Step assemblies (item #1) on a flat surface. (Left and right side Oval Step assemblies are identical)
 - 2.2 Attach the front short bracket (item #2) and rear tall bracket (item #3) to the Oval Step assemblies as shown. Use the 1/2-13 X 2" hex head bolts (item #4).
Torque these bolts to 65 lb. ft.

NOTE:

DUE TO EXCESSIVE THREAD LOCKER IN THE BODY MOUNT BOLT AREA ON THE 2010+ GM SILVERADO/SIERRA, USE CAUTION WHEN REMOVING THE BODY MOUNT BOLTS TO REDUCE THE RISK OF CAUSING DAMAGE TO THE THREADED INSERTS INSIDE THE VEHICLE.

- 3 Remove the four (4) applicable factory body mount bolts from the vehicle.
 - 3.1 These four (4) bolts are reused in this installation.
 - 3.2 The body mount steel washer plates, and rubber cushions are reused between the body mount and the Oval Step brackets.
- 4 Position the Oval Step up under the vehicle and attach the front and rear bracket to the body mounts with factory body mount bolts as shown.
 - 4.1 Torque all body mount bolts to 65 lb. ft.

SERVICE PARTS LIST

ITEM	PART NO.	QTY	DESCRIPTION
1	108429	2	OVAL STEP ASSY-SST,440713
2	550130	2	BRKT- MTG, GM, LH/RH, FRONT
3	549077	2	BRKT- MTG, GM, LH/RH, REAR
4	104249	4	SCREW-HEX HED, 1/2" X 2", ZP



(A LUVERNE Company)

1200 E. Birch St.

Brandon, SD 57005

REV B 21MAY14
REV A 03SEPT10
551756 SHEET 1 10JAN08

INSTALLATION INSTRUCTION
AND PARTS LIST

MODEL NO. - 440713

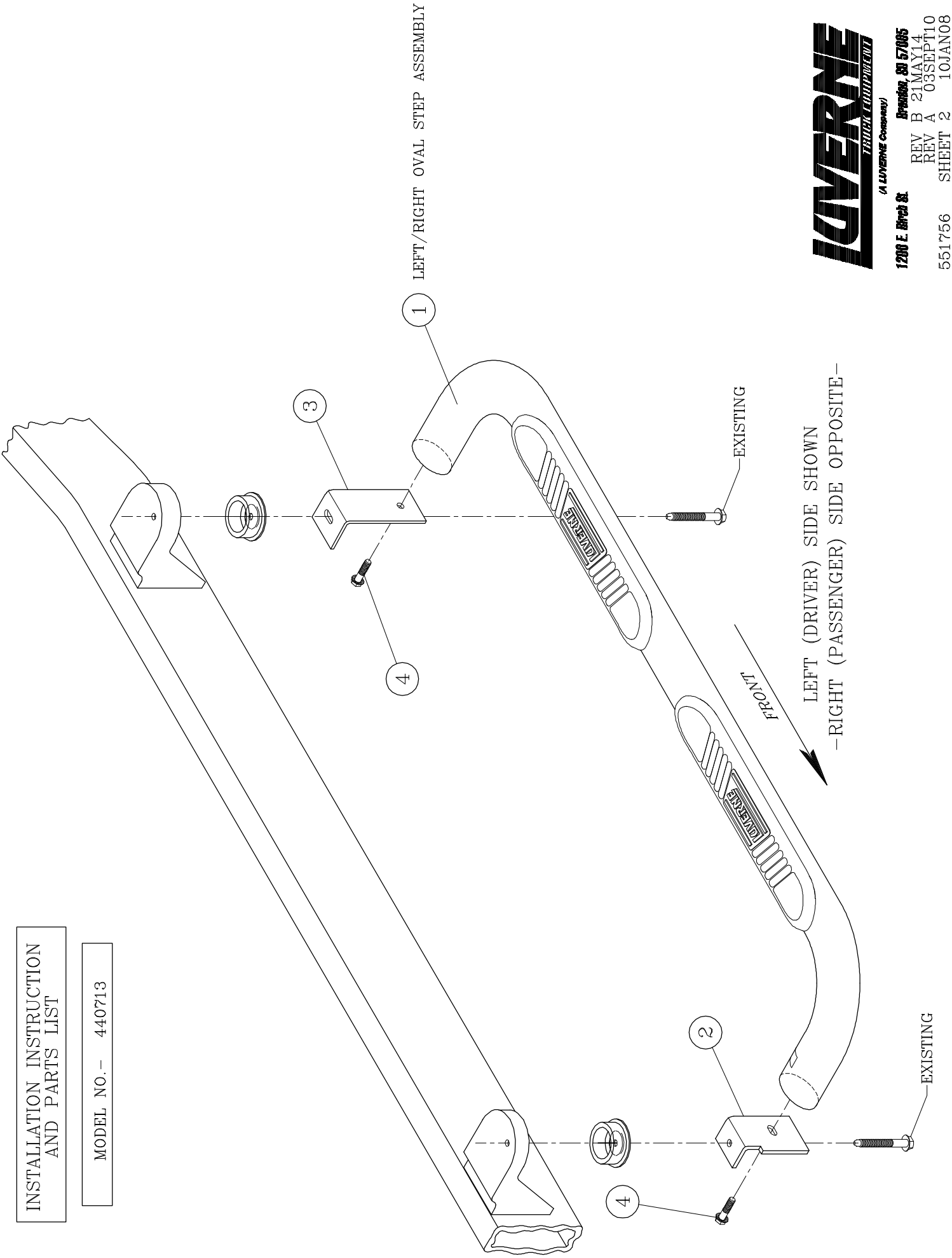

LEFT/RIGHT OVAL STEP ASSEMBLY

FRONT
LEFT (DRIVER) SIDE SHOWN
-RIGHT (PASSENGER) SIDE OPPOSITE-

LOVERNE
TRUCK EQUIPMENT
A LOVERNE COMPANY

1200 E. 87th St.
Brentwood, MO 63105
REV B 21MAY14
REV A 03SEPT10
551756 SHEET 2 10JAN08