

# INSTALLATION INSTRUCTIONS AND PARTS LIST

APPL: F9927 SERIES STAINLESS STEEL AND BLACK NERF BARS ON:  
1999 AND NEWER FORD SUPER DUTY SUPER CAB PICKUPS,  
459929 AND 469929 NERF BARS ON:  
1999 AND NEWER FORD SUPER DUTY CREW CAB PICKUPS



## NO DRILL INSTALLATION

1. READ INSTRUCTIONS COMPLETELY AND CHECK TO MAKE SURE THAT ALL REQUIRED PARTS (LISTED ON SERVICE PARTS LIST) ARE ON HAND BEFORE STARTING THE INSTALLATION.
2. THE NERF BARS AND MOUNTING BRACKETS ARE PRE-ASSEMBLED TO MATCH THE EXISTING MOUNTING LOCATIONS ON THE VEHICLE. IF ANY ADDITIONAL ADJUSTMENT SHOULD BE REQUIRED, THIS CAN BE ACCOMPLISHED BY LOOSENING THE PRE-TORQUED 1/2 IN. HEX HEAD BOLT THAT RETAINS THE FRONT AND REAR MOUNTING BRACKETS TO THE NERF BAR. IF THE PRE-TORQUE ON THIS 1/2 IN. BOLT IS BROKEN, THE BOLT MUST BE RE-TIGHTENED TO 65 LB. FT.
3. EXISTING MOUNTING HOLE PATTERNS ARE LOCATED ON THE INTERIOR WALL AND PINCH WELD OF THE ROCKER PANEL. THESE MOUNTING HOLE PATTERNS MUST BE USED FOR THIS INSTALLATION PER THE FOLLOWING INSTRUCTIONS.
  - 3.1. ON THE FRONT MOUNTING PATTERN, INSERT ONE 5/16 MULTI THREAD U-NUT (ITEM #17) INTO THE TOP REAR HOLE SO THAT THE THREADS ARE TO THE INSIDE OF THE ROCKER PANEL. (THIS IS DONE BY INSERTING THE THREADED HALF OF THE U-NUT THROUGH THE .75 X 1.50 RECTANGULAR SLOT AND SLIDING THE U-NUT TOWARDS THE REAR UNTIL THE NUT IS SEATED IN THE ROUND HOLE).
  - 3.2. ON THE REAR MOUNTING HOLE PATTERN, INSERT THE 5/16 MULTI THREAD U-NUTS INTO BOTH THE TOP FRONT AND TOP REAR HOLES SO THAT THE THREADS ARE TO THE INSIDE OF THE ROCKER PANEL.
4. INSTALL THE NERF BAR ASSEMBLY AS FOLLOWS:
  - 4.1. POSITION THE NERF BAR ASSEMBLY UP TO THE ROCKER PANEL SO THAT THE HOLES IN MOUNTING BRACKETS LINE UP WITH THE MOUNTING HOLES IN THE PINCH WELD. INSTALL 5/16-18 X 3/4" CARRIAGE BOLTS (ITEM #13) AND 5/16-18 SERRATED FLANGE NUTS (ITEM #14). LEAVE THESE FASTENERS FINGER TIGHT AT THIS TIME.
  - 4.2. ON THE TOP HOLE OF THE FRONT BRACKET, LOCATE A 1/2" FLAT WASHER (ITEM #12) BETWEEN THE MOUNTING BRACKET AND THE U-NUT (INSTALLED PER INSTRUCTION 3.1). NEXT INSTALL A 5/16-18 X 1.00" HEX HEAD CAP SCREW (ITEM #15) WITH A 5/16" FLAT WASHER (ITEM # 16) THROUGH THE MOUNTING BRACKET AND 1/2" FLAT WASHER INTO THE U-NUT.
  - 4.3. ON THE TOP HOLES OF THE REAR BRACKET, INSTALL 5/16-18 X 1.00" HEX HEAD CAP SCREWS WITH 5/16" FLAT WASHER THROUGH THE MOUNTING BRACKET AND INTO THE U-NUT. (TORQUE ALL 5/16 FASTENERS TO 19 LB. FT.)

## INSTALLATION INSTRUCTIONS AND PARTS LIST

APPL: F9927 SERIES STAINLESS STEEL AND BLACK NERF BARS ON:  
 1999 AND NEWER FORD SUPER DUTY SUPER CAB PICKUPS,  
 459929 AND 469929 NERF BARS ON:  
 1999 AND NEWER FORD SUPER DUTY CREW CAB PICKUPS

### SERVICE PARTS LIST

ITEM	PART NO.	QTY	DESCRIPTION
1	551195	1	NERF BAR WLDMT- LH, F9927SST
2	551196	1	NERF BAR WLDMT- RH, F9927SST
1	551187	1	NERF BAR WLDMT- LH, F9927TB
2	551188	1	NERF BAR WLDMT- RH, F9927TB
1	551181	1	NERF BAR WLDMT- LH, 469929
2	551182	1	NERF BAR WLDMT- RH, 469929
1	551184	1	NERF BAR WLDMT- LH, 459929
2	551185	1	NERF BAR WLDMT- RH, 459929
3	551199	2	SPCR TUBE, 3.00, SST
3	551189	2	SPCR TUBE, 3.00, BLACK
4	551112	2	TRIM, SPCR TUBE
5	103950	6	PAD-STEP, NB, BLK, 20.00 LG
6	102500	2	INSR-FNSH, RIBBED, 14-18 GA
7	548860	1	BRKT-MTG, FRT, LH
8	548861	1	BRKT-MTG, FRT, RH
9	548862	1	BRKT-MTG, REAR, LH
10	548863	1	BRKT-MTG, REAR, RH
11	104249	4	SCREW-HEX HD, SERR FLNG, ½-13 X 2.00, ZP
12	100118	2	WASHER-FLAT, ½", ZP
13	104262	8	BOLT-CARRIAGE, SST, 5/16-18 X ¾" LG
14	102680	8	NUT-SERRATED FLANGE, HEX, SST, 5/16-18
15	100647	6	SCREW-HEX HD, 5/16-18 X 1.00" LG, ZP
16	100034	6	WASHER-FLAT, 5/16,ZP
17	104264	6	NUT-U, MULTI THREAD, 5/16-18, STL, BLACK

SERVICE PARTS LIST

MODEL NO. - F9927SSST  
 - F9927TB  
 - 459929  
 - 469929

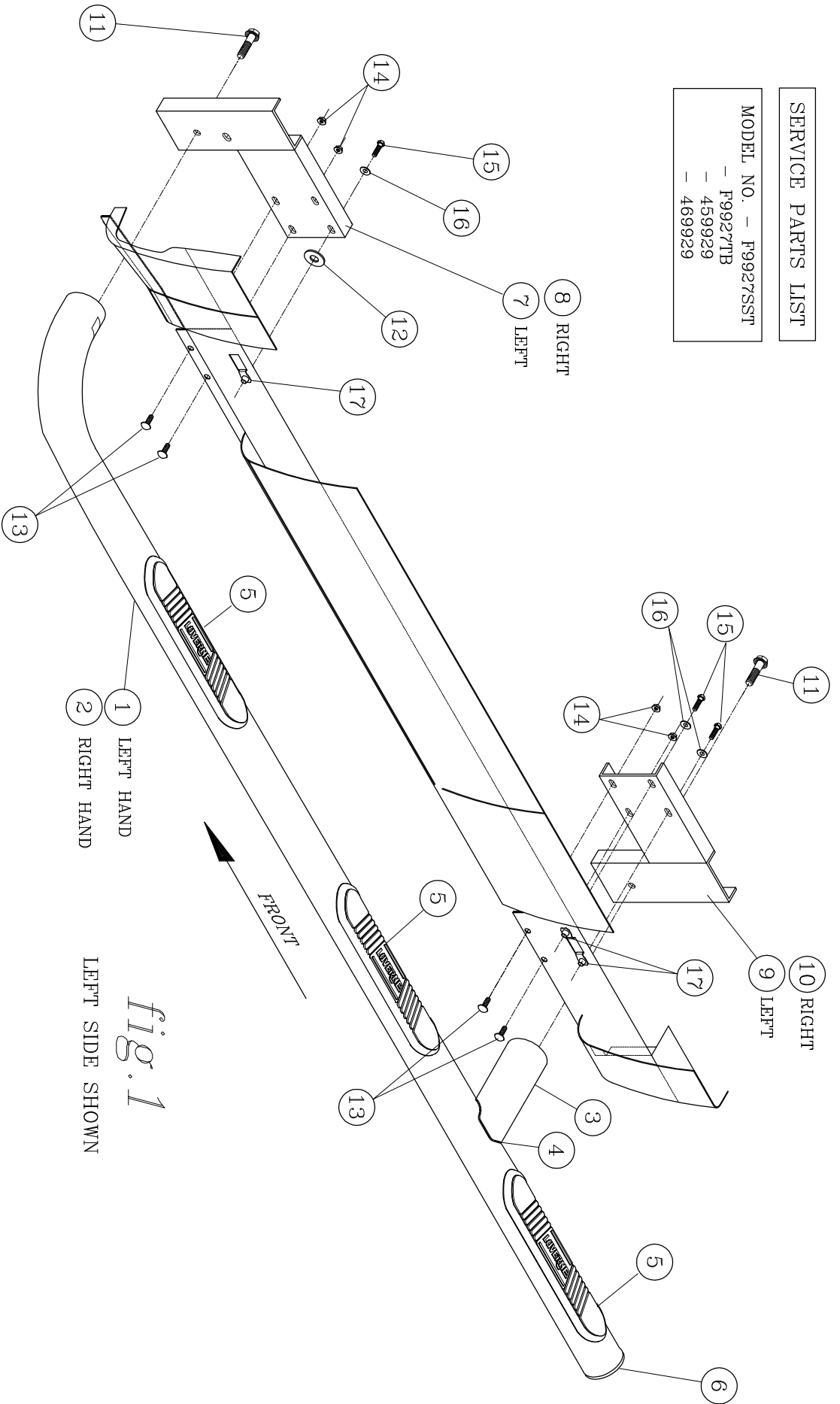

fig. 1  
 LEFT SIDE SHOWN