

INSTALLATION INSTRUCTIONS AND PARTS LIST

MODELS:

477097, 477101, 477113 (EXTENDED CABS)
477102, 477108, 477114, 477125 (CREW CABS)
REGAL 7 OVAL STEPS (BOARDS ONLY)
UNIVERSAL APPLICATIONS



1. Read instructions completely and check to make sure that all required parts (listed on the service parts list) are on hand before starting the installation.
2. Follow the instructions included with the specific bracket package that you are using to mount the brackets to your vehicle.
3. The step is pre-assembled from the factory. The serial number label is located on the front inside drivers side step assembly.
4. Attaching the step to the mounting bracket:
 - 4.1 Set the step on the mounting brackets, and slide each support mounting plate (item #9) inside the oval step and above each bracket.
 - 4.2 Using the supplied 5/16-18 x 1" black stainless steel hex bolt, washer, and serrated flange nut (items # 10,11&12) attach the step assembly, support mounting plate and mounting bracket.
 - 4.3 Set the step plate in the correct position and tighten all fasteners.
Torque all 5/16" fasteners to 19 LB FT.



(A LUVERNE Company)

1200 E. Birch St.

Brandon, SD 57005

REV A 31JUL12
552088 SHEET 1 OF 3 07MAY12

INSTALLATION INSTRUCTIONS AND PARTS LIST

APPLICATION:

MODEL 401037 WHEEL TO WHEEL STEP BRACKETS:
2010 DODGE RAM 2500/3500 REGULAR/CREW/MEGA CAB PICKUPS



1. READ INSTRUCTIONS COMPLETELY AND CHECK TO MAKE SURE THAT ALL REQUIRED PARTS (LISTED ON THE SERVICE PARTS LIST) ARE ON HAND BEFORE STARTING THE INSTALLATION.
2. ATTACH THE MOUNTING BRACKETS TO THE VEHICLE AS FOLLOWS: [SEE FIG. 1]
 - 2.1 ON THE VERTICAL WALL OF THE ROCKER PANEL, INSTALL THE T-BOLT WELMENT (ITEM #2) INTO THE LARGE OBOUNRD HOLE AND FISH THE OTHER END THROUGH THE FORWARD 1/2" HEXAGON HOLE **BE CAREFULL NOT TO DROP THE T-BOLT INSIDE OF THE ROCKER PANEL.** ATTACH THE FLAT NYLON WASHER (ITEM #4) TO THE THREADED END OF EACH BOLT. (THIS IS TO BE USED AS A RETAINER.)
 - 2.2 POSITION THE MOUNTING BRACKET (ITEM #1) SO THAT THE HOLES IN THE BRACKETS LINE UP WITH THE THREADED STUDS ON THE INSIDE WALL OF THE ROCKER PANEL. INSTALL THE 3/8-16 SERRATED FLANGE NUTS (ITEM #3). TIGHTEN BRACKET FASTENERS TO 19 LB FT.
 - 2.3 ASSEMBLE THE DOUBLE ENDED STUD & FASTENERS TO THE BRACKETS AS FOLLOWS:
 - 2.4 INSTALL 3/8" SERRATED FLANGE NUTS (ITEM #3) BACKWARDS, TO THE END OF THE THREAD, ON EACH END OF THE DOUBLE ENDED STUD (ITEM #6).
 - 2.5 ON (1) THREADED END OF THE STUD, INSTALL A 3/8" FLAT WASHER (ITEM #7) AND THEN PUSH THE 3/4" THICK RUBBER WASHER (ITEM #5) AND FLAT WASHER TIGHT UP AGAINST THE SERRATED FLANGE NUT. **(THE END OF THE DOUBLE ENDED STUD SHOULD BE RECESSED BACK IN THE HOLE OF THE RUBBER WASHER APPROXIMATELY 3/16").**
 - 2.6 INSTALL THE SECOND THREADED END OF THE STUD ASSEMBLY THRU THE HOLE IN THE BRACKET (ITEM# 1) AS SHOWN AND INSTALL A 3/8" SERRATED FLANGE NUT. (FINGER TIGHT ONLY).
 - 2.7 POSITION SNUG AGAINST FRAME RAIL AND TIGHT ALL FASTENERS. THIS WILL REINFORCE THE STEP.
3. ATTACH THE MOUNTING BRACKETS TO THE BOX OF THE VEHICLE AS FOLLOWS (SEE FIG. 1)
 - 3.1. ATTACH THE UPPER MOUNTING BRACKET (ITEM#8) TO THE TOP OF THE SPRING SHACKLE USING THE 1/2" HOLE LOCATED ON THE TOP OF THE SPRING MOUNT. PLACE 1/2-13 BOLT AND WASHER (ITEM# 9&10) THROUGH THE BRACKET AND SPRING MOUNT. ATTACH THE 1/2-13 NUT (ITEM# 11) FINGER TIGHTEN. (THE BRACKET WILL SIT AT A 15 DEGREE ANGLE)
 - 3.2. PLACE LOWER BRACKET (ITEM# 8) BEHIND THE UPPER BRACKET. SO THAT IT SITS LEVEL TO THE FRONT BRACKETS. USE THE TWO HOLES AS SHOWN IN UPPER BRACKET AND THE TWO HOLES IN THE LOWER BRACKET. INSTALL THE 3/8" BOLT, WASHER AND NUT (ITEMS # 12,13, &3)TO AFFIX BRACKETS TOGETHER. ASSEMBLE THE DOUBLE ENDED STUD & FASTENERS. TIGHTEN TO 19 LBS FT.
4. ATTACHING THE STEP ASSEMBLY:
PLEASE REVIEW THE INSTALLATION INSTRUCTIONS THAT ARE INCLUDED IN YOUR STEP ASSEMBLY FOR SPECIFIC DETAILS.

LIVERNE
TRUCK EQUIPMENT

(A LIVERNE Company)

1200 E. Birch St.

Brandon, SD 57005

REVISION B 05MAR12
REVISION A 20JAN11
551887 SHEET 1 OF 3 29SEP10

INSTALLATION INSTRUCTIONS AND PARTS LIST

APPLICATION:

MODEL 401037 WHEEL TO WHEEL STEP BRACKETS:

2010 DODGE RAM 2500/3500 REGULAR/CREW/MEGA CAB PICKUPS

SERVICE PARTS LIST

ITEM	PART NO.	QTY	DESCRIPTION
PARTS INCLUDED IN THE BRACKET PACKAGE			
1	551858	6	MOUNTING BRACKET, BLK, DODGE, GRIP STEP
2	550147	6	T-BOLT WELDMENT, ZP
3	100181	40	NUT-SERRATED FLANGE,HEX,3/8-16,ZP
4	108442	12	WASHER-NYLON,,360 X 1.50 X .032
5	102592	8	WASHER-RUBBER,,354 X 1.00 X .748
6	551899	6	STUD-DBL THREADED,3/8-16 X 11.00,ZP
7	100062	12	WASHER-FLT,3/8,ZP
8	551885	2	MOUNTING BRACKET,LOWER,401037,LH/RH
9	551810	2	MOUNTING BRACKET,UPPER,571037,LH/RH
10	100085	2	SCR-HHC,1/2-13 X 1.00,ZP
11	100118	2	WASHER-FLAT,1/2",ZP
12	100123	2	NUT-HEX,SERRATED FLANGE, 1/2-13,ZP
13	100040	4	SCR-HEX HD,3/8-16 X 1.00,ZP
14	104673	2	STUD-DBL END,STL,3/8-16 X 5.00,ZP



1200 E. Birch St.

Brandon, SD 57005

REVISION B 05MAR12
REVISION A 20JAN11
551887 SHEET 2 OF 3 29SEP10

SERVICE PARTS LIST

MODEL NO. -401037

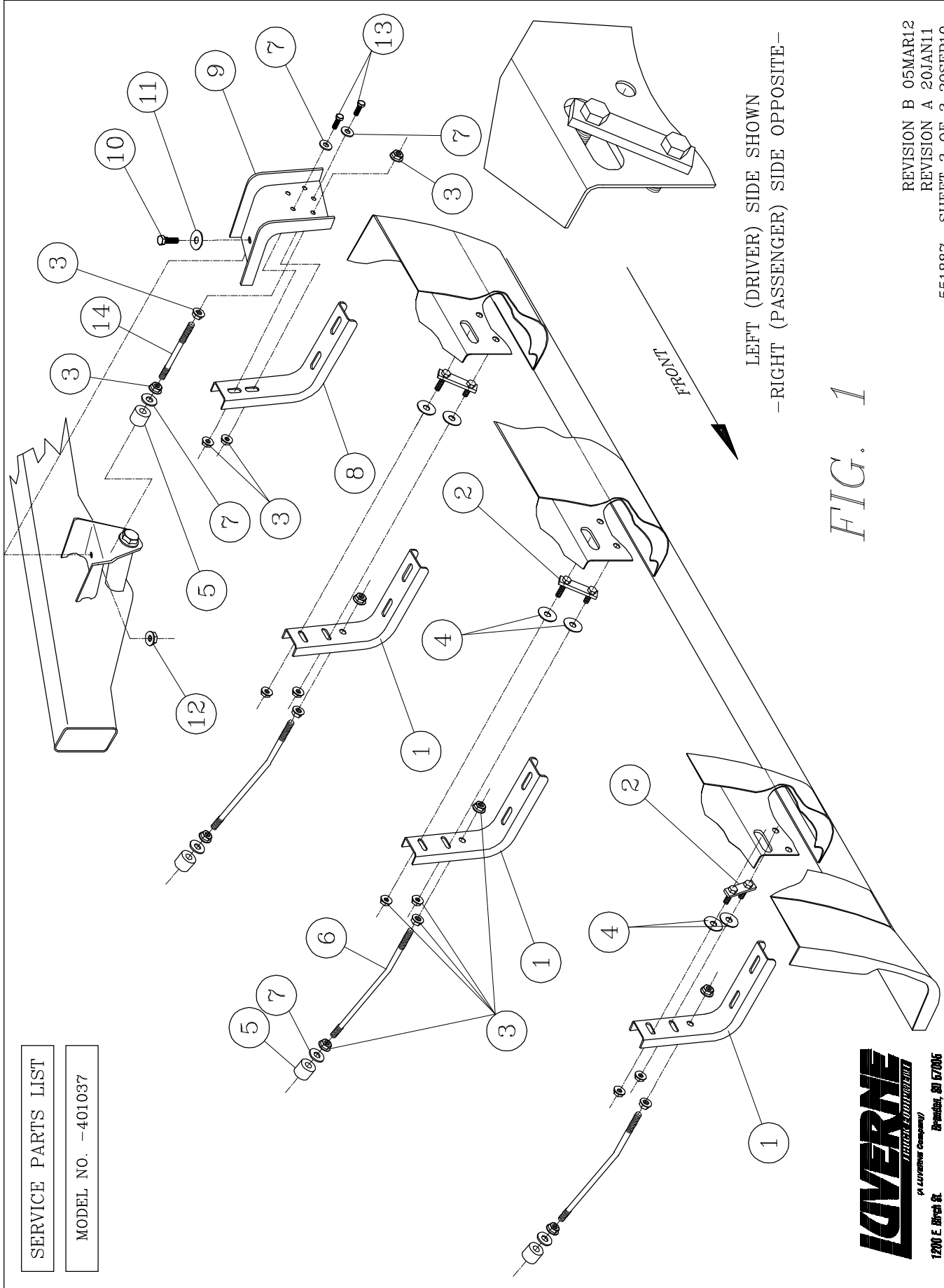

LEFT (DRIVER) SIDE SHOWN
-RIGHT (PASSENGER) SIDE OPPOSITE-

FIG. 1

LOVERNE
A LUYKENS COMPANY
1200 E. Street St. Danbury, CT 07705

REVISION B 05MAR12
REVISION A 20JAN11
551887 SHEET 3 OF 3 29SEP10

SERVICE PARTS LIST

ITEM	PART NO.	QTY	DESCRIPTION
1	552074	1	REGAL 7 OVAL STEP, LH,96",477097, EXT CAB
2	552075	1	REGAL 7 OVAL STEP, RH,96",477097, EXT CAB
1	552076	1	REGAL 7 OVAL STEP, LH,100",477101, EXT CAB
2	552077	1	REGAL 7 OVAL STEP, RH,100",477101, EXT CAB
1	552078	1	REGAL 7 OVAL STEP, LH,112",477113, EXT CAB
2	552079	1	REGAL 7 OVAL STEP, RH,112",477113, EXT CAB
1	552080	1	REGAL 7 OVAL STEP, LH,100",477102, CREW CAB
2	552081	1	REGAL 7 OVAL STEP, RH,100",477102, CREW CAB
1	552501	1	REGAL 7 OVAL STEP, LH, 106",477108, CREW CAB
2	552502	1	REGAL 7 OVAL STEP, RH, 106",477108, CREW CAB
1	552082	1	REGAL 7 OVAL STEP, LH,112",477114, CREW CAB
2	552083	1	REGAL 7 OVAL STEP, RH,112",477114, CREW CAB
1	552084	1	REGAL 7 OVAL STEP, LH,123",477125, CREW CAB
2	552085	1	REGAL 7 OVAL STEP, RH,123",477125, CREW CAB
3	109233	2	END CAP LH REAR, RH FRONT,BLK PLASTIC
4	109232	2	END CAP RH REAR, LH FRONT,BLK PLASTIC
5	107863	8	BOLT-CARRAIGE, 10-24 X 0.50,SST, BLACK
6	108909	6	STEP PAD, 25" X 6.5", PLASTIC, BLACK
7	108908	36	BOLT-CARRAIGE, 10-24 X 1.0,SST, BLACK
8	107864	44	NUT-NYLOCK, 10-24, SST
9	552052	10	SUPPORT MTG PLT, 11 GA, GALV
10	106997	20	SCREW-HEX HD, 5/16-18X1.0,SST,BLACK
11	106998	20	WSHR-FLAT, 5/16, SST, BLACK
12	102680	20	NUT-SER FLG, 5/16-18, SST
13	108913	2	STEP PAD, 15" X 6.5", PLASTIC (IF NEEDED)



(A LIVERNE Company)

1200 E. Birch St.

Brandon, SD 57005

REV B 06JUN14

REV A 31JUL12

552088 SHEET 2 OF 3 07MAY12

SERVICE PARTS LIST

MODEL NO.	—	477097
	—	477101
	—	477102
	—	477108
	—	477113
	—	477114
	—	477125

NOTE:
SOME APPLICATIONS WILL
USE A SMALL STEP PAD
FOR THE BOX STEP.

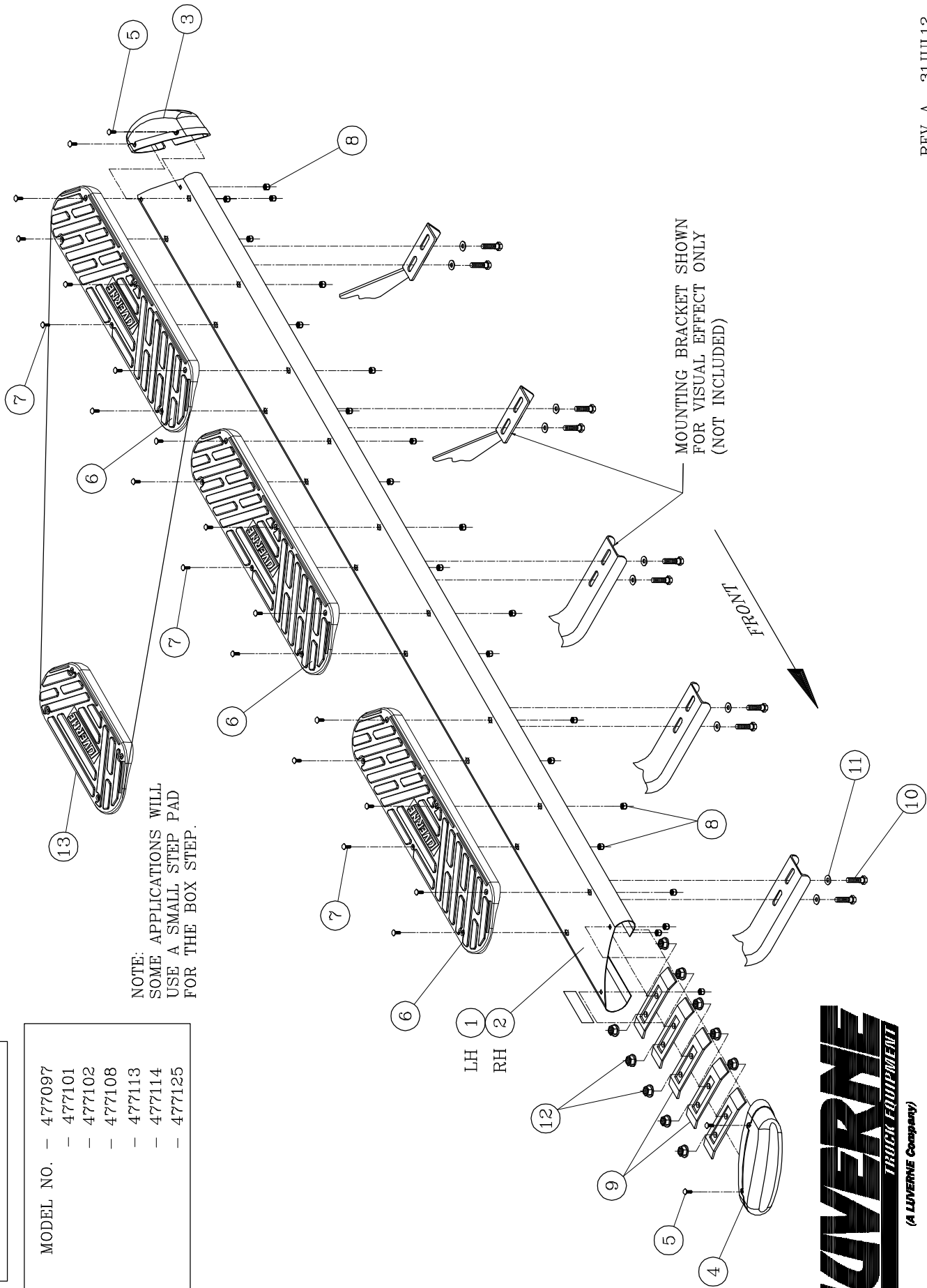

LIVERNE
TRUCK EQUIPMENT
(A LIVERNE Company)

1200 E. Birch St.
Brandon, SD 57005